

MISSION VILLAGE PLAZA OFF-SITE SEWER IMPROVEMENT PLAN

GENERAL NOTES:

1. No person shall perform any construction activity or install any objects within the public right-of-way or easements of the City of Riverside without a valid Construction permit or, a Street Opening Permit or an Encroachment Permit issued by the City's Public Works Department.
2. It shall be the responsibility of the contractor to clear the right of way in accordance with the provisions of law as it affects each utility including irrigation lines and appurtenances and at no cost to the City.
3. Construction shall be in accordance with the City of Riverside Department of Public Works, Standard Drawings, its Supplemental Notes and the Standard Specifications for Public Works Construction, current edition.
4. The private engineer signing these plans is responsible for assuring the accuracy and acceptability of the work hereon. In the event of discrepancies arising during construction, the private engineer shall be responsible for determining an acceptable solution and revising the plans for approval by the City.
5. Quantities shown are for information only and the City of Riverside is not responsible for their accuracy.
6. The developer shall be responsible for preserving or re-establishing and referencing survey monuments destroyed, disturbed or buried as a result of construction shown hereon.
7. All flagged elevations shall be staked in the field by the private engineer.
8. Any traffic control striping obliterated and/or badly worn during construction shall be restored by the contractor within five days after notification from the City Inspectors.
9. Street improvement work that will cause damage to the detector loop(s) shall not be performed until traffic signal maintenance personnel have been notified and the necessary timing adjustments are made to maintain signal operation.
10. The contractor shall call in a location request to Underground Service Alert (USA), Phone # 1-800-227-2600, two working days before digging. No construction permit will be issued by the Public Works department involving excavation for underground facilities unless the applicant has been provided and inquiry identification number by U.S.A.
11. Contractor is to verify existing sewer elevation prior to construction.
12. A plug shall be installed and will remain in place where the new sewer connects with the existing sewer until the new sewer is accepted by the City.
13. The sewer contractor shall adjust manholes to final grade after paving is complete.

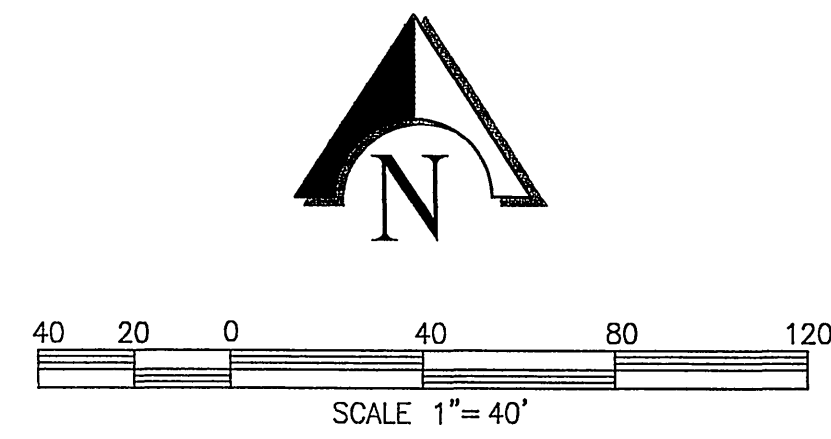
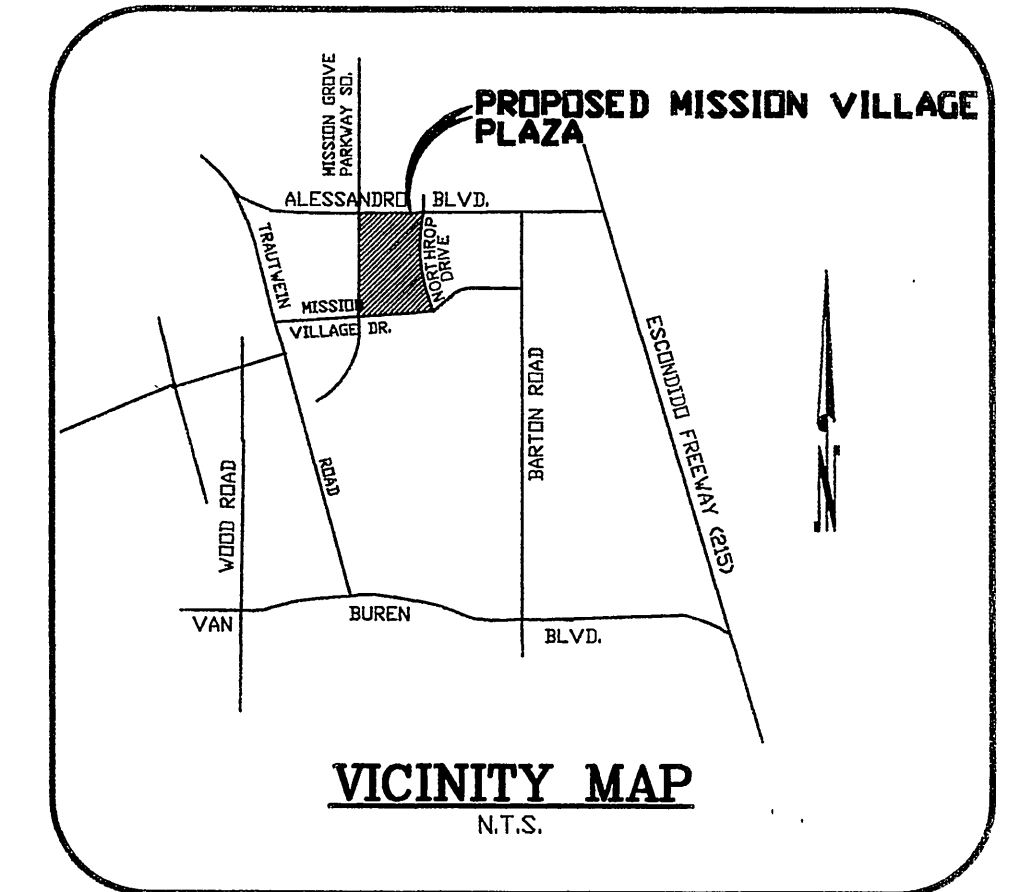

CONTRACTOR'S SCOPE OF WORK

TO CONSTRUCT THE OFFSITE UNDERGROUND SEWER SYSTEMS.

CONTRACTOR
VAZZANA UNDERGROUND CONSTRUCTION
31705 CENTRAL STREET
WILDOMAR, CA 92595
STATE LICENSE NO.614898

PROPERTY ADDRESS
501 ALESSANDRO BLVD,
RIVERSIDE, CA 92505

LEGEND

I.E. PROPOSED 8" SEWER MAIN
..... INVERT ELEVATION

CONSTRUCTION NOTES

- | | | |
|---|--|----------|
| ① | CONSTRUCT 8" VCP EXTRA STRENGTH SEWER MAIN | 141 L.F. |
| ② | REMOVE PLUG & JOIN | 1 E.A. |
| ③ | CONSTRUCT PRECAST CONCRETE MANHOLE PER CITY OF RIVERSIDE STD. DWG. NO. 500 | 1 E.A. |
| ④ | CONSTRUCT SEWER CLEANOUT PER CITY OF RIVERSIDE STD. DWG. NO. 560 | 1 E.A. |

QUANTITIES

SEWER NOTES:

1. ALL MATERIALS AND TESTING OF SEWER SHALL BE IN CONFORMITY WITH THE REQUIREMENTS OF WESTERN MUNICIPAL WATER DISTRICT. FAILURE TO MEET ANY REQUIREMENT'S OF THE ABOVE REFERENCED AGENCY WILL BE CAUSE FOR REJECTION.
2. ALL LATERALS SHALL BE LOCATED AS SHOWN ON THE DRAWINGS, TERMINATE 5'-FT. FROM BUILDING). ALL LATERALS SHALL BE 6" MINIMUM DIAMETER WITH A MINIMUM SLOPE OF 2%, UNLESS OTHERWISE NOTED. ALL LATERALS SHALL HAVE A CLEAN OUT. LATERALS SHALL BE INSTALLED IN ACCORDANCE WITH CITY OF RIVERSIDE STD. DWG. NO. 562
3. MANHOLES SHALL BE CONSTRUCTED IN ACCORDANCE WITH CITY OF RIVERSIDE STD. DWG. NO. 500
4. SEWER CLEANOUTS AT END OF A SEWER LINE RUN, SHALL BE INSTALLED IN ACCORDANCE WITH CITY OF RIVERSIDE STD. DWG. NO. 560. THE RIM ELEVATION OF CLEANOUTS LOCATED IN UNPAVED AREAS SHALL BE 0.1' HIGHER THAN FINISHED SURFACE.
5. SEWER BEDDING AND BACKFILL SHALL BE IN ACCORDANCE WITH CITY OF RIVERSIDE STD. DWG NOS. 452 & 453.
6. PRIOR TO CONSTRUCTION, CONTRACTOR SHALL EXPOSE EXISTING FACILITIES AT PROPOSED CONNECTIONS AND CROSSINGS AND VERIFY ELEVATIONS, LOCATIONS, AND SIZE OF EXISTING FACILITIES.
7. WHENEVER A SEWERLINE ENCOUNTERS A STORM DRAIN PIPE OR OTHER CONSTRUCTION AND CROSSING OVER THE OBSTRUCTION WILL RESULT IN LESS THAN THE MINIMUM COVER ALLOWED BY THE DISTRICT. THE SEWERLINE SHALL CROSS UNDER THE OBSTRUCTION WITH A MINIMUM CLEARANCE OF 12". ALL SEWERLINES SHALL CROSS UNDER POTABLE WATERLINES WITH A MINIMUM 12" CLEARANCE.
8. SEWER ELEVATIONS ARE TO INVERT OF PIPE.
9. NOTE: PRIOR TO THE REQUIRED INSPECTION(S) BY THE BUILDING INSPECTOR, THE DESIGNER MUST VERIFY IN WRITING THAT THE INSTALLATION IS IN COMPLIANCE WITH THE APPROVED PLANS AND SPECIFICATIONS.

Underground Service Alert
Call: TOLL FREE
1-800-227-2600
TWO WORKING DAYS BEFORE YOU DIG

PRIVATE ENGINEERING NOTE
CONSTRUCTION CONTRACTOR AGREES THAT IN ACCORDANCE WITH REGULARLY ACCEPTED CONSTRUCTION PRACTICES, CONSTRUCTION CONTRACTOR WILL BE REQUIRED TO ASSUME SOLE AND COMPLETE RESPONSIBILITY FOR JOB SITE CONDITIONS DURING THE COURSE OF CONSTRUCTION OF THE PROJECT, INCLUDING SAFETY OF ALL PERSONS AT ALL TIMES. THAT THIS REQUIREMENT SHALL BE MADE TO APPLY CONTINUOUSLY AND NOT BE LIMITED TO NORMAL WORKING HOURS, AND CONSTRUCTION CONTRACTOR FURTHER AGREES TO DEFEND, INDEMNIFY AND HOLD DESIGN PROFESSIONAL HARMLESS FROM ANY AND ALL LIABILITY, REAL OR ALLEGED, IN CONNECTION WITH THE PERFORMANCE OF WORK ON THIS PROJECT, EXCEPTING LIABILITY ARISING FROM THE SOLE NEGLIGENCE OF DESIGN PROFESSIONAL.

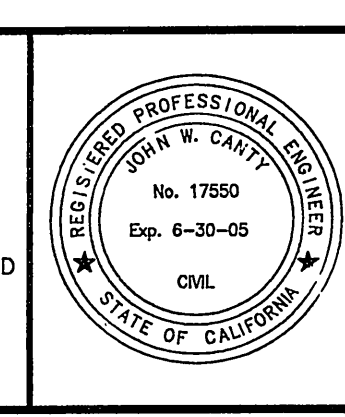

PREPARED UNDER THE DIRECTION OF:
John W. Canty
REGISTERED CIVIL ENGINEER NO. 17550
EXPIRATION DATE: 6-30-05 DATE: 4/16/03

CEG COUNTY ENGINEERING GROUP, INC.
CIVIL ENGINEERING - PLANNING - SURVEYING
2020 IOWA AVENUE, SUITE 102, P.O. BOX 52050, RIVERSIDE, CA 92517
TEL (909) 883-5234 FAX (909) 883-5301
CITY OF RIV. BUSINESS TAX ACCT. NO. 69372 EXP. DATE 04-07-04

SCALE: AS SHOWN
BENCH MARK: FB-03 P.K. Nail & City Engineer Tag in the sidewalk over the westerly wall of a catch basin, 1 foot northerly of the face of curb along the northerly curb of Alessandro Blvd, easterly of Mission Grove Parkway. Elevation=1602.33

MARK	REVISIONS	APPR. DATE
DESIGNED BY W.T.	DRAWN BY W.T.	CHECKED BY W.T.

**CITY OF RIVERSIDE, CALIFORNIA
DEPARTMENT OF PUBLIC WORKS**

APPROVED BY	BY	DATE	APPROVED BY
PRINCIPAL ENGINEER	<i>[Signature]</i>	4/16/03	<i>[Signature]</i>
PARK DEPARTMENT			CITY ENGINEER
TRAFFIC DIVISION			DATE 5/16/03

#A5-BUILT 9-28-05 *4H*

**PM 30214
MISSION VILLAGE PLAZA
MISSION VILLAGE DRIVE
OFFSITE SEWER PLAN**

PROJECT NO. **S-1796**
SHEET 1 OF 2
FOR: REGIONAL PROPERTIES
FILE NO.: 1004-016

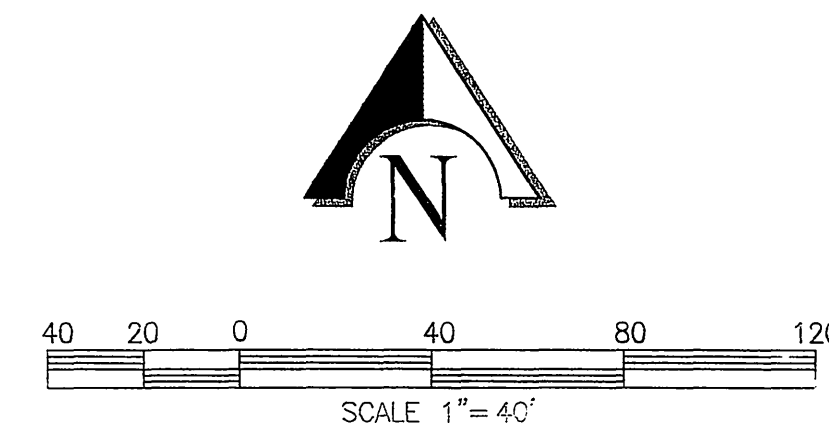
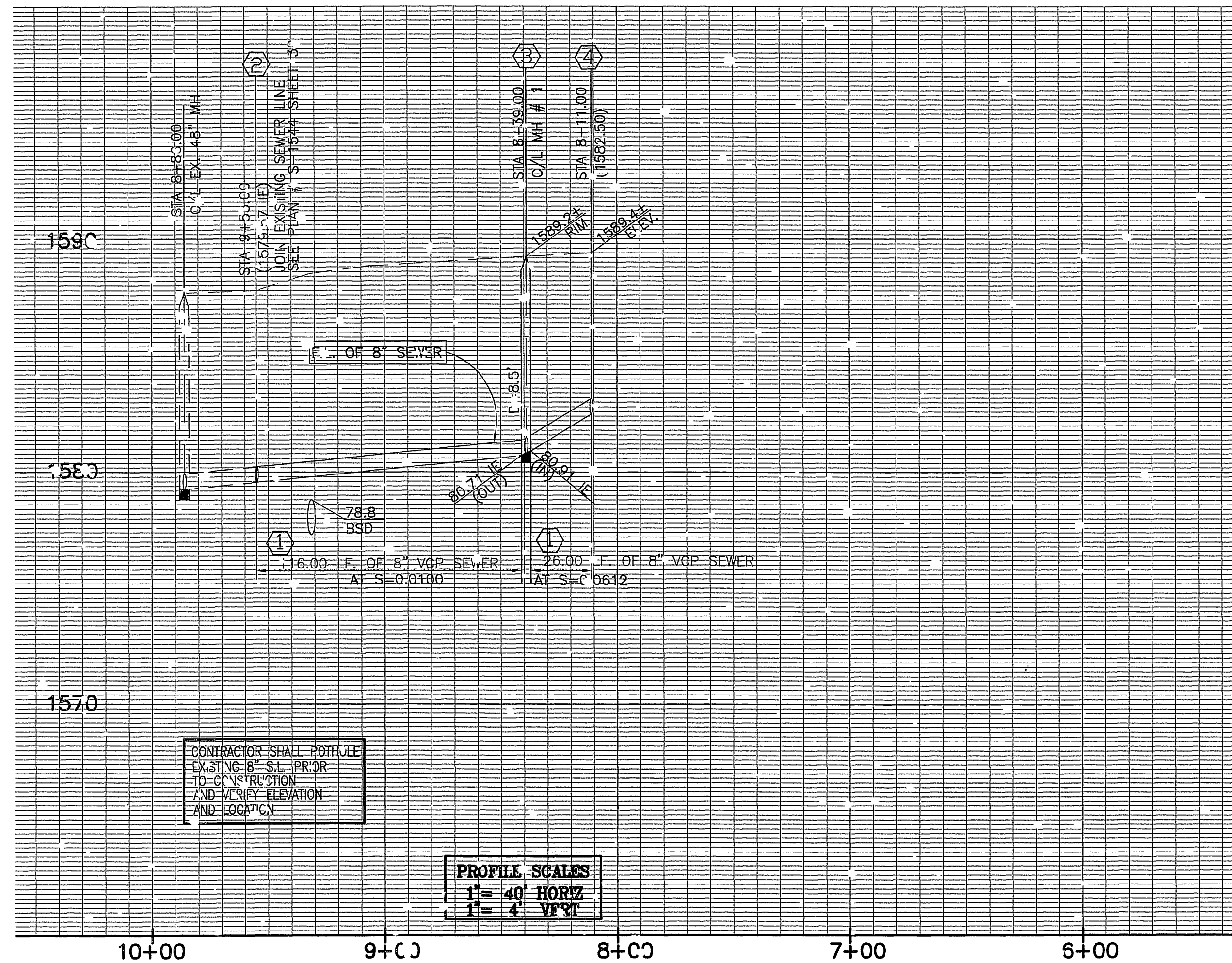

- CONSTRUCTION NOTES**
- ① CONSTRUCT 8" VCP EXTRA STRENGTH SEWER MAIN
 - ② REMOVE PLUG & JOIN
 - ③ CONSTRUCT 48" I.D. PRECAST CONCRETE TERMINUS MANHOLE PER CITY OF RIVERSIDE STD. DWG. NO. 300
 - ④ CONSTRUCT SEWER CLEANOUT PER CITY OF RIVERSIDE STD. DWG. NO. 560

Underground Service Alert
Call: TOLL FREE
1-800-227-2600
TWO WORKING DAYS BEFORE YOU DIG

PRIVATE ENGINEERING NOTE
CONSTRUCTION CONTRACTOR AGREES THAT IN ACCORDANCE WITH GENERALLY ACCEPTED CONSTRUCTION PRACTICES, CONSTRUCTION CONTRACTOR WILL BE REQUIRED TO ASSUME SOLE AND COMPLETE RESPONSIBILITY FOR JOB SITE CONDITIONS DURING THE COURSE OF CONSTRUCTION OF THIS PROJECT, INCLUDING SAFETY OF ALL PERSONS AND PROPERTY; THAT THIS REQUIREMENT SHALL BE MADE TO APPLY CONTINUOUSLY AND IT WILL BE LIMITED TO NORMAL WORKING HOURS, AND CONSTRUCTION CONTRACTOR FURTHER AGREES TO DEFEND, INDemnIFY AND HOLD DESIGN PROFESSIONAL HARMLESS FROM ANY AND ALL LIABILITY, REAL OR ALLEGED, IN CONNECTION WITH THE PERFORMANCE OF WORK ON THIS PROJECT, EXCEPT LIABILITY ARISING FROM THE SOLE NEGLIGENCE OF DESIGN PROFESSIONAL.

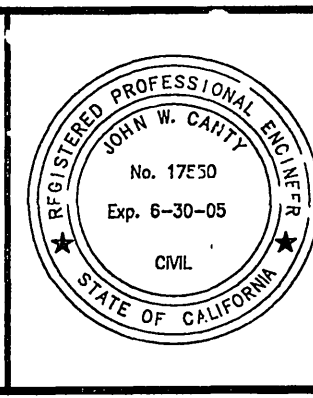

PREPARED UNDER THE DIRECTION OF:
John W. Caty
REGISTERED CIVIL ENGINEER NO. 17530
EXPIRATION DATE: 6-30-05 DATE: 4/25/03

CEG COUNTY ENGINEERING GROUP, INC.
CIVIL ENGINEERING - PLANNING - SURVEYING
2020 IOWA AVENUE, SUITE 102, P.O. BOX 52050, RIVERSIDE, CA 92517
TEL (909) 683-5244 FAX (909) 683-5301
CITY OF RIV. BUSINESS TAX ACCT. NO. 68972 EXP. DATE 04-07-04

SCALE: AS SHOWN
DATE: APRIL 2003

MARK	REVISIONS	APPR.	DATE
DESIGNED BY	W.T.	DRAWN BY	W.T.
CHECKED BY	W.T.	DATE	

CITY OF RIVERSIDE, CALIFORNIA
DEPARTMENT OF PUBLIC WORKS

APPROVED BY	DATE	APPROVED BY	DATE
PRINCIPAL ENGINEER	4/25/03		
PARK DEPARTMENT			
TRAFFIC DIVISION			

CITY ENGINEER

*A5-BUILT 9-28-05 LH

PM 30214
MISSION VILLAGE PLAZA
MISSION VILLAGE DRIVE
OFFSITE SEWER PLAN
MISSION GROVE PKWY E'LY 150±

PROJECT NO. **S-1796**
SHEET **2** OF **2**
FOR: REGIONAL PROPERTIES
FILE NO.: 1004-016