

NOTES

- SKIDS SHALL BE REDWOOD, 30" LONG, AND OF SUFFICIENT HEIGHT TO PROVIDE A MINIMUM 2" CLEARANCE BETWEEN INVERT OF CASING AND BELL OF VCP. ALL SKIDS SHALL BE OF EQUAL DIMENSIONS AND POSITIONED UNIFORMLY.
- ALL STEEL CASING PIPE FIELD JOINTS SHALL BE WELDED WITH A CONTINUOUS CIRCUMFERENTIAL WELD.
- CARRIER PIPE SHALL BE AIR TESTED PRIOR TO SLURRY BACKFILLING AND SEALING CASING.
- VOID BETWEEN CASING AND CARRIER PIPE SHALL BE FILLED WITH A ONE SACK PCC SLURRY MIX.
- UPSTREAM AND DOWNSTREAM ELEVATIONS TO BE VERIFIED PRIOR TO SEALING CASING.
- ENDS OF CASING TO BE SEALED WITH BRICK AND MORTAR. PLACE 1" # MINIMUM PVC PIPE AT INVERT OF CASING (THROUGH BRICK) AND SURROUND WITH 2 CUBIC FEET CRUSHED ROCK.

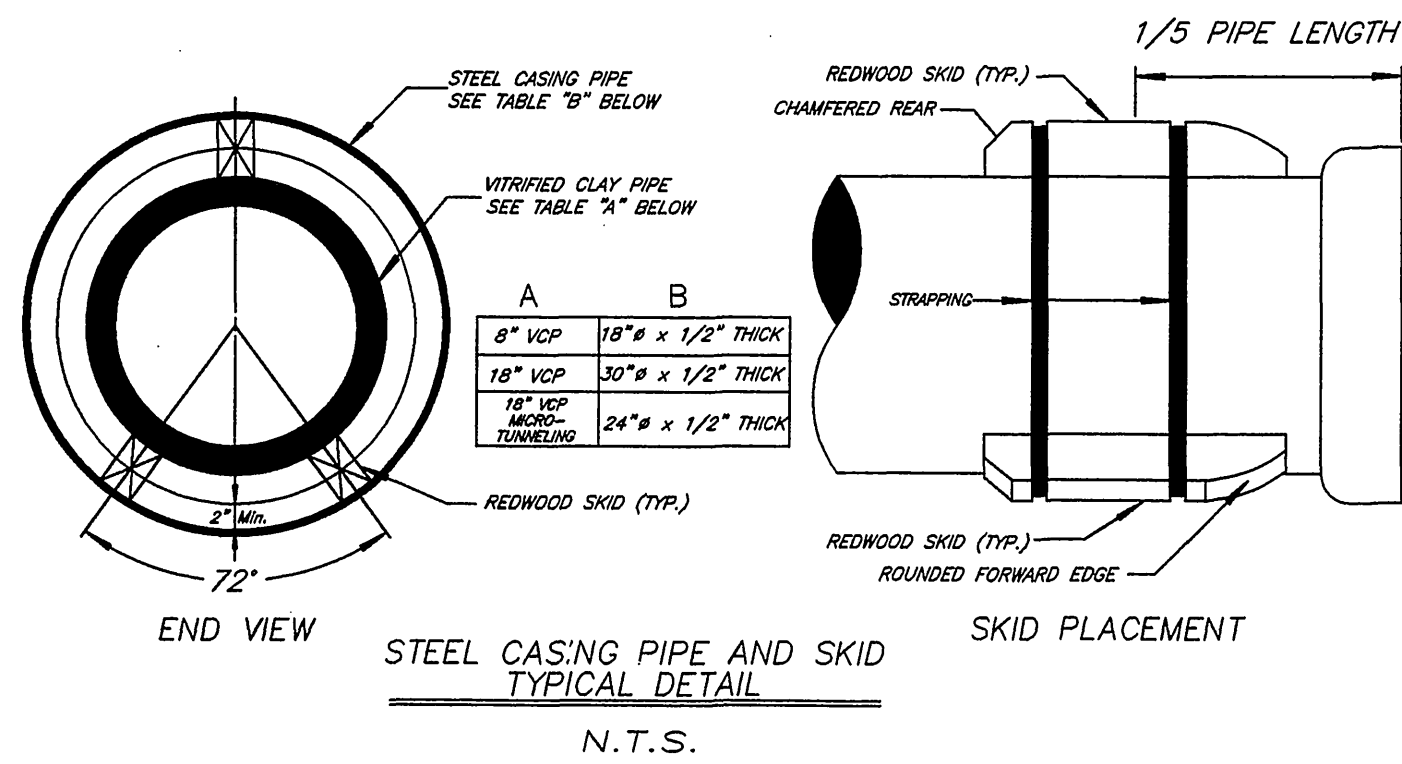

BENCHMARK
 18-A P.K. NAIL AND CITY ENGINEER TAG IN THE WESTERLY END OF THE SOUTHWEST CURB RETURN AT SPRUCE STREET AND ATLANTA AVENUE
 ELEV- 929.63

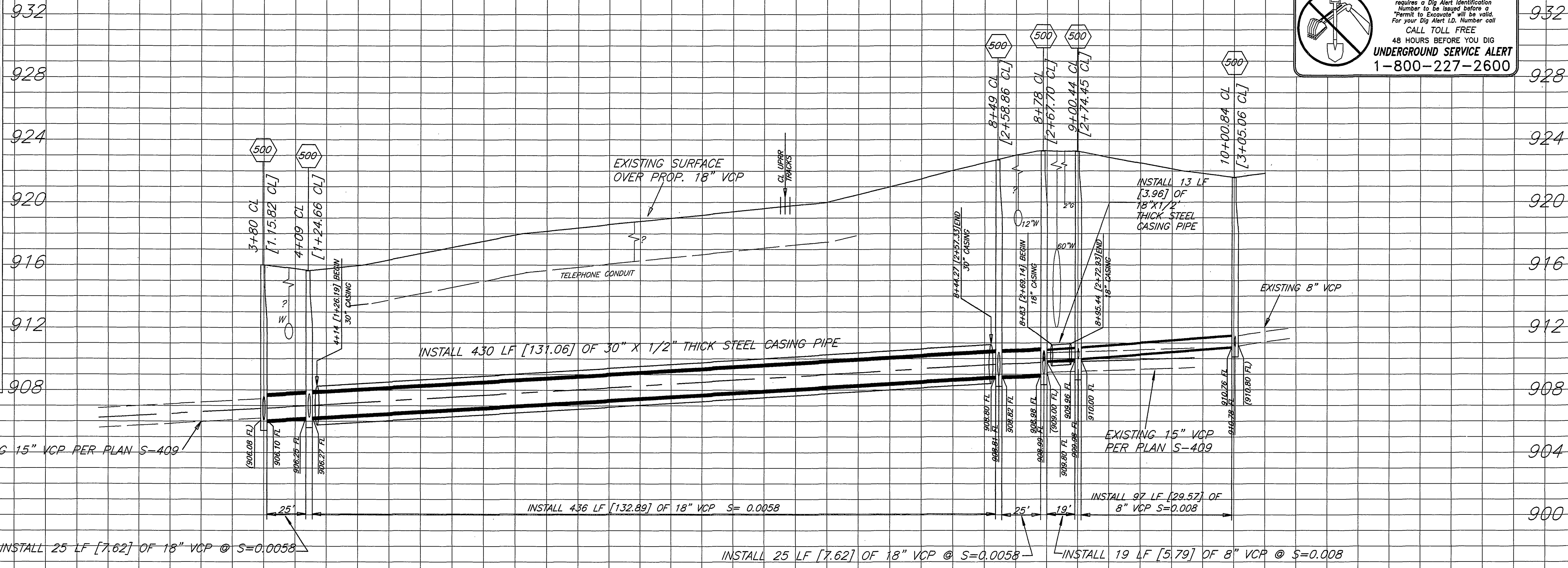

IMPORTANT NOTICE
 Section 4216/4217 of the Government Code requires a Dig Alert Identification Number to be issued before a "Permit to Excavate" will be valid. For your Dig Alert ID, Number call CALL TOLL FREE 48 HOURS BEFORE YOU DIG
UNDERGROUND SERVICE ALERT
 1-800-227-2600

SPRUCE STREET

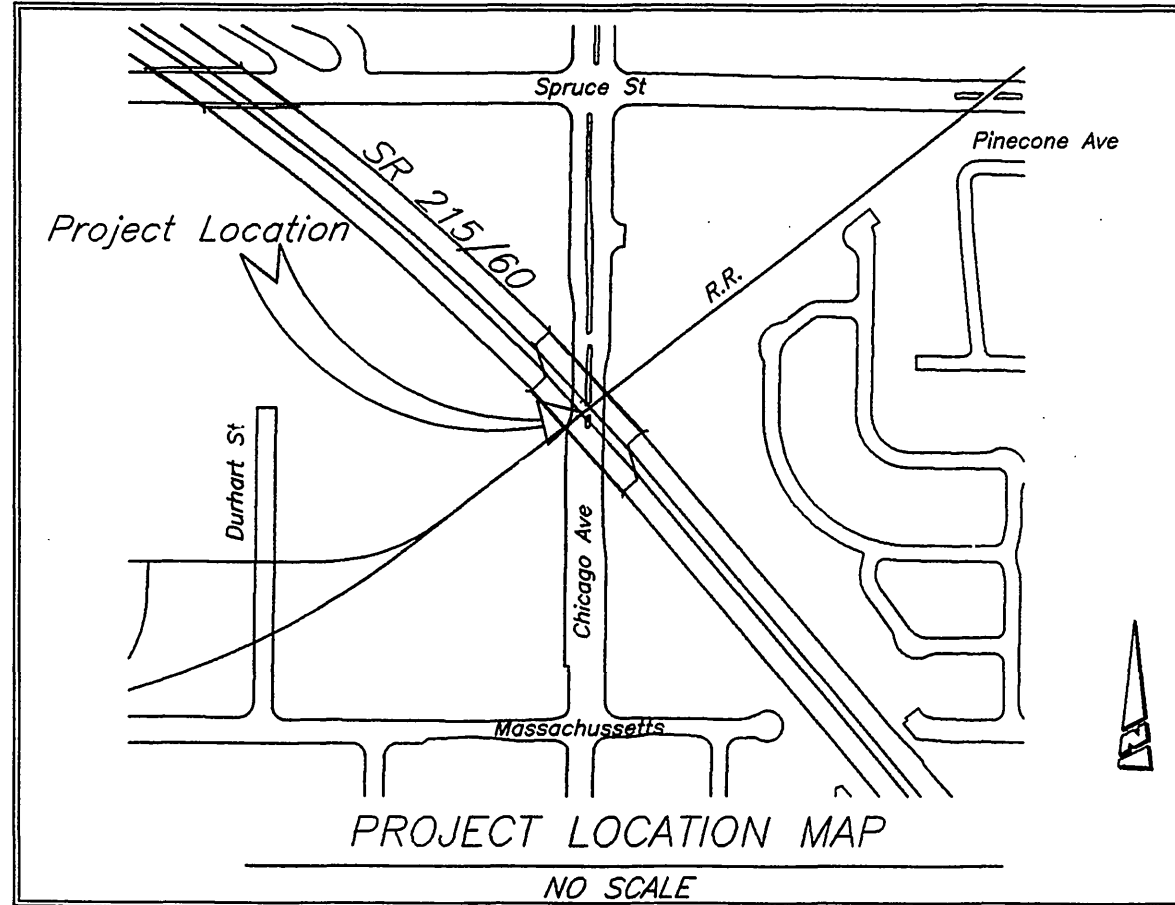
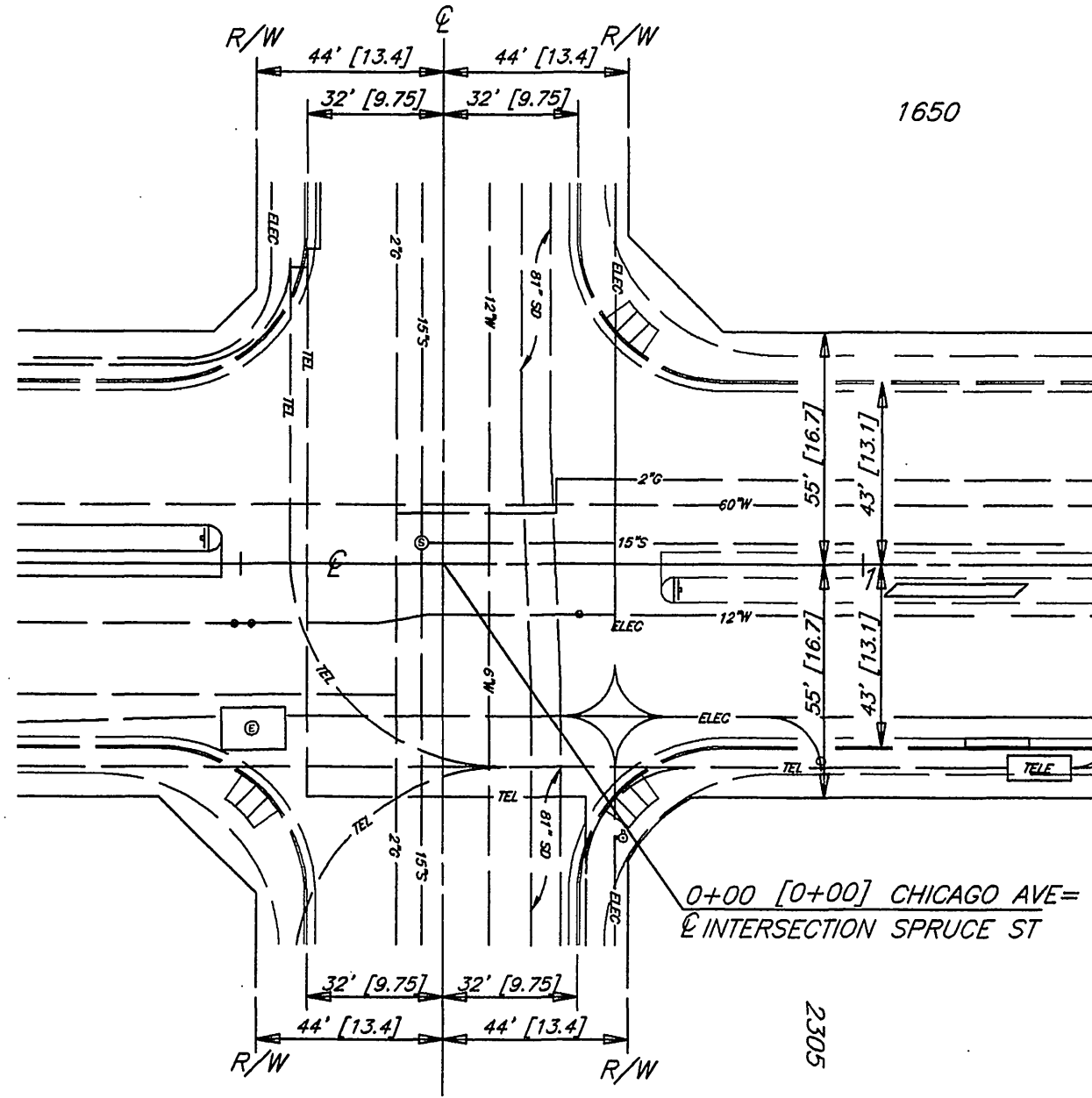

- GENERAL NOTES**
- CONSTRUCTION SHALL BE IN ACCORDANCE WITH THE CITY OF RIVERSIDE STANDARD DRAWINGS AND STANDARD SPECIFICATIONS FOR PUBLIC WORKS CONSTRUCTION, 2003 EDITION.
 - EXISTING UTILITIES SHOWN ON THIS PLAN ARE PLOTTED FROM PUBLIC RECORDS. THE CONTRACTOR IS REQUIRED TO TAKE DUE PRECAUTIONARY MEASURES TO LOCATE AND PROTECT ALL UTILITIES WHETHER OR NOT SHOWN ON THIS PLAN.
 - CONTRACTOR SHALL POTHOLE AND VERIFY ALL LOCATIONS AND ELEVATIONS OF UTILITIES PRIOR TO THE START OF CONSTRUCTION TO ELIMINATE INTERFERENCE WITH NEW CONSTRUCTION.
 - PRIME CONTRACTOR BIDDING THIS WORK SHALL HAVE A CLASS "A, C-34 OR C-42" LICENSE.
 - ALL ELEVATIONS SHOWN ON THIS PLAN SHALL BE STAKED IN THE FIELD.
 - BACKFILLING OF TRENCH AND PAVEMENT REPLACEMENT SHALL BE DONE PER CITY OF RIVERSIDE STANDARD DRAWING 453.
 - ALL NUMBERS IN BRACKETS [] ARE IN METERS UNLESS UNITS ARE SHOWN

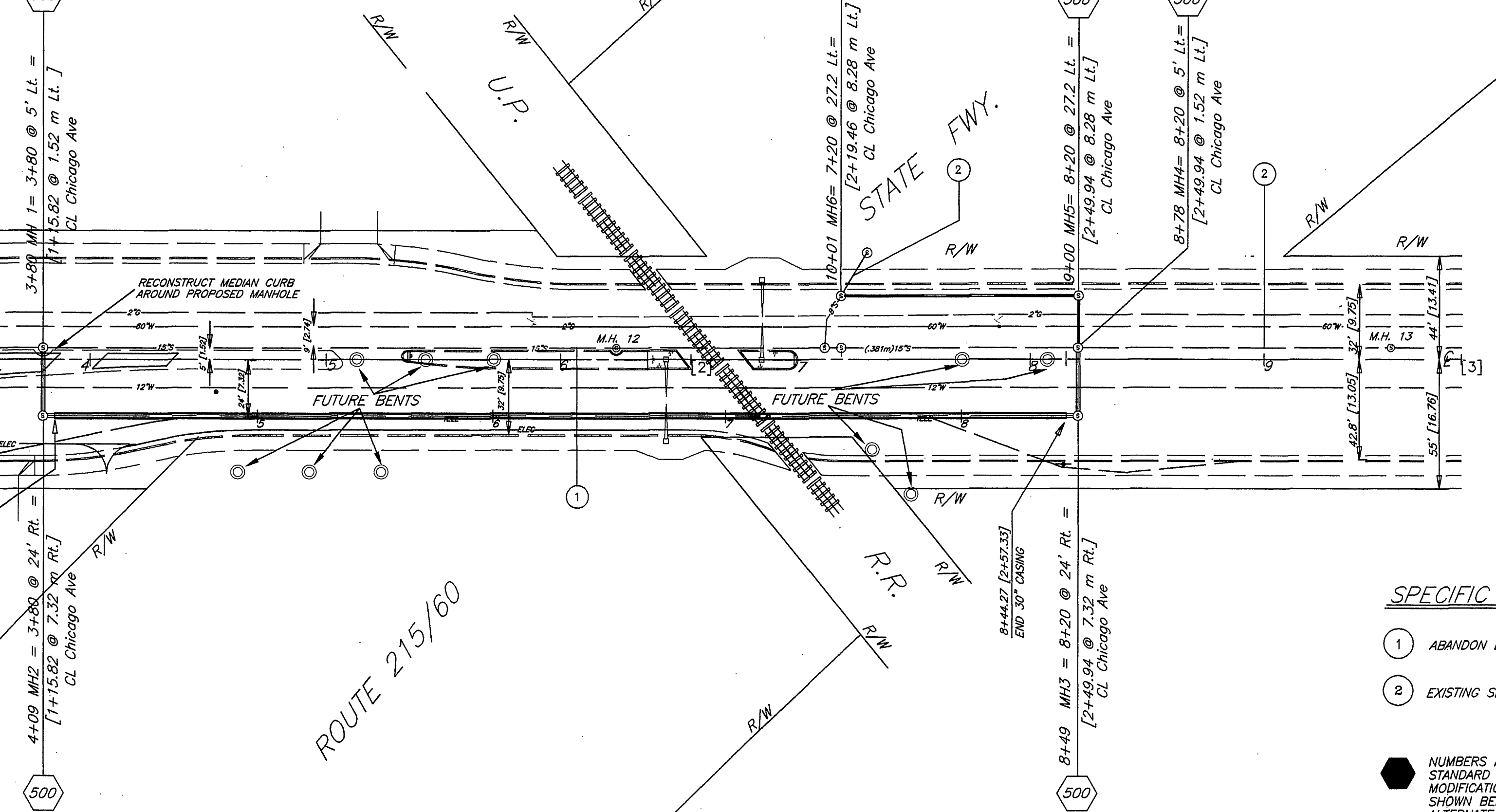

- SPECIFIC CONSTRUCTION NOTES**
- ABANDON EXISTING SEWER IN PLACE
 - EXISTING SEWER TO REMAIN IN SERVICE.
- NUMBERS ABOVE 100 IN A HEXAGON ON THE PLAN REFER TO THE RESPECTIVE STANDARD DRAWING AND SHALL BE CONSTRUCTED ACCORDINGLY. UNLESS MODIFICATIONS ARE NOTED ON THE PLAN OR COVER SHEET, ANY NUMBER SHOWN BELOW THE STANDARD DRAWING NUMBER INDICATES THE SPECIFIC ALTERNATE TO BE CONSTRUCTED.

SEWER RELOCATION IS NECESSARY DUE TO CALTRANS' PROJECT TO WIDEN THE I-215/RTE 60 FREEWAY.

ENGINEER IN RESPONSIBLE CHARGE
 LAUREN F. CALDWELL
 R.C.E. No. 39441 expires 12/31/05
 DATE 10/31/03

MARK	REVISIONS	APPR.	DATE

CITY OF RIVERSIDE, CALIFORNIA
PUBLIC WORKS DEPARTMENT

APPROVED BY	BY	DATE	APPROVED BY
PRINCIPAL ENGINEER			
INSPECTOR			
SURVEYOR			

DATE 10/31/03

INDEXED 1-05-04 LHM

CHICAGO AVENUE
SEWER RELOCATION
 215/RTE 60 UPRR

ACC. NO. 9762623203-440301HX

S-1808

HORIZ. SCALE: 1" = 40'
 VERT. SCALE: 1" = 4'

SHEET 1 OF 1