

GENERAL CONSTRUCTION NOTES:

- EXISTING UTILITIES SHOWN ON THE PLAN ARE PLOTTED FROM UTILITY RECORDS. THE CONTRACTOR IS REQUIRED TO TAKE DUE PRECAUTIONARY MEASURES TO LOCATE AND PROTECT ALL UTILITIES WHETHER OR NOT SHOWN ON THIS PLAN.
- PRIME CONTRACTORS BIDDING THIS WORK SHALL HAVE A CLASS "A", "C-34", OR A "C-42" LICENSE.
- ALL ELEVATIONS SHOWN ON THE PLANS SHALL BE STAKED IN THE FIELD.
- CONTRACTOR SHALL POTHOLE AND VERIFY ALL LOCATIONS AND ELEVATIONS OF UTILITIES PRIOR TO THE START OF CONSTRUCTION TO ELIMINATE INTERFERENCE WITH NEW CONSTRUCTION.
- CONSTRUCTION SHALL BE IN ACCORDANCE WITH THE CITY OF RIVERSIDE STANDARD DRAWINGS AND STANDARD SPECIFICATIONS FOR PUBLIC WORKS CONSTRUCTION, 2003 EDITION.
- BACKFILLING OF TRENCH SHALL BE DONE PER CITY OF RIVERSIDE STANDARD DRAWING 453.
- NUMBERS IN BRACKETS [] ARE IN METERS UNLESS UNITS ARE OTHERWISE SHOWN.

CONSTRUCTION LEGEND:

- NUMBERS ABOVE 100 IN A HEXAGON ON THE PLAN REFER TO THE RESPECTIVE STANDARD DRAWING AND SHALL BE CONSTRUCTED ACCORDINGLY, UNLESS MODIFICATIONS ARE NOTED ON THE PLAN. ANY NUMBER SHOWN BELOW THE STANDARD DRAWING NUMBER INDICATES THE SPECIFIC ALTERNATE TO BE CONSTRUCTED.
- SEE PROJECT LOCATION MAP. ABANDON EXIST. 18" V.C.P. SEWER ON THE S.W. SIDE OF SPRUCE ST. FROM MULBERRY ST. TO KANSAS AVE. ABANDON MANHOLES AND PLUG AND ABANDON ASSOCIATED SEWER PIPES.

IMPORTANT NOTICE
Section 4216/4217 of the Government Code requires a Dig Alert Identification Number to be issued before a "Permit to Excavate" will be valid. For your Dig Alert I.D. Number call Underground Service Alert
TOLL FREE 1-800-227-2600
Two working days before you dig.

SEWER CONSTRUCTION IS NECESSARY DUE TO CALTRANS' PROJECT TO RECONSTRUCT THE 91/215/60 FREEWAYS INTERCHANGE.

SEWER CURVE DATA				
Δ	R	L	T	
1	36' 50" 10"	318.87' [97.192]	205.01' [62.487]	106.197' [32.367]
2	5' 41" 14"	400.00' [121.920]	39.70' [12.101]	19.87' [6.056]
3				
4				
5				

BENCHMARK
A C.S.D.H. BRONZE DISK STAMPED "B.M. 66-B-61" IN THE TOP OF THE S.W. END OF THE S.E. CONCRETE HEADWALL OF A 20x8 FOOT BOX CULVERT UNDER A ROAD 47 YARDS S.W. OF THE S.W. EDGE OF U.S. HWY. 60 OVERCROSSING OF THE A.T. & S.F. R.R. 45 FEET N.W. OF THE N.W. RAIL, 22 FEET S.E. OF CENTERLINE OF E. LA CADENA DRIVE AND LEVEL WITH THE GROUND.
ELEVATION 901.36' [274.735]

ENGINEER IN RESPONSIBLE CHARGE
Lauren F. Caldwell
LAUREN F. CALDWELL
R.C.E. No. 39441 expires 12/31/2005
DATE 3/23/2004

CITY OF RIVERSIDE, CALIFORNIA
PUBLIC WORKS DEPARTMENT

APPROVED BY: [Signature]
DATE: 2/13/04

E. LA CADENA DR. SEWER FROM SPRUCE ST. TO 1,100' S'LY OF SPRUCE ST.

HORIZ. SCALE: 1" = 40' VERT. SCALE: 1" = 4'

ACCT. NO. 976232203-440301xx
S-1817
SHEET 1 OF 2

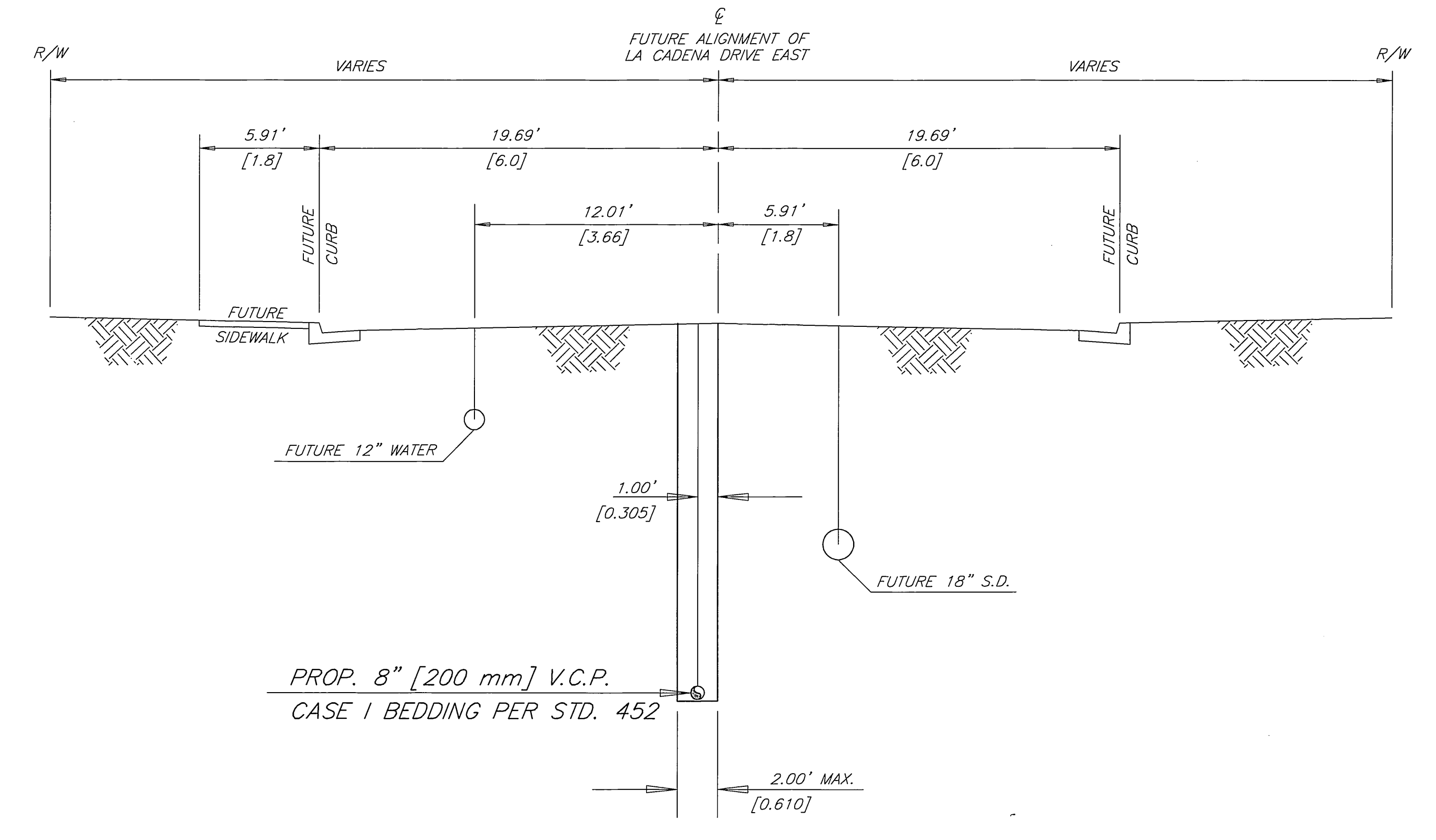
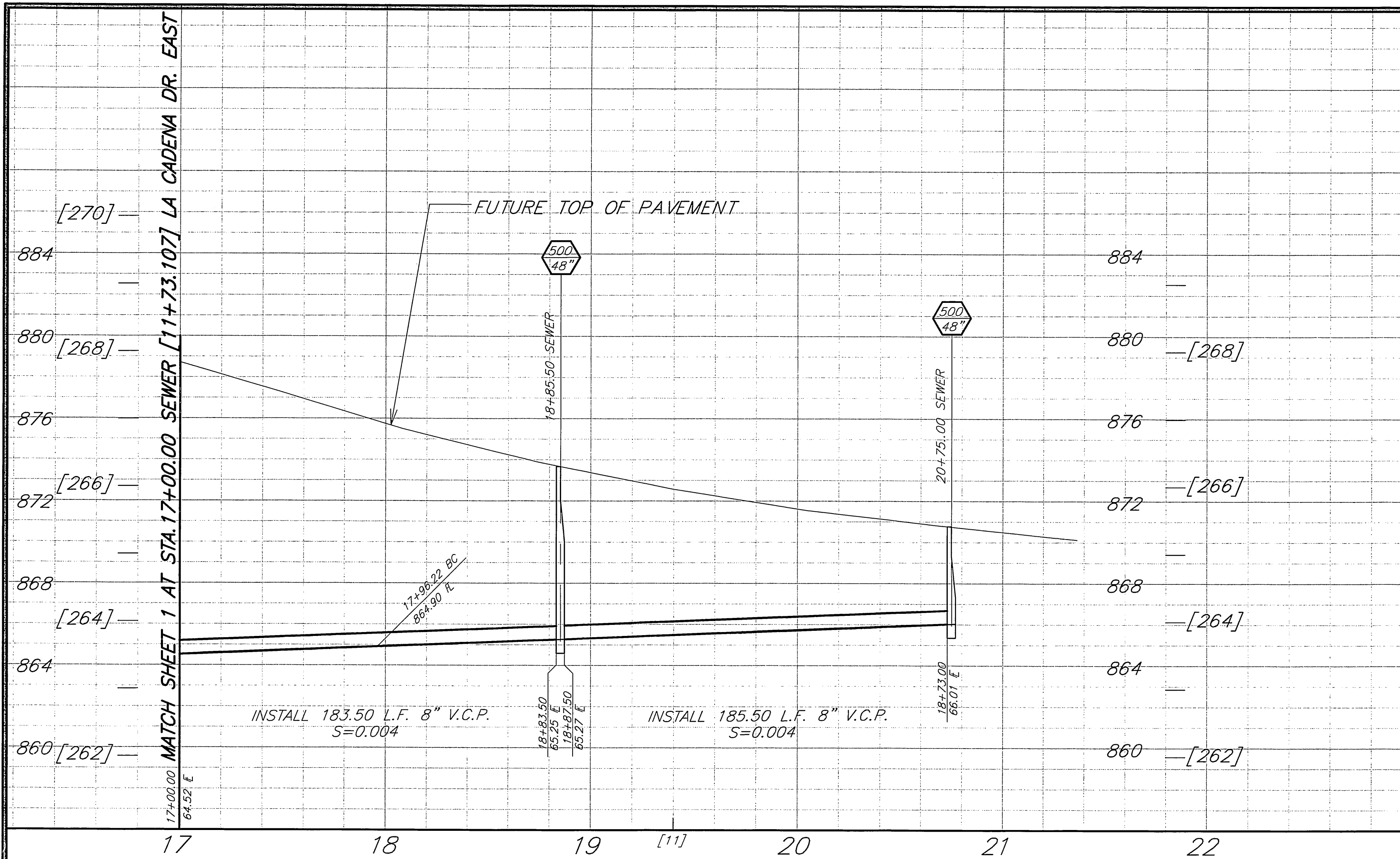

TYPICAL SECTION
PROPOSED 8" SEWER IN LA CADENA DRIVE EAST
NO SCALE

NOTES

- SKIDS SHALL BE REDWOOD, 30" LONG, 2" WIDE AND OF SUFFICIENT HEIGHT TO PROVIDE A MINIMUM 2" CLEARANCE BETWEEN INVERT OF CASING AND BELL OF V.C.P. ALL SKIDS SHALL BE OF EQUAL DIMENSIONS AND POSITIONED UNIFORMLY.
- ALL STEEL CASING PIPE FIELD JOINTS SHALL BE WELDED WITH A CONTINUOUS CIRCUMFERENTIAL WELD.
- CARRIER PIPE SHALL BE AIR TESTED PRIOR TO SLURRY BACK FILLING AND SEALING CASING.
- VOID BETWEEN CASING AND CARRIER PIPE SHALL BE FILLED WITH A ONE SACK P.C.C. SLURRY MIX.
- UPSTREAM AND DOWNSTREAM ELEVATIONS TO BE VERIFIED PRIOR TO SEALING CASING.
- ENDS OF CASING TO BE SEALED WITH MORTAR. PLACE 1" DIAMETER (MIN.) PVC PIPE AT INVERT OF CASING (THROUGH MORTAR) AND SURROUND WITH 2 CUBIC FEET CRUSHED ROCK.

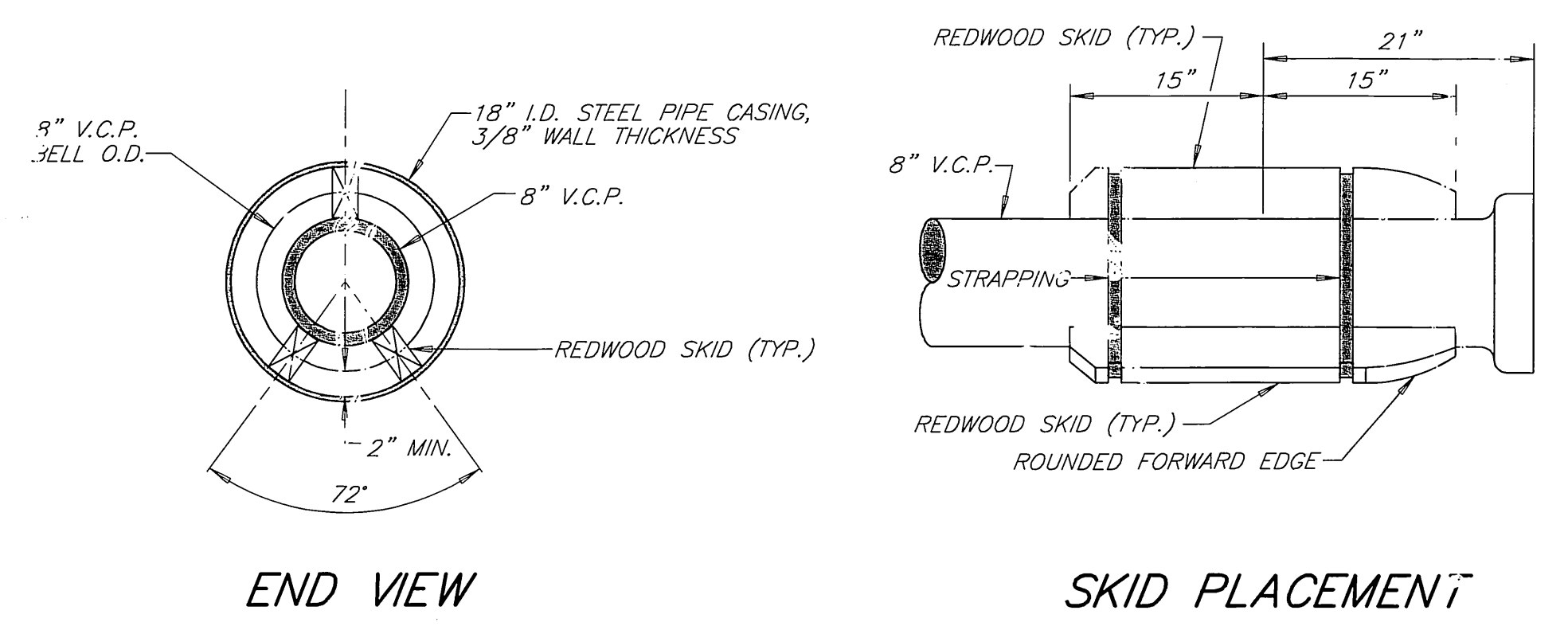
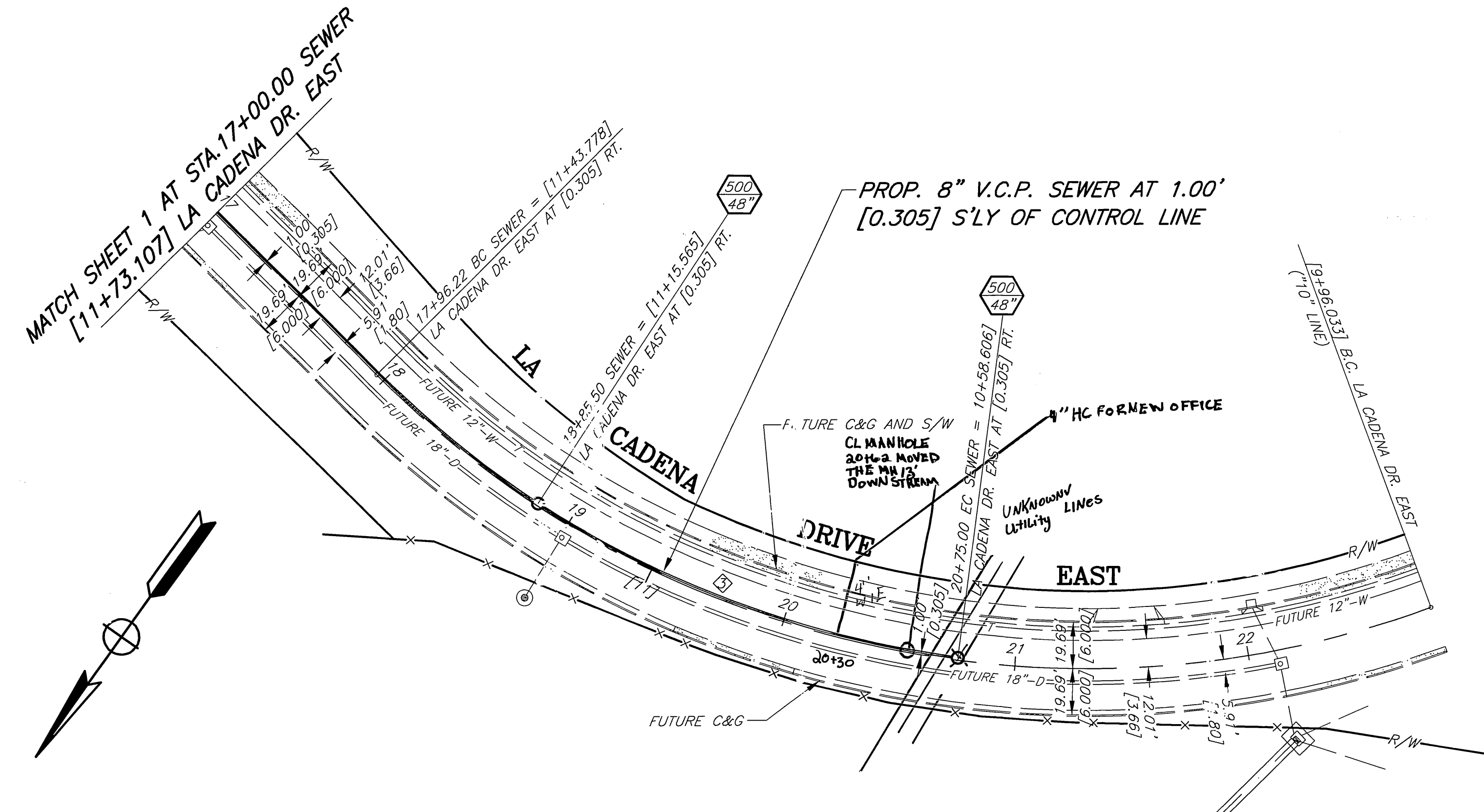

STEEL CASING AND SKID
TYPICAL DETAIL
NO SCALE

IMPORTANT NOTICE
Section 4216/4217 of the Government Code requires a Dig Alert Identification Number to be issued before a "Permit to Excavate" will be valid. For your Dig Alert I.D. Number call Underground Service Alert TOLL FREE 1-800-227-2600 Two working days before you dig.

SEWER CURVE DATA				
Δ	R	L	T	
3	37' 32" 18"	425.51' [129.695]	278.78' [84.972]	144.60' [44.074]
4				
5				

BENCHMARK
A C.S.D.H. BRONZE DISK STAMPED "B.M. 66-B-61" IN THE TOP OF THE S.W. END OF THE S.E. CONCRETE HEADWALL OF A 20x8 FOOT BOX CULVERT UNDER A ROAD 47 YARDS S.W. OF THE S.W. EDGE OF U.S. HWY. 60 OVERCROSSING OF THE A.T. & S.F. R.R., 45 FEET N.W. OF THE N.W. RAIL, 22 FEET S.E. OF CENTERLINE OF E. LA CADENA DRIVE AND LEVEL WITH THE GROUND.
ELEVATION 901.36' [274.735]

ENGINEER IN RESPONSIBLE CHARGE
LAUREN F. CALDWELL
R.C.E. No. 39441 expires 12/31/2005
DATE 3/23/2004

DESIGNED BY SK DRAWN BY SK CHECKED BY SC

CITY OF RIVERSIDE, CALIFORNIA
PUBLIC WORKS DEPARTMENT
APPROVED BY: [Signature]
DATE: 4/13/04

E. LA CADENA DR. SEWER
FROM SPRUCE ST. TO
1,100' S'LY OF SPRUCE ST.

ACCT. NO. 976232303-440301xx
S-1817
SHEET 2 OF 2