

GENERAL NOTES

- NO PERSON SHALL PERFORM ANY CONSTRUCTION ACTIVITY OR INSTALL ANY OBJECTS WITHIN THE PUBLIC RIGHTS-OF-WAY OR EASEMENTS OF THE CITY OF RIVERSIDE WITHOUT A VALID CONSTRUCTION PERMIT OR, A STREET OPENING PERMIT OR AN ENCROACHMENT PERMIT ISSUED BY THE CITY'S PUBLIC WORKS DEPARTMENT.
- IT SHALL BE THE RESPONSIBILITY OF THE CONTRACTOR TO CLEAR THE RIGHT-OF-WAY IN ACCORDANCE WITH THE PROVISIONS OF LAW AS IT AFFECTS EACH UTILITY INCLUDING IRRIGATION LINES AND APPURTENANCES AND AT NO COST TO THE CITY.
- CONSTRUCTION SHALL BE IN ACCORDANCE WITH THE CITY OF RIVERSIDE DEPARTMENT OF PUBLIC WORKS, STANDARD DRAWINGS, ITS SUPPLEMENTAL NOTES AND THE STANDARD SPECIFICATIONS FOR PUBLIC WORKS CONSTRUCTION, CURRENT EDITION.
- THE PRIVATE ENGINEER SIGNING THESE PLANS IS RESPONSIBLE FOR ASSURING THE ACCURACY AND ACCEPTABILITY OF THE WORK HEREON. IN THE EVENT OF DISCREPANCIES ARISING DURING CONSTRUCTION, THE PRIVATE ENGINEER SHALL BE RESPONSIBLE FOR DETERMINING AN ACCEPTABLE SOLUTION AND REVISIONS FOR APPROVAL BY THE CITY.
- QUANTITIES SHOWN ARE FOR INFORMATION ONLY AND THE CITY OF RIVERSIDE IS NOT RESPONSIBLE FOR THEIR ACCURACY.
- THE DEVELOPER SHALL BE RESPONSIBLE FOR PRESERVING OR RE-ESTABLISHING AND REFERENCING SURVEY MONUMENTS DESTROYED, DISTURBED OR BURIED AS A RESULT OF CONSTRUCTION SHOWN HEREON.
- ALL FLAGGED ELEVATIONS SHALL BE STAKED IN THE FIELD BY THE PRIVATE ENGINEER.
- THE CONTRACTOR SHALL CALL IN A LOCATION REQUEST TO UNDERGROUND SERVICE ALERT (USA), PHONE #1-800-227-2600, TWO WORKING DAYS BEFORE DIGGING. NO CONSTRUCTION PERMIT WILL BE ISSUED BY THE PUBLIC WORKS DEPARTMENT INVOLVING EXCAVATION FOR UNDERGROUND FACILITIES UNLESS THE APPLICANT HAS BEEN PROVIDED AN INQUIRY IDENTIFICATION NUMBER BY U.S.A.
- CONTRACTOR IS TO VERIFY EXISTING SEWER ELEVATION PRIOR TO CONSTRUCTION.
- LOCATION OF LATERALS TO BE DETERMINED IN THE FIELD AT THE DIRECTION OF THE OWNER. AVOID CONFLICT WITH PROPOSED AND/OR EXISTING FACILITIES.
- NO FINISHED FLOOR ELEVATION SHALL BE LESS THAN 6" ABOVE THE UPPER MANHOLE RIM ELEVATION OF THE SEWER LINE SEGMENT BEING CONNECTED TO, WITHOUT HAVING A PROPER BACKWATER VALVE INSTALLED IN THE LATERAL.
- A PLUG SHALL BE INSTALLED AND WILL REMAIN IN PLACE WHERE THE NEW SEWER CONNECTS WITH THE EXISTING SEWER UNTIL THE NEW SEWER IS ACCEPTED BY THE CITY.
- THE SEWER CONTRACTOR SHALL ADJUST MANHOLES TO FINAL GRADE AFTER PAVING IS COMPLETED.
- PIPE BEDDING SHALL BE CASE I PER CITY STD. DWG. NO. 452 UNLESS OTHERWISE SHOWN ON THE PLANS. IF GROUND WATER IS ENCOUNTERED, BEDDING SHALL BE CASE III IN ACCORDANCE WITH NOTE 2, CITY STD. DWG. NO. 452.

CONSTRUCTION NOTES

QUANTITIES

- | | |
|--|--------|
| ① CONSTRUCT 4" MANHOLE PER CITY STD. NO. 500 | 2 EA. |
| ② CONSTRUCT 8" VCP SEWER | 286 LF |
| ③ INSTALL 4" SEWER SERVICE WITH PROPERTY LINE CLEANOUT PER CITY STD. PLAN 562A | 7 EA. |
| ④ INSTALL BACKFLOW VALVE | 3 EA. |

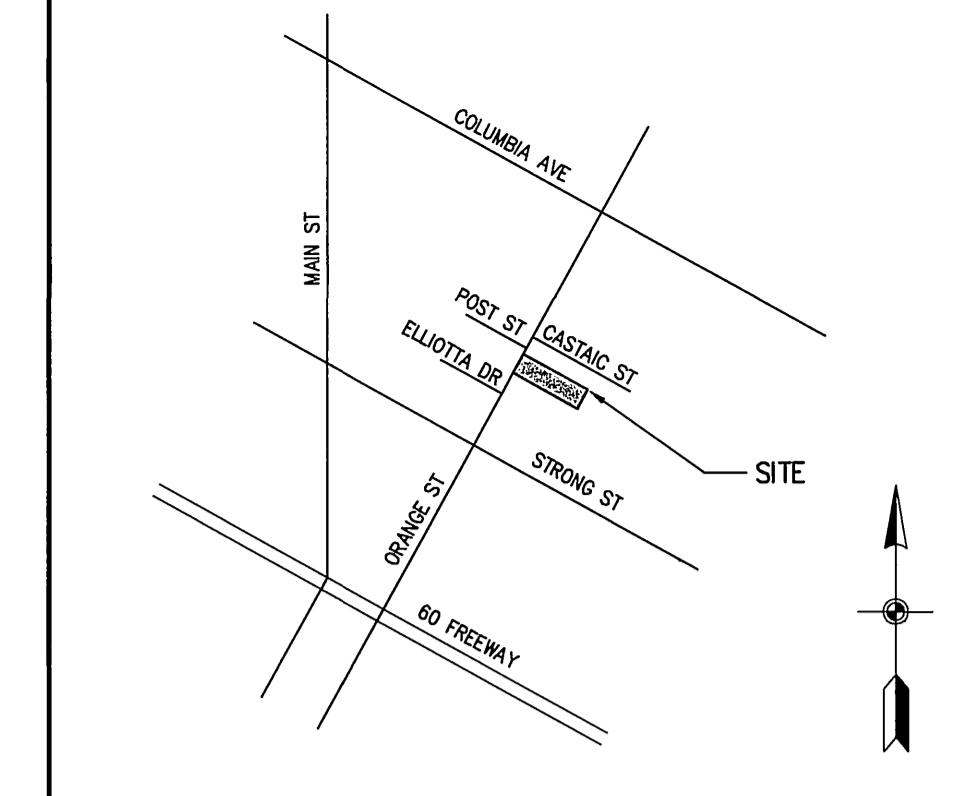
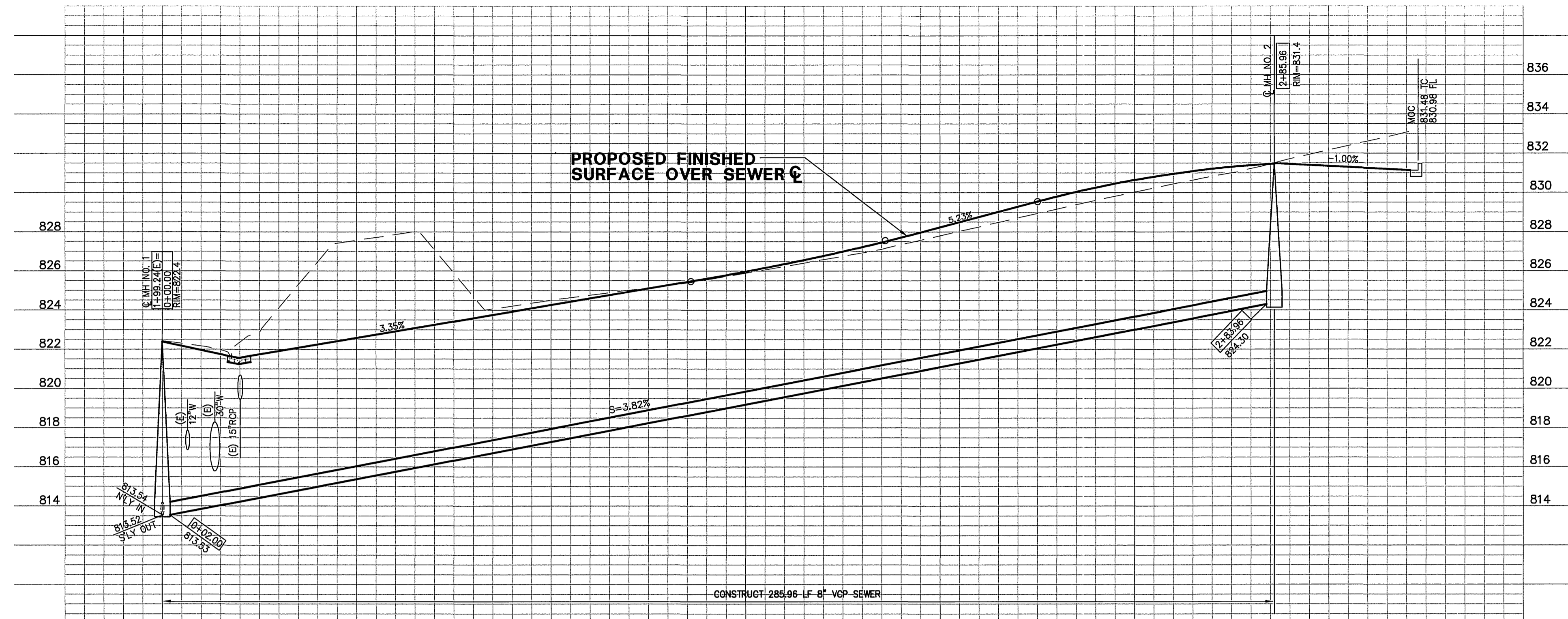

VICINITY MAP

NTS

SCALE
HORZ. 1"=20'
VERT. 1"=4'

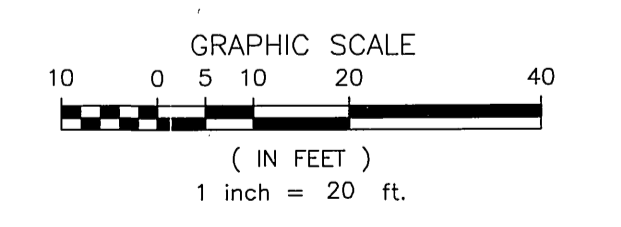
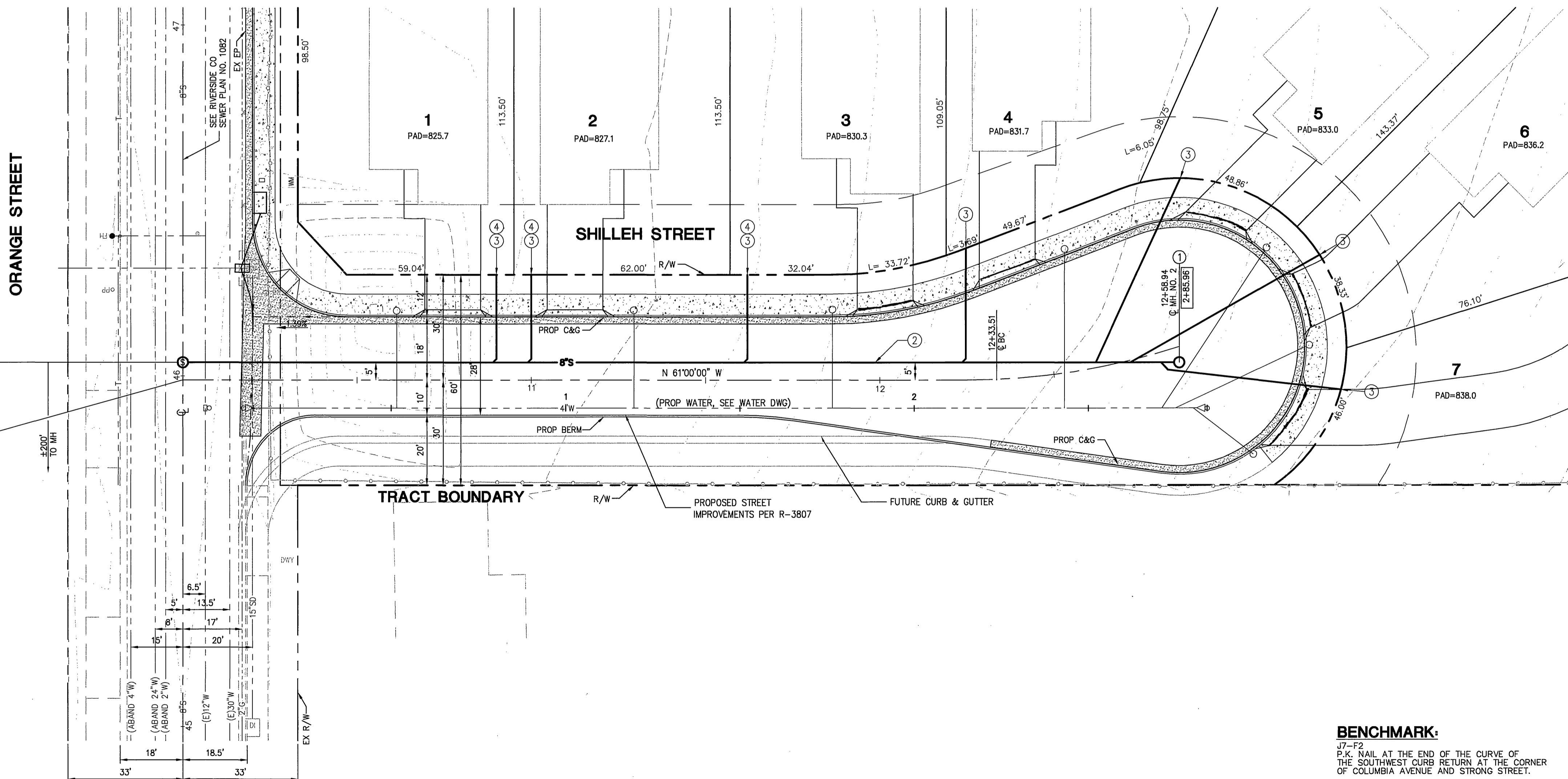

BENCHMARK:
J7-F2
P.K. NAIL AT THE END OF THE CURVE OF THE SOUTHWEST CURB RETURN AT THE CORNER OF COLUMBIA AVENUE AND STRONG STREET.
ELEVATION=827.25'

CITY OF RIVERSIDE
PUBLIC UTILITIES DEPARTMENT
WATER DIVISION

APPROVED BY: *MW McLea*
DATE: 7/11/05

PREPARED BY:
FES INC.
FORKERT ENGINEERING AND SURVEYING, INC.
22311 BROOKHURST ST., STE. 1
HUNTINGTON BEACH, CA 92646
TEL: (714) 963-6793
FAX: (714) 963-7296
CITY OF RIVERSIDE BUS. CERTIFICATE #119711 EXP. DATE: 3/16/06

ENGINEER IN RESPONSIBLE CHARGE
Thomas M. Ruiz
THOMAS M. RUIZ
R.C.E. No. 58827 expires 12/31/06
DATE: 7/11/05



MARK	REVISIONS	APPR.	DATE

CITY OF RIVERSIDE, CALIFORNIA
PUBLIC WORKS DEPARTMENT
APPROVED BY: *[Signature]*
BY: *[Signature]* DATE: 7/11/05
APPROVED BY: *[Signature]*
CITY ENGINEER
DATE: 10/21/05

SEWER IMPROVEMENT FOR TRACT NO. 31825 SHILLEH STREET STA. 10+00.00 TO STA. 12+58.56
HORIZONTAL SCALE: 1"=20' VERTICAL SCALE: 1"=4'
WDID# 833C331920
PH# 04-0277
S-1854
SHEET 1 OF 1
INDEXED 12-23-05

07/08/05 F:\AZ7A\729-Comp\SL\SEWER.dwg