

GENERAL NOTES 13+00

- NO PERSON SHALL PERFORM ANY CONSTRUCTION ACTIVITY OR INSTALL ANY OBJECTS WITHIN THE PUBLIC RIGHT-OF-WAY OR EASEMENTS OF THE CITY OF RIVERSIDE WITHOUT A VALID CONSTRUCTION PERMIT OR, A STREET OPENING PERMIT, OR AN ENCROACHMENT PERMIT ISSUED BY THE CITY'S PUBLIC WORKS DEPARTMENT.
- IT SHALL BE THE RESPONSIBILITY OF THE CONTRACTOR TO CLEAR THE RIGHT OF WAY IN ACCORDANCE WITH THE PROVISIONS OF LAW AS IT AFFECTS EACH UTILITY INCLUDING IRRIGATION LINES AND APPURTENANCES AND AT NO COST TO THE CITY.
- CONSTRUCTION SHALL BE IN ACCORDANCE WITH THE CITY OF RIVERSIDE DEPARTMENT OF PUBLIC WORKS, STANDARD DRAWINGS, ITS SUPPLEMENTAL NOTES AND THE STANDARD SPECIFICATIONS FOR PUBLIC WORKS CONSTRUCTION, CURRENT EDITION.
- THE PRIVATE ENGINEER SIGNING THESE PLANS IS RESPONSIBLE FOR ASSURING THE ACCURACY AND ACCEPTABILITY OF THE WORK HEREON. IN THE EVENT OF DISCREPANCIES ARISING DURING CONSTRUCTION, THE PRIVATE ENGINEER SHALL BE RESPONSIBLE FOR DETERMINING AN ACCEPTABLE SOLUTION AND REVISING THE PLANS FOR APPROVAL BY THE CITY.
- QUANTITIES SHOWN ARE FOR INFORMATION ONLY AND THE CITY OF RIVERSIDE IS NOT RESPONSIBLE FOR THEIR ACCURACY.
- THE DEVELOPER SHALL BE RESPONSIBLE FOR PRESERVING OR RE-ESTABLISHING AND REFERENCING SURVEY MONUMENTS DESTROYED, DISTURBED, OR BURIED AS A RESULT OF CONSTRUCTION SHOWN HEREON.
- ALL FLAGGED ELEVATIONS SHALL BE STAKED IN THE FIELD BY THE PRIVATE ENGINEER.
- THE CONTRACTOR SHALL CALL IN A LOCATION REQUEST TO UNDERGROUND SERVICE ALERT (USA), PHONE # 1-800-227-2860, TWO WORKING DAYS BEFORE DIGGING. NO CONSTRUCTION PERMIT WILL BE ISSUED BY THE PUBLIC WORKS DEPARTMENT INVOLVING EXCAVATION FOR UNDERGROUND FACILITIES UNLESS THE APPLICANT HAS BEEN PROVIDED AN INQUIRY IDENTIFICATION NUMBER BY USA.

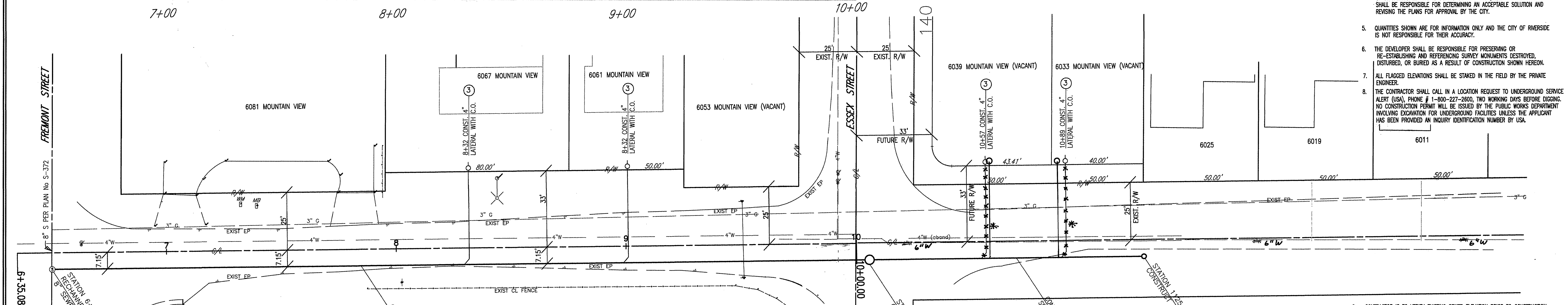

MOUNTAIN VIEW AVENUE

CONSTRUCTION NOTES AND QUANTITY ESTIMATES:

- CONSTRUCT SEWER MANHOLE PER CITY OF RIVERSIDE STANDARD DRAWING # 500. 1 EA.
- INSTALL 8" P.V.C. SDR 35 GREEN SEWER MAIN & PIPE BEDDING CASE I PER CITY OF RIVERSIDE STD. DRAWING #452. 473 L.F.
- INSTALL 4" SEWER LATERAL WITH P.L. CLEANOUT PER CITY OF RIVERSIDE STD. DWG. 562A. 164 L.F.
- CONSTRUCT SEWER CLEANOUT PER CITY OF RIVERSIDE STANDARD DRAWING # 560. 1 EA.

BENCHMARK: H4-C3
P/K. NAIL AND CITY ENGINEER TAG IN THE BASE OF A TRAFFIC SIGNAL AT THE NORTHWEST CURB RETURN OF JURUPA AVENUE AND FREMONT STREET. (THE RETURN BETWEEN FREMONT ST. AND COLUMBUS ST.)
ELEV. - 790.277

DIGALERT
DIAL BEFORE YOU DIG
TWO WORKING DAYS BEFORE YOU DIG
TOLL FREE 1-800-227-2860
A PUBLIC SERVICE BY UNDERGROUND SERVICE ALERT

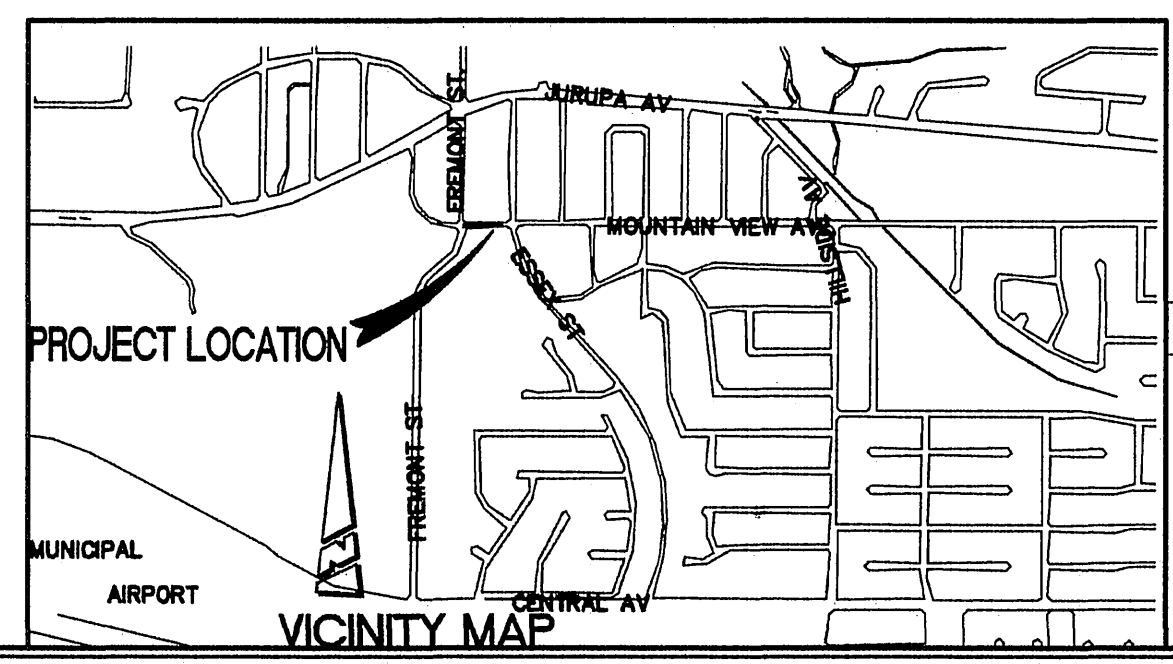

REGISTERED PROFESSIONAL ENGINEER
ESSEX & ESCATE
No. 21884
Exp. 9-30-05
CIVIL
STATE OF CALIFORNIA

SCALE: 1"=20'
10 20 40 60 80

CITY BUSINESS TAX CERT NO. 110958, EXP DATE 4/14/05

WATER

ESGATE ENGINEERING
3351 PACHAPPA HILL
RIVERSIDE, CALIFORNIA 92506
(951) 313-2058
PLANS PREPARED UNDER SUPERVISION OF
[Signature]
Date 12-18-2004 R.C.E. 21884 (EXP. 9-30-05)

APPROVED BY
[Signature]
WATER ENGINEERING MM
DATE: 12/20/2004

MARK	REVISIONS	APPR.	DATE

DESIGNED BY _____ DRAWN BY _____ CHECKED BY _____

CITY OF RIVERSIDE, CALIFORNIA
PUBLIC WORKS DEPARTMENT

APPROVED BY _____ BY DATE _____ APPROVED BY _____
PRINCIPAL ENGINEER
STREET SERVICES
TRAFFIC DIVISION
DATE 12/23/04

***AS-BUILT 9-27-05 LHM**

SEWER IMPROVEMENT PLANS	PW04-0854
MOUNTAIN VIEW AVENUE	S-1876
ESSEX STREET TO FREMONT STREET	SHEET 1 OF 1
HORIZ. SCALE: 1" = 20'	VERT. SCALE: 1" = 2'

INDEXED 1-04-05 LHM