

# ON-SITE SEWER PLAN

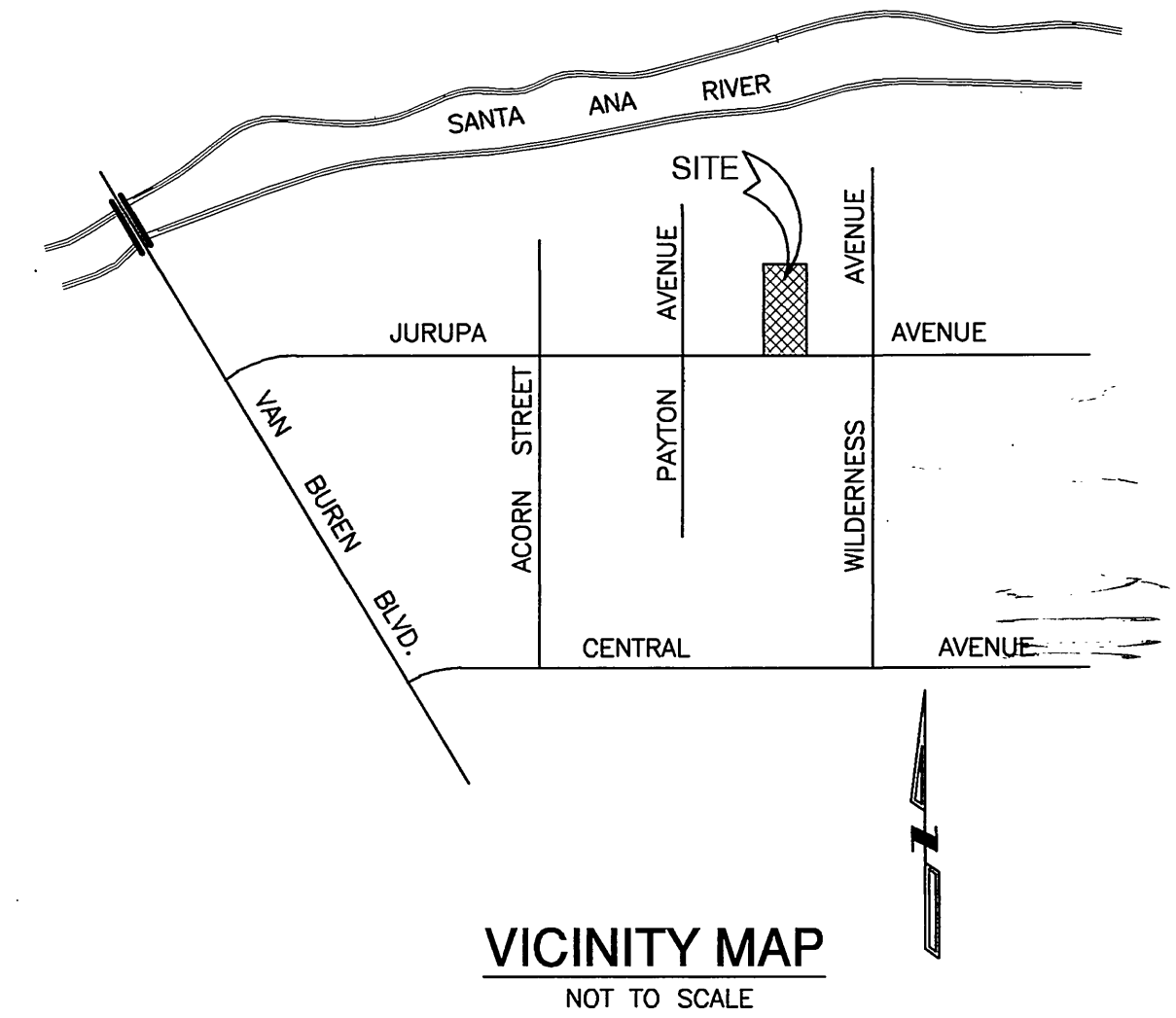

VICINITY MAP  
NOT TO SCALE

## GENERAL NOTES:

- NO PERSON SHALL PERFORM ANY CONSTRUCTION ACTIVITY OR INSTALL ANY OBJECTS WITHIN THE PUBLIC RIGHTS-OF-WAY OR EASEMENTS OF THE CITY OF RIVERSIDE WITHOUT A VALID CONSTRUCTION PERMIT OR A STREET OPENING PERMIT OR AN ENCROACHMENT PERMIT ISSUED BY THE CITY'S PUBLIC WORKS DEPARTMENT.
- IT SHALL BE THE RESPONSIBILITY OF THE CONTRACTOR TO CLEAR THE RIGHT OF WAY IN ACCORDANCE WITH THE PROVISIONS OF LAW AS IT AFFECTS EACH UTILITY INCLUDING IRRIGATION LINES AND APPURTENANCES AND AT NO COST TO THE CITY.
- CONSTRUCTION SHALL BE IN ACCORDANCE WITH THE CITY OF RIVERSIDE DEPARTMENT OF PUBLIC WORKS, STANDARD DRAWINGS, ITS SUPPLEMENTAL NOTES AND THE STANDARD SPECIFICATIONS FOR PUBLIC WORKS CONSTRUCTION, CURRENT EDITION.
- THE PRIVATE ENGINEER SIGNING THESE PLANS IS RESPONSIBLE FOR ASSURING THE ACCURACY AND ACCEPTABILITY OF THE WORK HEREON. IN THE EVENT OF DISCREPANCIES ARISING DURING CONSTRUCTION, THE PRIVATE ENGINEER SHALL BE RESPONSIBLE FOR DETERMINING AN ACCEPTABLE SOLUTION AND REVISING THE PLANS FOR APPROVAL BY THE CITY.
- QUANTITIES SHOWN ARE FOR INFORMATION ONLY AND THE CITY OF RIVERSIDE IS NOT RESPONSIBLE FOR THEIR ACCURACY.
- THE DEVELOPER SHALL BE RESPONSIBLE FOR THE PRESERVING OR RE-ESTABLISHING AND REFERENCING SURVEY MONUMENTS DESTROYED, DISTURBED OR BURIED AS A RESULT OF CONSTRUCTION SHOWN HEREON.
- ALL FLAGGED ELEVATIONS SHALL BE STAKED IN THE FIELD BY THE PRIVATE ENGINEER.
- ANY TRAFFIC CONTROL STRIPING OBLITERATED AND/OR BADLY WORN DURING CONSTRUCTION SHALL BE RESTORED BY THE CONTRACTOR WITHIN FIVE DAYS AFTER NOTIFICATION FROM THE CITY INSPECTORS.
- FINAL STRIPING FOR TRAFFIC CONTROL AND/OR PAVEMENT MARKING TO BE THE RESPONSIBILITY OF THE DEVELOPER.
- THE CONTRACTOR SHALL CALL IN A LOCATION REQUEST TO UNDERGROUND SERVICE ALERT (USA), PHONE # 1-800-227-2600, TWO WORKING DAYS BEFORE DIGGING. NO CONSTRUCTION PERMIT WILL BE ISSUED BY THE PUBLIC WORKS DEPARTMENT INVOLVING EXCAVATION FOR UNDERGROUND FACILITIES UNLESS THE APPLICANT HAS BEEN PROVIDED AN INQUIRY IDENTIFICATION NUMBER BY U.S.A.
- CONTRACTOR IS TO VERIFY EXISTING SEWER ELEVATION PRIOR TO CONSTRUCTION.
- LOCATION OF LATERALS TO BE DETERMINED IN THE FIELD AT THE DIRECTION OF THE OWNER. AVOID CONFLICT WITH PROPOSED AND/OR EXISTING FACILITIES.
- NO FINISHED FLOOR ELEVATION SHALL BE LESS THAN 6" ABOVE THE UPPER MANHOLE RIM ELEVATION OF THE SEWER LINE SEGMENT BEING CONNECTED TO, WITHOUT HAVING PROPER BACKWATER VALVE INSTALLED IN THE LATERAL.
- A PLUG SHALL BE INSTALLED AND WILL REMAIN IN PLACE WHERE THE NEW SEWER CONNECTS WITH THE EXISTING SEWER UNTIL THE NEW SEWER IS ACCEPTED BY THE CITY.
- THE SEWER CONTRACTOR SHALL ADJUST MANHOLE & CLEAN OUTS TO FINAL GRADE AFTER PAVING IS COMPLETED.

## ENGINEERS NOTES TO CONTRACTORS

THE EXISTENCE AND LOCATION OF ANY UNDERGROUND UTILITY PIPES OR STRUCTURES SHOWN ON THIS PLAN ARE OBTAINED BY SEARCH OF AVAILABLE RECORDS, TO THE BEST OF OUR KNOWLEDGE, THERE ARE NO EXISTING UTILITIES EXCEPT AS SHOWN ON THESE PLANS. THE CONTRACTOR IS REQUIRED TO TAKE DUE PRECAUTIONARY MEASURES TO PROTECT THE UTILITIES SHOWN AND ANY OTHER LINES OR STRUCTURES NOT SHOWN ON THESE PLANS.

ALL CONTRACTORS AND SUBCONTRACTORS PERFORMING WORK SHOWN ON OR RELATED TO THESE PLANS SHALL CONDUCT THEIR OPERATIONS SO THAT ALL EMPLOYEES ARE PROVIDED A SAFE PLACE TO WORK AND THE PUBLIC IS PROTECTED. ALL CONTRACTORS AND SUBCONTRACTORS SHALL COMPLY WITH THE "OCCUPATIONAL SAFETY AND HEALTH REGULATIONS" OF THE U.S. DEPARTMENT OF LABOR, AND THE STATE OF CALIFORNIA DEPARTMENT OF INDUSTRIAL RELATIONS, "CONSTRUCTION SAFETY ORDERS."

THE CIVIL ENGINEER SHALL NOT BE RESPONSIBLE IN ANY WAY FOR THE CONTRACTORS AND SUBCONTRACTORS' COMPLIANCE WITH THE "OCCUPATIONAL SAFETY AND HEALTH REGULATIONS" OF THE U.S. DEPARTMENT OF LABOR OR WITH THE STATE OF CALIFORNIA DEPARTMENT OF INDUSTRIAL RELATIONS, "CONSTRUCTION SAFETY ORDERS."

CONTRACTOR FURTHER AGREES THAT HE SHALL HAVE SOLE AND COMPLETE RESPONSIBILITY FOR JOB SITE CONDITIONS DURING THE COURSE OF CONSTRUCTION OF THIS PROJECT, INCLUDING SAFETY OF ALL PERSONS AND PROPERTY; THAT THIS REQUIREMENT SHALL APPLY CONTINUOUSLY AND NOT BE LIMITED TO NORMAL WORKING HOURS; AND THAT THE CONTRACTOR SHALL DEFEND, INDEMNIFY AND HOLD THE OWNER AND THE ENGINEER HARMLESS FROM ANY AND ALL LIABILITY, REAL OR ALLEGED, IN CONNECTION WITH THE PERFORMANCE OF WORK ON THIS PROJECT, EXCEPTING FOR LIABILITY ARISING FROM THE SOLE NEGLIGENCE OF THE OWNER OR THE ENGINEER.

## UNAUTHORIZED CHANGES AND USES:

THE ENGINEER PREPARING THESE PLANS WILL NOT BE RESPONSIBLE FOR, OR LIABLE FOR, UNAUTHORIZED CHANGES TO OR USES OF THESE PLANS. ALL CHANGES TO THE PLANS MUST BE IN WRITING AND MUST BE APPROVED BY THE PREPARER OF THESE PLANS.

## OWNER:

MIKE BROWN  
5225 CANYON CREST DRIVE, #71-332  
RIVERSIDE, CA 92507  
(909) 731-3750

## CIVIL ENGINEER:

SOUTHLAND ENGINEERING  
2200 BUSINESS WAY, Ste. 100  
RIVERSIDE, CA 92501  
(951) 788-8488

## ASSESSOR'S PARCEL NUMBERS:

189-140-012

## LEGAL DESCRIPTION:

PARCEL MAP NO. 31398 RECORDED IN BOOK 214 OF PARCEL MAPS, PAGES 10 THROUGH 12, RECORDS OF RIVERSIDE COUNTY, CALIFORNIA

## BASIS OF BEARINGS

THE BASIS OF BEARINGS FOR THIS PROJECT IS THE CENTERLINE OF JURUPA AVENUE PER PARCEL MAP NO. 22082, BOOK 78, PAGES 2 AND 3. RIVERSIDE COUNTY RECORDS. BEING N82°59'43"E

## CONSTRUCTION NOTES:

- \*CONSTRUCT 8" VCP SEWER LINE \_\_\_\_\_ 702 LF
- CONSTRUCT PRECAST CONCRETE SEWER MANHOLE PER CITY OF RIVERSIDE STD. DWG. NO. 500 \_\_\_\_\_ 3 EA
- CONSTRUCT 3" SEWER LATERAL WITH CLEANOUT PER CITY OF RIVERSIDE DWG. NO. 562A \_\_\_\_\_ 14 EA
- CONSTRUCT TRENCH BACKFILL PER CITY OF RIVERSIDE STD. DWG. NO. 453 \_\_\_\_\_ 1,059 LF
- CONSTRUCT PIPE BEDDING, CASE II PER CITY OF RIVERSIDE DWG. NO. 452 \_\_\_\_\_ 1,059 LF
- CONSTRUCT CONCRETE ENCASUREMENT PER SECTION "A-A" \_\_\_\_\_ 302 LF
- CONSTRUCT 8"x3" WYE \_\_\_\_\_ 14 EA

\*ALTERNATE PIPE 8" SDP 36

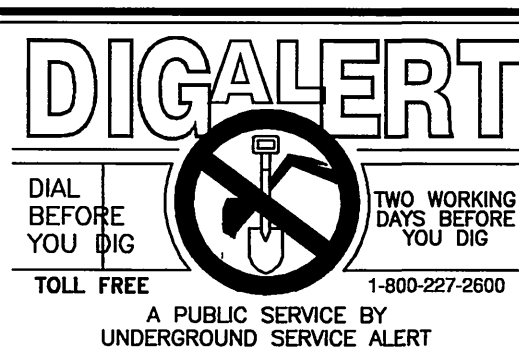

CITY TAX CERTIFICATE NO. 027049 EXP. 1-25-06

<b>BENCHMARK:</b> H4-63 DATE LVID: 1997 P.K. NAIL AND CITY ENGINEER TAG IN THE TOP OF A CATCH BASIN ALONG THE SOUTHERLY CURB OF JURUPA AVENUE, 80 FEET EASTERLY OF PAYTON AVENUE. LEVELED AS PART OF THE LANDFILL BORROW SITE PROJECT. ELEVATION: 758.910	CITY OF RIVERSIDE WATER DIVISION APPROVED BY: <i>R.W. McNeil</i> DATE: <i>9/23/05</i>	Southland Engineering 2200 BUSINESS WAY, Ste. 100 RIVERSIDE, CA 92501 (951) 788-8488 PREPARED UNDER THE SUPERVISION OF <i>Allen W. Martin</i> 9-22-05 ALLEN W. MARTIN R.C.E. 38463 EXP. 3-31-07	CITY OF RIVERSIDE PUBLIC WORKS DEPARTMENT APPROVED BY: <i>[Signature]</i> PRINCIPAL ENGINEER DATE: <i>9/23/05</i> APPROVED BY: <i>[Signature]</i> CITY ENGINEER DATE: <i>9/23/05</i>	SEWER IMPROVEMENT PLAN P.M. 31398 <b>TITLE SHEET</b> HORIZ. SCALE: 1" = 100' INDEXED 10-12-05 Lft	ACCOUNT NO. <b>PW05-0784</b>
					SHEET <b>1</b> OF <b>2</b> 22145

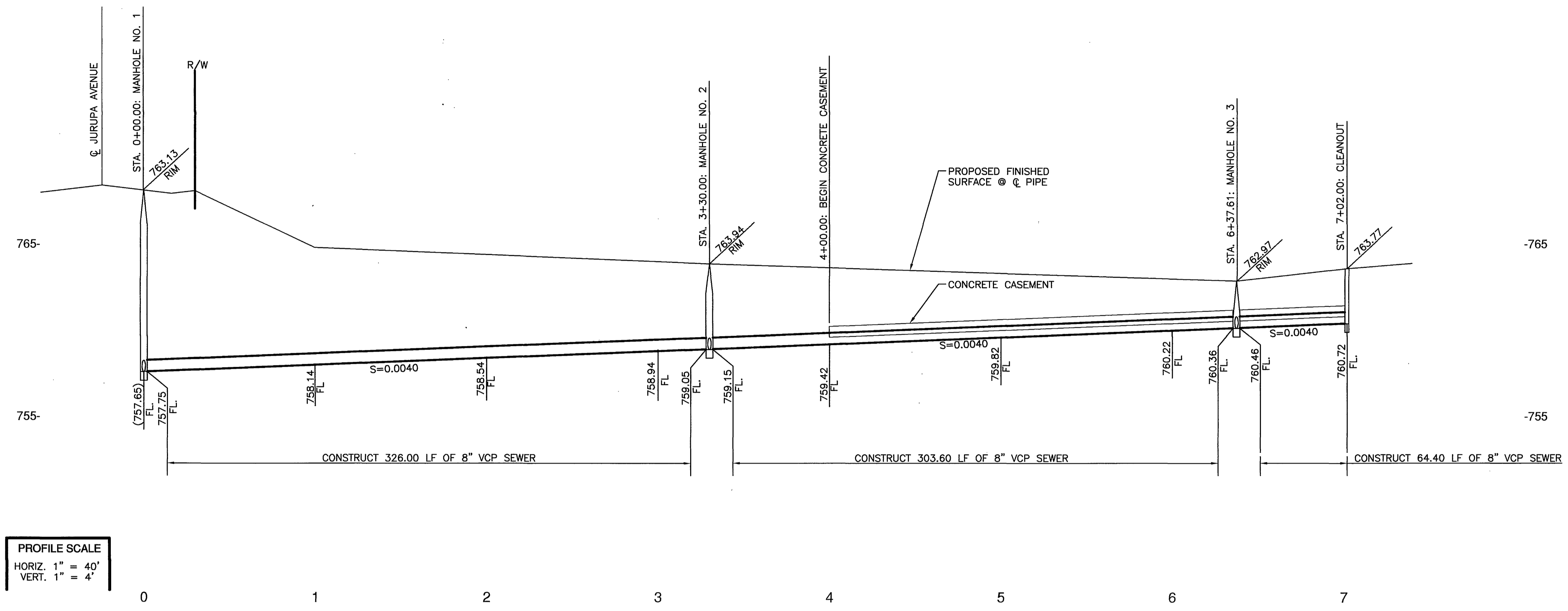

**PROFILE SCALE**  
 HORIZ. 1" = 40'  
 VERT. 1" = 4'

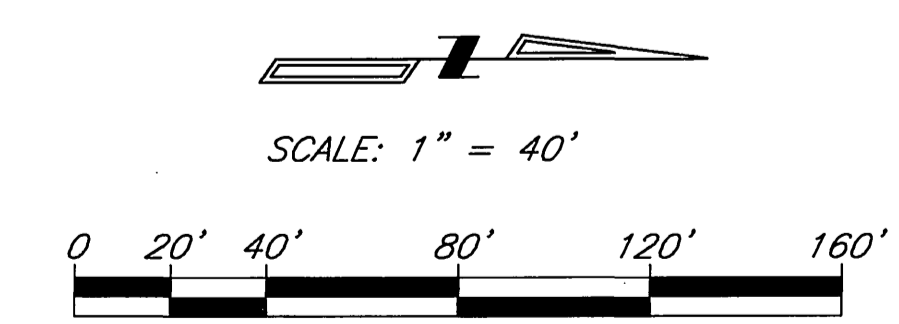
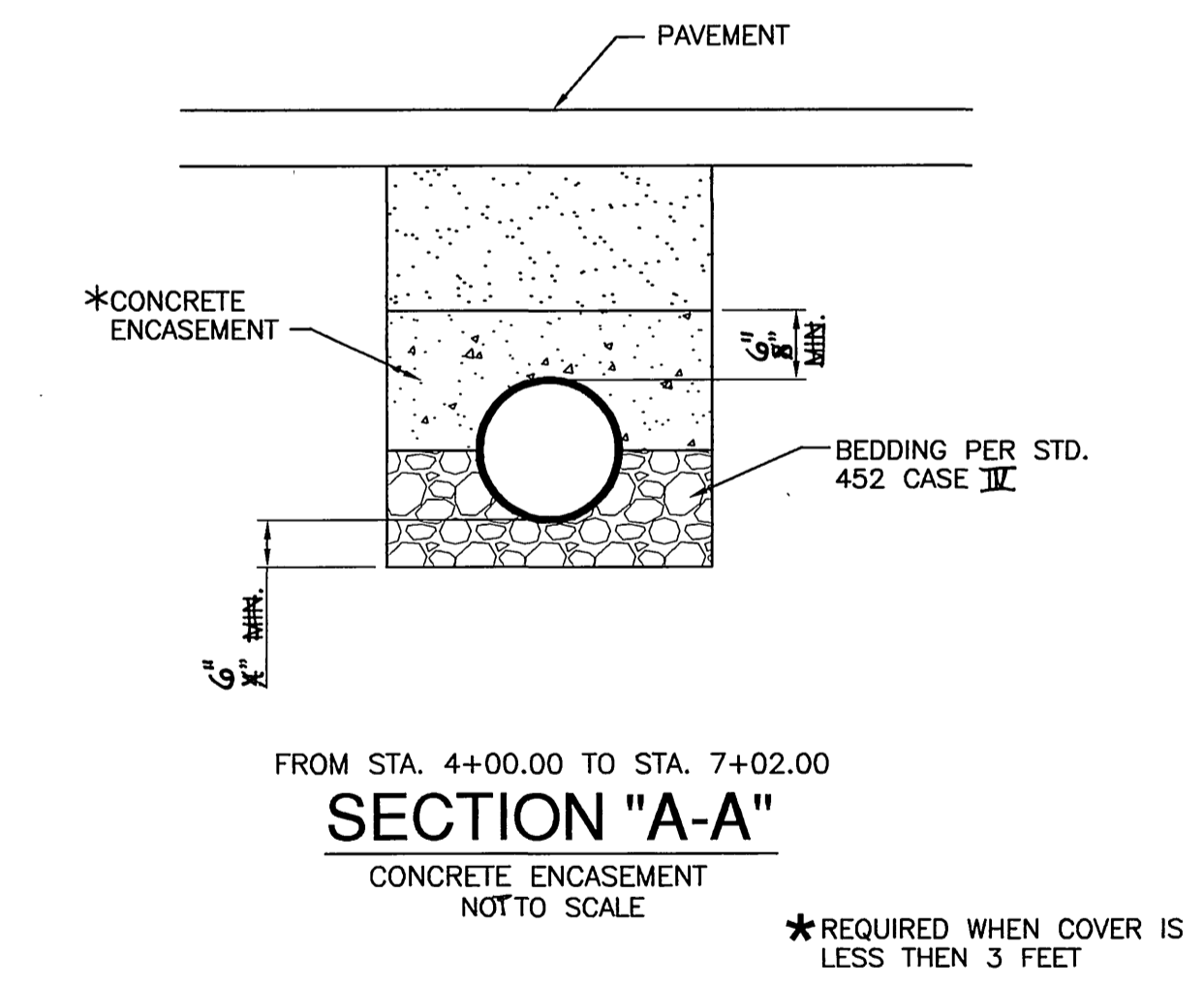
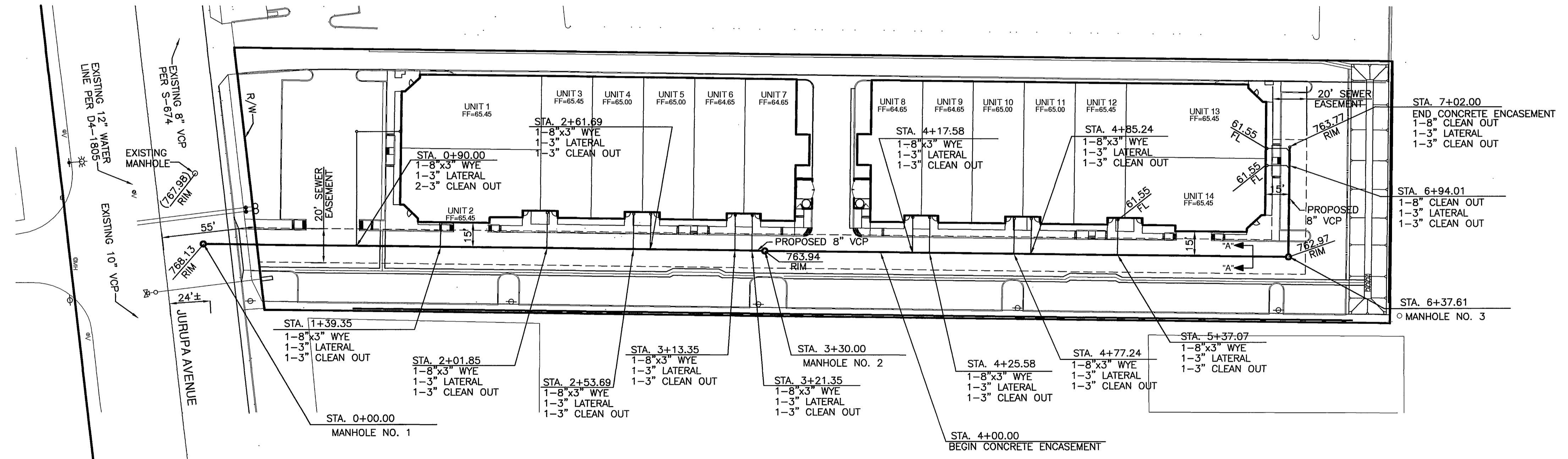

CITY TAX CERTIFICATE NO. 027049 EXP. 1-25-06

**BENCHMARK:** H4-63 **DATE LVID:** 1997  
 P.K. NAIL AND CITY ENGINEER TAG IN THE TOP OF A CATCH BASIN ALONG THE SOUTHERLY CURB OF JURUPA AVENUE, 80 FEET EASTERLY OF PAYTON AVENUE. LEVELED AS PART OF THE LANDFILL BORROW SITE PROJECT.  
**ELEVATION:** 758.910

**Southland Engineering**  
 2200 BUSINESS WAY, Ste. 100  
 RIVERSIDE, CA. 92501  
 (951) 788-8488  
 PREPARED UNDER THE SUPERVISION OF  
 ALLEN W. MARTIN  
 R.C.E. 38463 EXP. 3-31-07

MARK	REVISIONS	APPR.	DATE

DESIGNED BY NU DRAWN BY NU CHECKED BY AM

**CITY OF RIVERSIDE**  
 PUBLIC WORKS DEPARTMENT  
 APPROVED BY DATE BY APPROVED BY  
 PRINCIPAL ENGINEER 9/2/05  
 PARK DEPARTMENT  
 TRAFFIC DIVISION  
 STREET SERVICES  
 DATE 7/2/05

**SEWER IMPROVEMENT PLAN**  
 PM 31398  
 PLAN AND PROFILE  
 FROM STA. 0+00.00 TO STA. 7+02.00  
 HORIZ. SCALE: 1" = 40' VERT. SCALE: 1" = 4'

**PW 05-0784**  
 ACCOUNT NO.  
**S-1927**  
**2** OF **2**  
 SHEET  
 W.O. 22145

22145 (sewer plan)

INDEXED 10-12-05 LPH