

GENERAL CONSTRUCTION NOTES:

- 1 EXISTING UTILITIES SHOWN ON THE PLAN, ARE PLOTTED FROM UTILITY RECORDS. THE CONTRACTOR IS REQUIRED TO TAKE DUE PRECAUTIONARY MEASURES TO LOCATE AND PROTECT ALL UTILITIES WHETHER OR NOT SHOWN ON THIS PLAN.
- 2 PRIME CONTRACTORS BIDDING THIS WORK SHALL HAVE A CLASS "A", "C-34", OR A "C-42" LICENSE.
- 3 ALL ELEVATIONS SHOWN ON THE PLANS SHALL BE STAKED IN THE FIELD.
- 4 CONSTRUCTION SHALL BE IN ACCORDANCE WITH THE CITY OF RIVERSIDE STANDARD DRAWINGS AND STANDARD SPECIFICATIONS FOR PUBLIC WORKS CONSTRUCTION, 2003 EDITION.

SPECIFIC CONSTRUCTION NOTES:

- 1 REMOVE EXISTING CURB RETURN, WHEELCHAIR RAMP & SIDEWALK AND RECONSTRUCT PER STANDARD DRAWINGS 200, TYPE I, 304, TYPE IV & 325.

CONSTRUCTION LEGEND:

NUMBERS ABOVE 100 IN A HEXAGON ON THE PLAN REFER TO THE RESPECTIVE STANDARD DRAWING AND SHALL BE CONSTRUCTED ACCORDINGLY, UNLESS MODIFICATIONS ARE NOTED ON THE PLAN. ANY NUMBER SHOWN BELOW THE STANDARD DRAWING NUMBER INDICATES THE SPECIFIC ALTERNATE TO BE CONSTRUCTED.

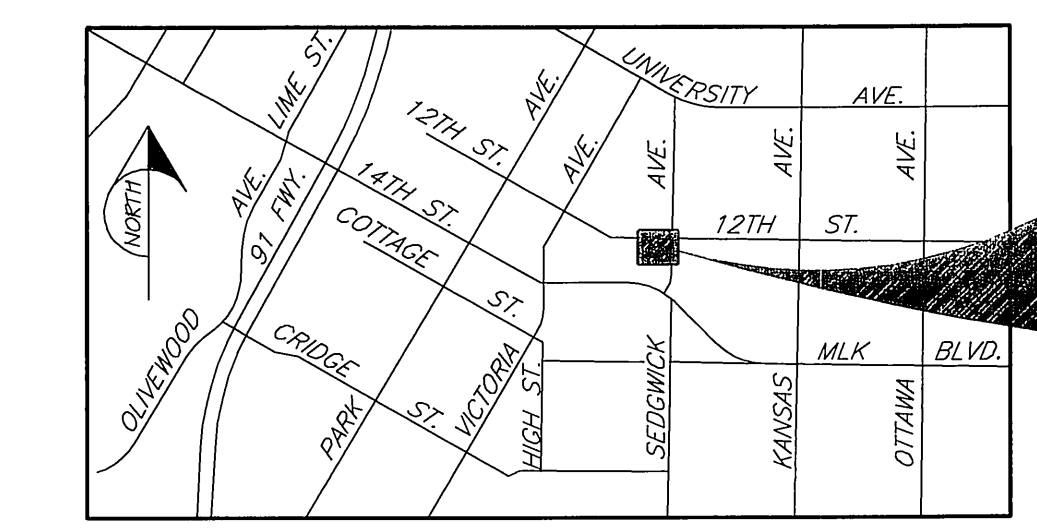

PROJECT LOCATION

BENCHMARK:

H7-D3
P.K. NAIL & CITY ENGINEER TAG IN THE TOP OF CURB, SOUTHWEST CURB RETURN AT KANSAS AVENUE AND TWELFTH STREET.
ELEV. - 929.257

PROJECT LOCATION MAP

NO SCALE

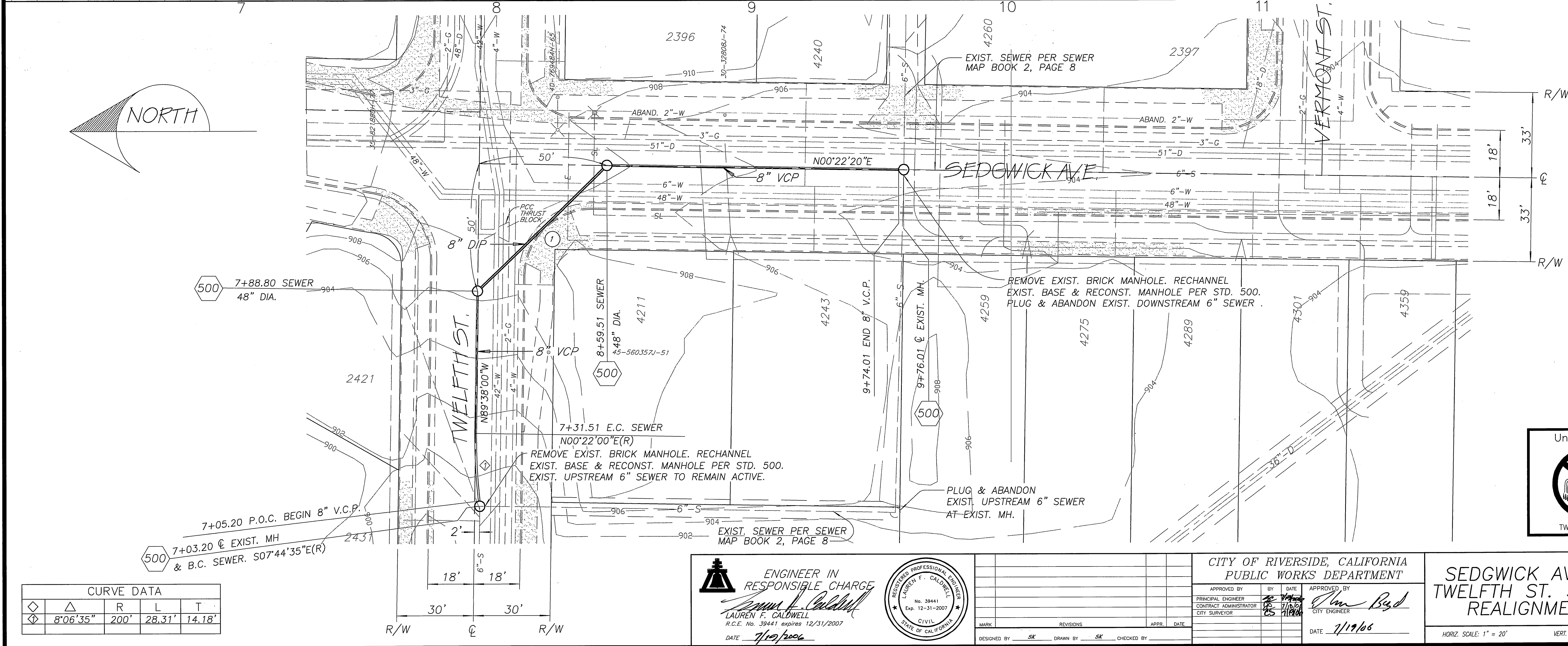

Underground Service Alert
CALL BEFORE YOU DIG
CALL: TOLL FREE
1-800
227-2600
TWO WORKING DAYS BEFORE YOU DIG

CURVE DATA

Curve	R	L	T
1	8'06'35"	200'	28.31', 14.18'

ENGINEER IN RESPONSIBLE CHARGE
Lauren F. Caldwell
LAUREN F. CALDWELL
R.C.E. No. 39441 expires 12/31/2007
DATE 7/19/06



CITY OF RIVERSIDE, CALIFORNIA
PUBLIC WORKS DEPARTMENT
APPROVED BY: [Signature]
PRINCIPAL ENGINEER: [Signature]
CONTRACT ADMINISTRATOR: [Signature]
CITY SURVEYOR: [Signature]
DATE: 7/19/06

SEDGWICK AVE. & TWELFTH ST. SEWER REALIGNMENT

ACCT. No. 9787823203-44030109
W0060924/03
S-1966
SHEET 1 OF 1
FILE NO.

HORIZ. SCALE: 1" = 20' VERT. SCALE: 1" = 4'

INDEXED 7-26-06 Lft