

970  
968  
966  
964

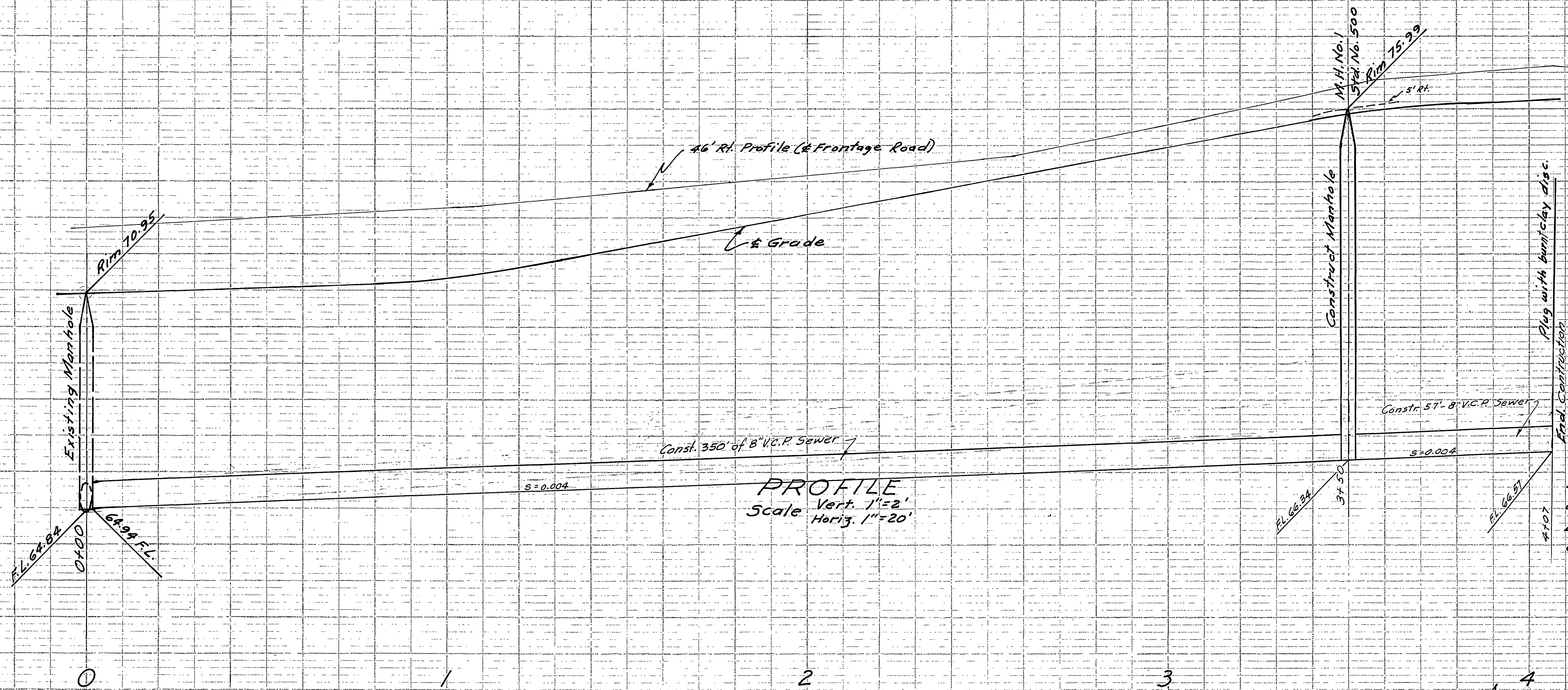

PROFILE  
Scale Vert. 1"=2'  
Horiz. 1"=20'

Bench Mark is spike in R.P. No. 2102-J,  
at ANNA ST. & VICTORIA AVE.  
Elev. 963.87  
City Engr. F.B. 439/7 6 644/39

976  
974  
972  
970  
968

PROFILE	DATE
PROJECT	
NO. 1	
STRUCTURE	

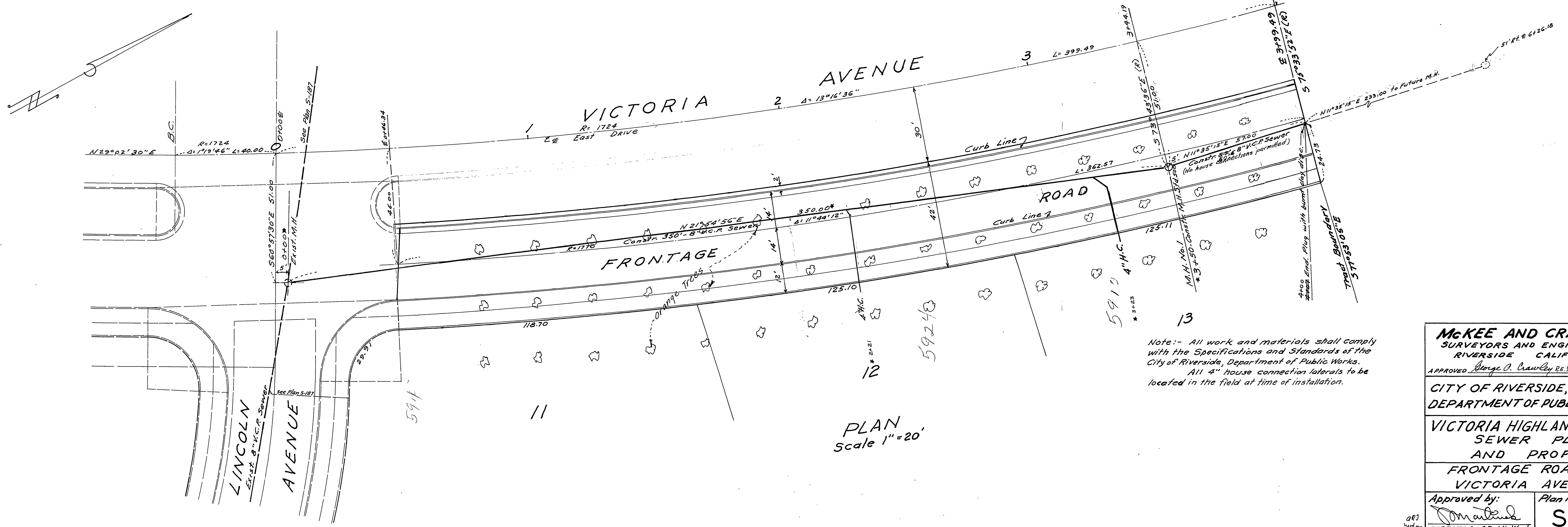

PLAN  
Scale 1"=20'

Note: - All work and materials shall comply with the Specifications and Standards of the City of Riverside, Department of Public Works.  
All 4" house connection laterals to be located in the field at time of installation.

**McKEE AND CRAWLEY**  
SURVEYORS AND ENGINEERS  
RIVERSIDE CALIFORNIA  
APPROVED *George O. Crawley* RE. PASS DATE 10-7-59  
CITY OF RIVERSIDE, CALIFORNIA  
DEPARTMENT OF PUBLIC WORKS  
VICTORIA HIGHLANDS UNIT #2  
SEWER PLAN  
AND PROFILE  
FRONTAGE ROAD (East)  
VICTORIA AVENUE

Approved by: *Donald*  
DIRECTOR of Public Works  
Date: Nov. 30, 1959  
Plan No. S-200  
Sheet 1 of 1

PLAN	DATE
PROJECT	
NO. 1	
STRUCTURE	

\* AS BUILT 3/30/60 B.L.O.W