

SECTION SHOWING EXISTING TUNNELS
No Scale

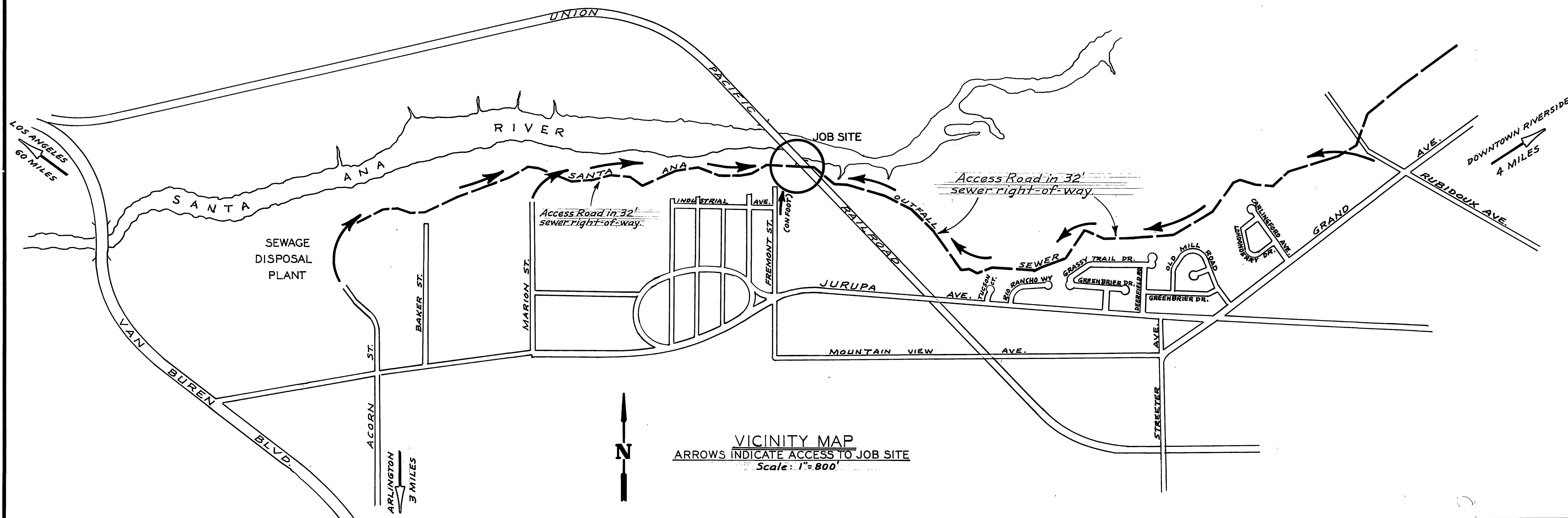
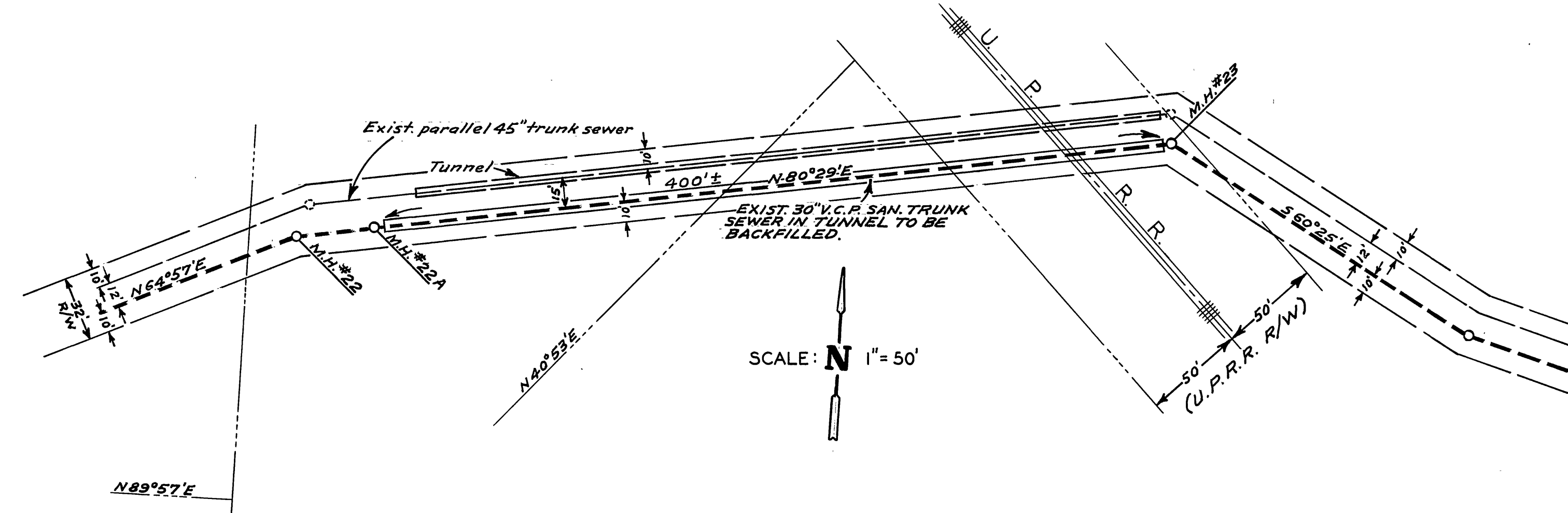
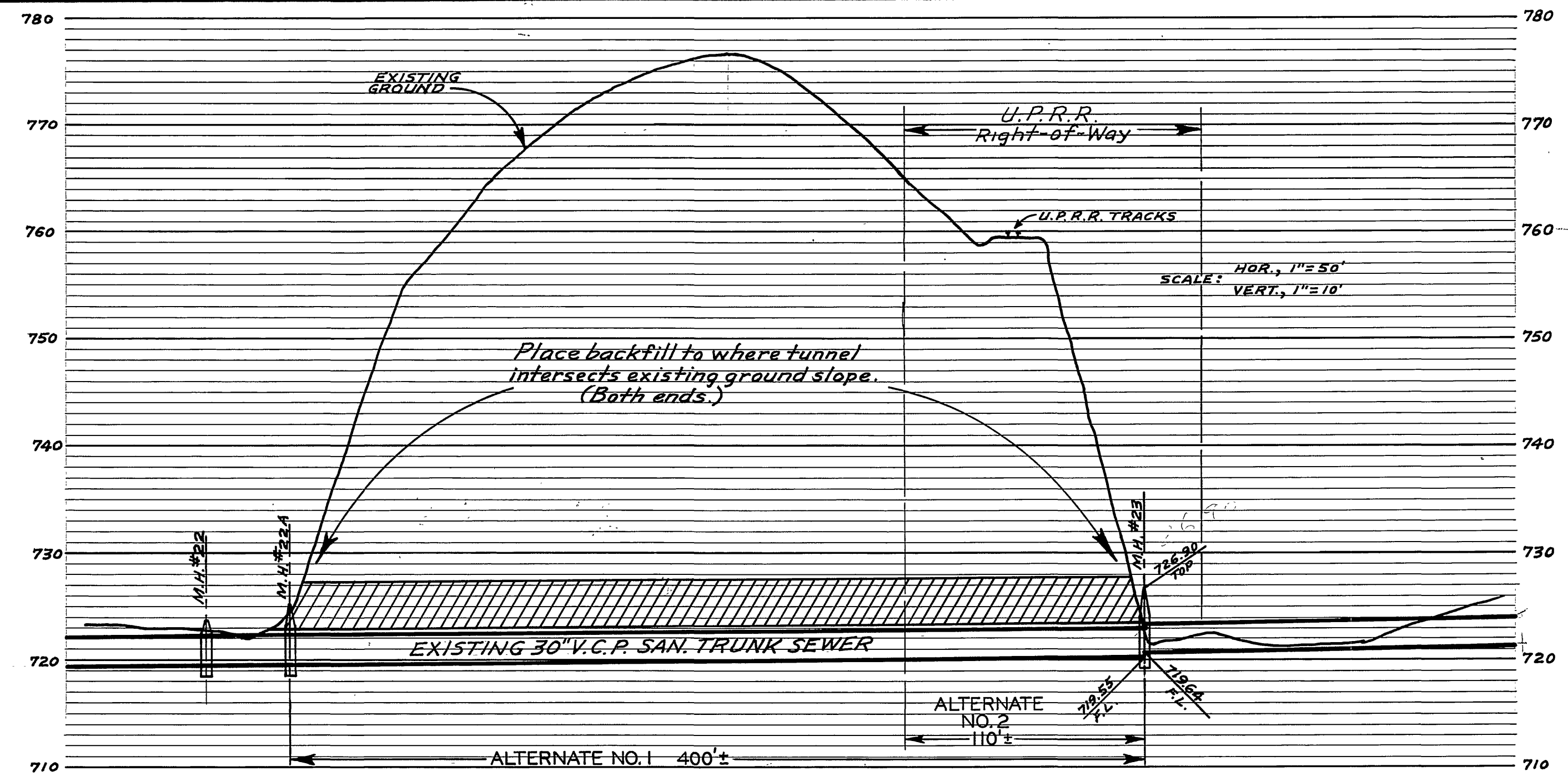

F.B. 622, 630
REF-DWG. S-101, SH. 5 & 15, & 1050

REVISIONS			CITY OF RIVERSIDE CALIFORNIA DEPARTMENT OF PUBLIC WORKS
MARK	DATE	DESCRIPTION	
			SANTA ANA OUTFALL TUNNEL BACKFILL UNDER UNION PACIFIC RAILROAD ACCOUNT NO. CC-1343-81-3
DESIGNED BY	CHECKED BY wdy	APPROVED BY	S-201 SHEET 1 OF 1
DRAWN BY H.Bell		<i>[Signature]</i> DIRECTOR OF PUBLIC WORKS	
DATE Nov. 24, 1959			