

PROFILE SCALES:
HORIZ. 1"=40'
VERT. 1"=4'

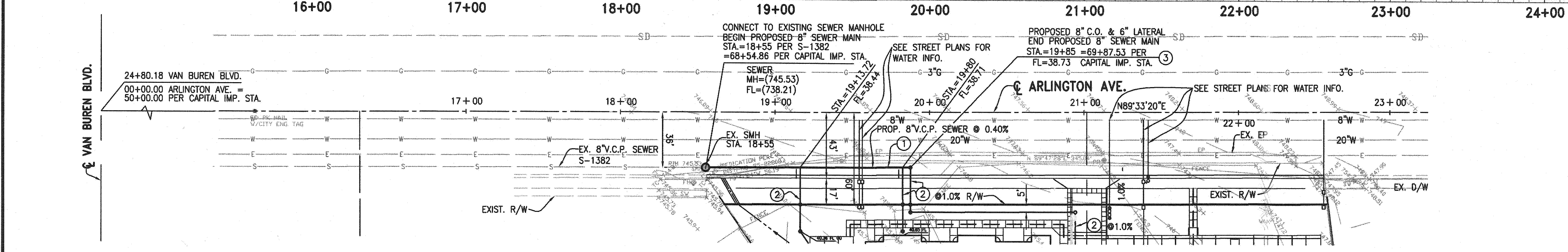

GENERAL NOTES

11. NO PERSON SHALL PERFORM ANY CONSTRUCTION ACTIVITY OR INSTALL ANY OBJECTS WITHIN THE PUBLIC RIGHT-OF-WAY OR EASEMENTS OF THE CITY OF RIVERSIDE WITHOUT A VALID CONSTRUCTION PERMIT OR, A STREET OPENING PERMIT OR AN ENCROACHMENT PERMIT ISSUED BY THE CITY'S PUBLIC WORKS DEPARTMENT.
22. IT SHALL BE THE RESPONSIBILITY OF THE CONTRACTOR TO CLEAR THE RIGHT OF WAY IN ACCORDANCE WITH THE PROVISIONS OF LAW AS IT AFFECTS EACH UTILITY INCLUDING IRRIGATION LINES AND APPURTENANCES AND AT NO COST TO THE CITY.
33. CONSTRUCTION SHALL BE IN ACCORDANCE WITH THE CITY OF RIVERSIDE DEPARTMENT OF PUBLIC WORKS, STANDARD DRAWINGS, ITS SUPPLEMENTAL NOTES AND THE STANDARD SPECIFICATIONS FOR PUBLIC WORKS CONSTRUCTION, CURRENT EDITION.
44. THE PRIVATE ENGINEER SIGNING THESE PLANS IS RESPONSIBLE FOR ASSURING THE ACCURACY AND ACCEPTABILITY OF THE WORK HEREON. IN THE EVENT OF DISCREPANCIES ARISING DURING CONSTRUCTION, THE PRIVATE ENGINEER SHALL BE RESPONSIBLE FOR DETERMINING AN ACCEPTABLE SOLUTION AND REVISING THE PLANS FOR APPROVAL BY THE CITY.
55. QUANTITIES SHOWN ARE FOR INFORMATION ONLY AND THE CITY OF RIVERSIDE IS NOT RESPONSIBLE FOR THEIR ACCURACY.
66. THE DEVELOPER SHALL BE RESPONSIBLE FOR PRESERVING OR RE-ESTABLISHING AND REFERENCING SURVEY MONUMENTS DESTROYED, DISTURBED OR BURIED AS A RESULT OF CONSTRUCTION SHOWN HEREON.
77. ALL FLAGGED ELEVATIONS SHALL BE STAKED IN THE FIELD BY THE PRIVATE ENGINEER.
88. THE CONTRACTOR SHALL CALL IN A LOCATION REQUEST TO UNDERGROUND SERVICE ALERT (USA), PHONE# 1-800-227-2600, TWO WORKING DAYS BEFORE DIGGING. NO CONSTRUCTION PERMIT WILL BE ISSUED BY THE PUBLIC WORKS DEPARTMENT INVOLVING EXCAVATION FOR UNDERGROUND FACILITIES UNLESS THE APPLICANT HAS BEEN PROVIDED AN INQUIRY IDENTIFICATION NUMBER BY U.S.A.
99. CONTRACTOR IS TO VERIFY EXISTING SEWER LOCATION PRIOR TO CONSTRUCTION.
110. LOCATION OF LATERALS TO BE DETERMINED IN THE FIELD AT THE DIRECTION OF THE OWNER. AVOID CONFLICT WITH PROPOSED AND/OR EXISTING FACILITIES.
111. NO FINISHED FLOOR ELEVATION SHALL BE LESS THAN 6" ABOVE THE UPPER MANHOLE RIM ELEVATION OF THE SEWER LINE SEGMENT BEING CONNECTED TO, WITHOUT HAVING A PROPER BACKWATER VALVE INSTALLED IN THE LATERAL.
112. A PLUG SHALL BE INSTALLED AND WILL REMAIN IN PLACE WHERE THE NEW SEWER CONNECTS WITH THE EXISTING SEWER UNTIL THE NEW SEWER IS ACCEPTED BY THE CITY.

ARLINGTON AVENUE

CONSTRUCTION NOTES AND QUANTITY ESTIMATE

THE QUANTITIES SHOWN BELOW ARE FOR BONDING INFORMATION ONLY. THE CONTRACTOR IS TO CONSTRUCT PROJECT PER THESE PLANS AND SUBMIT CONSTRUCTION BID BASED ON THEIR OWN QUANTITY "TAKE-OFF".

- ① CONSTRUCT 8" V.C.P. SEWER WITH CASE III BEDDING PER CITY STD. DWG. NO. 452 130 LF.
- ② CONSTRUCT 6" V.C.P. SEWER LATERAL WITH C.O. AT R/W PER CITY STD. DWG. 562A 72 LF., 3 EA.
- ③ CONSTRUCT MAINLINE CLEANOUT PER CITY STD. DWG. NO. 560 1 EA.

PIPE JOINTS FOR VITRIFIED CLAY PIPE SHALL BE TYPE "G"

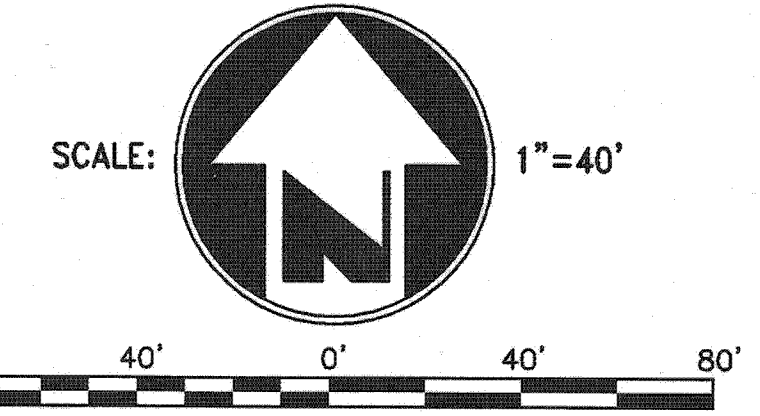

REFERENCE DRAWING
GRADING PLAN PW07-0184
STREET PLANS R-4061

T. 3 S., R. 5 W., SECTION 6
THOMAS GUIDE: PAGE 714, SECTION J-2

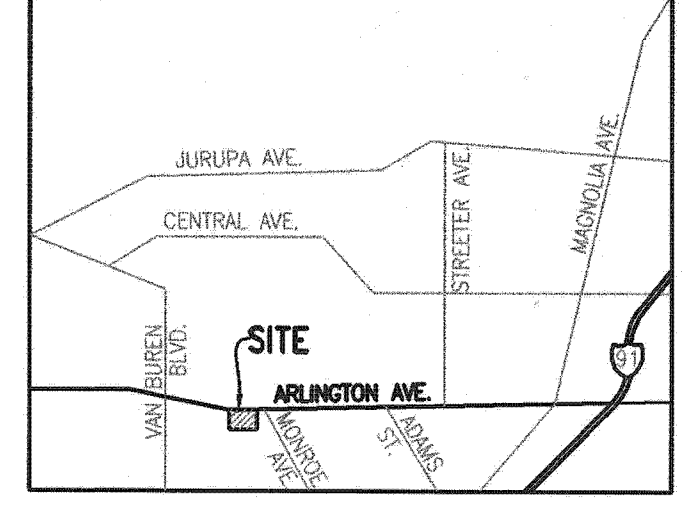

NOTICE TO CONTRACTORS:
THE EXISTENCE AND LOCATION OF UNDERGROUND UTILITY PIPES OR STRUCTURES SHOWN ON THIS PLAN, ARE OBTAINED BY A SEARCH OF THE AVAILABLE RECORDS. TO THE BEST OF OUR KNOWLEDGE THERE ARE NO EXISTING UTILITIES EXCEPT AS SHOWN ON THIS PLAN. THE CONTRACTOR IS REQUIRED TO TAKE PRECAUTIONARY MEASURES TO PROTECT THE UTILITY LINES NOT OF RECORD OR NOT SHOWN ON THIS PLAN.



CITY OF RIVERSIDE PUBLIC UTILITIES DEPARTMENT WATER DEPARTMENT APPROVED BY: <i>MW mcd</i> VOID ONE YEAR FROM THIS DATE	Underground Service Alert Call: TOLL FREE 1-800-227-2600 DATE: 1/18/08 TWO WORKING DAYS BEFORE YOU DIG	GABEL, COOK & ASSOCIATES INC. CIVIL ENGINEERS LAND SURVEYORS LAND PLANNERS 125 West La Cadena Drive, Suite A, Riverside, CA 92501 Telephone: (951) 788-8092 Facsimile: (951) 788-5184 <i>Craig A. Cook</i> 16 Jan 08 CRAIG A. COOK RCE 23323 EXP 12/31/09 DATE:	BENCHMARK: G3-F2 BRASS DISK AT THE INTERSECTION OF ARLINGTON AVE. & VAN BUREN BLVD. ELEV. = 736.332	CITY BUSINESS TAX CERTIFICATE NO. 012144 EXP. DATE 12-31-08		CITY OF RIVERSIDE, CALIFORNIA PUBLIC WORKS DEPARTMENT APPROVED BY: <i>[Signature]</i> DATE: 2/13/08 PRINCIPAL ENGINEER CITY ENGINEER	SEWER IMPROVEMENT PLANS 7010, 7020 & 7030 ARLINGTON AVE. PLAN AND PROFILE STA. 18+55 TO 21+25 SCALE: AS-NOTED DATE PREPARED: JANUARY 07 W.O. 2336	PW07-0183 S-2043 SHEET 1 OF 1
				DESIGNED BY: <i>LF</i> DRAWN BY: <i>MAC</i> CHECKED BY: <i>CAC</i>	DATE: 2/13/08			

N:\2336\Land Development\dwg\2336SEWER.dwg
 Wednesday, 16 January 2008 09:03am
 JOB FOLDER
 DRAWING NAME
 DATE PRINTED

INDEXED 2-15-08 LPH