

GENERAL NOTES:

- 1 EXISTING UTILITIES SHOWN ON THE PLAN ARE PLOTTED FROM UTILITY RECORDS. THE CONTRACTOR IS REQUIRED TO TAKE DUE PRECAUTIONARY MEASURES TO LOCATE AND PROTECT ALL UTILITIES WHETHER OR NOT SHOWN ON THIS PLAN.
- 2 PRIME CONTRACTORS BIDDING THIS WORK SHALL HAVE A CLASS "A", "C-34", OR A "C-42" LICENSE.
- 3 ALL ELEVATIONS SHOWN ON THE PLAN SHALL BE STAKED IN THE FIELD.
- 4 CONSTRUCTION SHALL BE IN ACCORDANCE WITH THE CITY OF RIVERSIDE STANDARD DRAWINGS AND STANDARD SPECIFICATIONS FOR PUBLIC WORKS CONSTRUCTION, CURRENT EDITION.
- 5 TRENCHES SHALL EITHER BE BACKFILLED AND COMPACTED PER STD. DWG. 453 OR COVERED WITH TRAFFIC RATED STEEL PLATES AT THE END OF EACH WORK DAY AS SPECIFIED IN THE SPECIAL PROVISIONS.
- 6 WATER VALVES ENCOUNTERED DURING PIPELINE CONSTRUCTION OR DURING RESTORATION OF SURFACE IMPROVEMENTS SHALL BE PROTECTED IN PLACE, RESTORED TO PRECONSTRUCTION CONDITION AND/OR ADJUSTED TO GRADE.
- 7 PIPE BEDDING SHALL BE PER STD. DWG. 452 AND CASE SHALL BE AS SPECIFIED ON THE PLANS.
- 9 PIPE JOINTS FOR PROPOSED VCP SHALL BE TYPE "G", PER SECTION 208-2.3 OF THE STANDARD SPECIFICATIONS. PIPE JOINTS FOR JOINING EXISTING VCP TO PROPOSED VCP SHALL BE TYPE "Z", PER SECTION 208-5 OF THE STANDARD SPECIFICATIONS.
- 11 ANY WORK THAT WILL CAUSE DAMAGE TO THE DETECTOR LOOPS SHALL NOT BE PERFORMED UNTIL TRAFFIC SIGNAL MAINTENANCE PERSONNEL HAVE BEEN NOTIFIED AND THE NECESSARY TIMING ADJUSTMENTS ARE MADE TO MAINTAIN SIGNAL OPERATION.
- 12 CONTRACTOR SHALL REPLACE ALL EXISTING TRAFFIC DETECTOR LOOPS AFFECTED BY CONSTRUCTION.

SPECIFIC CONSTRUCTION NOTES

NUMBERS ABOVE 100 IN A HEXAGON ON THE PLAN REFER TO THE RESPECTIVE STANDARD DRAWING AND SHALL BE CONSTRUCTED ACCORDINGLY. UNLESS MODIFICATIONS ARE NOTED ON THE PLAN OR COVER SHEET, ANY NUMBER SHOWN BELOW THE STANDARD DRAWING NUMBER INDICATES THE SPECIFIC ALTERNATE TO BE CONSTRUCTED.

500 RR REMOVE AND REPLACE EXISTING MANHOLE.

- 1 EXISTING SEWER TO REMAIN IN SERVICE.
- 2 ABANDON EXISTING SEWER PIPE IN PLACE.
- 3 PROTECT AND SUPPORT IN PLACE.
- 4 ABANDON EXISTING MANHOLE IN PLACE.
- 5 USE 2-FOOT PIPE LENGTHS FOR PROPOSED 48-FOOT CURVE RADIUS.
- 6 REMOVE INTERFERING PORTION OF 20" ABANDONED FORCE MAIN.
- 7 REMOVE INTERFERING PORTION OF EXISTING MANHOLE AND EXTEND EXISTING 8" VCP TO CONNECT TO PROPOSED 21" VCP.

RIVERSIDE CALIFORNIA

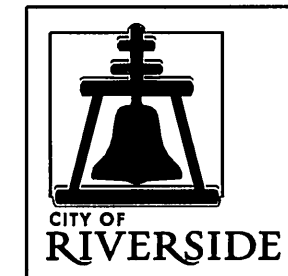

PUBLIC WORKS DEPARTMENT

COLLETT SEWER

FROM LA SIERRA AVENUE TO TORREY PINES DRIVE

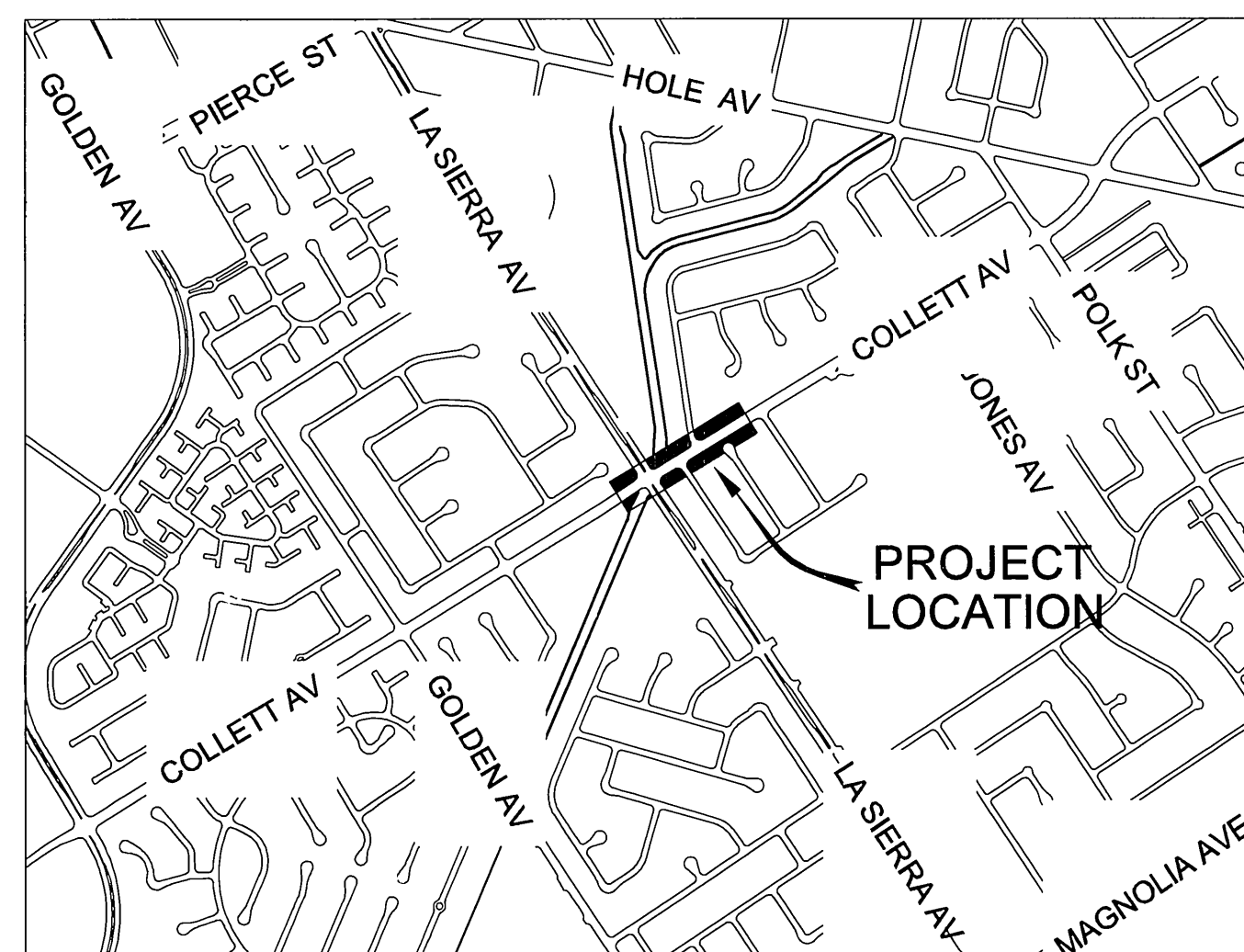

PROJECT LOCATION MAP
NTS

EXISTING UNDERGROUND & TOPOGRAPHY LEGEND

EXISTING UNDERGROUND UTILITIES:

SANITARY SEWER	--- 8"S ---	TELEPHONE CONDUIT	---	T	T
WATER LINE	--- 12"W ---	ELECTRICAL CONDUIT	---	E	E
STORM DRAIN	--- 36"SD ---	GAS LINE	---	3"G	
SEWER FORCE MAIN	--- 20"FM ---	CABLE TV	---	CATV	

(S) SANITARY SEWER M.H.
 (D) STORM DRAIN M.H.

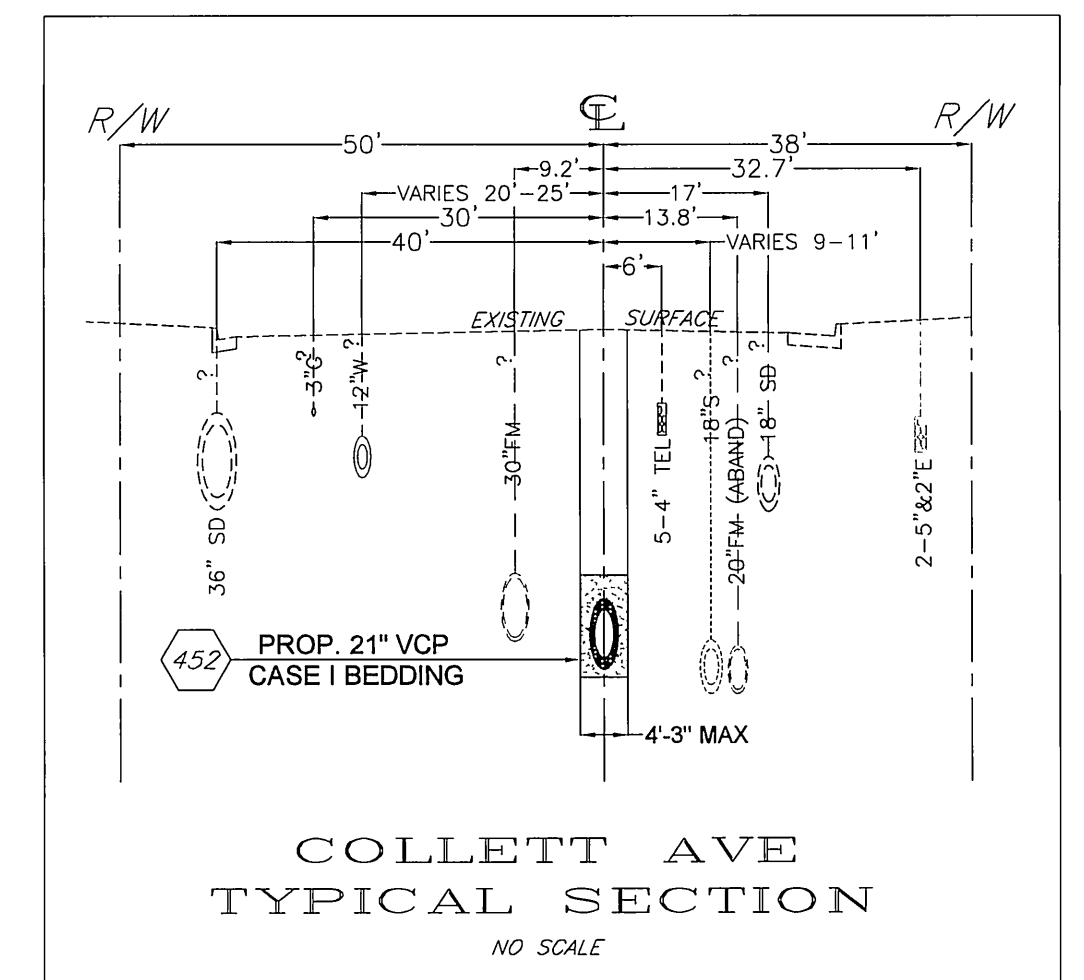

COLLETT AVE
TYPICAL SECTION
NO SCALE

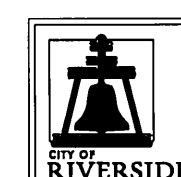
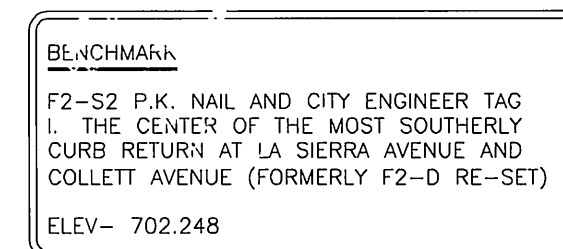
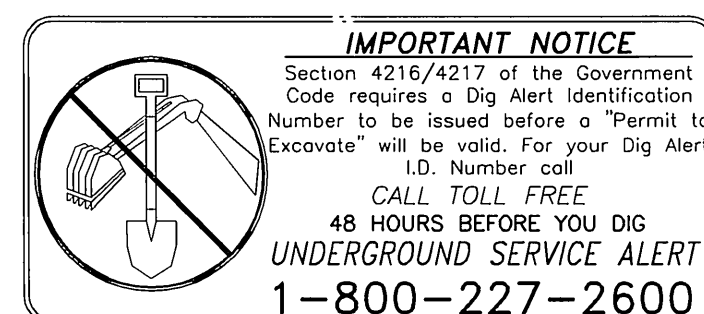
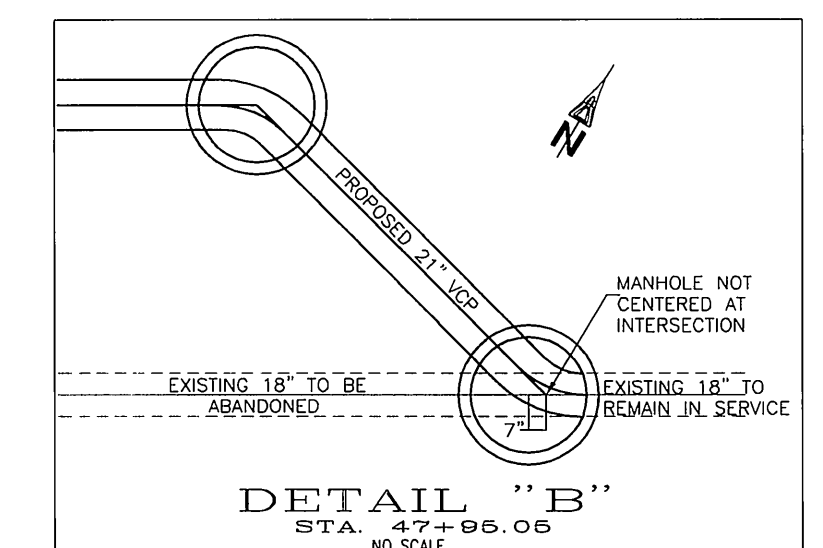
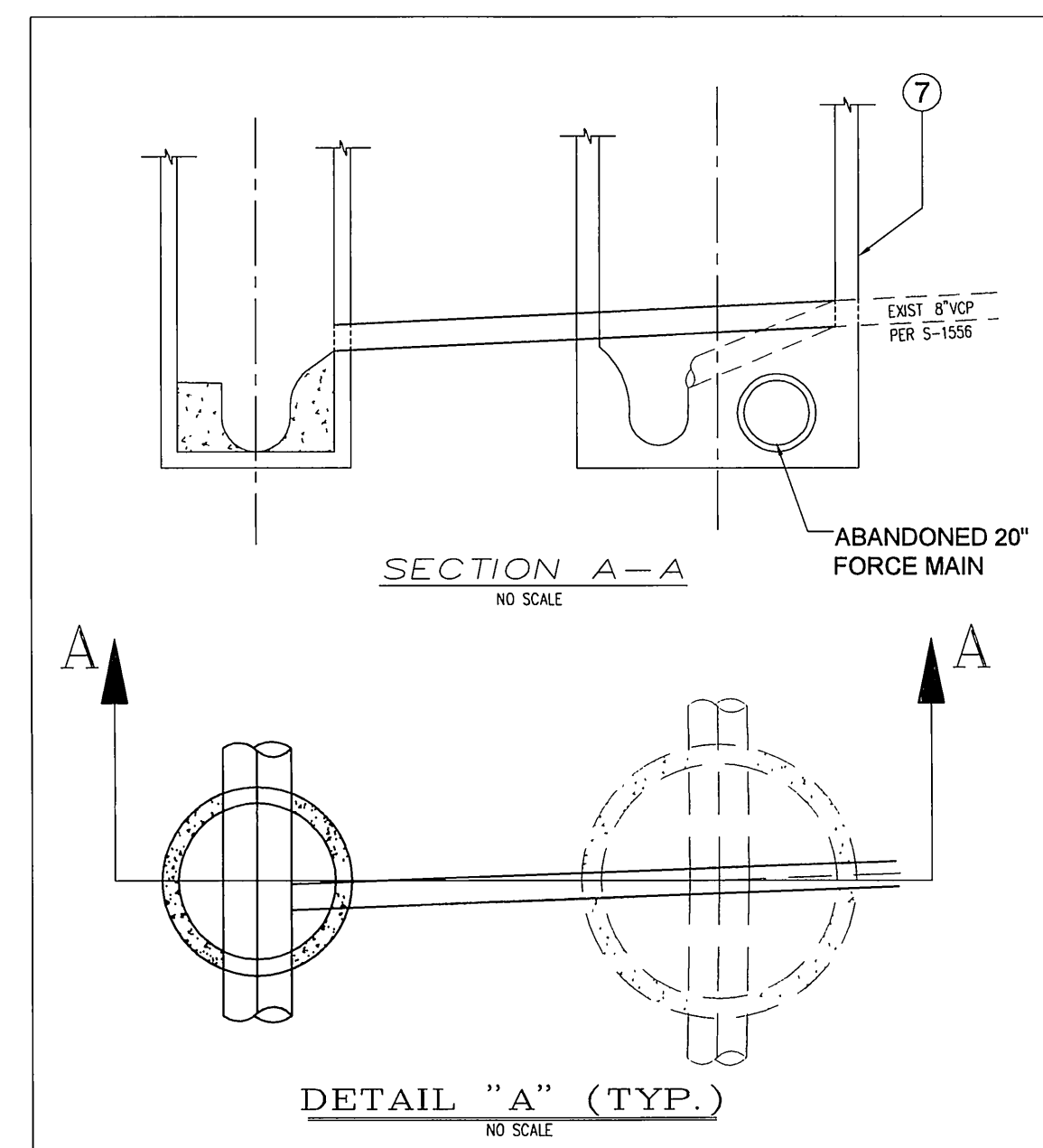

ENGINEER IN RESPONSIBLE CHARGE

LOWMY P. YOUNG
 R.C.E. No. 43216 expires 03-31-2012
 DATE 4/28/2010



MARK	REVISIONS	APPR.	DATE

DESIGNED BY: MLEMING DRAWN BY: MLEMING CHECKED BY: LYOUNG

CITY OF RIVERSIDE, CALIFORNIA
PUBLIC WORKS DEPARTMENT

APPROVED BY	BY	DATE	APPROVED BY
PRINCIPAL ENGINEER	[Signature]	4/28/10	[Signature]
ENGINEERING MANAGER	[Signature]	4/28/10	CITY ENGINEER
INSPECTOR	[Signature]	4/28/10	
SURVEYOR	[Signature]	4/28/10	
TRAFFIC ENGINEERING			

DATE: 4/28/10

COLLETT SEWER

FROM LA SIERRA AVENUE TO TORREY PINES DRIVE

SCALE: AS SHOWN

ACC. No. 9820923203-440301XX
W.O. 0901465

S-2067

SHEET 1 OF 2

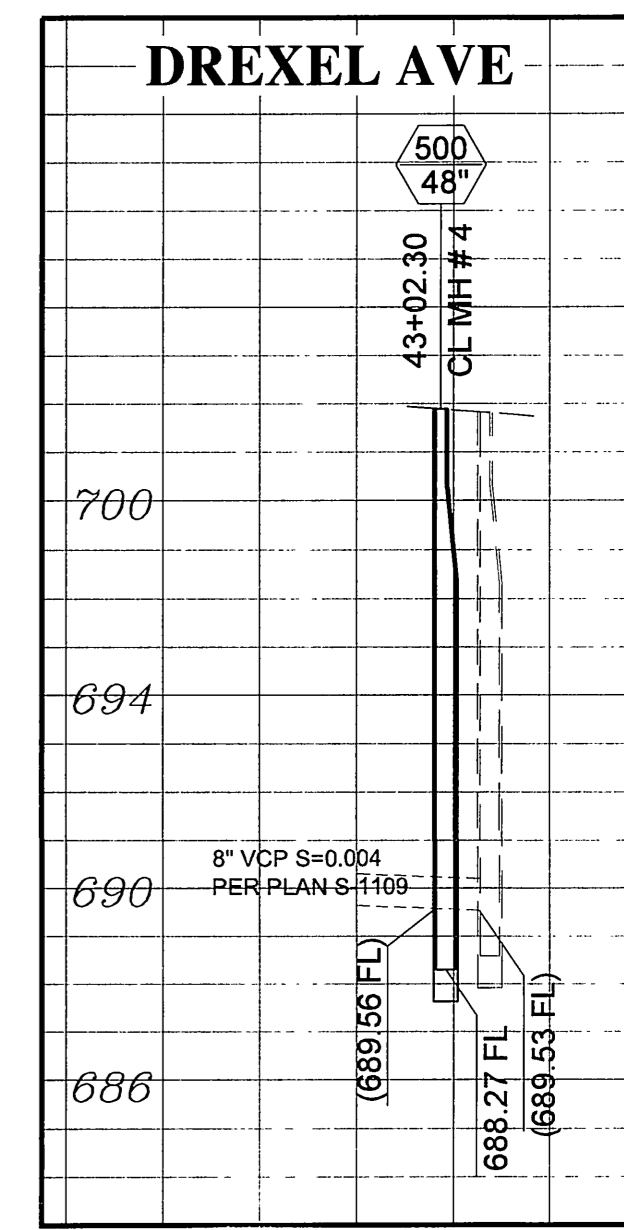
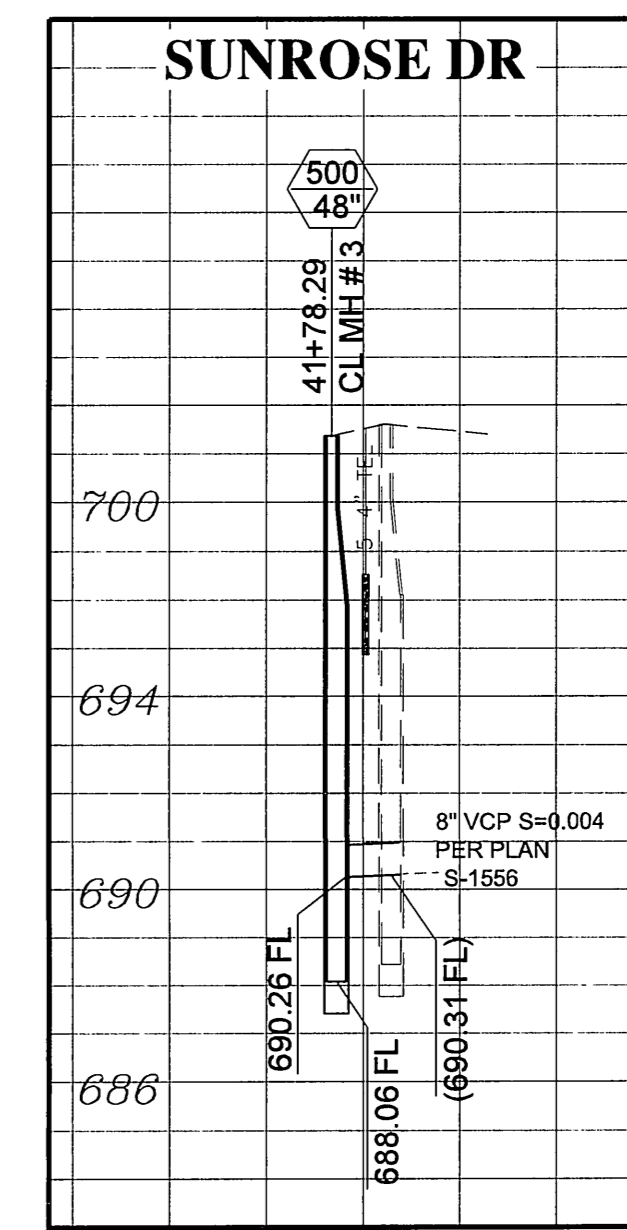
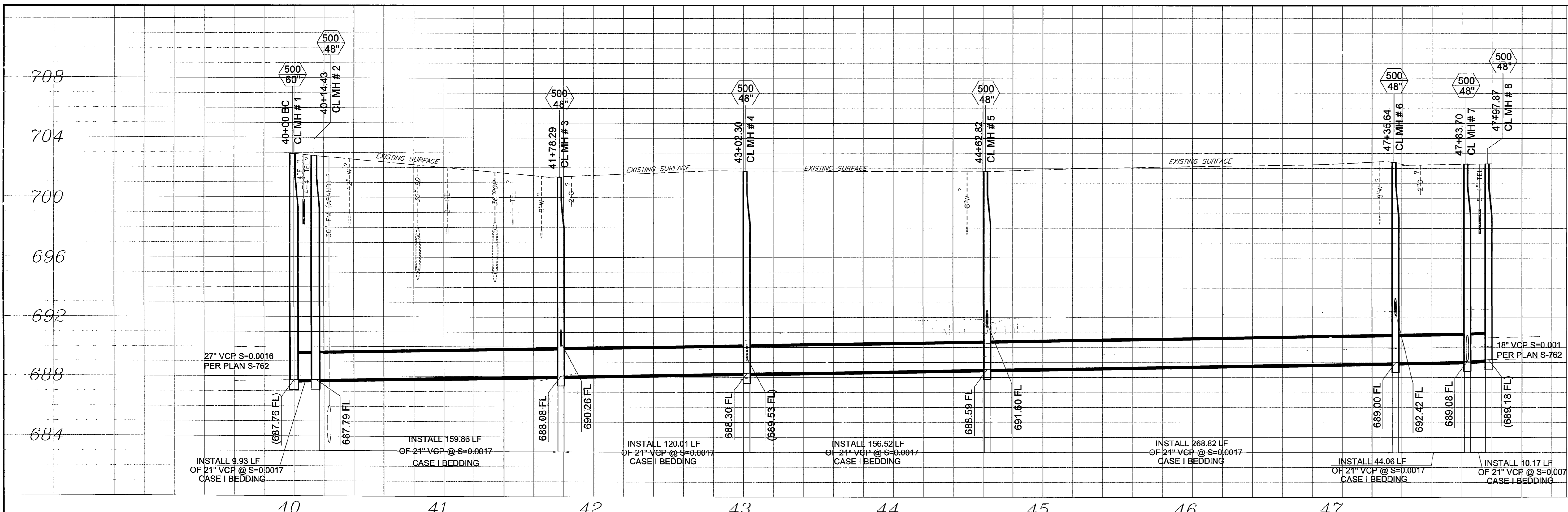

SEWER LINE DATA

	L	BEARING
①	14.43'	N8°13'39"E
②	37.20'	S76°04'35"E

- SPECIFIC CONSTRUCTION NOTES**
- ① NUMBERS ABOVE 100 IN A HEXAGON ON THE PLAN REFER TO THE RESPECTIVE STANDARD DRAWING AND SHALL BE CONSTRUCTED ACCORDINGLY. UNLESS MODIFICATIONS ARE NOTED ON THE PLAN OR COVER SHEET, ANY NUMBER SHOWN BELOW THE STANDARD DRAWING NUMBER INDICATES THE SPECIFIC ALTERNATE TO BE CONSTRUCTED.
 - ② REMOVE AND REPLACE EXISTING MANHOLE.
 - ③ EXISTING SEWER TO REMAIN IN SERVICE.
 - ④ ABANDON EXISTING SEWER PIPE IN PLACE.
 - ⑤ PROTECT AND SUPPORT IN PLACE.
 - ⑥ ABANDON EXISTING MANHOLE IN PLACE.
 - ⑦ NOT USED.
 - ⑧ REMOVE INTERFERING PORTION OF 20" ABANDONED FORCE MAIN.
 - ⑨ REMOVE INTERFERING PORTION OF EXISTING MANHOLE AND EXTEND EXISTING 8" VCP TO CONNECT TO PROPOSED 21" VCP SEE DETAIL "A"

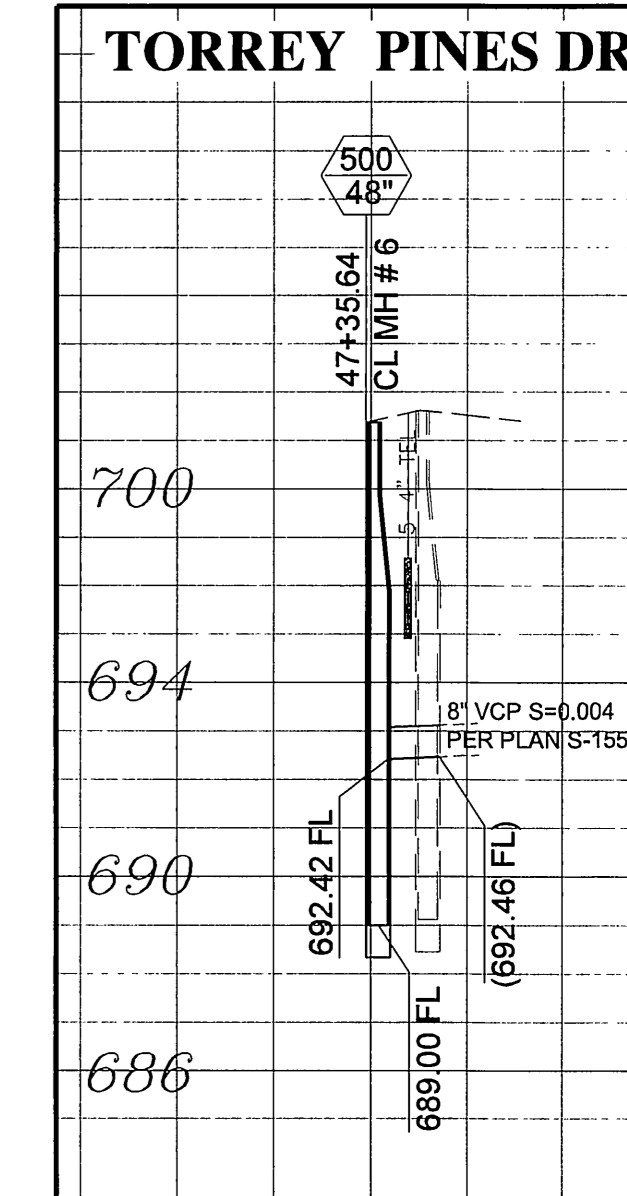
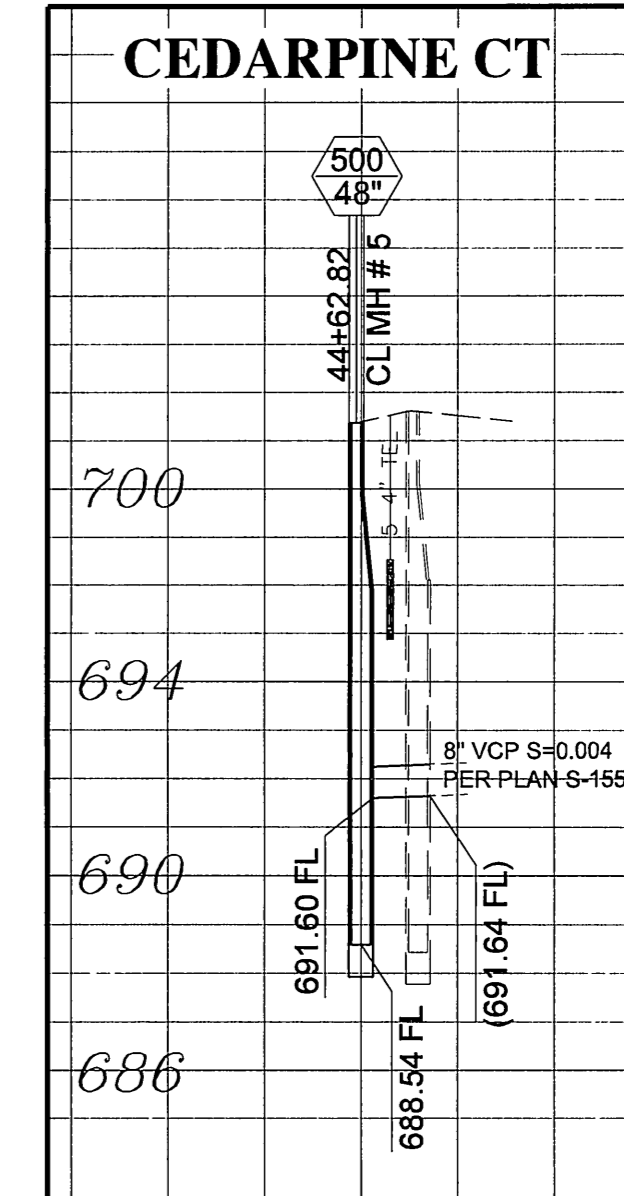
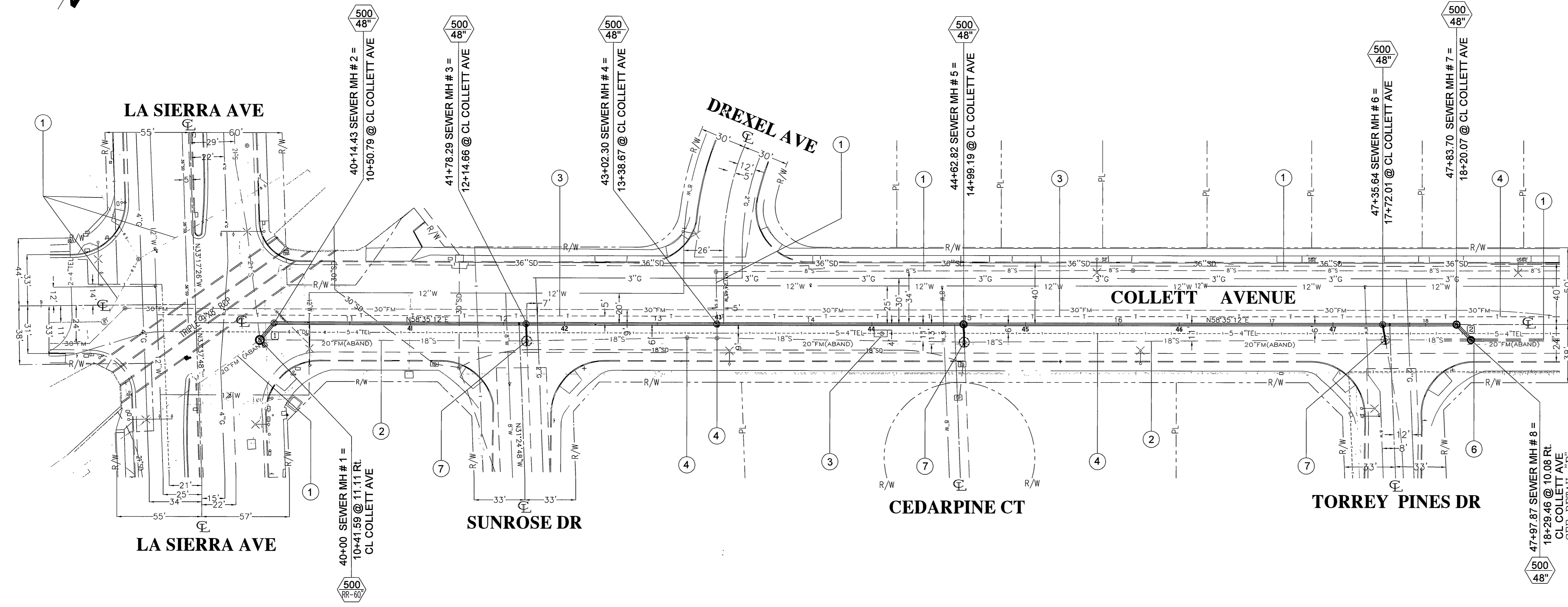

IMPORTANT NOTICE
 Section 42161/4217 of the Government Code requires a Dig Alert identification Number to be issued before a "Permit to Excavate" will be valid. For your Dig Alert I.D. Number call:
 CALL TOLL FREE
 48 HOURS BEFORE YOU DIG
 UNDERGROUND SERVICE ALERT
 1-800-227-2600

BENCHMARK
 F2-52 P.K. NAIL AND CITY ENGINEER TAG IN THE CENTER OF THE MOST SOUTHERLY CURB RETURN AT LA SIERRA AVENUE AND COLLETT AVENUE (FORMERLY F2-D RE-SET)
 ELEV= 702.248

ENGINEER IN RESPONSIBLE CHARGE
 LARRY LAW YOUNG
 R.C.E. No. 43216 Expires 03-31-2012
 DATE: 02/20/10



MARK	REVISIONS	APPR.	DATE

CITY OF RIVERSIDE, CALIFORNIA
 PUBLIC WORKS DEPARTMENT
 APPROVED BY: [Signature]
 PRINCIPAL ENGINEER
 ENGINEERING MANAGER
 SUPERVISOR
 TRAFFIC ENGINEERING
 DATE: 4/2/10

COLLETT SEWER
 FROM LA SIERRA AVENUE
 TO TORREY PINES DRIVE

ACC No. 9820923203-440301XX
 W.O. 0901485
S-2067
 SHEET 2 OF 2

HORIZ. SCALE: 1" = 40' VERT. SCALE: 1" = 4'