

GENERAL NOTES:

- 1). CONSTRUCTION SHALL BE IN ACCORDANCE WITH THE CITY OF RIVERSIDE STANDARD DRAWINGS AND STANDARD SPECIFICATIONS FOR PUBLIC WORKS CONSTRUCTION, 2009 EDITION.
- 2). EXISTING UTILITIES SHOWN ON THIS PLAN ARE PLOTTED FROM PUBLIC RECORDS. THE CONTRACTOR IS REQUIRED TO TAKE DUE PRECAUTIONARY MEASURES TO LOCATE AND PROTECT ALL UTILITIES WHETHER OR NOT SHOWN ON THIS PLAN.
- 3). PRIME CONTRACTOR BIDDING THIS WORK SHALL HAVE A CLASS "A" OR A "C-42" LICENSE.
- 4). ALL ELEVATIONS SHOWN ON THE PLANS SHALL BE STAKED IN THE FIELD, EXCEPT FOR ELEVATIONS SHOWN IN PARENTHESIS DENOTED BY EXISTING GRADES.

RIVERSIDE CALIFORNIA

PUBLIC WORKS DEPARTMENT

NEW SEWER MANHOLE IN PINE STREET BETWEEN 11TH ST AND 12TH ST.

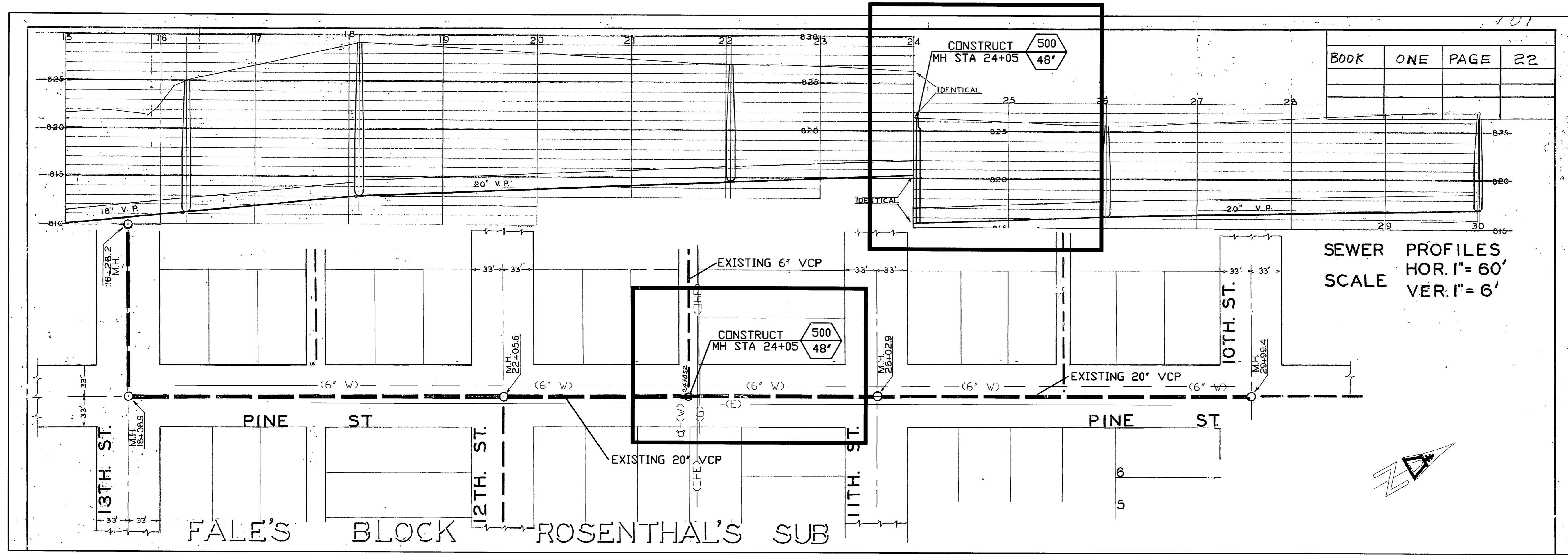

BOOK	ONE	PAGE	22
------	-----	------	----

SEWER PROFILES
SCALE HOR. 1"=60'
VER. 1"=6'

* EXISTING SEWER PER DRAWING 1/22. ADD MANHOLE IN PINE STREET AT STATION 24+05

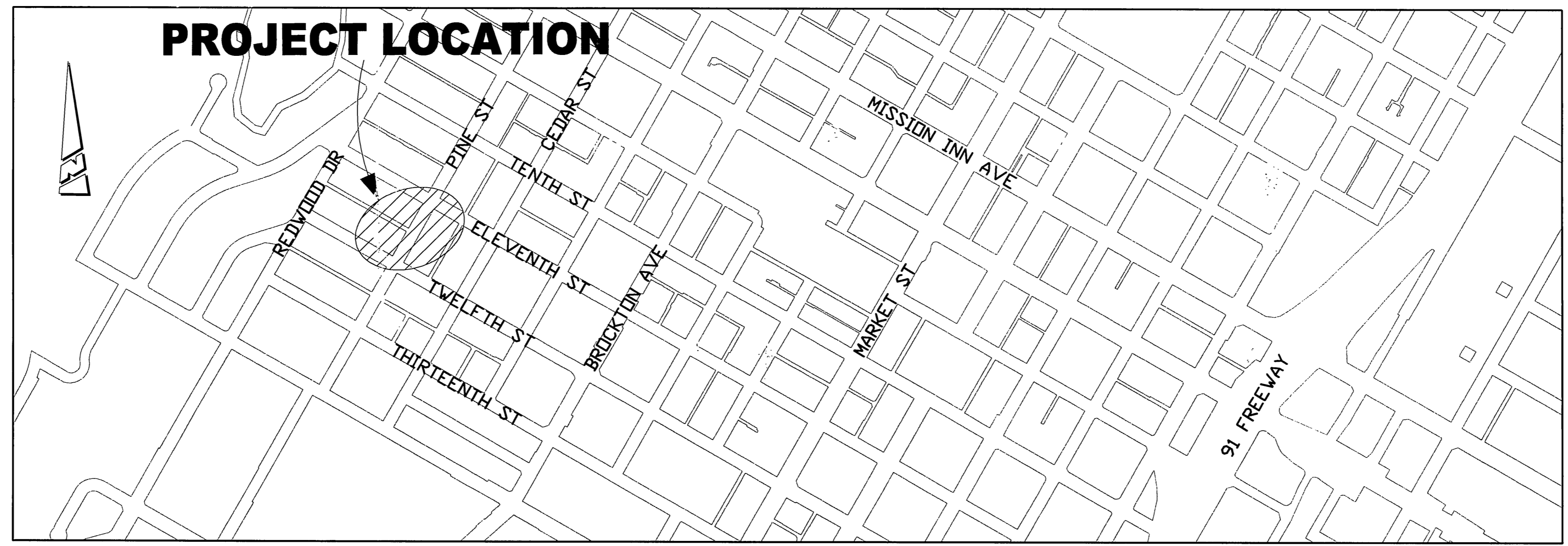

**VICINITY MAP
NTS**

CONSTRUCTION NOTES:

NUMBERS ABOVE 100 IN A HEXAGON ON THE PLAN REFER TO THE RESPECTIVE STANDARD DRAWING AND SHALL BE CONSTRUCTED ACCORDINGLY. UNLESS MODIFICATIONS ARE NOTED ON THE PLAN OR COVER SHEET. ANY NUMBER SHOWN BELOW THE STANDARD DRAWING NUMBER INDICATES THE SPECIFIC ALTERNATE TO BE CONSTRUCTED.

 Under Ground Service Alert of Southern California Call: TOLL FREE 1-800-227-2600 TWO WORKING DAYS BEFORE YOU DIG	 ENGINEER IN RESPONSIBLE CHARGE LONNY LEW YOUNG R.C.E. No. 43216 EXPIRES: 3-31-2012 DATE: 02/16/2011	 No. 43216 Exp. 3-31-2012 CIVIL STATE OF CALIFORNIA	CITY OF RIVERSIDE, CALIFORNIA DEPARTMENT OF PUBLIC WORKS APPROVED BY: [Signature] BY: [Signature] DATE: 2/17/11 PRINCIPAL ENGINEER CONSTRUCTION ADMIN. DATE: 02/16/2011 SURVEY DATE: 2/18/11	SEWER IMPROVEMENTS NEW SEWER MANHOLE IN PINE STREET BETWEEN 11TH ST AND 12TH ST TITLE SHEET HORIZ. SCALE: 1"=60' VERT. SCALE: 1"=6'	ACCT. NO. 985032303 4403010X DESIGN WORK ORDER NO.: 1112110 S-2086 SHEET 1 OF 1 FILE NAME:
--	---	---	--	---	---