

IN THE CITY OF RIVERSIDE, CALIFORNIA

# SEWER IMPROVEMENT PLANS

## TAVA CENTER-LA FITNESS EXPANSION

### GENERAL NOTES

- NO PERSON SHALL PERFORM ANY CONSTRUCTION ACTIVITY OR INSTALL ANY OBJECTS WITHIN THE PUBLIC RIGHTS-OF-WAY OR EASEMENTS OF THE CITY OF RIVERSIDE WITHOUT A VALID CONSTRUCTION PERMIT OR A STREET OPENING PERMIT OR AN ENCROACHMENT PERMIT ISSUED BY THE CITY'S PUBLIC WORKS DEPARTMENT.
- QUANTITIES SHOWN ARE FOR INFORMATION ONLY AND THE CITY OF RIVERSIDE IS NOT RESPONSIBLE FOR THEIR ACCURACY.
- CONSTRUCTION SHALL BE IN ACCORDANCE WITH THE CITY OF RIVERSIDE DEPARTMENT OF PUBLIC WORKS, STANDARD DRAWINGS, ITS SUPPLEMENTAL NOTES AND THE STANDARD SPECIFICATIONS FOR PUBLIC WORKS CONSTRUCTION, CURRENT EDITION.
- IT SHALL BE THE RESPONSIBILITY OF THE CONTRACTOR TO CLEAR THE RIGHT OF WAY IN ACCORDANCE WITH THE PROVISIONS OF LAW AS IT AFFECTS EACH UTILITY INCLUDING IRRIGATION LINES AND APPURTENANCES AND AT NO COST TO THE CITY.
- ALL FLAGGED ELEVATIONS SHALL BE STAKED IN THE FIELD BY THE PRIVATE ENGINEER.
- THE PRIVATE ENGINEER SIGNING THESE PLANS IS RESPONSIBLE FOR ASSURING THE ACCURACY AND ACCEPTABILITY OF THE WORK HEREON. IN THE EVENT OF DISCREPANCIES ARISING DURING CONSTRUCTION, THE PRIVATE ENGINEER SHALL BE RESPONSIBLE FOR DETERMINING AN ACCEPTABLE SOLUTION AND REVISING THE PLANS FOR APPROVAL BY THE CITY.
- THE CONTRACTOR SHALL CALL IN A LOCATION REQUEST TO UNDERGROUND SERVICE ALERT (U.S.A.) PHONE NO. 811, TWO WORKING DAYS BEFORE DIGGING. NO CONSTRUCTION PERMIT WILL BE ISSUED BY THE PUBLIC WORKS DEPARTMENT INVOLVING EXCAVATION FOR UNDERGROUND FACILITIES UNLESS THE APPLICANT HAS BEEN PROVIDED AN INQUIRY IDENTIFICATION NUMBER BY U.S.A.
- THE DEVELOPER SHALL BE RESPONSIBLE FOR PRESERVING OR RE-ESTABLISHING AND REFERENCING SURVEY MONUMENTS DESTROYED, DISTURBED OR BURIED AS A RESULT OF CONSTRUCTION SHOWN HEREON.
- CONTRACTOR IS TO VERIFY EXISTING SEWER LOCATION AND ELEVATION PRIOR TO START OF CONSTRUCTION.
- A PLUG IS TO BE INSTALLED AND WILL REMAIN IN PLACE WHERE THE NEW SEWER CONNECTS WITH THE EXISTING SEWER UNTIL THE NEW SEWER IS ACCEPTED BY THE CITY.
- THE SEWER CONTRACTOR SHALL ADJUST MANHOLES TO FINAL GRADE AFTER PAVING IS COMPLETED.
- PIPE JOINTS FOR VITRIFIED CLAY PIPE SHALL BE TYPE "G" AS SPECIFIED IN SECTION 208-2.3 OF THE STANDARD SPECIFICATIONS FOR PUBLIC WORKS. IF PLASTIC PIPE IS ALLOWED AS AN ALTERNATIVE, ALL PIPE JOINTS SHALL BE GASKETED. CEMENTED JOINTS SHALL NOT BE ALLOWED.
- THE DEVELOPER IS RESPONSIBLE FOR PERFORMING A VIDEO INSPECTION OF THE NEW SEWER MAIN PRIOR TO FINAL ACCEPTANCE OF THE WORK. THE VIDEO INSPECTION MUST BE PERFORMED IN THE PRESENCE OF THE PUBLIC WORKS INSPECTOR. A RECORDING OF THE VIDEO INSPECTION MUST BE SUBMITTED TO THE CITY FOR REVIEW AND ACCEPTANCE.
- LOCATION OF LATERALS TO BE DETERMINED IN THE FIELD AT THE DIRECTION OF THE OWNER. AVOID CONFLICT WITH PROPOSED AND/OR EXISTING FACILITIES.
- NO FINISHED FLOOR ELEVATION SHALL BE LESS THAN 6" ABOVE THE UPPER MANHOLE RIM ELEVATION OF THE SEWER LINE SEGMENT BEING CONNECTED TO, WITHOUT HAVING A PROPER BACKWATER VALVE INSTALLED IN THE LATERAL.

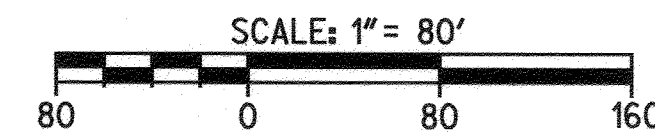
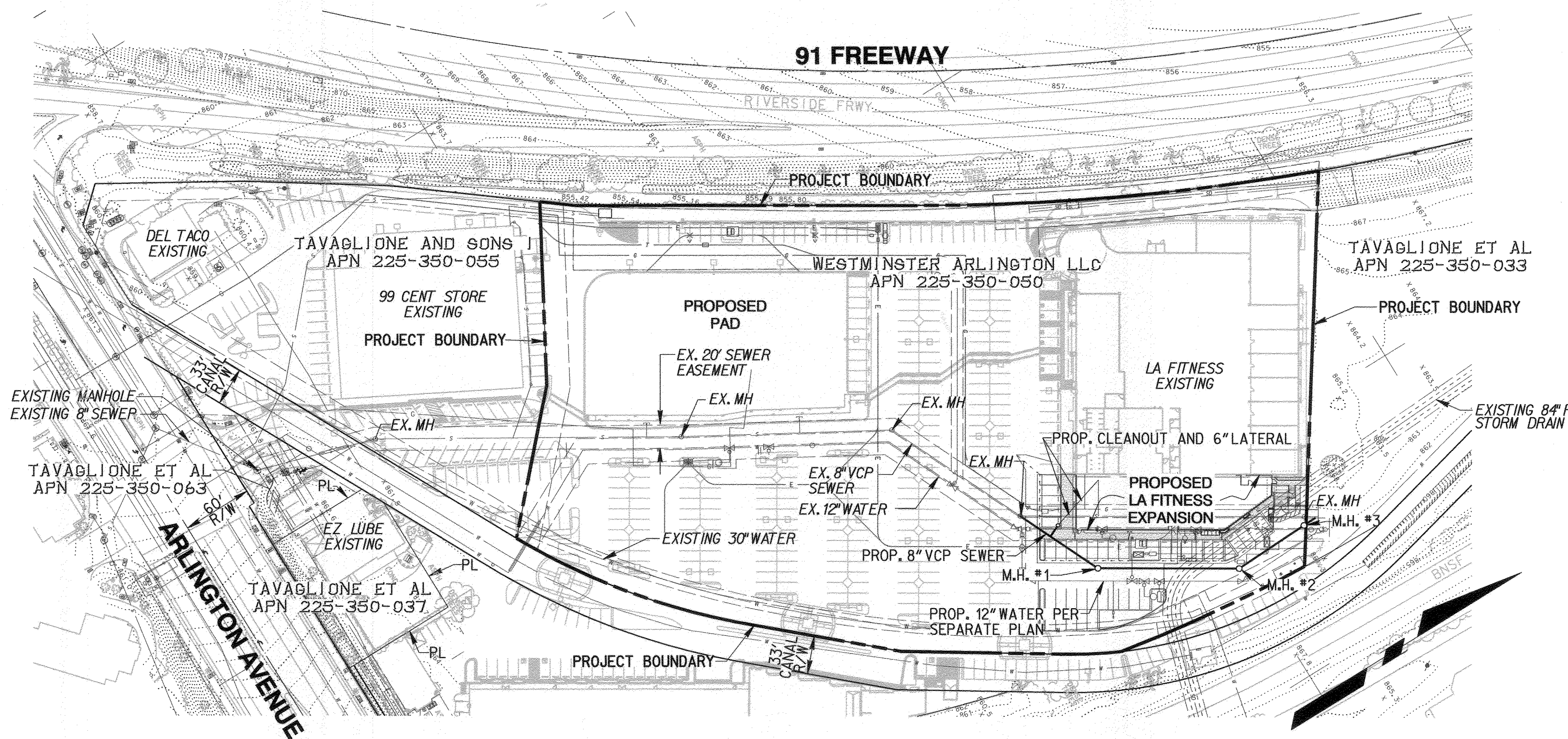

### WORK TO BE DONE

THESE IMPROVEMENTS CONSIST OF THE FOLLOWING WORK TO BE DONE ACCORDING TO THESE PLANS, THE CURRENT CITY OF RIVERSIDE STANDARDS AND SPECIFICATIONS, AND THE LATEST EDITION OF THE STANDARD SPECIFICATIONS FOR PUBLIC WORK CONSTRUCTION ("GREEN BOOK").

### PRIVATE ENGINEER'S NOTE TO CONTRACTOR

ALL CONTRACTORS AND SUBCONTRACTORS PERFORMING WORK SHOWN ON OR RELATED TO THESE PLANS SHALL CONDUCT THEIR OPERATIONS SO THAT ALL EMPLOYEES ARE PROVIDED A SAFE PLACE TO WORK AND THE PUBLIC IS PROTECTED. ALL CONTRACTORS AND SUBCONTRACTORS SHALL COMPLY WITH THE OCCUPATIONAL SAFETY AND HEALTH REGULATIONS OF THE U.S. DEPARTMENT OF LABOR AND THE STATE OF CALIFORNIA DEPARTMENT OF INDUSTRIAL RELATIONS CONSTRUCTION SAFETY ORDERS. THE CIVIL ENGINEER SHALL NOT BE RESPONSIBLE IN ANY WAY FOR THE CONTRACTOR'S AND SUBCONTRACTOR'S COMPLIANCE WITH SAID REGULATIONS AND ORDERS.

CONTRACTOR FURTHER AGREES THAT HE SHALL ASSUME SOLE AND COMPLETE RESPONSIBILITY FOR JOB-SITE CONDITIONS DURING THE COURSE OF CONSTRUCTION OF THIS PROJECT, INCLUDING SAFETY OF ALL PERSONS AND PROPERTY, THAT THIS REQUIREMENT SHALL APPLY CONTINUOUSLY AND NOT BE LIMITED TO NORMAL WORKING HOURS, AND THAT THE CONTRACTOR SHALL DEFEND, INDEMNIFY AND HOLD THE OWNER AND CIVIL ENGINEER HARMLESS FROM ANY AND ALL LIABILITY, REAL OR ALLEGED, IN CONNECTION WITH THE PERFORMANCE OF WORK ON THIS PROJECT, EXCEPT FOR LIABILITY ARISING FROM THE SOLE NEGLIGENCE OF THE OWNER OR ENGINEER.

THE EXISTENCE AND APPROXIMATE LOCATIONS OF ANY UNDERGROUND UTILITIES OR STRUCTURES SHOWN ON THESE PLANS ARE OBTAINED BY A SEARCH OF THE AVAILABLE RECORDS. THE CIVIL ENGINEER ASSUMES NO LIABILITY AS TO THE EXACT LOCATION OF SAID LINES NOR FOR UTILITY OR IRRIGATION LINES WHOSE LOCATIONS ARE NOT SHOWN. THE CONTRACTOR SHALL BE RESPONSIBLE FOR NOTIFYING ALL UTILITY AND IRRIGATION COMPANIES PRIOR TO WORK OR EXCAVATION TO DETERMINE THE EXACT LOCATIONS OF ALL LINES AFFECTING THIS WORK, WHETHER OR NOT SHOWN HERE ON, AND FOR ANY DAMAGE OR PROTECTION TO THESE LINES.

### CIVIL ENGINEER

RICK ENGINEERING COMPANY  
1770 IOWA AVENUE, SUITE 100  
RIVERSIDE, CA 92507  
ATTN: KRISTIN BROWN, RCE  
(951) 782-0707

### GEOTECHNICAL ENGINEER

JOHN R. BYERLY, INC.  
2257 SOUTH LILAC AVENUE  
BLOOMINGTON, CA 92316  
ATTN: JOHN R. BYERLY, GE  
(909) 877-1324

### NOTICE TO CONTRACTOR

THE EXISTENCE AND LOCATIONS OF ALL UNDERGROUND UTILITIES (UTILITY PIPES, STRUCTURES, ETC.) SHOWN ON THESE PLANS (MAIN LINES ONLY - NO SERVICE LATERALS) WERE ASCERTAINED BY A REVIEW OF RECORDS PROVIDED BY THESE MEMBER AGENCIES AND ARE APPROXIMATE. NEITHER THE OWNER NOR THE ENGINEER ASSUMES ANY RESPONSIBILITY FOR UTILITIES NOT SHOWN OR NOT IN THE LOCATION SHOWN.

THE CONTRACTOR IS REQUIRED TO TAKE DUE PRECAUTIONARY MEASURES TO PROTECT THE UTILITY LINES SHOWN AND ANY OTHER LINES NOT OF RECORD OR NOT SHOWN ON THESE PLANS. LOCATIONS OF UTILITIES SHALL BE VERIFIED BY THE CONTRACTOR PRIOR TO COMMENCEMENT OF CONSTRUCTION.

CALL UNDERGROUND SERVICE ALERT (U.S.A.) 811 AT LEAST 2 WORKING DAYS PRIOR TO COMMENCEMENT OF CONSTRUCTION.

### ENGINEER'S NOTES

THE PRIVATE ENGINEER SIGNING THESE PLANS IS RESPONSIBLE FOR ASSURING THE ACCURACY OF DESIGN AND ACCEPTABILITY OF THE DESIGN HEREON. IN THE EVENT OF DISCREPANCIES ARISING AFTER CITY APPROVAL OR DURING CONSTRUCTION, THE CONTRACTOR SHALL IMMEDIATELY CONTACT THE PRIVATE ENGINEER FOR CLARIFICATION. THE PRIVATE ENGINEER SHALL BE RESPONSIBLE FOR DETERMINING AN ACCEPTABLE SOLUTION AND REVISING THE PLANS FOR APPROVAL BY THE CITY.

PRIVATE ENGINEER WILL NOT BE PROVIDING INSPECTION SERVICES OR CONSTRUCTION REVIEW. THESE FUNCTIONS ARE THE RESPONSIBILITY OF THE CITY AND/OR THE GENERAL CONTRACTOR. ENGINEER ACCEPTS NO LIABILITY FOR SUCH FUNCTIONS OR WORK THEREOF.

### ABBREVIATIONS

- TC - TOP OF CURB
- IE - INVERT ELEVATION
- R/W - RIGHT OF WAY
- MH - MANHOLE
- PA - PROPOSED PLANTER AREA

### LEGEND

- PROPOSED SEWER MAIN AND MH
- EXIST SEWER MAIN
- EXIST WATER MAIN

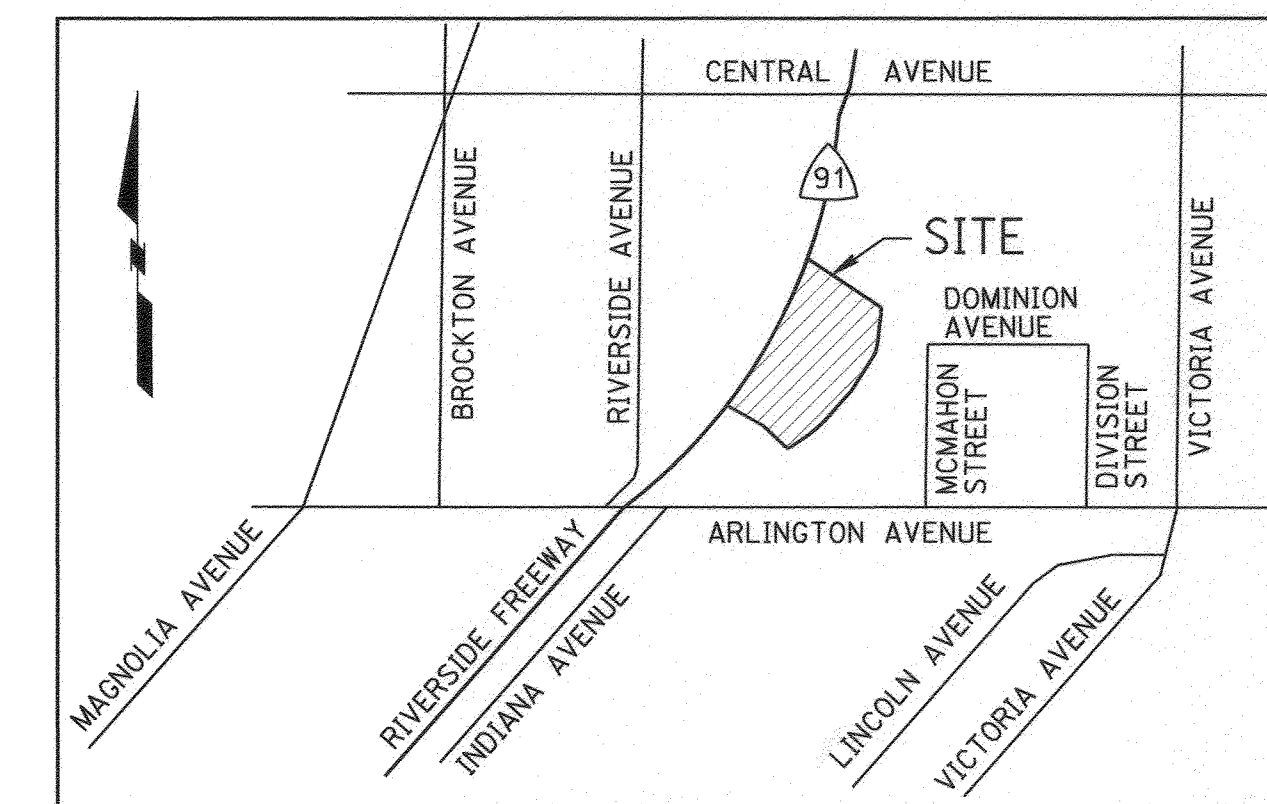

VICINITY MAP  
N.T.S.

### CONSTRUCTION NOTES AND QUANTITY ESTIMATE

- INSTALL SEWER MANHOLE PER CITY OF RIV STD 500 ..... 3 EA
- INSTALL 8" VCP SEWER MAIN, PIPE BEDDING PER CITY OF RIV STD 452 (CASE 1) ..... 281 LF
- INSTALL 6" SEWER LATERAL PER CITY OF RIV STD 562 ..... 1 EA / 10 LF
- INSTALL SEWER CLEANOUT PER CITY OF RIV STD 562 ..... 1 EA
- RECONTOUR BOTTOM OF EXISTING MANHOLE FOR FLOW. REFER TO CITY OF RIVERSIDE STD. 500 FOR DETAILS ..... 1 EA
- REMOVE EXISTING MANHOLE AND 8" VCP SEWER MAIN ..... 1 MH / 257 LF

**CAUTION:**  
EXACT LOCATION OF EXISTING UNDERGROUND FACILITIES IS UNKNOWN. CONTRACTOR TO VERIFY IN FIELD.

**811**  
Know what's below.  
Call before you dig.  
Call at least 2 working days prior to excavating.

CITY OF RIVERSIDE  
PUBLIC UTILITIES DEPARTMENT  
WATER ENGINEERING  
APPROVED BY: [Signature]  
DATE: 10/2/12

REGISTERED PROFESSIONAL ENGINEER  
ROBERT A. STOCKTON  
No. C033591  
Exp. 6-30-14  
CIVIL  
STATE OF CALIFORNIA

PREPARED UNDER THE DIRECTION OF  
ROBERT A. STOCKTON  
REGISTERED CIVIL ENGINEER NO. C033591  
EXPIRATION DATE 06/30/14

CITY BUSINESS TAX CERTIFICATE NO. 35225 EXP. DATE 7/20/13

**RICK ENGINEERING COMPANY**  
1770 IOWA AVENUE - SUITE 100  
RIVERSIDE, CA 92507  
951.782.0707  
(FAX) 951.782.0723  
rickengineering.com  
San Diego - Orange - San Luis Obispo - Bakersfield - Sacramento - Phoenix - Tucson

BENCH MARK:  
CITY OF RIVERSIDE BENCH MARK NUMBER G6-M3, P.K. NAIL AND CITY ENGINEER TAG IN THE SOUTHERLY CURB OF ARLINGTON AVENUE AT THE APPROXIMATE CENTERLINE PROD OF MT. DIABLO.  
ELEV. 841.147 NGVD 29

MARK	REVISIONS	APPR	DATE

DESIGNED BY: FR    DRAWN BY: FR    CHECKED BY: KMB

CITY OF RIVERSIDE  
PUBLIC WORKS DEPARTMENT  
APPROVED BY: [Signature]  
CITY ENGINEER/PW DIRECTOR  
DATE: 10/1/12

SEWER IMPROVEMENT PLANS  
LA FITNESS EXPANSION  
3437 ARLINGTON AVENUE  
TITLE SHEET

PW12-0285  
S-2109  
SHEET 1 OF 2  
FILE NO.

