

# PLAZA SUBSTATION SEWER IMPROVEMENT PLAN W.O. 1619571

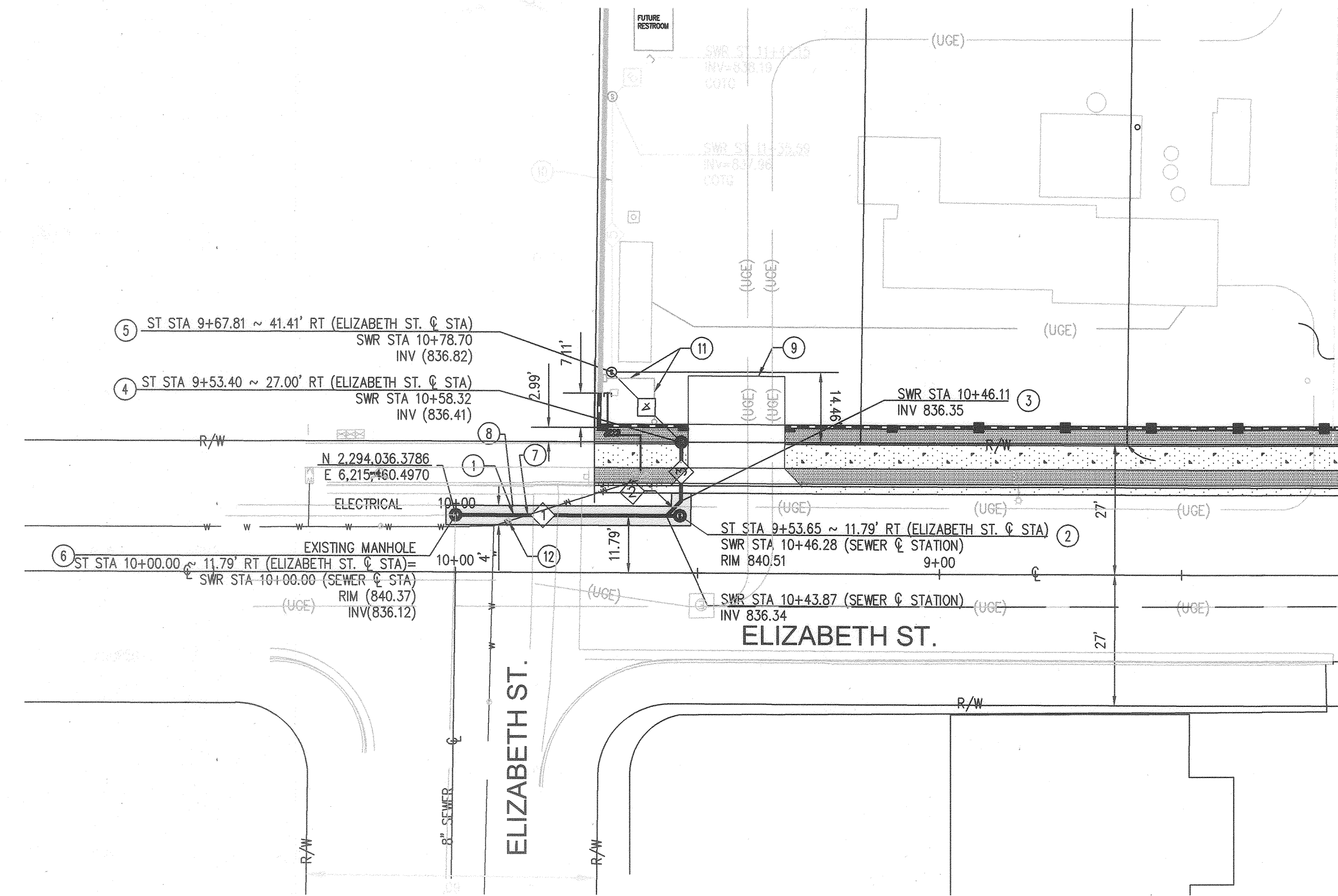
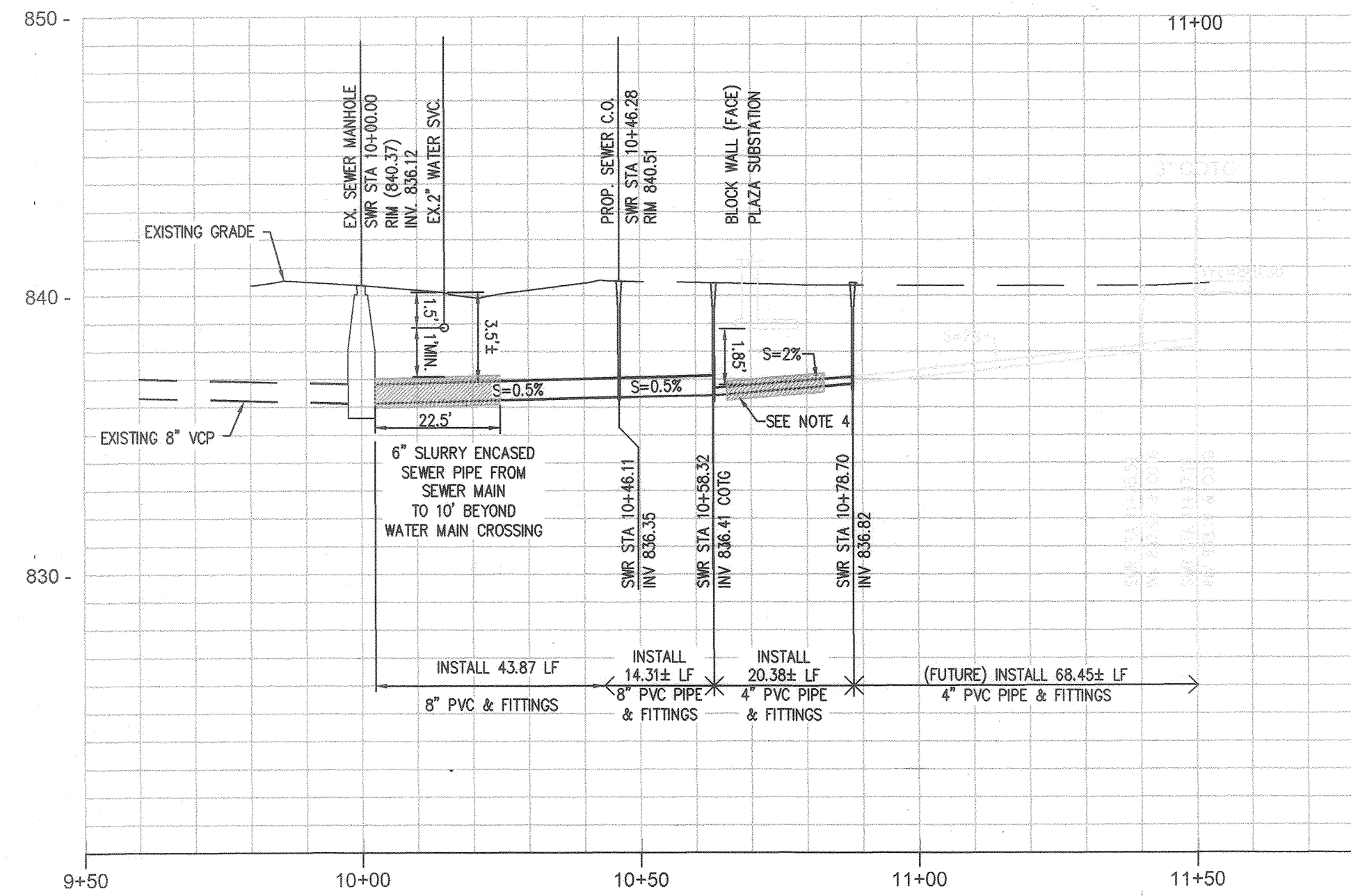
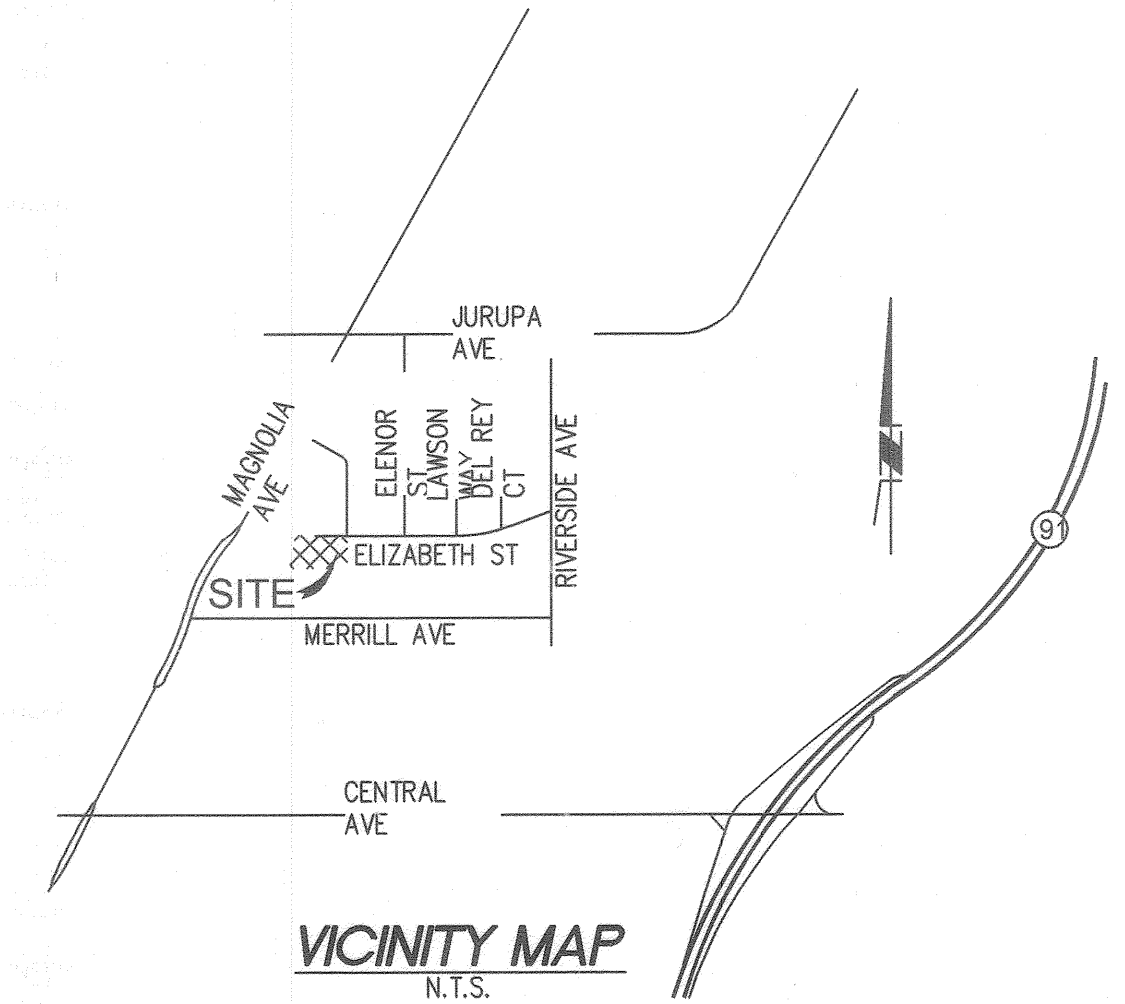

## CONSTRUCTION NOTES AND QUANTITY ESTIMATES

- |    |   |          |
|----|---|----------|
| 1  | INSTALL 8" PVC SEWER MAIN AND PIPE BEDDING CASE "H" PER CITY OF RIVERSIDE STD. DWG. 452. ENCASE 8" SEWER PIPE WITH 6" SLURRY FROM EXISTING SEWER MAIN TO 10' AFTER WATER MAIN CROSSING. | 43.87 LF |
| 2  | INSTALL SEWER MAIN CLEANOUT PER CITY OF RIVERSIDE STD. DWG. 560.  | 1 EA     |
| 3  | INSTALL 8" PVC SEWER LATERAL AND PIPE BEDDING CASE "H" PER CITY OF RIVERSIDE STD. DWG. 452.   | 14.21 LF |
| 4  | INSTALL 4" PVC SEWER LATERAL WITH PROPERTY LINE CLEANOUT PER CITY OF RIVERSIDE STD. DWG. 562. ENCASE 6FT OF SEWER PIPE CROSSING UNDER WALL FOOTING IN 6" SLURRY.                        | 20.38 LF |
| 5  | INSTALL CLEANOUT PER CITY OF RIVERSIDE STD. DWG. 560.   | 1 EA     |
| 6  | JOIN EXISTING SEWER MANHOLE, RE-CHANNEL BOTTOM PER CITY OF RIVERSIDE STD. DWG. 500.   | 1 LOT    |
| 7  | PROTECT IN PLACE EXISTING WATER SERVICE. CONTACT FIELD FORCES IF 2" WATER LINE REQUIRES ADJUSTMENTS (951)351-6368   | N/A      |
| 8  | THIS IS THE ESTIMATED AREA FOR TRENCHING IN THE STREET ROADWAY. CONTRACTOR TO RESTORE A.C. PAVEMENT PER DRAWINGS R-4285 SH. 1&2.  | 280 SF   |
| 9  | PROTECT DRIVEWAY GUTTER AND APRON WHEN INSTALLING PVC PIPE UNDER 6" CONCRETE.   | N/A      |
| 10 | INSTALL 68.45 ± FEET OF 4" VCP BUILDING SEWER, FITTINGS & CLEANOUTS.  | 1 LOT    |
| 11 | DIG WITH CAUTION. LOW VOLTAGE SECURITY CONDUIT LOCATED 20"-24" DEPTH.   |          |
| 12 | ADJUST VALVE CAN TO GRADE (IF NECESSARY).   |          |

NO.	BEARING/Delta	SLOPE (%)	LENGTH	DESCRIPTION
1	N89°48'37"W	0.5	43.87'	8" PVC (PUBLIC)
2	N45°11'23"E	0.5	2.10'	8" PVC (PRIVATE OFFSITE)
3	N00°11'23"E	0.5	12.21'	8" PVC (PRIVATE OFFSITE)
4	S44°48'37"E	2	20.38'	4" PVC (PRIVATE ONSITE)
5	S00°11'23"W	2	56.89'	4" PVC (PRIVATE ONSITE)
6	S45°11'23"W	2	11.56'	4" PVC (PRIVATE ONSITE)

\*GRANULAR MATERIAL SHALL NOT BE SAND OR NATIVE SOIL WITH A SAND EQUIVALENT.

## GENERAL NOTES

- NO PERSON SHALL PERFORM ANY CONSTRUCTION ACTIVITY OR INSTALL ANY OBJECTS WITHIN THE PUBLIC RIGHT-OF-WAY OR EASEMENT OF THE CITY OF RIVERSIDE WITHOUT A VALID CONSTRUCTION PERMIT OR A STREET OPENING PERMIT, OR AN ENCROACHMENT PERMIT ISSUED BY THE CITY'S PUBLIC WORKS DEPARTMENT.
- IT SHALL BE THE RESPONSIBILITY OF THE CONTRACTOR TO CLEAR THE RIGHT-OF-WAY IN ACCORDANCE WITH THE PROVISIONS OF THE LAW AS IT AFFECTS EACH UTILITY INCLUDING IRRIGATION LINES AND APPURTENANCES AND AT NO COST TO THE CITY.
- CONSTRUCTION SHALL BE IN ACCORDANCE WITH THE CITY OF RIVERSIDE DEPARTMENT OF PUBLIC WORKS, STANDARD DRAWINGS, ITS SUPPLEMENTAL NOTES AND THE STANDARD SPECIFICATIONS FOR PUBLIC WORKS CONSTRUCTION, CURRENT EDITION.
- THE PRIVATE ENGINEER SIGNING THESE PLANS IS RESPONSIBLE FOR ASSURING THE ACCURACY AND ACCEPTABILITY OF THE WORK HEREON. IN THE EVENT OF DISCREPANCIES ARISING DURING CONSTRUCTION, THE PRIVATE ENGINEER SHALL BE RESPONSIBLE FOR DETERMINING AN ACCEPTABLE SOLUTION AND REVISING THE PLANS FOR APPROVAL BY THE CITY.
- QUANTITIES SHOWN ARE FOR INFORMATION ONLY AND THE CITY OF RIVERSIDE IS NOT RESPONSIBLE FOR THEIR ACCURACY.
- THE DEVELOPER SHALL BE RESPONSIBLE FOR PRESERVING OR RE-ESTABLISHING AND REFERENCING SURVEY MONUMENTS DESTROYED, DISTURBED, OR BURIED AS A RESULT OF CONSTRUCTION SHOWN HEREON.
- ALL FLAGGED ELEVATIONS SHALL BE STAKED IN THE FIELD BY THE PRIVATE ENGINEER.
- THE CONTRACTOR SHALL CALL IN A LOCATION REQUEST TO UNDERGROUND SERVICE ALERT (USA), PHONE NUMBER 1-800-227-2600, TWO WORKING DAYS BEFORE DIGGING. NO CONSTRUCTION PERMIT WILL BE ISSUED BY THE PUBLIC WORKS DEPARTMENT INVOLVING EXCAVATION FOR UNDERGROUND FACILITIES UNLESS THE APPLICANT HAS BEEN PROVIDED AN INQUIRY IDENTIFICATION NUMBER BY USA.
- CONTRACTOR IS TO VERIFY EXISTING SEWER ELEVATION PRIOR TO CONSTRUCTION.
- LOCATION OF LATERALS TO BE DETERMINE IN THE FIELD AT THE DIRECTION OF THE OWNER. AVOID A CONFLICT WITH PROPOSED AND/OR EXISTING FACILITIES.
- NO FINISHED FLOOR ELEVATIONS SHALL BE LESS THAN 6" ABOVE THE UPPER MANHOLE RIM OF THE SEWER LINE SEGMENT BEING CONNECTED TO, WITHOUT HAVING A PROPER BACKWATER VALVE INSTALLED IN THE LATERAL.
- A PLUG SHALL BE INSTALLED AND WILL REMAIN IN PLACE WHERE THE NEW SEWER CONNECTS WITH THE EXISTING SEWER UNTIL THE NEW SEWER IS ACCEPTED BY THE CITY.
- THE SEWER CONTRACTOR SHALL ADJUST MANHOLES TO FINAL GRADE AFTER PAVING IS COMPLETED.
- PIPE BEDDING SHALL BE CASE "H" PER CITY STD DWG. NO. 452 UNLESS OTHERWISE SHOWN ON THE PLANS. IF GROUND WATER IS ENCOUNTERED, BEDDING SHALL BE CASE III IN ACCORDANCE WITH NOTE 2, CITY STD. DWG. NO. 452.
- ANY TRAFFIC CONTROL STRIPING OBLITERATED AND/OR BADLY WORN DURING CONSTRUCTION SHALL BE RESTORED BY THE CONTRACTOR WITHIN FIVE DAYS AFTER NOTIFICATION FROM THE CITY INSPECTOR.
- PIPE JOINTS FOR VITRIFIED CLAY PIPE SHALL BE TYPE "G" AS SPECIFIED IN SECTION 208-2.3 OF THE STANDARD SPECIFICATIONS FOR PUBLIC WORKS PROJECTS. IF PLASTIC PIPE IS ALLOWED AS AN ALTERNATIVE, ALL PIPE JOINTS SHALL BE GASKETED. GEMENTED JOINTS SHALL NOT BE ALLOWED.
- THE DEVELOPER AND/OR CONTRACTOR IS RESPONSIBLE FOR PERFORMING A VIDEO INSPECTION OF ALL NEW SEWER AND STORM DRAIN FACILITIES TO BE PUBLICLY OWNED AND MAINTAINED PRIOR TO FINAL ACCEPTANCE OF THE WORK. THE VIDEO INSPECTION MUST BE PERFORMED IN THE PRESENCE OF THE PUBLIC WORKS INSPECTOR. A RECORDING OF THE VIDEO INSPECTION MUST BE SUBMITTED TO THE CITY FOR REVIEW AND ACCEPTANCE.
- PROTECT IN PLACE - ALL EXISTING RPU WATER FACILITIES

**BENCHMARK**  
BRASS DISC STAMPED "H6-B" IN A MONUMENT WELL AT THE INTERSECTION OF JURUPA AVENUE AND MAGNOLIA AVENUE PER THE CITY OF RIVERSIDE VERTICAL CONTROL NETWORK.  
ELEVATION: 834.784 (DATUM: NGVD29)

**IMPORTANT NOTICE**  
Section 4714.0217 of the Government Code requires a Dig Alert Identification Number to be placed before a "Permit to Excavate" will be valid. For your Dig Alert I.D. Number call CALL TOLL FREE 48 HOURS BEFORE YOU DIG UNDERGROUND SERVICE ALERT 1-800-227-2600

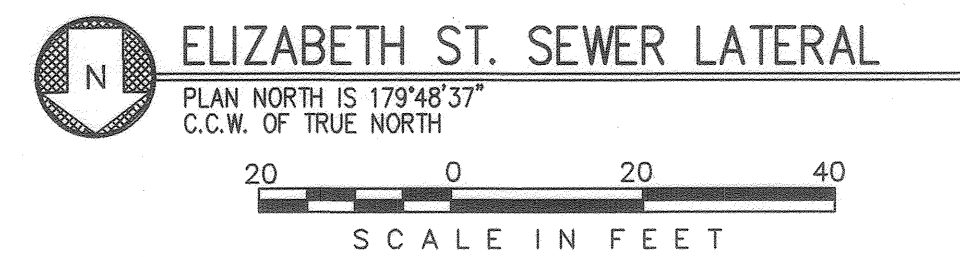

CITY OF RIVERSIDE  
PUBLIC UTILITIES DEPARTMENT  
ELECTRIC-OVERHEAD & UNDERGROUND  
APPROVED BY: *[Signature]* DATE: 7/19/16

**BASIS OF BEARINGS**  
THE BASIS FOR THIS SURVEY ARE REFERENCED TO GRID NORTH, CCS83/ZONE 6 AS DETERMINED BY CONTROL POINTS 0181 AND 2069 PER THE CITY OF RIVERSIDE HORIZONTAL CONTROL NETWORK. I.E. N 35°39'49" W

**ENGINEER IN RESPONSIBLE CHARGE**  
*[Signature]*  
Thuy Nguyen  
R.C.E. No. 84751 EXPIRES: 6-30-17  
DATE: 7/19/16

MARK	REVISIONS	APPR. DATE

DESIGNED BY: S.D. DRAWN BY: P.A. CHECKED BY: S.D.

CITY OF RIVERSIDE, CALIFORNIA  
PUBLIC WORKS DEPARTMENT  
APPROVED BY: *[Signature]* DATE: 7/19/16  
TRAFFIC ENGINEERING: *[Signature]* DATE: 7/19/16  
CITY ENGINEER/PW DIRECTOR

ELIZABETH STREET  
SEWER IMPROVEMENTS  
RIVERSIDE PLAZA SUBSTATION  
3716 ELIZABETH STREET  
ELIZABETH STREET TO ELIZABETH STREET  
HORIZONTAL SCALE: 1" = 20'  
VERTICAL SCALE: 1" = 4'

ACCT. NO.  
PW 14-0229  
S-2120  
SHEET 1 OF 1