

NOTICE TO CONTRACTOR:

CONTRACTOR AGREES THAT HE SHALL ASSUME SOLE AND COMPLETE RESPONSIBILITY FOR JOB SITE CONDITIONS DURING THE COURSE OF CONSTRUCTION OF THIS PROJECT, INCLUDING SAFETY OF ALL PERSONS AND PROPERTY; THAT THIS REQUIREMENT SHALL APPLY CONTINUOUSLY AND NOT BE LIMITED TO NORMAL WORKING HOURS; AND THAT THE CONTRACTOR SHALL DEFEND, INDEMNIFY AND HOLD THE OWNER AND THE ENGINEER HARMLESS FROM ANY AND ALL LIABILITY, REAL OR ALLEGED, IN CONNECTION WITH THE PERFORMANCE OF WORK ON THIS PROJECT, EXCEPT FOR LIABILITY ARISING FROM THE SOLE NEGLIGENCE OF THE OWNER OR THE ENGINEER.

THE EXISTENCE AND LOCATION OF ANY UNDERGROUND UTILITIES OR STRUCTURES SHOWN ON THESE PLANS ARE OBTAINED BY A SEARCH OF AVAILABLE RECORDS. TO THE BEST OF OUR KNOWLEDGE, THERE ARE NO EXISTING UTILITIES EXCEPT THOSE SHOWN ON THESE PLANS. THE CONTRACTOR IS REQUIRED TO TAKE ALL PRECAUTIONARY MEASURES TO PROTECT THE UTILITIES SHOWN, AND ANY OTHER LINES OR STRUCTURES NOT SHOWN ON THESE PLANS AND IS RESPONSIBLE FOR THE PROTECTION OF OR ANY DAMAGE TO THESE LINES OR STRUCTURES.

CONTRACTOR SHALL VERIFY ALL CONDITIONS AND DIMENSIONS AND SHALL REPORT ALL DISCREPANCIES TO THE ENGINEER PRIOR TO COMMENCEMENT OF WORK.

UNDERGROUND STRUCTURES

ALL UNDERGROUND STRUCTURES OR UTILITIES REPORTED BY THE OWNER OR OTHERS AND THOSE SHOWN ON THE RECORDS EXAMINED ARE INDICATED WITH THEIR APPROXIMATE LOCATION AND EXTENT.

THE OWNER, BY ACCEPTING THESE PLANS OR PROCEEDING WITH THE IMPROVEMENTS PURSUANT THERETO AGREES TO ASSUME LIABILITY AND TO HOLD THE UNDERSIGNED HARMLESS FOR ANY DAMAGES RESULTING FROM THE EXISTENCE OF UNDERGROUND UTILITIES OR STRUCTURES NOT REPORTED TO THE UNDERSIGNED, NOT INDICATED ON THE PUBLIC RECORDS EXAMINED, LOCATED AT VARIANCE WITH THAT REPORTED OR SHOWN ON THE RECORDS EXAMINED.

THE CONTRACTOR IS REQUIRED TO TAKE DUE PRECAUTIONARY MEASURES TO PROTECT THE UTILITIES OR STRUCTURES SHOWN AND ANY OTHER UTILITIES OR STRUCTURES FOUND AT THE SITE. IT SHALL BE THE CONTRACTOR'S RESPONSIBILITY TO NOTIFY THE OWNERS OF THE UTILITIES OR STRUCTURES CONCERNED BEFORE STARTING WORK.

PROFILE SCALES
 HORIZ. 1"=40'
 VERT. 1"=4'

CONSTRUCTION NOTES AND QUANTITY ESTIMATE *

ITEM	DESCRIPTION	AMOUNT	UNIT
①	INSTALL 8" VCP SEWER MAIN, CASE 2 BEDDING PER CITY OF RIVERSIDE STD. NO. 452	160	LF
②	INSTALL MANHOLE PER CITY OF RIVERSIDE STD. NO. 500	1	EA
③	INSTALL 6" VCP SEWER LATERAL PER CITY OF RIVERSIDE STD. DWG. NO. 562 (LAY FLAT)	26	LF
④	INSTALL CLEANOUT PER CITY OF RIVERSIDE STD. NO. 502	1	EA
⑤	TRENCH BACKFILL PER CITY OF RIVERSIDE STD. NO. 450	450	SF

* THE QUANTITIES SHOWN ABOVE ARE FOR BIDDING INFORMATION ONLY. THE CONTRACTOR IS TO CONSTRUCT PROJECT PER THESE PLANS AND SUBMIT CONSTRUCTION BID BASED UPON THEIR OWN QUANTITY "TAKE-OFF".

GENERAL SEWER NOTES

- NO PERSON SHALL PERFORM ANY CONSTRUCTION ACTIVITY OR INSTALL ANY OBJECTS WITHIN THE PUBLIC RIGHT-OF-WAY OR EASEMENTS OF THE CITY OF RIVERSIDE WITHOUT A VALID CONSTRUCTION PERMIT OR A STREET OPENING PERMIT OR AN ENCROACHMENT PERMIT ISSUED BY THE CITY'S PUBLIC WORKS DEPARTMENT.
- IT SHALL BE THE RESPONSIBILITY OF THE CONTRACTOR TO CLEAR THE RIGHT-OF-WAY IN ACCORDANCE WITH THE PROVISIONS OF LAW AS IT AFFECTS EACH UTILITY INCLUDING IRRIGATION LINES AND APPURTENANCES AND AT NO COST TO THE CITY.
- CONSTRUCTION SHALL BE IN ACCORDANCE WITH THE CITY OF RIVERSIDE DEPARTMENT OF PUBLIC WORKS, STANDARD DRAWINGS, ITS SUPPLEMENTAL NOTES AND THE STANDARD SPECIFICATIONS FOR PUBLIC WORKS CONSTRUCTION, CURRENT EDITION.
- THE PRIVATE ENGINEER SIGNING THESE PLANS IS RESPONSIBLE FOR ASSURING THE ACCURACY AND ACCEPTABILITY OF THE WORK HEREON. IN THE EVENT OF DISCREPANCIES ARISING DURING CONSTRUCTION, THE PRIVATE ENGINEER SHALL BE RESPONSIBLE FOR DETERMINING AN ACCEPTABLE SOLUTION AND REVISING THE PLANS FOR APPROVAL BY THE CITY.
- QUANTITIES SHOWN ARE FOR INFORMATION PURPOSES ONLY AND THE CITY OF RIVERSIDE IS NOT RESPONSIBLE FOR THE ACCURACY.
- THE DEVELOPER SHALL BE RESPONSIBLE FOR PRESERVING OR RE-ESTABLISHING AND REFERENCING SURVEY MONUMENTS DESTROYED, DISTURBED OR BURIED AS A RESULT OF CONSTRUCTION SHOWN HEREON.
- ALL FLAGGED ELEVATIONS SHALL BE STAKED IN THE FIELD BY THE PRIVATE ENGINEER.
- THE CONTRACTOR SHALL CALL IN A LOCATION REQUEST TO UNDERGROUND SERVICE ALERT (U.S.A.), PHONE 1-800-227-2800, TWO WORKING DAYS BEFORE DIGGING. NO CONSTRUCTION PERMIT WILL BE ISSUED BY THE PUBLIC WORKS DEPARTMENT INVOLVING EXCAVATION FOR UNDERGROUND FACILITIES UNLESS THE APPLICANT HAS BEEN PROVIDED AN INQUIRY IDENTIFICATION NUMBER BY U.S.A.
- CONTRACTOR IS TO VERIFY EXISTING SEWER ELEVATION PRIOR TO CONSTRUCTION.
- LOCATION OF LATERALS TO BE DETERMINED IN THE FIELD AT THE DIRECTION OF THE OWNER, AVOID CONFLICT WITH PROPOSED AND/OR EXISTING FACILITIES.
- NO FINISHED FLOOR ELEVATION SHALL BE LESS THAN 6" ABOVE THE UPPER MANHOLE RIM ELEVATION OF THE SEWER LINE SEGMENT BEING CONNECTED TO, WITHOUT HAVING A PROPER BACKWATER VALVE INSTALLED IN THE LATERAL. PROPOSED AND/OR EXISTING FACILITIES.
- A PLUG SHALL BE INSTALLED AND WILL REMAIN IN PLACE WHERE THE NEW SEWER CONNECTIONS WITH THE EXISTING SEWER UNTIL THE NEW SEWER IS ACCEPTED BY THE CITY.
- THE SEWER CONTRACTOR SHALL ADJUST MANHOLES TO FINAL GRADE AFTER PAVING IS COMPLETED.
- PIPES JOINTS FOR VITRIFIED CLAY PIPE SHALL BE TYPE "G" AS SPECIFIED IN SECTION 208-2.3 OF THE STANDARD SPECIFICATIONS FOR PUBLIC WORKS PROJECTS. IF PLASTIC PIPE IS ALLOWED AS AN ALTERNATIVE, ALL PIPE JOINTS SHALL BE GASKETED. CEMENTED JOINTS SHALL NOT BE ALLOWED.
- THE DEVELOPER AND/OR CONTRACTOR IS RESPONSIBLE FOR PERFORMING A VIDEO INSPECTION OF ALL NEW SEWER AND STORM DRAIN FACILITIES TO BE PUBLICLY OWNED AND MAINTAINED PRIOR TO FINAL ACCEPTANCE OF THE WORK. THE VIDEO INSPECTION MUST BE PERFORMED IN THE PRESENCE OF THE PUBLIC WORKS INSPECTOR. A RECORDING OF THE VIDEO INSPECTION MUST BE SUBMITTED TO THE CITY FOR REVIEW AND ACCEPTANCE.

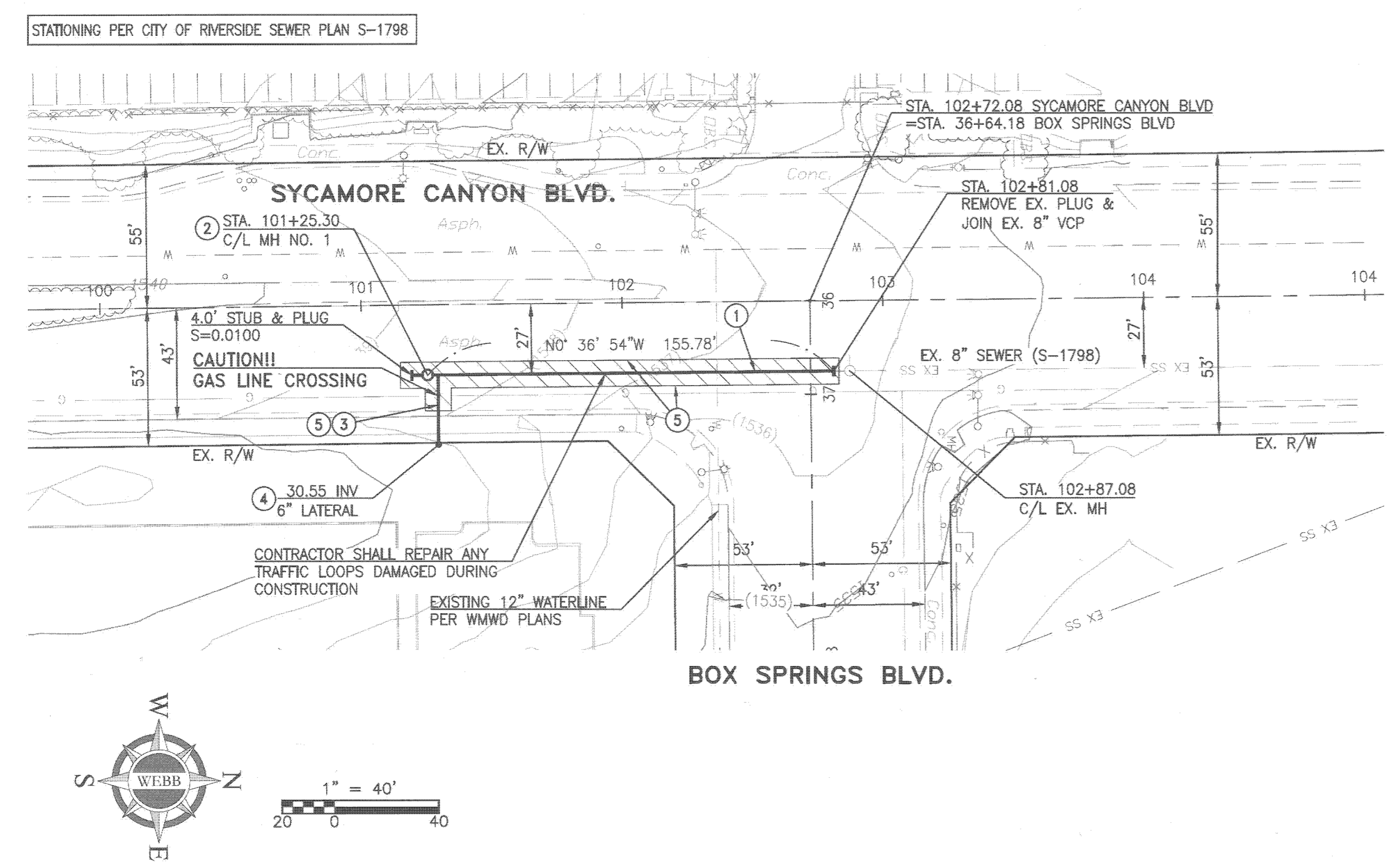

BENCH MARK

BENCH MARK DESCRIPTION:
 POINT ID: L1-B3
 ELEVATION: 1537.343 NVD 1929
 DATE LEVELED: 1997
 REFERENCE: LL43/105 REFERENCE:
 ADJUSTMENT YEAR: 1971
 3RD ORDER POINT DESCRIPTION: P.K. NAIL AND CITY ENGINEER TAG IN THE BASE OF A STREET LIGHT ALONG THE SOUTHERLY CURB OF RIVER CREST DRIVE, 70 FEET WESTERLY OF BOX SPRINGS BLVD. ADJUSTED AND ENTERED: MAY 1997

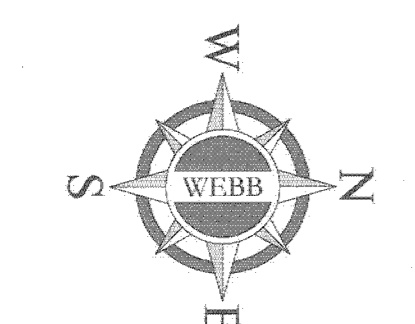
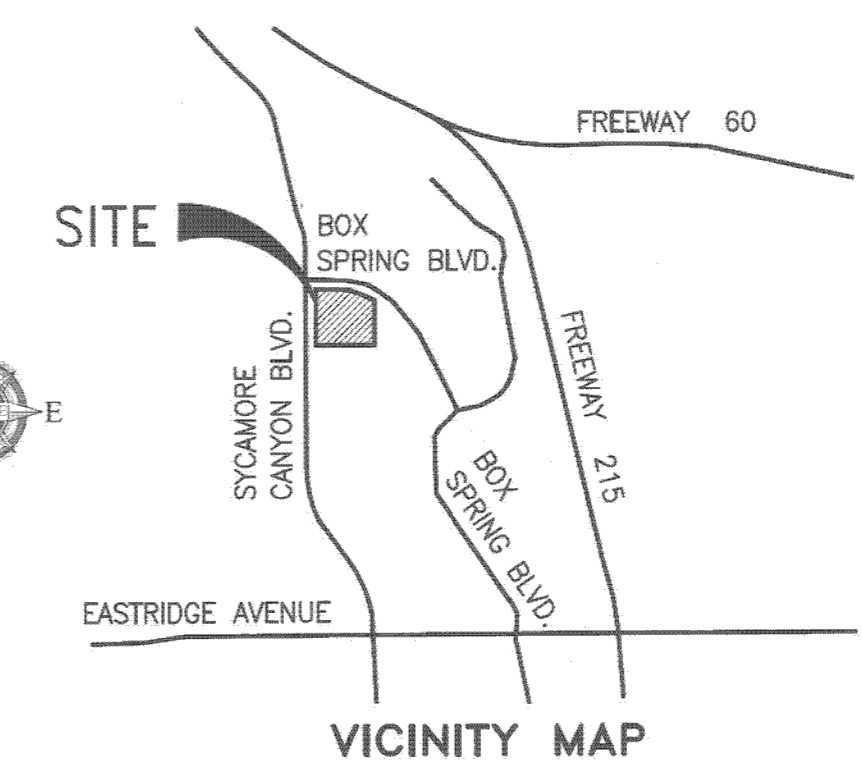

CITY BUSINESS TAX CERTIFICATE NO. 005751 EXP. 12/31/14

UNDERGROUND SERVICE ALERT
 CALL: TOLL FREE
 1-800
 227-2600
 TWO WORKING DAYS BEFORE YOU DIG

WESTERN MUNICIPAL WATER DISTRICT (WMWD)
 (FOR NON-INTERFERENCE)

APPROVED: *Derek Kanner* 08/20/2014
 DATE

REGISTERED PROFESSIONAL ENGINEER
 D. A. ARELLANO
 NO. 81988
 CIVIL
 STATE OF CALIFORNIA

ALBERT A. CIVIL ENGINEERS
WEBB 3788 McCRAY STREET
 RIVERSIDE, CA. 92506
 PH: (951) 686-1070
 FAX: (951) 788-1256
 ASSOCIATES
 PREPARED UNDER THE SUPERVISION OF:
[Signature]
 R.C.E. No. C81988 DATE: 8/10/14

MARK	REVISIONS	APPR. DATE

DRAFTED BY: a.j.g. DESIGNED BY: a.j.g. CHECKED BY: R.B. PLN CHK REF

CITY OF RIVERSIDE, CALIFORNIA
 PUBLIC WORKS DEPARTMENT

APPROVED BY: *[Signature]* BY DATE: 7/10/2014
 ENGINEERING MANAGER
 CAPITAL PROJECTS
 TRAFFIC ENGINEERING

APPROVED BY: *[Signature]* BY DATE: 7/10/2014
 CITY ENGINEER/PW DIRECTOR

CITY OF RIVERSIDE
 SEWER PLAN & PROFILE
SYCAMORE SPRINGS BUILDING
 PLOT PLAN P13-0609
 SYCAMORE CANYON BLVD.

FOR: INLAND INVESTMENTS W.O. 13-0176

PW14-0239
 ACCOUNT NO.
 DRAWING NUMBER
S-2121
 SHEET 1 of 1
 13-0176SWR