

GENERAL NOTES

- NO PERSON SHALL PERFORM ANY CONSTRUCTION ACTIVITY OR INSTALL ANY OBJECTS WITHIN THE PUBLIC RIGHT-OF-WAY OR EASEMENTS OF THE CITY OF RIVERSIDE WITHOUT A VALID CONSTRUCTION PERMIT OR, A STREET OPENING PERMIT OR AN ENCROACHMENT PERMIT ISSUED BY THE CITY'S PUBLIC WORKS DEPARTMENT.
- IT SHALL BE THE RESPONSIBILITY OF THE CONTRACTOR TO CLEAR THE RIGHT OF WAY IN ACCORDANCE WITH THE PROVISIONS OF LAW AS IT AFFECTS EACH UTILITY INCLUDING IRRIGATION LINES AND APPURTENANCES AND AT NO COST TO THE CITY.
- CONSTRUCTION SHALL BE IN ACCORDANCE WITH THE CITY OF RIVERSIDE DEPARTMENT OF PUBLIC WORKS, STANDARD DRAWINGS, ITS SUPPLEMENTAL NOTES AND THE STANDARD SPECIFICATIONS FOR PUBLIC WORKS CONSTRUCTION, CURRENT EDITION.
- THE PRIVATE ENGINEER SIGNING THESE PLANS IS RESPONSIBLE FOR ASSURING THE ACCURACY AND ACCEPTABILITY OF THE WORK HEREON. IN THE EVENT OF DISCREPANCIES ARISING DURING CONSTRUCTION, THE PRIVATE ENGINEER SHALL BE RESPONSIBLE FOR DETERMINING AN ACCEPTABLE SOLUTION AND REVISING THE PLANS FOR APPROVAL BY THE CITY.
- QUANTITIES SHOWN ARE FOR INFORMATION ONLY AND THE CITY OF RIVERSIDE IS NOT RESPONSIBLE FOR THEIR ACCURACY.
- THE DEVELOPER SHALL BE RESPONSIBLE FOR PRESERVING OR RE-ESTABLISHING AND REFERENCING SURVEY MONUMENTS DESTROYED, DISTURBED OR BURIED AS A RESULT OF CONSTRUCTION SHOWN HEREON.
- ALL FLAGGED ELEVATIONS SHALL BE STAKED IN THE FIELD BY THE PRIVATE ENGINEER.
- THE CONTRACTOR SHALL CALL IN A LOCATION REQUEST TO UNDERGROUND SERVICE ALERT (USA), PHONE# 1-800-227-2600, TWO WORKING DAYS BEFORE DIGGING. NO CONSTRUCTION PERMIT WILL BE ISSUED BY THE PUBLIC WORKS DEPARTMENT INVOLVING EXCAVATION FOR UNDERGROUND FACILITIES UNLESS THE APPLICANT HAS BEEN PROVIDED AN INQUIRY IDENTIFICATION NUMBER BY U.S.A.
- CONTRACTOR IS TO VERIFY EXISTING SEWER ELEVATION PRIOR TO CONSTRUCTION.
- LOCATION OF LATERALS TO BE DETERMINED IN THE FIELD AT THE DIRECTION OF THE OWNER. AVOID CONFLICT WITH PROPOSED AND/OR EXISTING FACILITIES.
- NO FINISHED FLOOR ELEVATION SHALL BE LESS THAN 6" ABOVE THE UPPER MANHOLE RIM ELEVATION OF THE SEWER LINE SEGMENT BEING CONNECTED TO, WITHOUT HAVING A PROPER BACKWATER VALVE INSTALLED IN THE LATERAL.
- A PLUG SHALL BE INSTALLED AND WILL REMAIN IN PLACE WHERE THE NEW SEWER CONNECTS WITH THE EXISTING SEWER UNTIL THE NEW SEWER IS ACCEPTED BY THE CITY.
- THE SEWER CONTRACTOR SHALL ADJUST MANHOLES TO FINAL GRADE AFTER PAVING IS COMPLETED.
- PIPES JOINTS FOR VITRIFIED CLAY PIPE SHALL BE TYPE "G" AS SPECIFIED IN SECTION 208-2.3 OF THE STANDARD SPECIFICATIONS FOR PUBLIC WORKS PROJECTS. IF PLASTIC PIPE IS ALLOWED AS AN ALTERNATIVE, ALL PIPE JOINTS SHALL BE GASKETED. CEMENTED JOINTS SHALL NOT BE ALLOWED.
- THE DEVELOPER AND CONTRACTOR ARE RESPONSIBLE FOR PERFORMING A VIDEO INSPECTION OF ALL NEW SEWER FACILITIES TO BE PUBLICLY OWNED AND MAINTAINED PRIOR TO FINAL ACCEPTANCE OF THE WORK. THE VIDEO INSPECTION MUST BE PERFORMED IN THE PRESENCE OF THE PUBLIC WORKS INSPECTOR. A RECORDING OF THE VIDEO INSPECTION MUST BE SUBMITTED TO THE CITY FOR REVIEW AND ACCEPTANCE.

SEWER IMPROVEMENT PLAN

FOR

DOOLITTLE CENTER 6610 DOOLITTLE AVENUE RIVERSIDE, CA

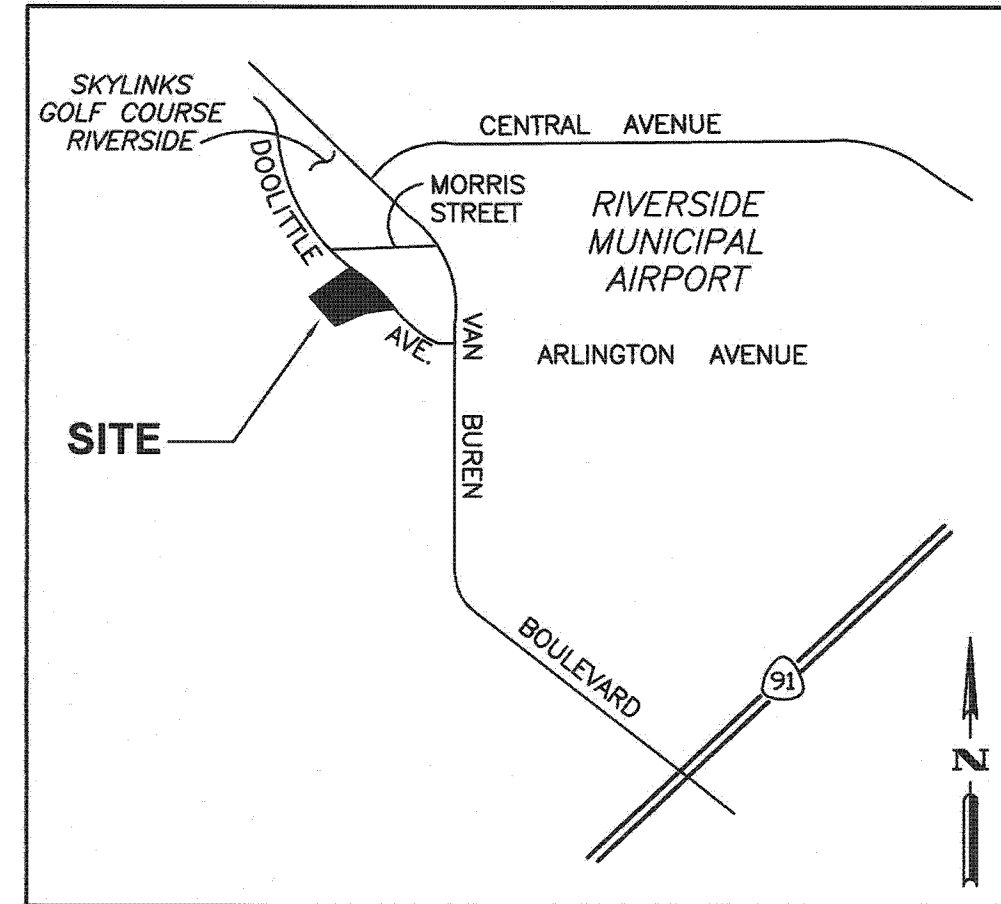

VICINITY MAP

NOT TO SCALE
THOMAS GUIDE MAP PG 714, GRID G2

PRIVATE ENGINEER'S NOTICE TO CONTRACTORS

THE EXISTENCE AND LOCATION OF ANY UNDERGROUND UTILITY PIPES OR STRUCTURES SHOWN ON THIS PLAN ARE OBTAINED BY A SEARCH OF AVAILABLE RECORDS. TO THE BEST OF OUR KNOWLEDGE THERE ARE NO EXISTING UTILITIES EXCEPT AS SHOWN ON THESE PLANS. THE CONTRACTOR IS REQUIRED TO TAKE DUE PRECAUTIONARY MEASURES TO PROTECT THE UTILITIES SHOWN AND ANY OTHER LINES OR STRUCTURES NOT SHOWN ON THESE PLANS.

ALL CONTRACTORS AND SUBCONTRACTORS PERFORMING WORK SHOWN ON OR RELATED TO THESE PLANS SHALL CONDUCT THEIR OPERATIONS SO THAT ALL EMPLOYEES ARE PROVIDED A SAFE PLACE TO WORK AND THE PUBLIC IS PROTECTED. ALL CONTRACTORS AND SUBCONTRACTORS SHALL COMPLY WITH THE "OCCUPATIONAL SAFETY AND HEALTH REGULATIONS" OF THE U.S. DEPARTMENT OF LABOR, AND THE STATE OF CALIFORNIA DEPARTMENT OF INDUSTRIAL RELATIONS' "CONSTRUCTION SAFETY ORDERS".

THE CIVIL ENGINEER SHALL NOT BE RESPONSIBLE IN ANY WAY FOR THE CONTRACTORS' AND SUBCONTRACTORS' COMPLIANCE WITH THE "OCCUPATIONAL SAFETY AND HEALTH REGULATIONS" OF THE U.S. DEPARTMENT OF LABOR OR WITH THE STATE OF CALIFORNIA DEPARTMENT OF INDUSTRIAL RELATIONS' "CONSTRUCTION SAFETY ORDERS".

CONTRACTOR FURTHER AGREES THAT HE SHALL ASSUME SOLE AND COMPLETE RESPONSIBILITY FOR JOB SITE CONDITIONS DURING THE COURSE OF CONSTRUCTION OF THIS PROJECT, INCLUDING SAFETY OF ALL PERSONS AND PROPERTY; THAT THIS REQUIREMENT SHALL APPLY CONTINUOUSLY AND NOT BE LIMITED TO NORMAL WORKING HOURS; AND THAT THE CONTRACTOR SHALL DEFEND, INDEMNIFY AND HOLD THE OWNER AND THE ENGINEER HARMLESS FROM ANY AND ALL LIABILITY, REAL OR ALLEGED, IN CONNECTION WITH THE PERFORMANCE OF WORK ON THIS PROJECT, EXCEPTING FOR LIABILITY ARISING FROM THE SOLE NEGLIGENCE OF THE OWNER OR THE ENGINEER.

UNAUTHORIZED CHANGES AND USES

THE ENGINEER PREPARING THESE PLANS WILL NOT BE RESPONSIBLE FOR, OR LIABLE FOR, UNAUTHORIZED CHANGES TO OR USES OF THESE PLANS. ALL CHANGES TO THE PLANS MUST BE IN WRITING AND MUST BE APPROVED BY THE PREPARER OF THESE PLANS.

BENCHMARK

CITY OF RIVERSIDE BENCHMARK H3-H3 ELEV.=740.967 N.A.V.D. 29 DATUM (ADJ. 2009) BEING DESCRIBED BY THE CITY OF RIVERSIDE AS FOLLOWS: P.K. NAIL AND CITY ENGINEER TAG IN THE NORTHWEST CORNER OF AN ELECTRIC VAULT AT THE SOUTHWEST CORNER OF VAN BURDEN BLVD. AND MORRIS STREET. B.M. TRANSFER AS PART OF SIGNAL INSTALLATION: DEC. 1999

BASIS OF BEARING

THE BEARINGS SHOWN HEREON ARE BASED UPON THE CENTERLINE OF DOOLITTLE AVENUE BEING NORTH 53°47'17" EAST AS SHOWN ON PARCEL MAP NO. 33033, P.M.B. 223/73-75.

CONSTRUCTION NOTES

- PROTECT IN PLACE. 1 EACH
- REMOVE PLUG INSTALL BANDED RUBBER COUPLING (IF NEEDED) AND JOIN 8" V.C.P. SEWER. 1 EACH
- CONSTRUCT 6" V.C.P. SEWER WITH CASE I BEDDING PER CITY OF RIVERSIDE STD. DWG. NO. 452. 47 L.F.
- CONSTRUCT 8" V.C.P. SEWER WITH CASE I BEDDING PER CITY OF RIVERSIDE STD. DWG. NO. 452. 37 L.F.
- CONSTRUCT MANHOLE PER CITY OF RIVERSIDE STD. DWG. NO. 500. 2 EACH
- TRENCH BACKFILL PER CITY OF RIVERSIDE STD. DWG. NO. 453. 85 L.F.

NOTES

- CONTRACTOR TO VERIFY HORIZONTAL AND VERTICAL LOCATION OF JOIN POINT(S) BEFORE ANY CONSTRUCTION AND NOTIFY THE ENGINEER OF ANY DISCREPANCIES.
- FOR PUBLIC WATER IMPROVEMENTS REFER TO PLAN D5-1901583.
- FOR PRECISE GRADING PLANS REFER TO PW18-0415.
- FOR STREET IMPROVEMENTS REFER TO R-4457.
- GRANULAR MATERIALS SHALL NOT BE SAND OR NATIVE MATERIAL.
- PIPE JOINTS FOR VCP SHALL BE TYPE "G" AS SPECIFIED IN SECTION 208-2.3 OF THE STANDARD SPECIFICATIONS.

UTILITY PURVEYORS:

WATER.....CITY OF RIVERSIDE UTILITIES
SEWER.....CITY OF RIVERSIDE UTILITIES
ELECTRICAL.....CITY OF RIVERSIDE UTILITIES
GAS.....SOCAL GAS
TELEPHONE.....AT&T
CABLE.....TIME WARNER

OWNER/DEVELOPER:

DOOLITTLE RIVERSIDE LLC
2151 MICHELSON DR., STE 295
IRVINE, CA 92616
(949) 722-7058
RICHARD REEMAN

SOILS ENGINEER:

NORCAL ENGINEERING
10641 HUMBOLT ST.
LOS ALAMITOS, CA 90720
(562) 799-9469
PROJ. NO.: 13657-07
DATE: APRIL 9, 2018

CITY OF RIVERSIDE BUSINESS TAX CERTIFICATE #1248898 EXP 3/31/19

UNDERGROUND SERVICE ALERT
CALL TOLL FREE:
1-800-227-2600
TWO WORKING DAYS BEFORE YOU DIG

CITY OF RIVERSIDE
WATER DEPARTMENT
APPROVED BY: *[Signature]* 1/24/19
DATE

MARIAN VADKERTI 1/22/19
DATE

WALDEN & ASSOCIATES
CIVIL ENGINEERS
LAND SURVEYORS
PLANNERS
2552 WHITE ROAD, SUITE B, IRVINE, CA 92614
(949) 660-0110 FAX: 660-0418

MARK	REVISIONS	APPR.	DATE

CITY OF RIVERSIDE, CALIFORNIA
PUBLIC WORKS DEPARTMENT

APPROVED BY	BY	DATE	APPROVED BY
PRINCIPAL ENGINEER	T.N.	2/4/19	<i>[Signature]</i>
TRAFFIC DIVISION	N/A	2-4-19	CITY ENGINEER

DESIGNED BY: *[Signature]* DRAWN BY: *[Signature]* CHECKED BY: *[Signature]*
DATE: FEB 6, 2019

DOOLITTLE CENTER
SEWER IMPROVEMENT PLAN
At 6610 DOOLITTLE AVENUE
HORIZONTAL SCALE: 1" = 20' VERTICAL SCALE: 1" = 2'

PW18-0418
S-2171
SHEET 1 OF 1

