

SEWER IMPROVEMENT PLANS FOR LINCOLN VILLAGE CITY OF RIVERSIDE

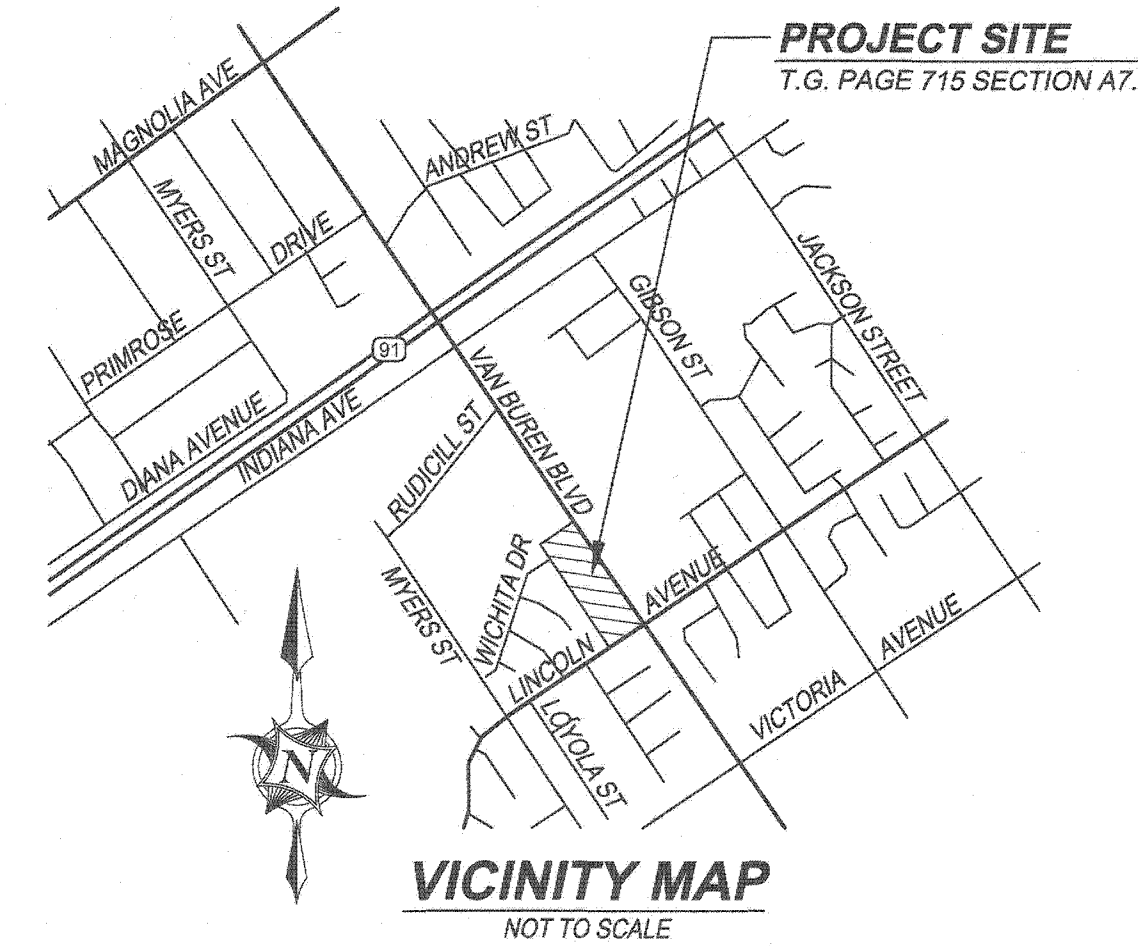

- GENERAL NOTES**
- NO PERSON SHALL PERFORM ANY CONSTRUCTION ACTIVITY OR INSTALL ANY OBJECTS WITHIN THE PUBLIC RIGHTS-OF-WAY OR EASEMENTS OF THE CITY OF RIVERSIDE WITHOUT A VALID CONSTRUCTION PERMIT OR, A STREET OPENING PERMIT OR AN ENCROACHMENT PERMIT ISSUED BY THE CITY'S PUBLIC WORKS DEPARTMENT.
 - IT SHALL BE THE RESPONSIBILITY OF THE CONTRACTOR TO CLEAR THE RIGHT OF WAY IN ACCORDANCE WITH THE PROVISIONS OF LAW AS IT AFFECTS EACH UTILITY INCLUDING IRRIGATION LINES AND APPURTENANCES AND AT NO COST TO THE CITY.
 - CONSTRUCTION SHALL BE IN ACCORDANCE WITH THE CITY OF RIVERSIDE DEPARTMENT OF PUBLIC WORKS, STANDARD DRAWINGS, ITS SUPPLEMENTAL NOTES AND THE STANDARD SPECIFICATIONS FOR PUBLIC WORKS CONSTRUCTION, CURRENT EDITION.
 - THE PRIVATE ENGINEER SIGNING THESE PLANS IS RESPONSIBLE FOR ASSURING THE ACCURACY AND ACCEPTABILITY OF THE WORK HEREON. IN THE EVENT OF DISCREPANCIES ARISING DURING CONSTRUCTION, THE PRIVATE ENGINEER SHALL BE RESPONSIBLE FOR DETERMINING AN ACCEPTABLE SOLUTION AND REVISING THE PLANS FOR APPROVAL BY THE CITY.
 - QUANTITIES SHOWN ARE FOR INFORMATION ONLY AND THE CITY OF RIVERSIDE IS NOT RESPONSIBLE FOR THEIR ACCURACY.
 - THE DEVELOPER SHALL BE RESPONSIBLE FOR PRESERVING OR RE-ESTABLISHING AND REFERENCING SURVEY MONUMENTS DESTROYED, DISTURBED OR BURIED AS A RESULT OF CONSTRUCTION SHOWN HEREON.
 - ALL FLAGGED ELEVATIONS SHALL BE STAKED IN THE FIELD BY THE PRIVATE ENGINEER.
 - ANY TRAFFIC CONTROL STRIPING OBLITERATED AND/OR BADLY WORN DURING CONSTRUCTION SHALL BE RESTORED BY THE CONTRACTOR WITHIN FIVE DAYS AFTER NOTIFICATION FROM THE CITY INSPECTORS.
 - THE CONTRACTOR SHALL CALL IN A LOCATION REQUEST TO UNDERGROUND SERVICE ALERT (USA), PHONE # 1-800-227-2600, TWO WORKING DAYS BEFORE DIGGING. NO CONSTRUCTION PERMIT WILL BE ISSUED BY THE PUBLIC WORKS DEPARTMENT INVOLVING EXCAVATION FOR UNDERGROUND FACILITIES UNLESS THE APPLICANT HAS BEEN PROVIDED AN INQUIRY IDENTIFICATION NUMBER BY U.S.A.
 - CONTRACTOR IS TO VERIFY EXISTING SEWER ELEVATION PRIOR TO CONSTRUCTION.
 - LOCATION OF LATERALS TO BE DETERMINED IN THE FIELD AT THE DIRECTION OF THE OWNER. AVOID CONFLICT WITH PROPOSED AND/OR EXISTING FACILITIES.
 - NO FINISHED FLOOR ELEVATION SHALL BE LESS THAN 6" ABOVE THE UPPER MANHOLE RIM ELEVATION OF THE SEWER LINE SEGMENT BEING CONNECTED TO, WITHOUT HAVING A PROPER BACKWATER VALVE INSTALLED IN THE LATERAL.
 - A PLUG SHALL BE INSTALLED AND WILL REMAIN IN PLACE WHERE THE NEW SEWER CONNECTS WITH THE EXISTING SEWER UNTIL THE NEW SEWER IS ACCEPTED BY THE CITY.
 - THE SEWER CONTRACTOR SHALL ADJUST MANHOLES TO FINAL GRADE AFTER PAVING IS COMPLETED.
 - PIPES, JOINTS FOR VITRIFIED CLAY PIPE SHALL BE TYPE "G" AS SPECIFIED IN SECTION 208-2.3 OF THE STANDARD SPECIFICATIONS FOR PUBLIC WORKS PROJECTS. IF PLASTIC PIPE IS ALLOWED AS AN ALTERNATIVE, ALL PIPE JOINTS SHALL BE GASKETED. CEMENTED JOINTS SHALL NOT BE ALLOWED.
 - THE DEVELOPER AND/OR CONTRACTOR IS RESPONSIBLE FOR PERFORMING A VIDEO INSPECTION OF ALL NEW SEWER AND STORM DRAIN FACILITIES TO BE PUBLICLY OWNED AND MAINTAINED PRIOR TO FINAL ACCEPTANCE OF THE WORK. THE VIDEO INSPECTION MUST BE PERFORMED IN THE PRESENCE OF THE PUBLIC WORKS INSPECTOR. A RECORDING OF THE VIDEO INSPECTION MUST BE SUBMITTED TO THE CITY FOR REVIEW AND ACCEPTANCE.

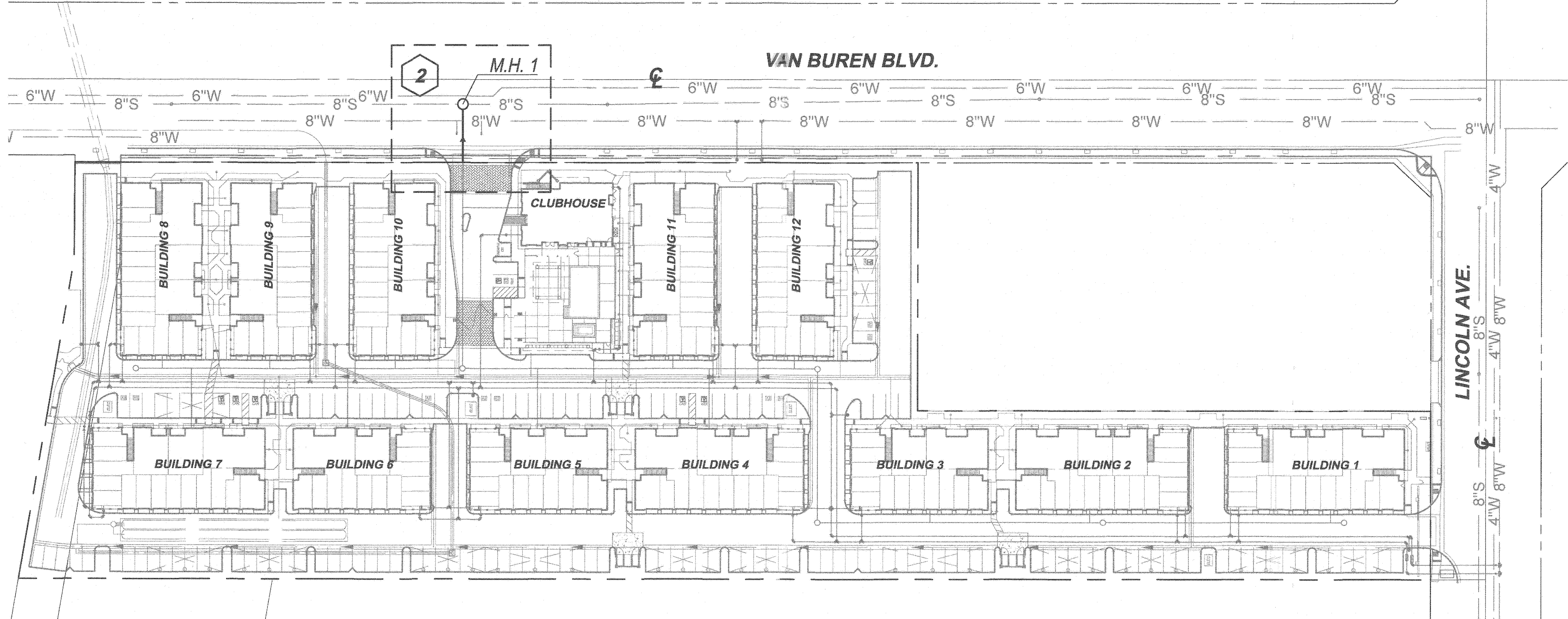

LEGEND OF ABBREVIATIONS

ANG.	ANGLE	N	NORTH
AVE.	AVENUE	NLY	NORTHERLY
AVG.	AVERAGE	N.T.C.	NOT TO SCALE
B.C.	BEGIN CURVE	NO.	NUMBER
BFP	BACKFLOW PREVENTOR	PL.	PLACE
CL	CENTERLINE	P.V.C.	POLYVINYL CHLORIDE PIPE
DR.	DRIVE	R	RADIUS
E	EAST	R.C.P.	REINFORCED CONCRETE PIPE
EA.	EACH	RD.	ROAD
E.C.	END CURVE	S	SOUTH
E.LY	EASTERLY	S.LY	SOUTHERLY
ELEV.	ELEVATION	SQ.	SQUARE
EST.	ESTIMATE	ST.	STREET
INV.	INVERT	STA.	STATION
LAT.	LATERAL	TYP.	TYPICAL
L.F.	LINEAR FEET	V.C.P.	VITRIFIED CLAY PIPE
LN.	LANE	VIC.	VICINITY
MH	MANHOLE	W	WEST
MIN.	MINIMUM	WLY	WESTERLY

SYMBOLS LEGEND

	PROPOSED STREET LIGHT
	PROPOSED STREET NAME
	PROPOSED STOP SIGN
	PROPOSED SEWER LINE
	SEWER CLEAN OUT
	PROPOSED SEWER MANHOLE
	PROPOSED SEWER LATERAL
	PROPOSED WATER LINE
	PROPOSED WATER SERVICE
	EXISTING WATER LINE
	EXISTING SEWER LINE
	EXISTING STORM DRAIN

INDEX MAP
SCALE 1"=50'

2 INDICATES SHEET NUMBER

SHEET INDEX

SHEET 1	TITLE SHEET
SHEET 2	PLAN AND PROFILE

IT IS THE CONTRACTOR / BIDDER'S RESPONSIBILITY TO REVIEW THESE PLANS AND PREPARE THEIR OWN TAKE - OFFS TO VERIFY ALL QUANTITIES INCLUDING ALL EARTHWORK QUANTITIES (RAW & REMEDIAL) TO COMPLETE ALL GRADING AND IMPROVEMENTS SHOWN ON THESE PLANS. THE QUANTITY ESTIMATE SHOWN HEREON IS FOR THE USE OF GOVERNING AGENCIES IN DETERMINING BOND AMOUNTS AND/OR FEES AND IS NOT TO BE USED FOR BID PURPOSES.

CONSTRUCTION NOTES

	QTY.	UNIT
1 CONSTRUCT 48" SEWER MANHOLE PER CITY OF RIVERSIDE STD. PLAN 800	1	EA.
2 CONSTRUCT 8" P.V.C. SEWER MAIN PIPE AND BEDDING PER CITY OF RIVERSIDE STD. PLAN 492 CASE III	42	L.F.
3 INSTALL PLUG	1	EA.

NOTE:
ALL SEWER LINES WITH SLOPE LESS THAN 1/8 INCH PER FOOT SHALL BE VERIFIED BY THE ENGINEER OF RECORD PRIOR TO THE REQUIRED INSPECTION BY THE CITY BUILDING INSPECTOR.

NOTICE TO CONTRACTOR:
CONTRACTOR AGREES THAT HE SHALL ASSUME SOLE AND COMPLETE RESPONSIBILITY FOR JOB SITE CONDITIONS DURING THE COURSE OF CONSTRUCTION OF THIS PROJECT, INCLUDING SAFETY OF ALL PERSONS AND PROPERTY; THAT THIS REQUIREMENT SHALL APPLY CONTINUOUSLY AND NOT BE LIMITED TO NORMAL WORKING HOURS; AND THAT THE CONTRACTOR SHALL DEFEND, INDEMNIFY AND HOLD THE OWNER AND THE ENGINEER HARMLESS FROM ANY AND ALL LIABILITY, REAL OR ALLEGED, IN CONNECTION WITH THE PERFORMANCE OF WORK ON THIS PROJECT, EXCEPTING FOR LIABILITY ARISING FROM THE SOLE NEGLIGENCE OF THE OWNER OR THE ENGINEER.

THE ENGINEER PREPARING THESE PLANS WILL NOT BE RESPONSIBLE FOR, OR LIABLE FOR, UNAUTHORIZED CHANGES OR USES OF THESE PLANS. ALL CHANGES TO THE PLANS MUST BE IN WRITING AND MUST BE APPROVED BY THE PREPARER OF THESE PLANS.

UNDERGROUND UTILITIES & STRUCTURES
THE EXISTENCE AND LOCATION OF ANY UNDERGROUND UTILITIES OR STRUCTURES SHOWN IN THESE PLANS WERE OBTAINED BY A SEARCH OF AVAILABLE RECORDS. TO THE BEST OF OUR KNOWLEDGE, THERE ARE NO EXISTING UTILITIES EXCEPT THOSE SHOWN ON THESE PLANS. THE CONTRACTOR IS REQUIRED TO TAKE ALL PRECAUTIONARY MEASURES TO PROTECT UTILITIES SHOWN AND ANY OTHER UTILITIES NOT OF RECORD OR NOT SHOWN ON THESE PLANS, AND IS RESPONSIBLE FOR THE PROTECTION OF AND ANY DAMAGE TO THESE LINES OR STRUCTURES.

BENCH MARK:
POINT ID: E4-J3
ELEVATION: 880.882 NAVD88 (ADJUSTED 2009)
DESC: P.K. NAIL AND CITY ENGINEER TAG IN TC OF THE SOUTHERLY CURB RETURN AT LINCOLN AVE. AND VAN BUREN BLVD.

BASIS OF BEARINGS:
THE BEARINGS HEREON IS THE CALIFORNIA STATE PLANE COORDINATE SYSTEM, ZONE 6, NORTH AMERICAN DATUM 1983, AS DETERMINED LOCALLY BY THE BETWEEN RIVERSIDE COUNTY GPS CONTROL POINT NO. 0215, BEING N25°07'57"E 1593.05 FEET (GROUND), (EPOCH 2010.00).

UNDERGROUND SERVICE ALERT
Call: Toll FREE 1-800-227-2600
TWO WORKING DAYS BEFORE YOU DIG

MAYERS & ASSOCIATES CIVIL ENGINEERING, INC.
PLANNING • ENGINEERING • SURVEYING
19 Spectrum Pointe Drive • Suite 609 Lake Forest, CA 92630
(949) 599-0870 • (949) 599-0880 Fax • www.mayerscivil.com

Jesus Taitano 3/25/19 DATE



CITY OF RIVERSIDE ELECTRIC UTILITIES DEPARTMENT	CITY OF RIVERSIDE WATER DEPARTMENT
APPROVED BY: <i>[Signature]</i> DATE: 3/25/19	APPROVED BY: <i>[Signature]</i> DATE: 3/25/19

CITY OF RIVERSIDE, CALIFORNIA
PUBLIC WORKS DEPARTMENT

APPROVED BY: <i>[Signature]</i> DATE: April 2, 2019	APPROVED BY: <i>[Signature]</i> DATE: April 2, 2019
PRINCIPAL ENGINEER	CITY ENGINEER

DESIGNED BY: S.T. DRAWN BY: S.T. CHECKED BY: J.T.

PROJECT SITE
A.P.N.: 234-270-020

MAYERS & ASSOCIATES
CITY BUSINESS TAX CERTIFICATE NO.
NO. 0109886 EXPIRES: 02/28/2019

SEWER IMPROVEMENT PLANS
LINCOLN VILLAGE
9501 LINCOLN AVENUE, RIVERSIDE
TITLE SHEET

PW18-0557

S-2174

SHEET 1 OF 2

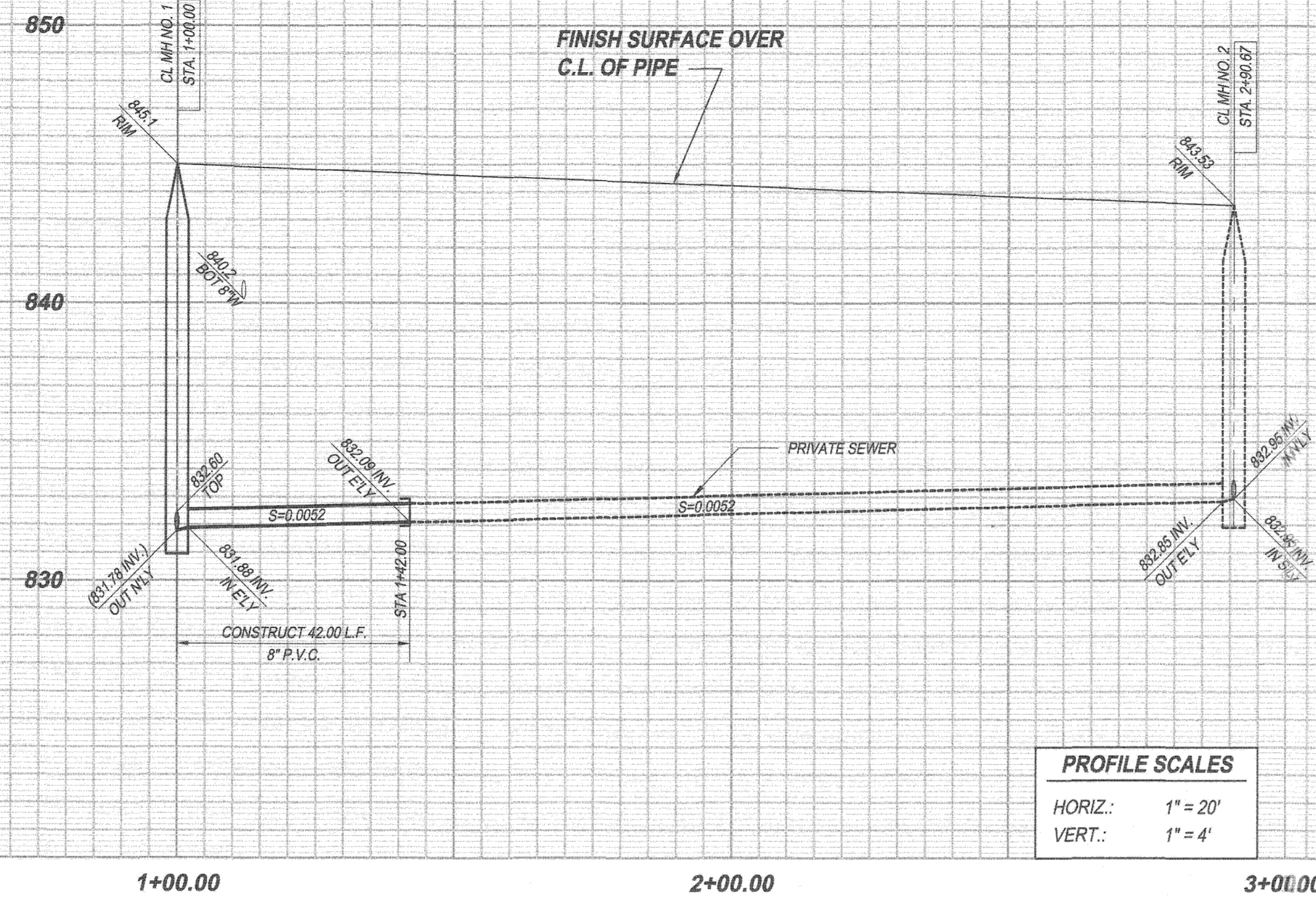

PROFILE SCALES
 HORIZ.: 1" = 20'
 VERT.: 1" = 4'

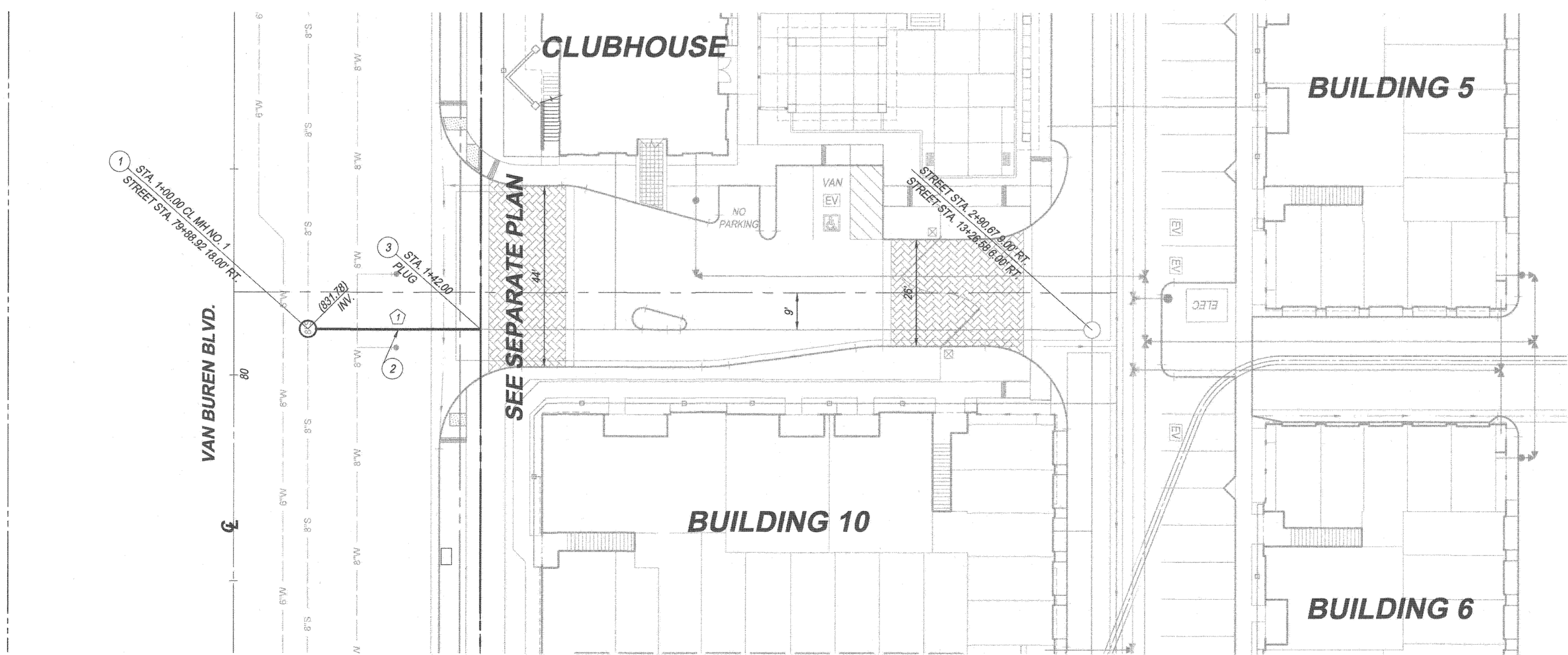

- CONSTRUCTION NOTES**
- CONSTRUCT 48" SEWER MANHOLE PER CITY OF RIVERSIDE STD. PLAN 500
 - CONSTRUCT 8" P.V.C. SEWER MAIN PIPE AND BEDDING PER CITY OF RIVERSIDE STD. PLAN 452 Q&E III
 - INSTALL PLUG AT JOIN

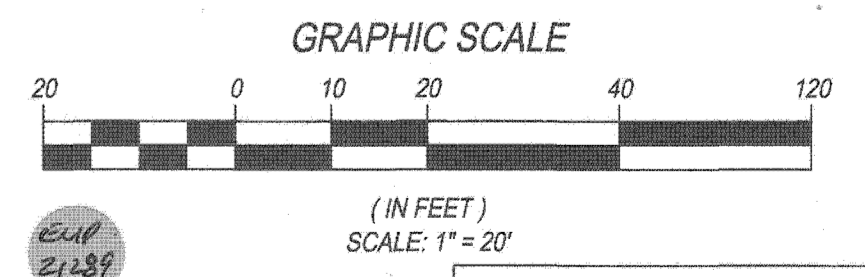
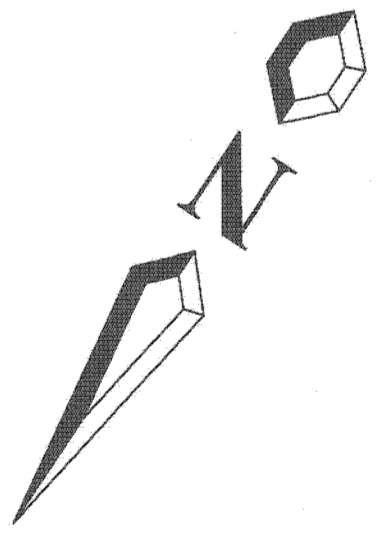

SEWER DATA TABLE

BEARING/DELTA	RADIUS	LENGTH	TANGENT
S 56°21'48" W		40.00	

BENCH MARK:
 POINT ID: E4-J3
 ELEVATION: 880.682 NAVD83 (ADJUSTED 2009)
 DESC: P.K. NAIL AND CITY ENGINEER TAG IN TC OF THE SOUTHERLY CURB RETURN AT LINCOLN AVE. AND VAN BUREN BLVD.

BASIS OF BEARINGS:
 THE BEARINGS HEREON IS THE CALIFORNIA STATE PLANE COORDINATE SYSTEM, ZONE 6, NORTH AMERICAN DATUM 1983, AS DETERMINED LOCALLY BY THE BETWEEN RIVERSIDE COUNTY GPS CONTROL POINT NO. 0215, BEING N25°07'57"E 1593.05 FEET (GROUND), (EPOCH 2010.00).

UNDERGROUND SERVICE ALERT
 Call: Toll FREE 1-800-227-2600
 TWO WORKING DAYS BEFORE YOU DIG

MAYERS & ASSOCIATES CIVIL ENGINEERING, INC.
 PLANNING • ENGINEERING • SURVEYING
 19 Spectrum Pointe Drive • Suite 609 Lake Forest, CA 92530
 (949) 599-0870 • (949) 599-0880 Fax • www.mayerscivil.com



CITY OF RIVERSIDE
 ELECTRIC UTILITIES DEPARTMENT
 APPROVED BY: [Signature] DATE: 3/25/19

CITY OF RIVERSIDE
 WATER DEPARTMENT
 APPROVED BY: [Signature] DATE: 3/25/19

NOTE:
 ALL SEWER LINES WITH SLOPE LESS THAN 1/8 INCH PER FOOT SHALL BE VERIFIED BY THE ENGINEER OF RECORD PRIOR TO THE REQUIRED INSPECTION BY THE CITY BUILDING INSPECTOR.

CITY OF RIVERSIDE, CALIFORNIA
 PUBLIC WORKS DEPARTMENT

APPROVED BY: [Signature] DATE: April 2, 2019
 APPROVED BY: [Signature] DATE: [Blank]

SEWER IMPROVEMENT PLANS
 LINCOLN VILLAGE
 9501 LINCOLN AVENUE, RIVERSIDE

S-2174
 SHEET 2 OF 2