

QUANTITY ESTIMATE

8" VITRIFIED CLAY PIPE	2194 L.F.
4" VITRIFIED CLAY PIPE	961 L.F.
8" x 4" WYES	26 EA.
MANHOLE - STD 500	8 EA.
CLEANOUT - STD 560	1 EA.

GENERAL NOTES

1. HOUSE CONNECTION WYES AND LATERALS TO BE LOCATED IN FIELD.
2. CONSTRUCTION TO BE IN ACCORDANCE WITH STANDARDS & STANDARD SPECIFICATIONS NO. 460 OF THE CITY OF RIVERSIDE, DEPARTMENT OF PUBLIC WORKS.

REVISION

MARK	DATE	DESCRIPTION
* 1	9-22-60	As Built, M.H. 4 to M.H. 5 - 4" Ball

ALBERT A. WEBB ASSOCIATES
 CIVIL ENGINEERS - RIVERSIDE, CALIFORNIA
 APPROVED *Albert A. Webb* DATE 4/4/60
 195616

CITY OF RIVERSIDE, CALIFORNIA
 DEPARTMENT OF PUBLIC WORKS

SEWER PLAN AND PROFILE
 EASEMENT AND DEL MONTE ST.
 PHOENIX AVE ELY TO DEL ROSA PL.
 PALM VIEW ESTATES

APPROVED BY *W.O. 59-282*
 DIRECTOR OF PUBLIC WORKS
 DATE May 13, 1960

NO. S230
 SHEET 1 OF 2

PROFILE

NO.	DATE	BY

PLAN

NO.	DATE	BY

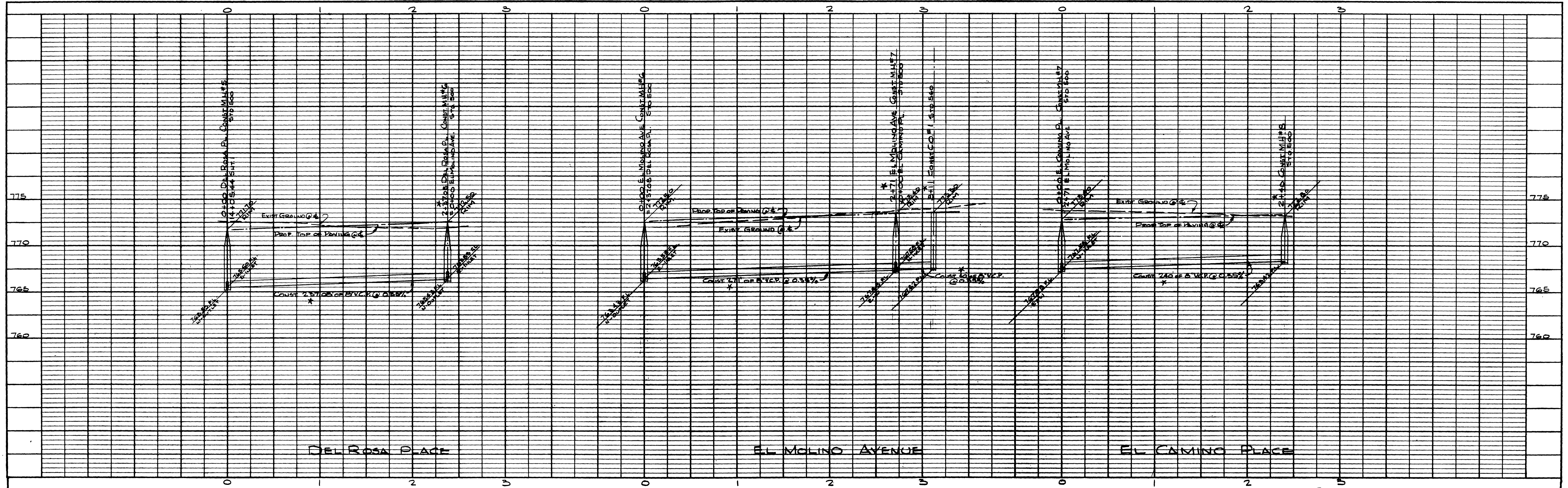

PROFILE	
NOTED	SURVEYED
BOOK	PLANNED
NO.	DATE

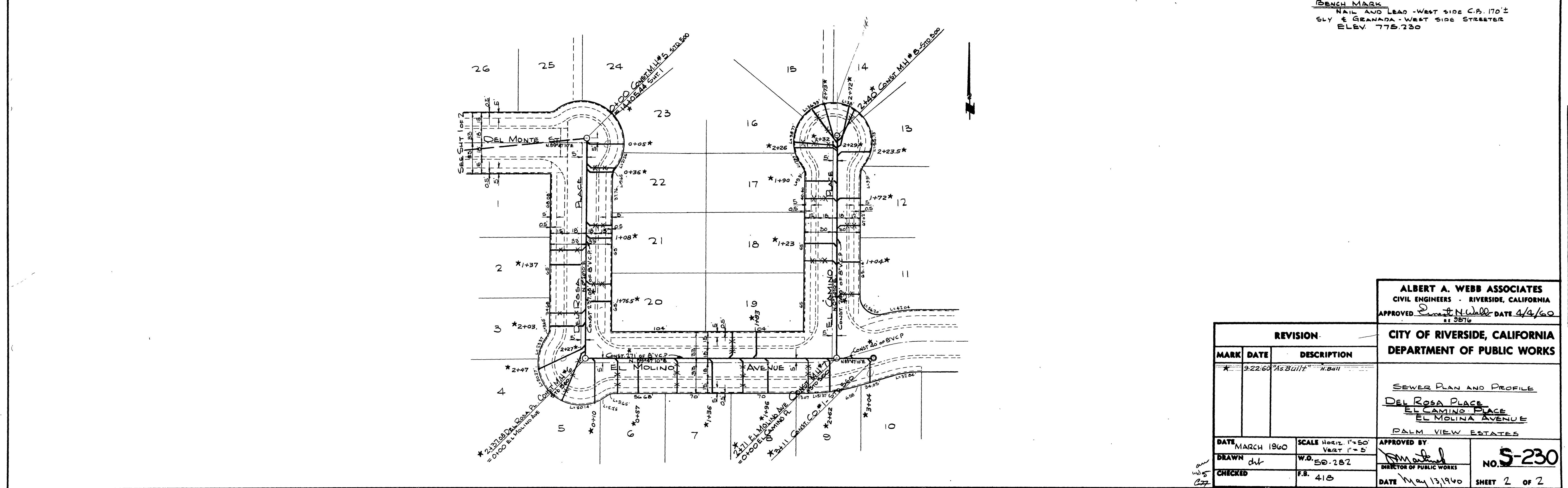

PLAN	
NOTED	SURVEYED
BOOK	PLANNED
NO.	DATE

REVISION MARK DATE DESCRIPTION * 9-22-60 "As Built" "K.B.H."		ALBERT A. WEBB ASSOCIATES CIVIL ENGINEERS - RIVERSIDE, CALIFORNIA APPROVED <i>Albert A. Webb</i> DATE 4/4/60 11 3876	
		CITY OF RIVERSIDE, CALIFORNIA DEPARTMENT OF PUBLIC WORKS SEWER PLAN AND PROFILE DEL ROSA PLACE EL CAMINO PLACE EL MOLINO AVENUE PALM VIEW ESTATES	
DATE MARCH 1960	SCALE Horiz. 1"=50' Vert. 1"=5'	APPROVED BY <i>W.D. 282</i>	NO. S-230
DRAWN <i>dt</i>	W.D. 282	DIRECTOR OF PUBLIC WORKS	
CHECKED <i>W.D. 282</i>	F.B. 418	DATE May 13, 1960	SHEET 2 OF 2