

B.M. ELEV. 826.91 S&L ON STORM DRAINAGE
 BOX N/W COR. ORANGE & COLUMBIA.
 SCALE: HOR: 1" = 50'
 VERT: 1" = 5'

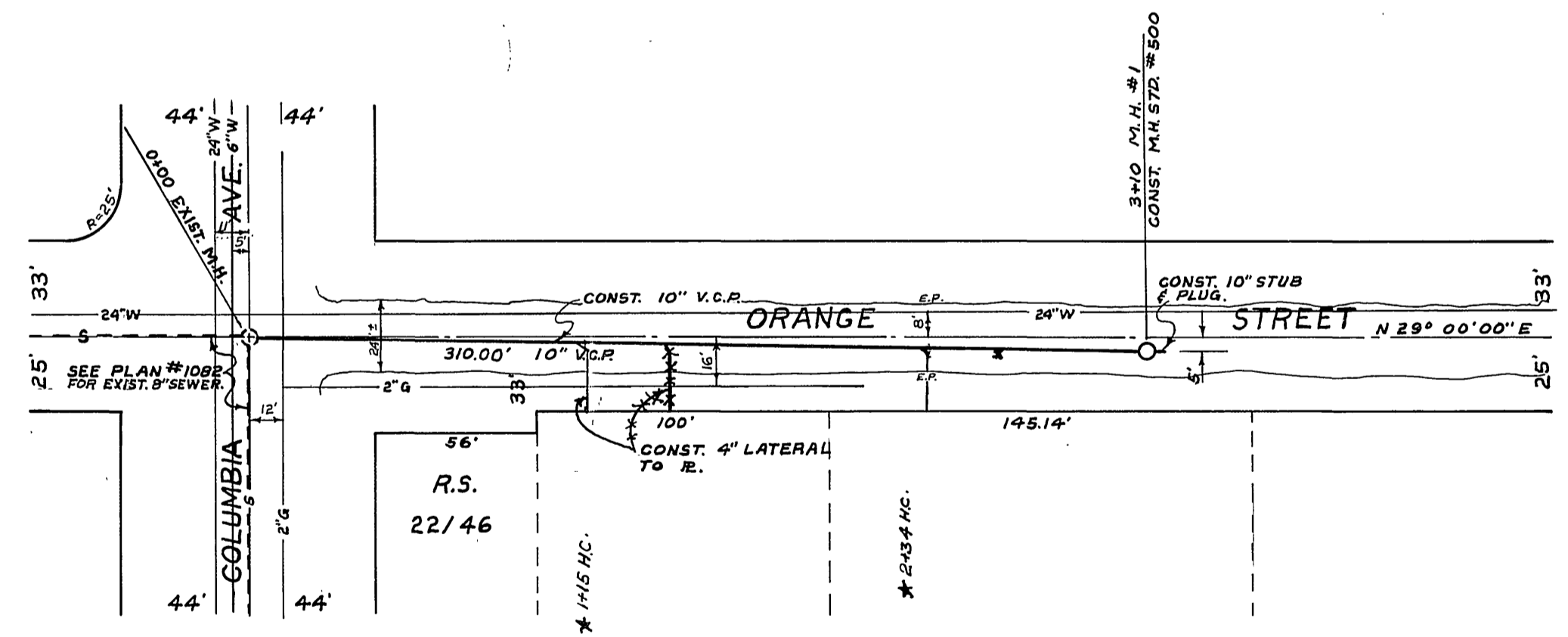
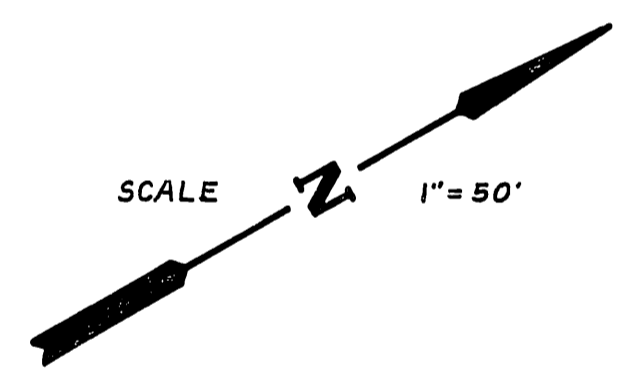

NOTE:
 1. ALL CONSTRUCTION SHALL CONFORM TO SPECIFICATION NO. 460 AND APPLICABLE STANDARD DRAWING OF THE CITY OF RIVERSIDE.
 2. WYES & LATERALS TO BE LOCATED IN THE FIELD.

★ 2.5-63 'As Built' H. Ball

CITY OF RIVERSIDE CALIFORNIA
 DEPARTMENT OF PUBLIC WORKS

ORANGE STREET
 SEWER EXTENSION NO. 1
 N'LY OF COLUMBIA AVE.

CHECKED BY: *A. R. Chahal*
 DIRECTOR OF PUBLIC WORKS

APPROVED BY: *R. Matthews*
 DIRECTOR OF PUBLIC WORKS

S-261
 SHEET 1 OF 1

PROFILE	SURVEYED	DATE
NO.	PLANNED	DATE
NO.	NOTED	DATE
NO.	CONSTRUCTED	DATE

PLAN	DESIGNED	DATE
NO.	PLANNED	DATE
NO.	NOTED	DATE
NO.	CONSTRUCTED	DATE