

SCALE
 Horiz. 1"=50'
 Vert. 1"=5'

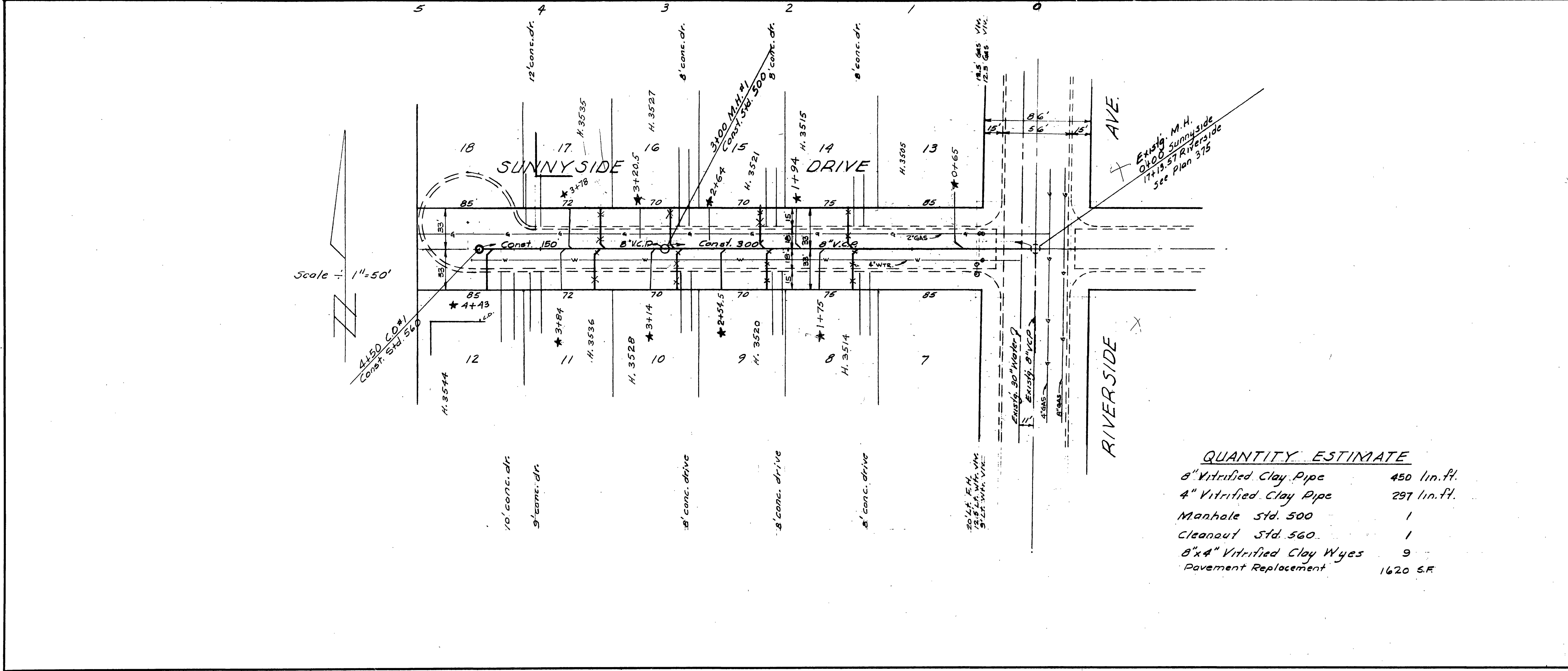

BENCH MARK Nail in NW Curb Return Sunnyside Drive & Riverside Ave. Elev. 838.48. FB 421/12
 Nail in S. Curb Return of N. Drive of Pachappa School. Elev. 842.88. FB 421/12

GENERAL NOTES
 1.- Construction shall be in accordance with the City of Riverside Department of Public Works Specifications No 460 and Standard Dwg.
 2.- House Connection Wyes shall be field located.

QUANTITY ESTIMATE

8" Vitrified Clay Pipe	450 lin. ft.
4" Vitrified Clay Pipe	297 lin. ft.
Manhole Std. 500	1
Cleanout Std. 560	1
8"x4" Vitrified Clay Wyes	9
Pavement Replacement	1620 SF

REVISIONS			CITY OF RIVERSIDE CALIFORNIA DEPARTMENT OF PUBLIC WORKS	
MARK	DATE	DESCRIPTION		
*	9/1/62	As built RK	SUNNYSIDE DRIVE SANITARY SEWER DISTRICT	
			SUNNYSIDE DRIVE	
DESIGNED BY REC	CHECKED BY	APPROVED BY	S-279	
DRAWN BY REC	<i>[Signature]</i>	<i>[Signature]</i>	DIRECTOR OF PUBLIC WORKS	
RECOMMENDED BY	<i>[Signature]</i>	DATE	3-13-61	
ASSISTANT CITY ENGINEER		SHEET 1 OF 1		

PROFILE

NOTED	BY	DATE
NOTED		
NOTED		
NOTED		

PLAN

NOTED	BY	DATE
NOTED		
NOTED		
NOTED		