

B.M. ELEV. 775.25 S&L IN C.B. 1073
S'LY OF GRANADA.

SCALE: HOR. 1"=50'
VERT. 1"=5'

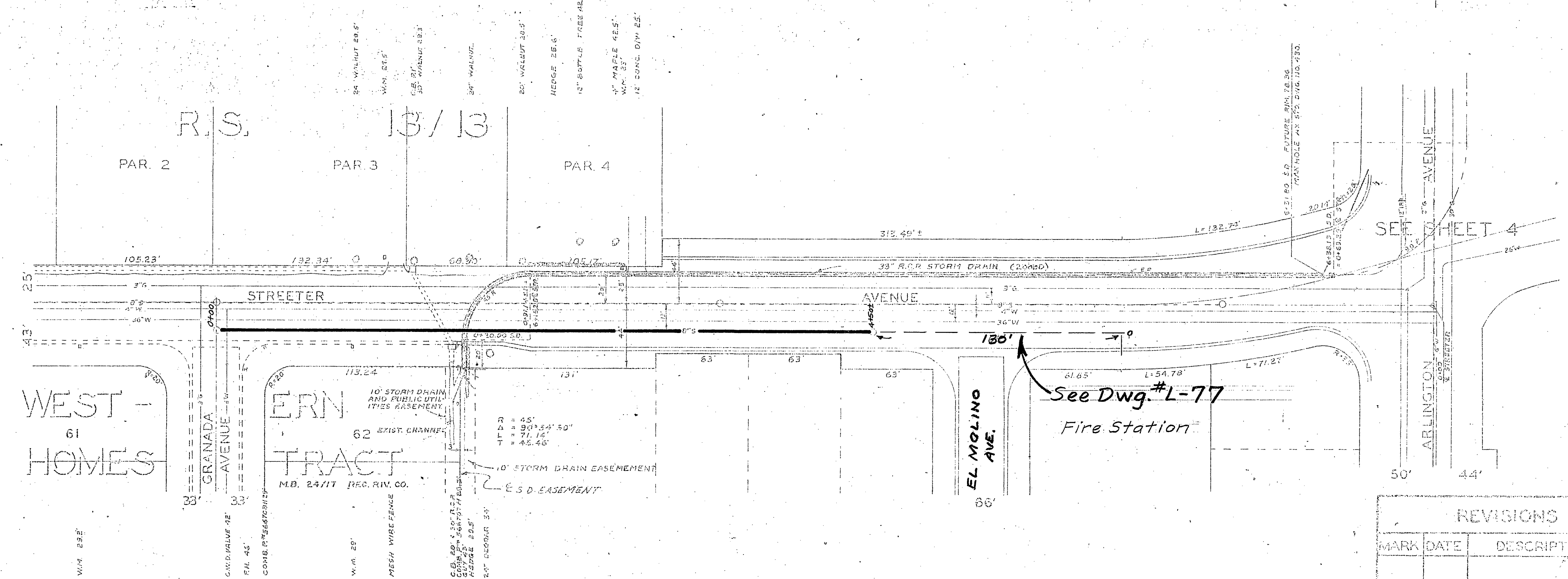
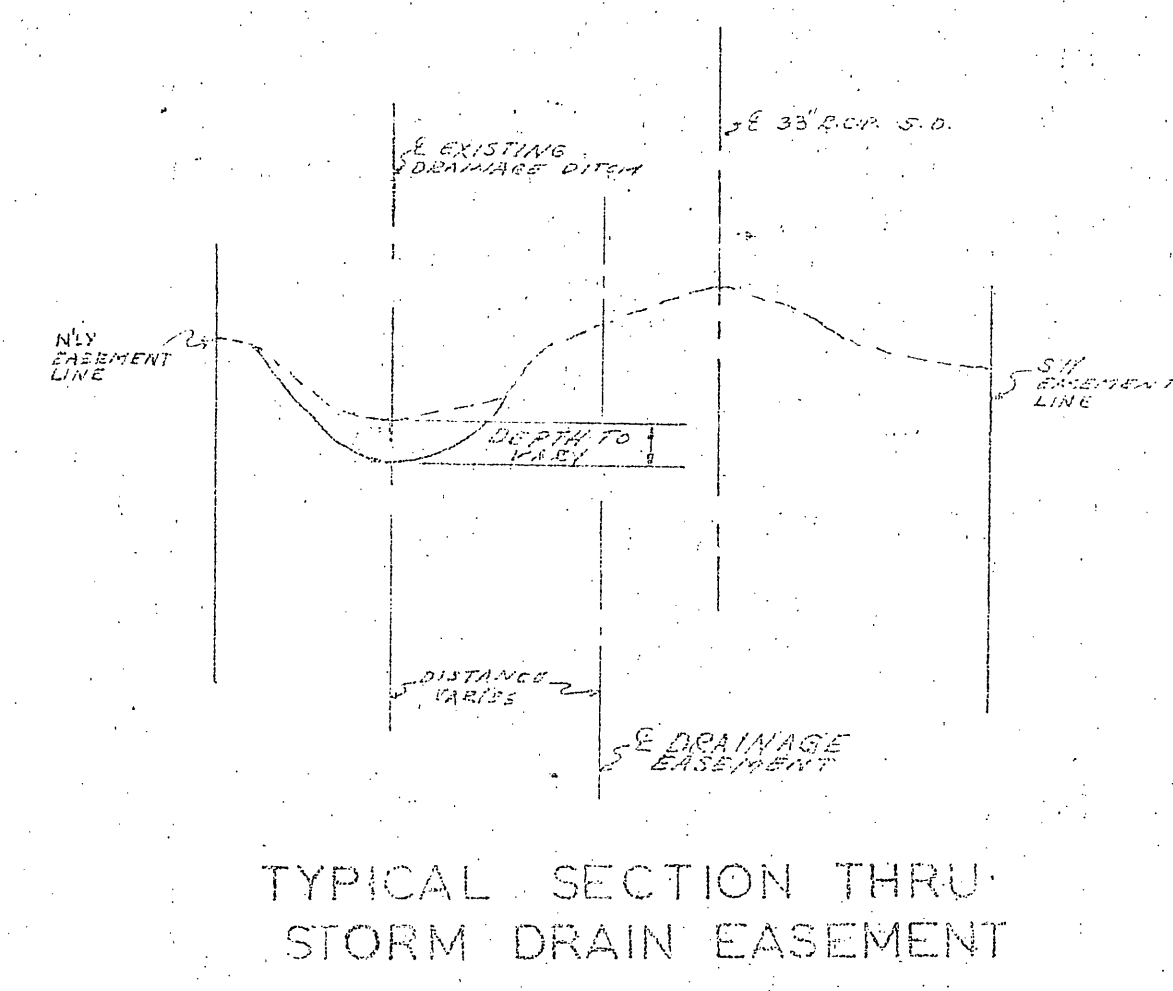

SCALE: 1"=50'

Note: This sewer was constructed to serve houses cut off from E sewer by a new 36" water main. Believed built by Street Dept. No records or field books on this. Main may have been extended 170' to serve Fire Station. See Bldg. Dept. cards.

H. Ball 2/21/62

REVISIONS		CITY OF RIVERSIDE CALIFORNIA DEPARTMENT OF PUBLIC WORKS
MARK	DATE	

DESIGNED BY	DRAWN BY	APPROVED BY

S-334

PROFILE

NO. 1	DATE	BY

PLAN

NO. 1	DATE	BY

