

PROPERTY OF
CITY OF RIVERSIDE
FILE NO. 102-379

PROPERTY OF
CITY OF RIVERSIDE
CITY ENGINEERING DEPT.

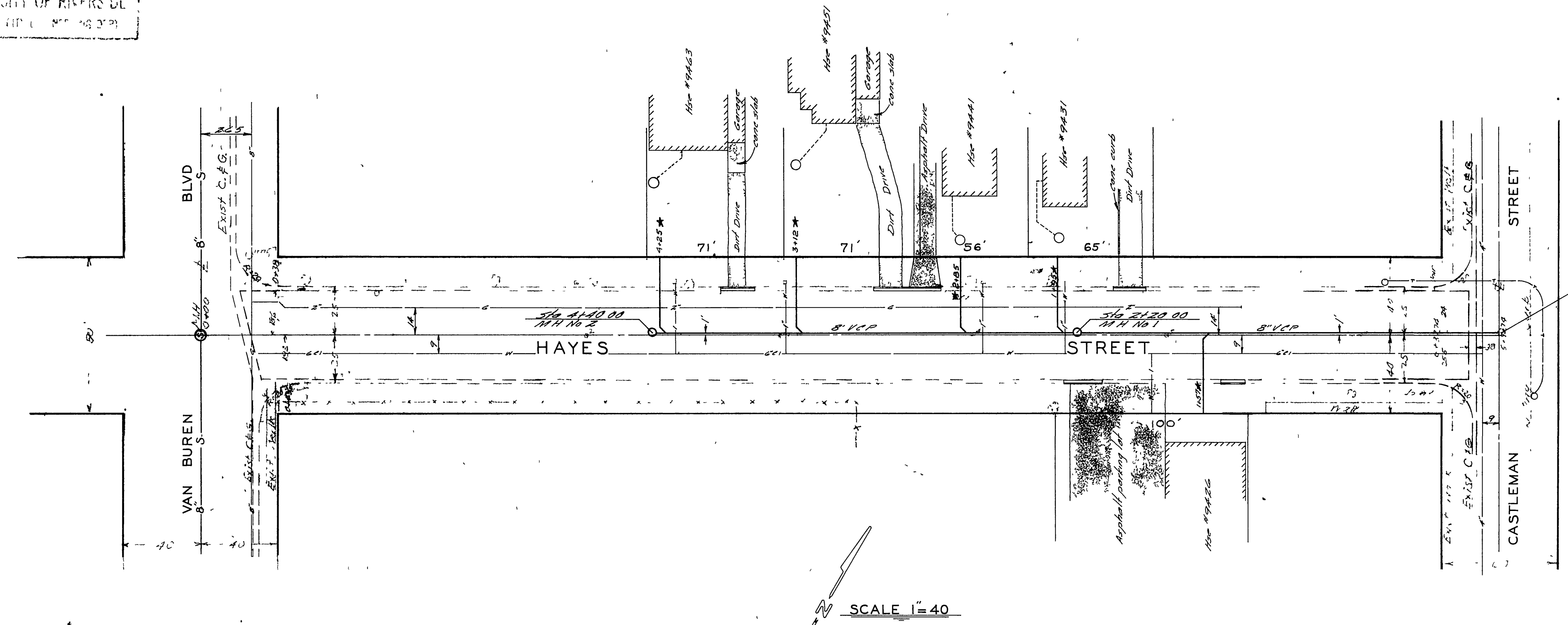

Equation
516 6172.07 (Street)
= 516 0101.00 (sewer)

- Notes**
- 1 Construct Manholes per City Std Dwg No 500
 - 2 Construct Laterals per City Std Dwg No 562
 - 3 Location of wyes & laterals to be determined in the field
 - 4 MH frames & covers to be set to exist pavement grades
 - 5 Sewer pipe shall be bedded per Case II, Std Dwg No 452
 - 6 All construction shall be in accordance with standards & specifications No 421 of the City of Riverside, Dept of Public Works.
 - 7 The existing location of any underground utility pipes or structures shown are obtained from available records. The contractor is required to take due precautionary measures to protect the utility lines shown & any other lines not of record or not shown on this plan
 - 8 Joints in vcp sewer shall conform to ASTM standard C-425-60T or the latest revision thereof
 - 9 Pavement replacement shall be 2 1/2" AC over 6" AB
 - 10 Prime coat, paint binder & seal coat is required
 - 11 Seal coat center 24' of street

- Quantities**
- 1 8" VCP - 440 LF
 - 2 4" VCP - 200 LF
 - 3 MH Std 500 - 2 EA
 - 4 8" Wyes - 5 EA
 - 5 Pavement Replacement - 1,524 SF
 - 6 Seal Coat - 14,550 SF

Adopted from Plan #427
BM ELEV 775.67 - S&L IN CORNER
COPING AT E & S SIDE OF WALK TO
LIBERTY SCHOOL, ON HAYES ST
FB S-4 / 66-70
SCALE HOR 1" = 40'
VERT 1" = 4'

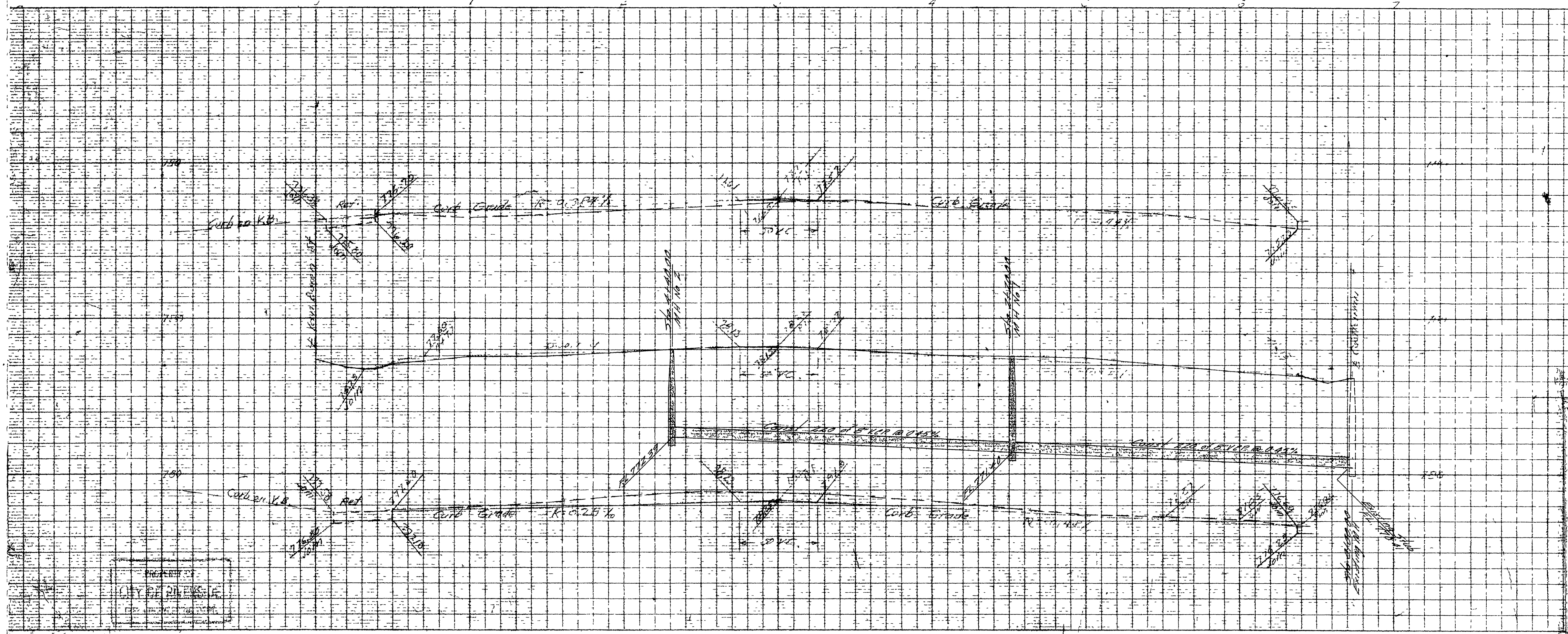

REVISIONS			CITY OF RIVERSIDE, CALIFORNIA DEPARTMENT OF PUBLIC WORKS	
MARK	DATE	DESCRIPTION		
*	4-19-63	As Built		
			HAYES STREET SEWER BET VAN BUREN BLVD & CASTLEMAN ST	
DESIGNED BY	BAD	SUBMITTED BY	APPROVED BY	PROJ NO 1012
DRAWN BY	R.M.	PARK DEPT	TRAFFIC DIV	S-405
CHECKED BY		RECOMMENDED BY	DATE 3-27-63	SHEET 1 OF 1