

HOR. 1" = 40'  
SCALE VERT. 1" = 4'

FB 550-13

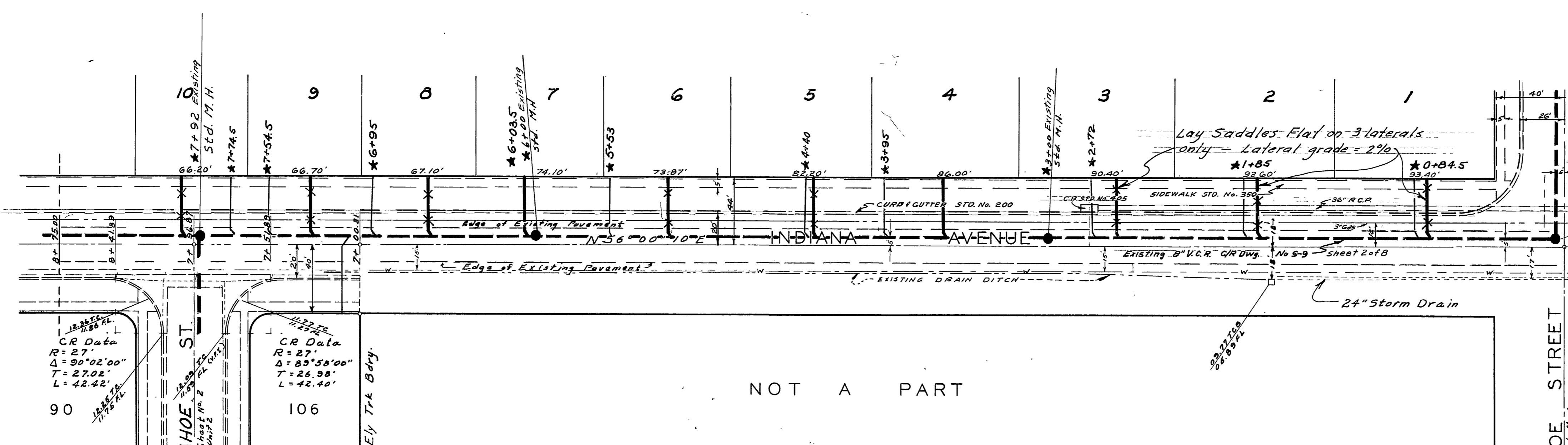

- BENCH MARKS**
- State B.M. - Pk in lead on concrete casing for M.H. 180's Elev. 812.29
  - North of  $\bar{C}$  intc of Indiana & Monroe.
  - City B.M. - Pk in lead in calcite wall 4' E of east end Elev. 829.26
  - of abutment of R.R. bridge over Monroe.
  - T.B.M. - "X" Top of storm drain wly side Monroe, Elev. 819.32
  - 1000' S South of Indiana.
  - T.B.M. - 20 penny spk. in P. Pole #12226 J 80' E east Elev. 813.99
  - of intc. of Indiana & Monroe, Nly side of Indiana.
  - T.B.M. - 20 penny spk. in P. Pole #8290 S on Sly side of Elev. 816.22
  - Indiana, 977' Wly from intc. of Indiana & Monroe.
  - T.B.M. - 20 penny spk. in P. Pole #8293 J Sly side Indiana Elev. 824.22
  - 1450' Wly from intc. of Indiana & Monroe.
  - T.B.M. - 20 penny spk. in P. Pole #2500 J on S.E. corner of Elev. 834.42
  - intc. of Jackson & Indiana.
  - T.B.M. - L & T. Top of concrete dyke Nly side of canal Elev. 842.81
  - Station 10+73.57, Amber Street (Proposed).

**GENERAL NOTES**

- Construction shall be in accordance with the City of Riverside Department of Public Works Standard Specifications No. 461 and Standard Drawings.
  - Location of Laterals to be Determined in the field.
  - All laterals to be constructed in accordance with Standard Drawing No. 562.
4. Joints in vitrified clay pipe sewer shall conform to A.S.T.M. Standard C-425-60T, or the latest revision thereto.

NOT A PART

**QUANTITY ESTIMATE**

4" Vitrified Clay Pipe	390 L.F.
Pavement Replacement (3" AC OVER 6" T.B.M.)	140 SF.

**NOTE TO CONTRACTOR**

The existence and location of any underground utility pipes or structures shown on these plans are obtained by a search of available records. To the best of our knowledge there are no existing utilities except as shown on these plans. The Contractor is required to take due precautionary measures to protect the utility lines shown & any other lines not of record or not shown on these plans.

\* = As built 9.10.63. G.S.

ALBERT A. WEBB ASSOCIATES  
CIVIL ENGINEERS - RIVERSIDE, CALIFORNIA  
APPROVED *Albert A. Webb* DATE 4/24/63  
S.E. 1970

CITY OF RIVERSIDE, CALIFORNIA  
DEPARTMENT OF PUBLIC WORKS  
**SEWER PLAN & PROFILE**  
INDIANA AVENUE  
TRACT No. 2641

REVISION		DATE	DESCRIPTION
MARK	DATE		

APPROVED BY *Albert A. Webb*  
Director of Public Works  
DATE *Aug 9 1963* SHEET *1* OF *1*

DWG. No. 63-77-B