

TELEPHONE CO. BURIED CABLE  
 Notify Telephone Co. 24 hours  
 in advance of any excavation  
 in this area.  
 Call 684-0071 or 547-6606

NOTE:  
 Southern California Gas Company  
 is to be called 48 hours (minimum)  
 before excavation is begun for exact  
 location and depth of pipes.  
 The exact depth of pipes is unknown - usual  
 cast practice is 30" cover.

NOTE:  
 3 Water lines exist in Indiana Avenue,  
 as follows: 20" E.S. (abandoned) 6 to 9' from E., depth unknown.  
 4" Transite 12.5' from E. 30" to 48" cover.  
 30" Steel 14' from E., depth as shown.

6. Joints in vitrified Clay Pipe Sewers shall  
 conform to A.S.T.M. Standards C-425-60 T,  
 or the latest Revision thereto.

5. BENCH MARK: Spike and lead in North end of West headwall of bridge over  
 canal of Indiana Avenue and Riverside Avenue Elevation 862.54 \* As built 2.13.64.G.S.

J. F. DAVIDSON-CIVIL  
 R.E. & C.  
 APPROVED BY  
 J. J. Dardas  
 CITY OF ORANGE  
 DEPARTMENT OF PUBLIC WORKS

SEWER  
 INDIANA AVENUE  
 Station 1+80  
 Station 10+34.22  
 1"=40'

S-434  
 1 1  
 9-26-63

F.B. 754-337-43

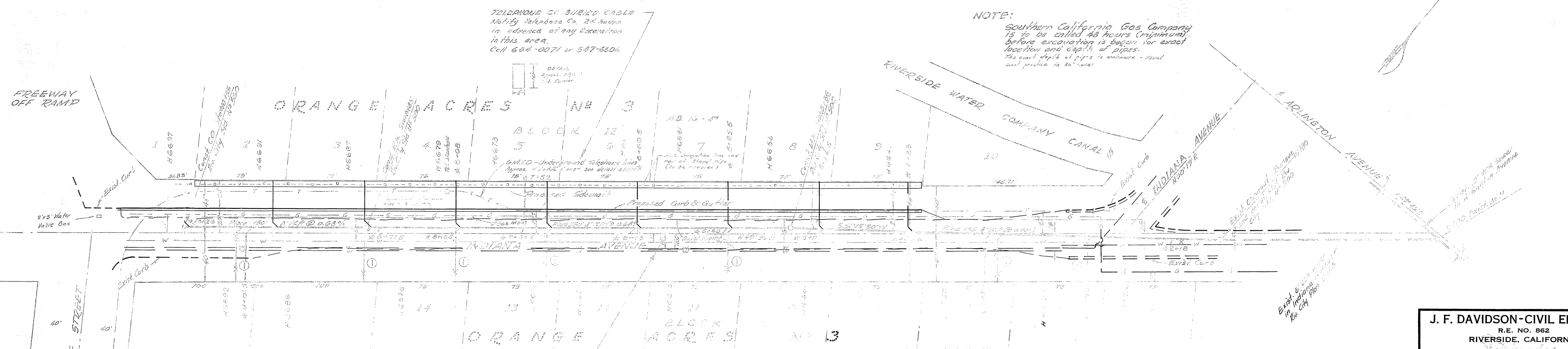
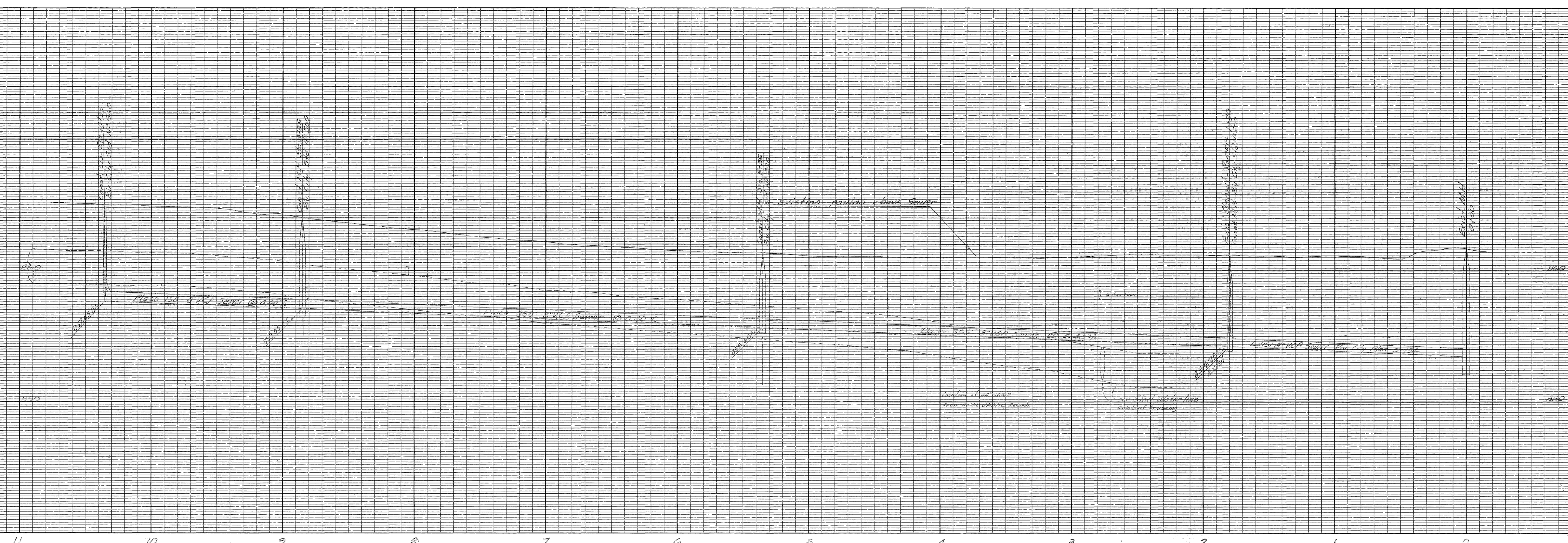

TELEPHONE CO. BURIED CABLE  
 Notify Telephone Co. 24 hours  
 in advance of any excavation  
 in this area.  
 Cell 684-0077 or 547-6606

NOTE:  
 Southern California Gas Company  
 is to be called 48 hours (minimum)  
 before excavation is begun for exact  
 location and depth of pipes.  
 The exact depth of pipes is unknown - usual  
 and practice is 30" - 40"

NOTE:  
 3" water lines are 3" minimum clearance  
 as follows: 2" to 2' 6" clearance to 6" of face of manhole  
 2" to 2' 6" clearance to 6" of face of manhole  
 2" to 2' 6" clearance to 6" of face of manhole

- NOTES**
- All wyes & tees shall be 12" and extended to the property line.
  - All laterals are 12" and extended to the property line.
  - All construction shall be in accordance with Standards and Specifications No. 46 of the City of Riverside Department of Public Works. Pipe shall be bedded per Case \_\_\_\_\_, Standard Drawing No. \_\_\_\_\_.
  - It shall be the responsibility of the contractor to clear the Right of Way in accordance with the provisions of law as it affects such utility including irrigation lines and appurtenances, and at no extra cost to the City of Riverside.
  - BENCH MARK: Spike and lead in North end canal at Indiana Avenue and Riverside.

REVISIONS		
MARK	DATE	DESCRIPTION
1		Wdg OR Jgm

DESIGNED BY \_\_\_\_\_ CHECKED BY \_\_\_\_\_  
 DRAWN BY \_\_\_\_\_  
 RECOMMENDED BY \_\_\_\_\_ ASSISTANT CITY ENGINEER

**J. F. DAVIDSON-CIVIL ENGINEER**  
 R.E. NO. 962  
 RIVERSIDE, CALIFORNIA  
 APPROVED BY \_\_\_\_\_ DATE 2-2-64

**CITY OF RIVERSIDE, CALIFORNIA**  
 DEPARTMENT OF PUBLIC WORKS

INDIANA AVENUE  
 PLAN & PROFILE  
 NO. 10-24-37  
 HORIZ. SCALE 1" = 40' VERT. SCALE 1" = 4'

NO. 4-496