

RIVERSIDE COUNTY HEALTH DEPARTMENT

- FOOD ESTABLISHMENT
- TRAILER PARK
- MOTEL, APT., HOTEL
- DWELLING
- COMMERCIAL BUILDING
- WATER SOURCE
- WATER LINE LAYOUT
- SEWAGE DISPOSAL
- GAL SEPTIC TANK
- SO. FT. OF LEACH LINE
- SEWAGE PIT
- CONNECTION TO SEWER
- SEWER LINE LAYOUT
- SWIMMING POOL

This is to Certify that the Riverside County Health Department Approves for Occupancy, Construction or Installation the Item(s) Checked Above.

Date 9-5-58 By M.B. Hawken

ESTIMATE OF QUANTITIES

Standard Manholes 4
8" V.C.P. Sewer Mains 720 lin. ft.
4" V.C.P. House Connections (14) 425 lin. ft.

La Sierra Community Services District
Approved Sept 10 1958
By [Signature]

NOTES:-

House connections shall be located in the field at the direction of the Subdivider. Manholes and cleanout shall conform to Riverside County Standards.

REVISIONS	DATE	BY

BURTON W. TILDEN
SEWER PLAN & PROFILE
SIERRA VISTA AVE
SIERRA VISTA RANCHO UNIT NO. 5 & R/S 27/91

SCALE 1"=50'	ALBERT A. WEBB ASSOCIATES CIVIL ENGINEERS RIVERSIDE CALIFORNIA	W.O. 58-22
DATE 8-8-58		SHEET 1
DRAWN REC		OF SHEETS
CHECKED REC		DWG. NO.
F.B. 354		58-220

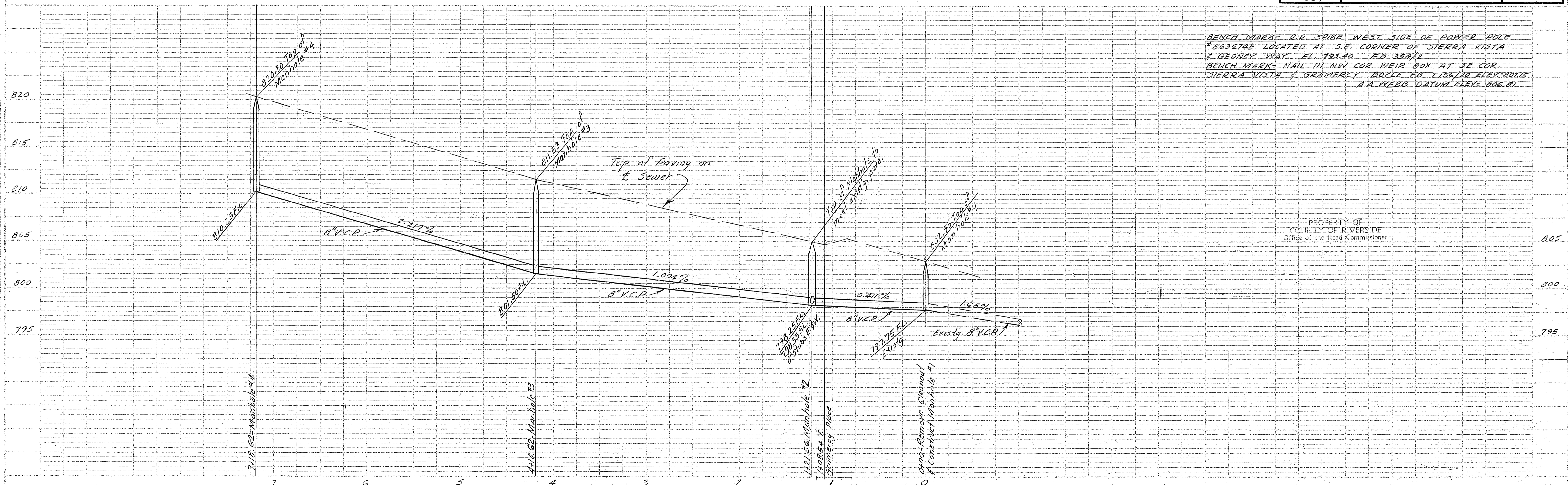

BENCH MARK - R.R. SPIKE WEST SIDE OF POWER POLE #8636782 LOCATED AT S.E. CORNER OF SIERRA VISTA & GEDNEY WAY EL. 799.40 F.B. 354/1
BENCH MARK - NAIL IN NW COR. WEIR BOX AT SE COR. SIERRA VISTA & GRAMERCY BRLE. F.B. 1156/20 ELEV. 801.5
A.A. WEBB DATUM ELEV. 806.81

PROPERTY OF
COUNTY OF RIVERSIDE
Office of the Road Commissioner