

T.B.M. Spike in tel pole # 434167H  
 Nly. side Spruce St. Wly. side  
 of A.T. & S.F. R.R.  
 F.B. 870 pg. 11, F.B. 825 pg. 21 F.B. 800 pg. 49  
 Elev. 1018.81

NOTE: Elevation of existing sewer to be verified in the field before constructing manhole.

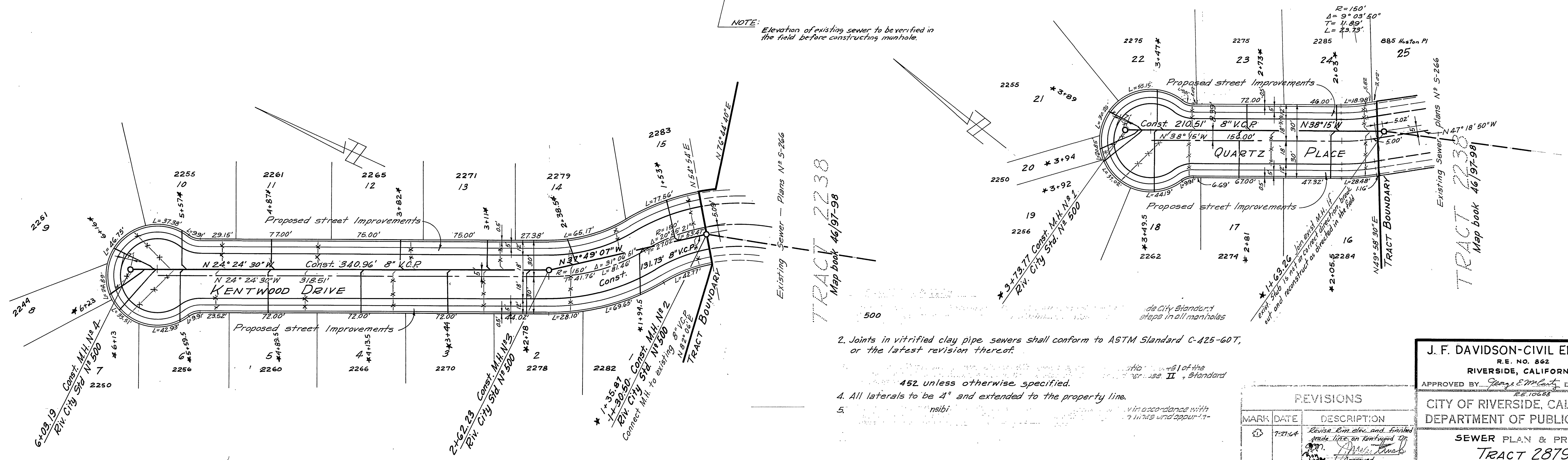

2. Joints in vitrified clay pipe sewers shall conform to ASTM Standard C-425-60T, or the latest revision thereof.
3. All laterals to be 4\"/>

REVISIONS	
MARK	DATE
1	7-21-64

**J. F. DAVIDSON-CIVIL ENGINEER**  
 R.E. NO. 862  
 RIVERSIDE, CALIFORNIA  
 APPROVED BY *George E. Maltz* DATE 7/21/64  
 R.E. 10288

**CITY OF RIVERSIDE, CALIFORNIA**  
 DEPARTMENT OF PUBLIC WORKS

**SEWER PLAN & PROFILE**  
**TRACT 2879**  
**KENTWOOD DRIVE & QUARTZ PLACE**  
 HORIZ. SCALE 1"=40' VERT. SCALE 1"=4'

DESIGNED BY *W.B.* CHECKED BY *P. Ron*  
 DRAWN BY *W.B.* DIRECTOR OF PUBLIC WORKS

RECOMMENDED BY *J.F. Davidson* ASSISTANT CITY ENGINEER DATE 5-20-64

NO. 5-530 SHEET 1 of 1

\* As built 9/22/64 B.E.