

B.M. 822.28 PK. NAIL IN CTR.  
OF SO. WEST CB. ROT. AT MAPLE-  
WOOD & BROCKTON  
F.B. 5-10 22/29  
VERT: 1"=2'  
SCALE HORIZ: 1"=20

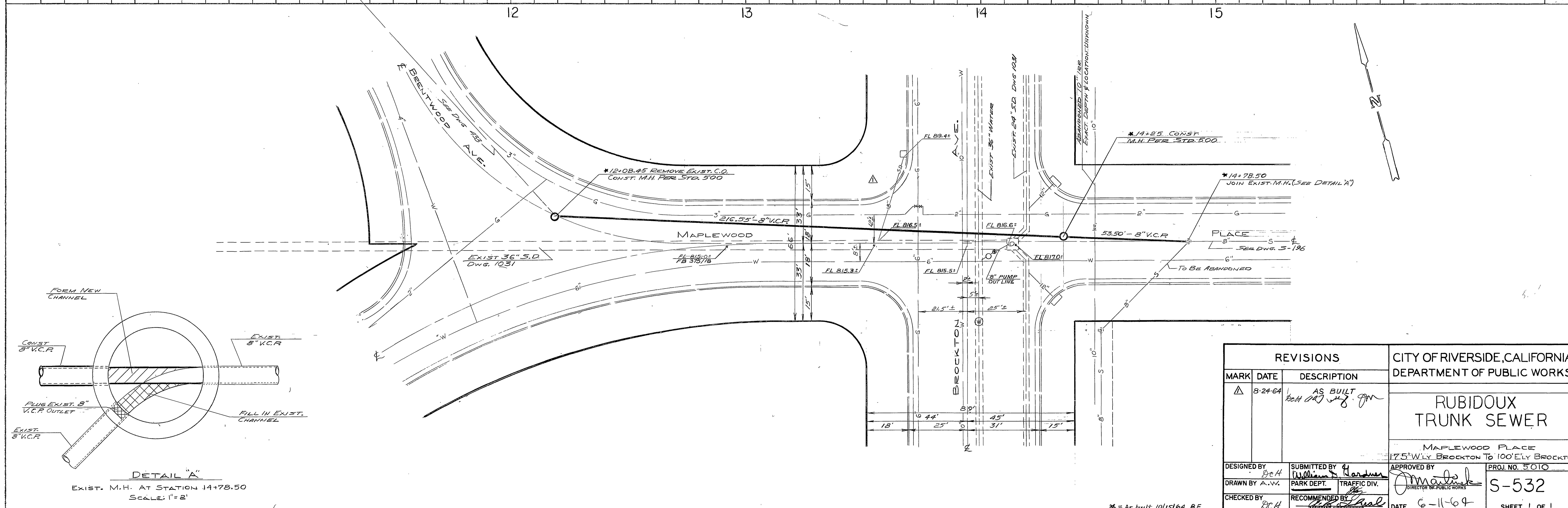

<b>REVISIONS</b>		CITY OF RIVERSIDE, CALIFORNIA DEPARTMENT OF PUBLIC WORKS  <b>RUBIDOUX TRUNK SEWER</b>  MAPLEWOOD PLACE 175' W'LY BROCKTON TO 100' E'LY BROCKTON PROJ. NO. 5010	
<b>MARK</b>	<b>DATE</b>		<b>DESCRIPTION</b>
△	8-24-64		AS BUILT <i>Belcher</i>
DESIGNED BY	SUBMITTED BY	APPROVED BY	PROJ. NO. 5010
DRAWN BY A.V.	PARK DEPT.	TRAFFIC DIV.	S-532
CHECKED BY B.C.H.	RECOMMENDED BY	DATE 6-11-64	SHEET 1 OF 1

PROF. BOOK NO.	
NOTES CHECKED	
PLANNING CHECKED	
CONSTRUCTION CHECKED	
BY	
DATE	

PLAN	
SUBMITTED	
PLANNING CHECKED	
CONSTRUCTION CHECKED	
BY	
DATE	

\* = As built 10/15/64 BE