

① APPROX. QUANTITIES
 368 L.F. 4" V.C.P.
 75 S.F. A.C. PAVING

LEGEND FOR MAIN ST. SEWER LATERAL CONST.
 ① CONTRACTOR SHALL INSTALL LATERALS FROM THESE EXISTING WYES TO BACK EDGE OF INDICATED CURB. THE SURVEYOR SHALL DETERMINE THE ELEVATION OF THE END OF THE LATERAL AND STAKE ITS LOCATION PRIOR TO BACKFILLING.

Bench Mark:
 Top of 2" I.P. in wall man at Main and Columbia from City B.M. Book, Elev. 813.95

GENERAL NOTES:

- Construction shall be in accordance with the City of Riverside, Department of Public Works, Standard Specifications No. 461 and Standard Drawings.
- It shall be the responsibility of the contractor to clear the right of way in accordance with the provisions of the law as it affects each utility including irrigation lines and appurtenances and at no cost to the City.
- Joints in vitrified clay pipe sewers shall conform to A.S.T.M. Standard C-425-60T, or the latest revision thereof.
- Pipe shall be bedded per case II, Standard Drawing No. 452, unless otherwise specified on plan.
- Location of wyes and laterals to be determined in the field.
- All wyes and laterals to be constructed in accordance with Standard Drawing No. 562. WYES shall be plugged and capped.

* AS BUILT 5-13-68 K.S.

① MAIN ST. SEWER LATERAL CONST. ① INSTALL LATERALS = PROJ. NO. 5114

① THIS CONTRACT CONSISTS ONLY OF SEWER LATERAL CONSTRUCTION FROM THE EXISTING 8" V.C.P. SHOWN ON THIS PLAN

CRAWLEY & HAWKINS SURVEYORS AND ENGINEERS Riverside, California Approved: <i>George O. Crawley</i> Date: 10/1/64 R.E. No. 3482		CITY OF RIVERSIDE, CALIFORNIA DEPARTMENT OF PUBLIC WORKS APPROVED BY: <i>[Signature]</i> DATE: 10/1/64 OFFICE ENGINEER PARK DEPARTMENT TRAFFIC DIVISION ASSISTANT CITY ENG.		SEWER PLAN & PROFILE MAIN ST. SEWER EXTENSION FROM FINLY CT. TO COLUMBIA AVE RIS 796 PROJECT NO. 5073 S-597 SHEET 1 OF 2 FILE NO.	
DESIGNED BY: <i>[Signature]</i> DRAWN BY: <i>[Signature]</i> CHECKED BY: <i>[Signature]</i>		DATE: 2-8-65 HORIZ. SCALE: 1" = 40' VERT. SCALE: 1" = 4'			

4056

4056

820

810

800

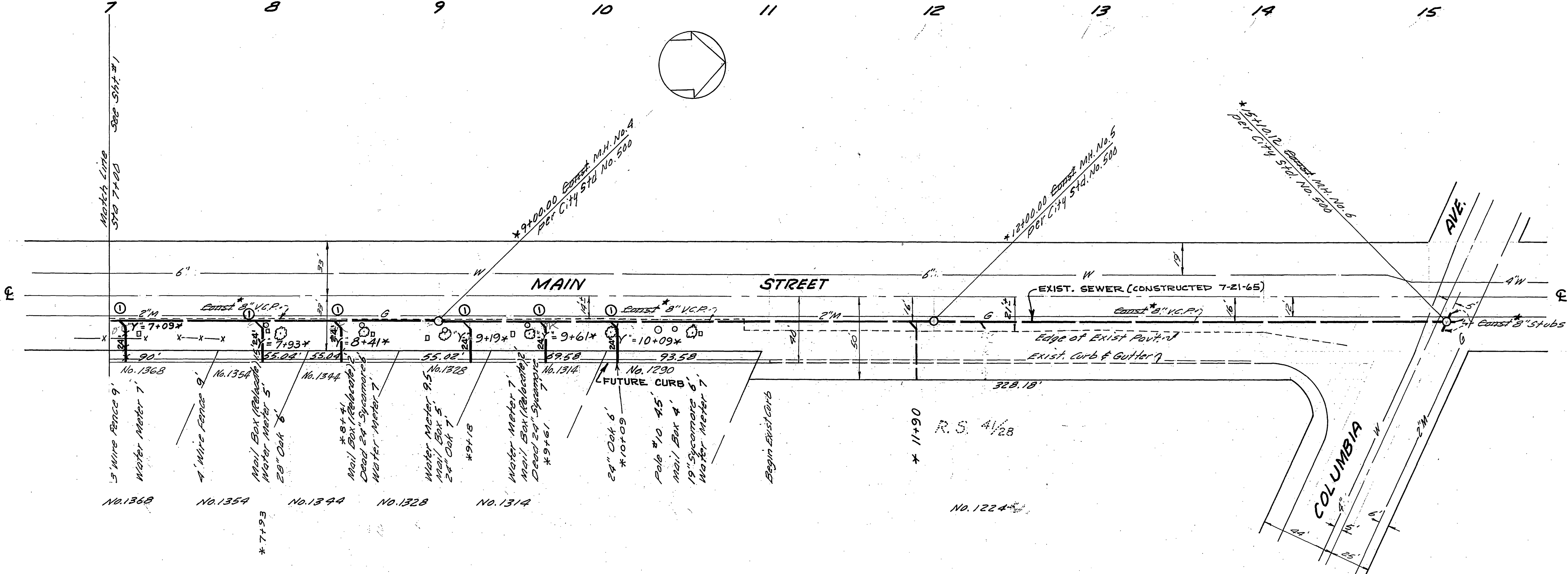
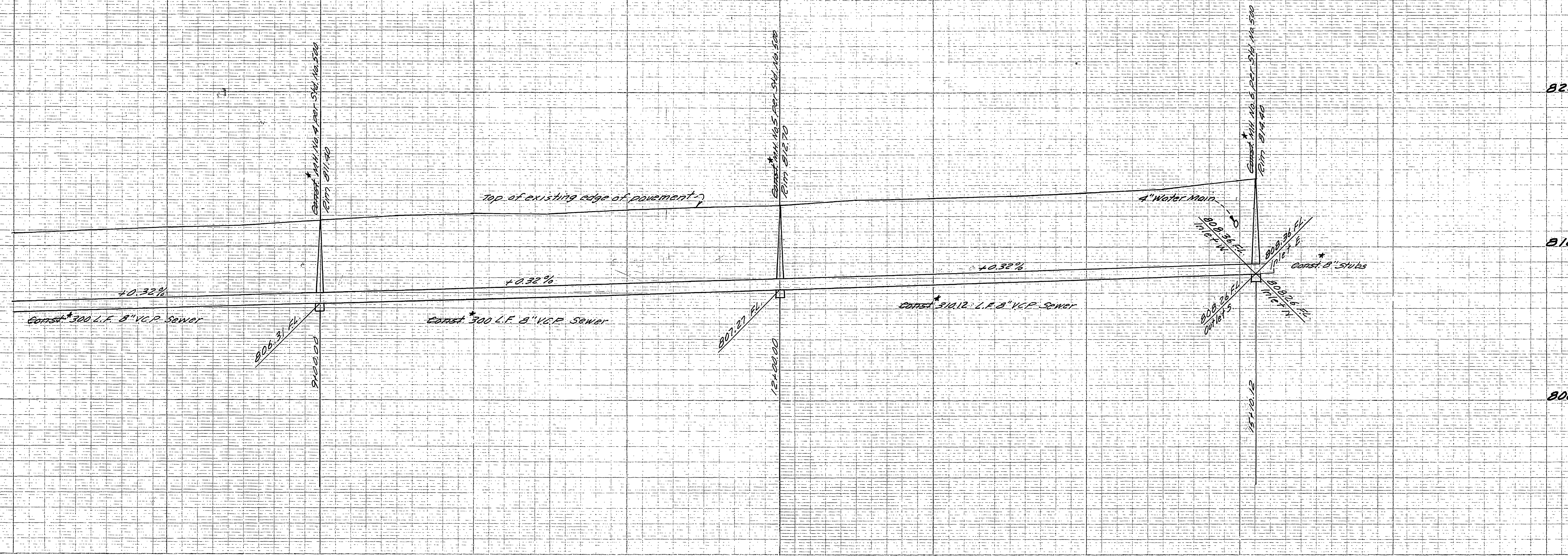

*AS BUILT 5-13-68 R.S.

⊙ MAIN ST. SEWER LATERAL CONST. ⊙ INSTALL LATERALS = PROJ. NO. 5114

CRAWLEY & HAWKINS
 George O. Crawley 74
 12/1/64
 70.3/6

* As built 7/2/65 BE			
⊙ INSTALL SEWER LATERALS			
MARK	REVISIONS	APPR. DATE	
DESIGNED BY	DRAWN BY	CHECKED BY	

CITY OF RIVERSIDE, CALIFORNIA
DEPARTMENT OF PUBLIC WORKS
 APPROVED BY: [Signature] DATE: 2-3-68
 OFFICE ENGINEER: [Signature] DATE: 2-5
 PARK DEPARTMENT: [Signature]
 TRAFFIC DIVISION: [Signature]
 ASSISTANT CITY ENG. DATE: 2-3-68

SEWER PLAN & PROFILE
MAIN ST. SEWER EXTENSION
 FROM FINLY CT. TO COLUMBIA AVE.
 RIS 796

PROJECT NO. 5073
 S-597
 SHEET 2 OF 2
 FILE NO.

HORIZ. SCALE: 1" = 40' VERT. SCALE: 1" = 4'

8056