

**BENCH MARK:**  
 Elev. 855.703 Top Man. in well, Intersection  
 Riverside Dr. & Terracina Dr. Webb F.B. 359/30.

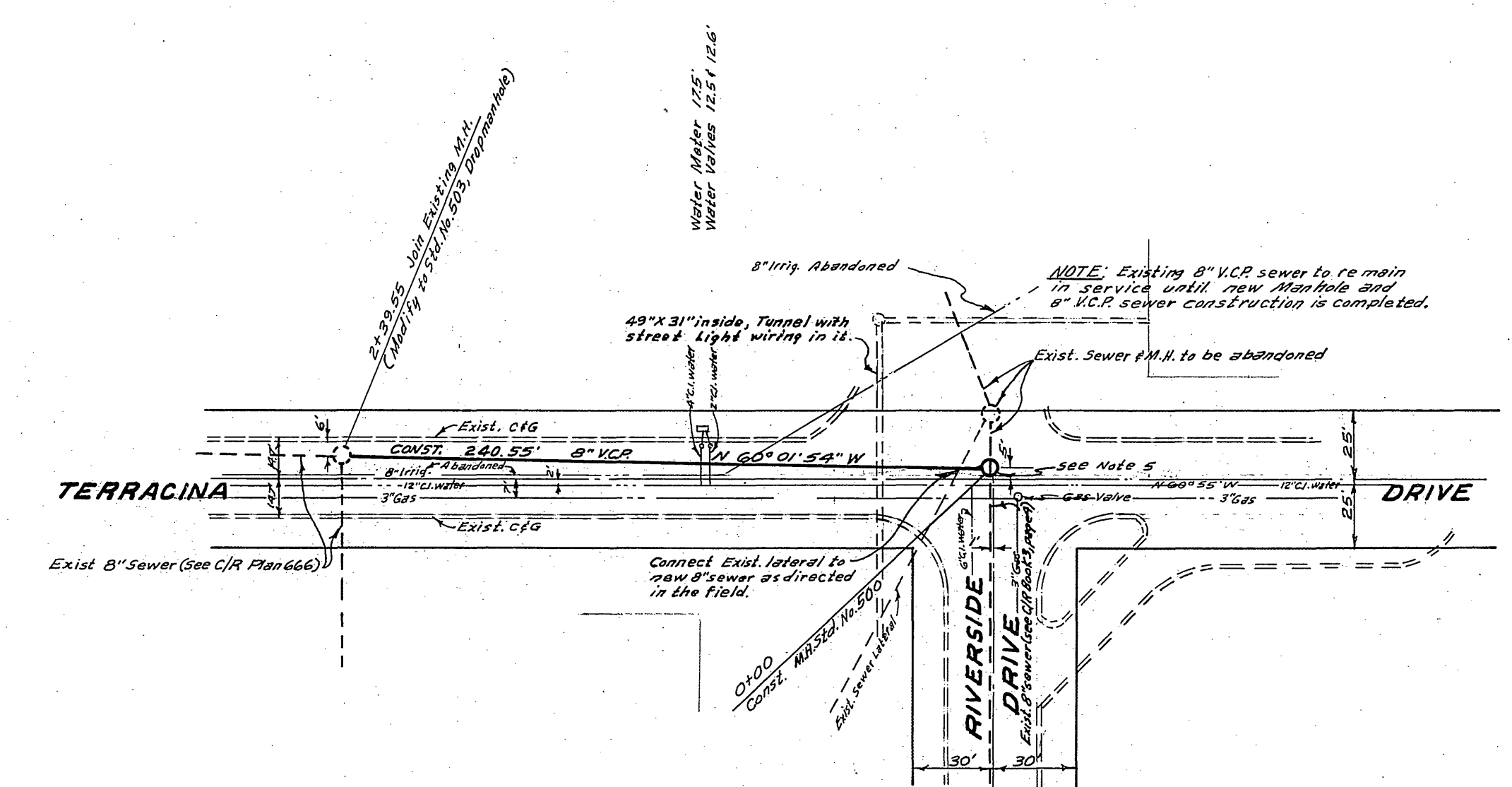

**QUANTITY ESTIMATE**

8" Vitrified Clay pipe	240 LF
Manhole Standard No. 500	1 EA.
Paving Replacement	660 SF
Modify Exist. M.H. to Standard No. 503	1 EA.

- Prior to construction of sewer, Contractor is to expose existing sewer and contact Engineer for verification of existing conditions.
- Prior to construction of sewer, Contractor is to expose existing underground tunnel at bottom slab and contact Engineer for verification of proposed sewer flowline elevations.
- Terracina Drive may be closed to thru traffic for 5 working days. See details plan for signs & barricades. Notify Police Dept. (787-7221) and Fire Dept. (787-7323) prior to closing.

**NOTICE TO CONTRACTOR**

The existence and location of any underground utility pipes or structures shown on these plans are obtained by a search of the available records. To the best of our knowledge, there are no existing utilities except as shown on these plans.

The contractor is required to take due precautionary measures to protect the utility lines shown and any other lines not explicitly shown on these plans.

<b>ALBERT A. WEBB ASSOCIATES</b> CIVIL ENGINEERS RIVERSIDE, CALIFORNIA APPROVED BY: <i>[Signature]</i> DATE 10/8/65 R.E. No. 9876		<b>CITY OF RIVERSIDE, CALIFORNIA</b> DEPARTMENT OF PUBLIC WORKS APPROVED BY: <i>[Signature]</i> DATE 10/8/65 DIRECTOR OF PUBLIC WORKS		PROJECT NO. <b>S-647</b>
DESIGNED BY: <i>[Signature]</i> DRAWN BY: <i>[Signature]</i> CHECKED BY: <i>[Signature]</i>		DATE 10-8-65		SHEET 1 OF 1 FILE NO. 65-327-B