

B.M. ELEV. 802.00 PK IN NORTH WEST
 CB. RETURN MITCHELL & ARLINGTON.
 B.M. ELEV. 813.00 PK IN NORTH WEST
 CB. RETURN SANDY LANE &
 ARLINGTON.
 F.B. 704/36

T=8" x 4" TEE (TYP)

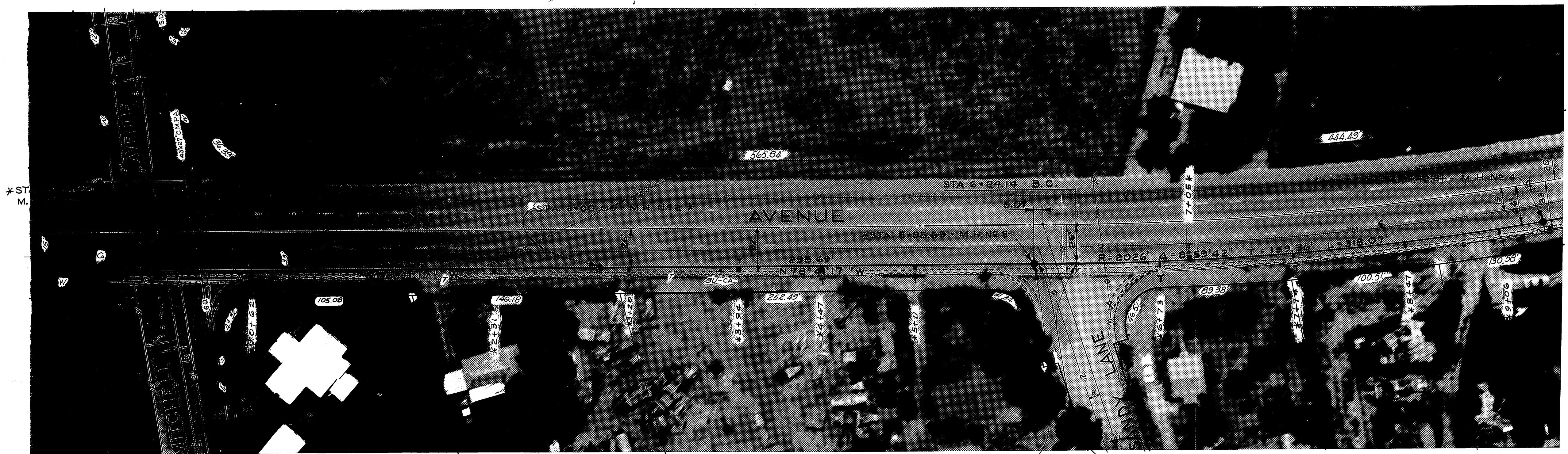

*A5 BUILT 1-23-69 8" STUB NORTH, PARALLEL TO SANDY LANE AND 8" STUB SOUTH. 28.45' - N 78° 41' 17" W

SEE SHEET 2

- CAUTION -
PACIFIC TELEPHONE
CABLES UNDERGROUND
BEFORE EXCAVATING
 CALL COLLECT:
 7:30 A.M. to 5 P.M. & Holidays
 Orange County 714-433-0811 714-547-6606
 Riverside County 714-484-0071 714-547-6606

MARK	REVISIONS	APPR.	DATE

CITY OF RIVERSIDE, CALIFORNIA
DEPARTMENT OF PUBLIC WORKS
 APPROVED BY: [Signature]
 SENIOR ENGINEER
 TRAFFIC DIVISION
 ASSISTANT CITY ENG.
 DATE: 8-19-68

ARLINGTON AVENUE
OFFSITE SEWER
 ARLINGTON AVENUE FROM
 MITCHELL TO SANDY LANE
 HORIZ. SCALE: 1" = 40' VERT. SCALE: 1" = 4'

ACCOUNT NO. 5109
5-682
 SHEET 1 OF 2
 6-6-PROJECT NO.

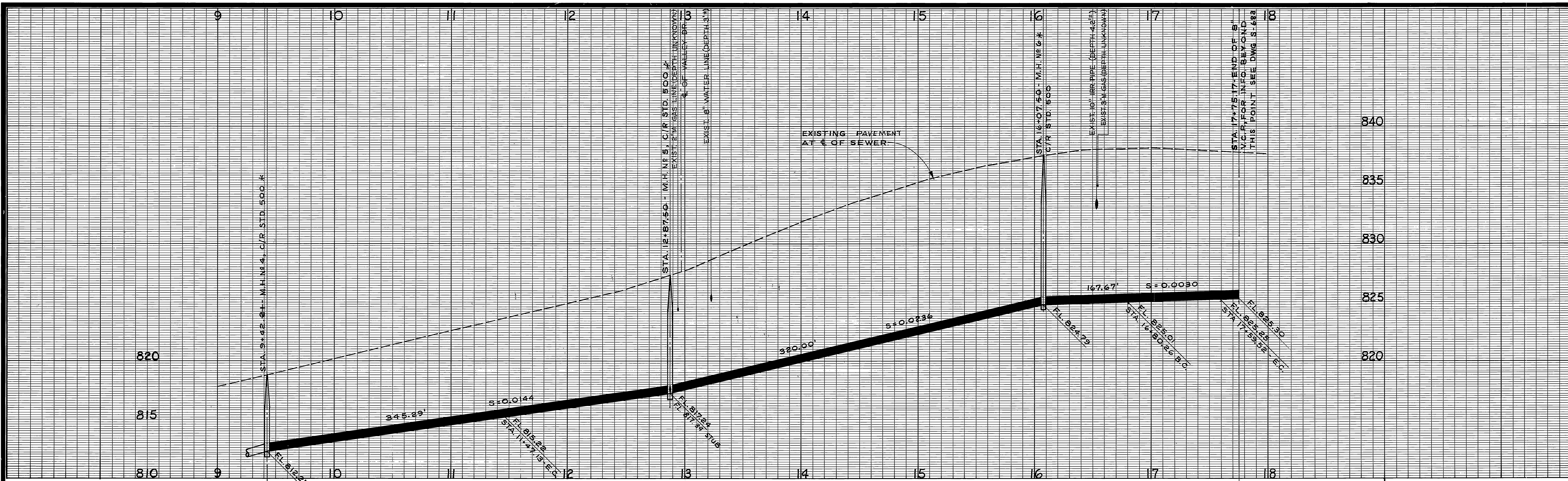

8" V.C.P.
(PIPE BEDDING PER C/R STD. DWG. 452, CASE I)

B.M. ELEV. 829.10 PK IN NORTH WEST
CB. RETURN VALLEY DRIVE &
ARLINGTON.
F.B. 704/36

T=8"x4" TEE (TYP)

SEE SHEET 1



AS BUILT 1-23-69 K.S.
15.65' - N 78°20'26"W
WESTERN HILLS ASSESSMENT DISTRICT.

-CAUTION-
PACIFIC TELEPHONE
CABLES UNDERGROUND
BEFORE EXCAVATING
CALL COLLECT:
Orange County 714-633-0811 After Hours
Riverside County 714-684-0071 & Holidays
714-547-6606

MARK	REVISIONS	APPR.	DATE

DESIGNED BY *JC* DRAWN BY *JRG* CHECKED BY *DCM*

CITY OF RIVERSIDE, CALIFORNIA
DEPARTMENT OF PUBLIC WORKS

APPROVED BY	BY	DATE
SENIOR ENGINEER	<i>[Signature]</i>	7/77
TRAFFIC DIVISION		
ASSISTANT CITY ENG.		

DATE 8-19-68

ARLINGTON AVENUE
OFFSITE SEWER

ARLINGTON AVENUE AT
VALLEY DRIVE

HORIZ. SCALE: 1" = 40'
VERT. SCALE: 1" = 4'

ACCOUNT NO. 5109
5-682
SHEET 2 OF 2
66-PROJECT NO.