

B.M. ELEV. (STATE) 781.799 "X" ON TOP FIRE HYDRANT, SW COR. MAGNOLIA & MONROE.  
 B.M. ELEV. (CITY) 760.298, RR SPIKE IN POLE #16/3811 J ON WLY SIDE MONROE, 400± S'LY OF CALIFORNIA AVE.  
 SCALES: HOR. 1" = 40', VERT. 1" = 4'  
 F.B. 611/8, 242/10

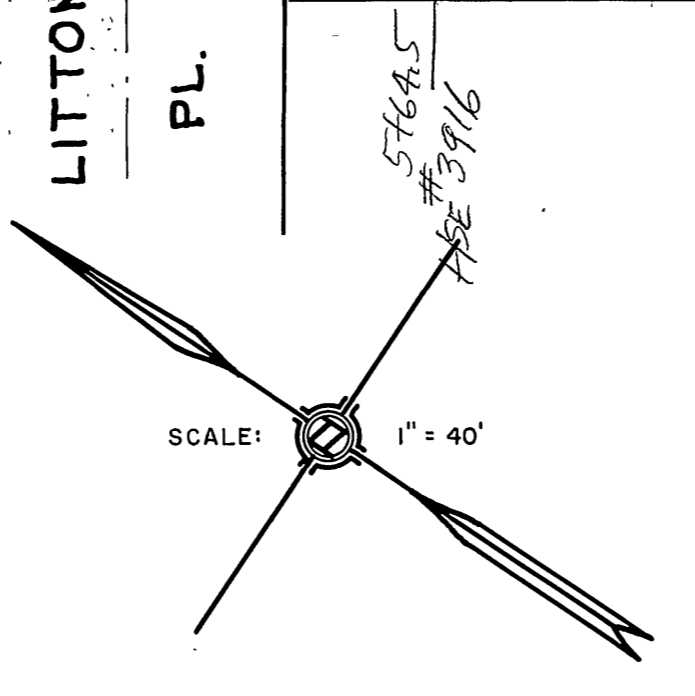

NOTE:  
 Laterals to property line to be located in the field. (by others)  
 The 15" sewer line and M.H.'s on Monroe St. to be constructed under this contract.  
 Twelve foot length of cast iron pipe laterals to be placed under storm drain ditch (by others)  
 The sewer under the P.E. Railroad tracks shall be constructed as specified by the Railroad.

NOTE:  
 Trunk Sewer Contractor is to cooperate with Roblynn Manor Subdivision Sewer Contractor in the tie-in of house connections along the easterly side of Monroe Street, between station 0+00 and 12+19.55 as shown on Plan.

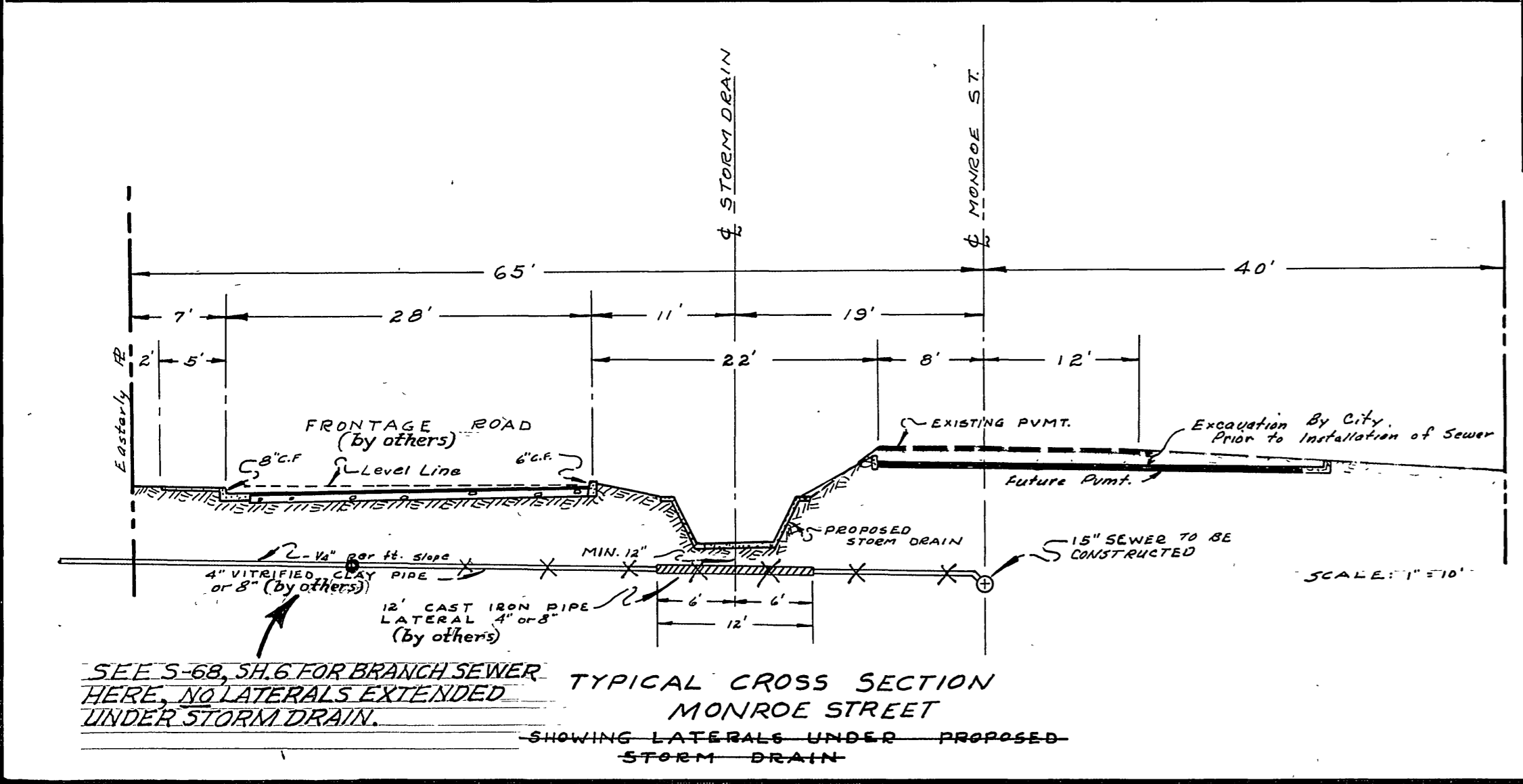
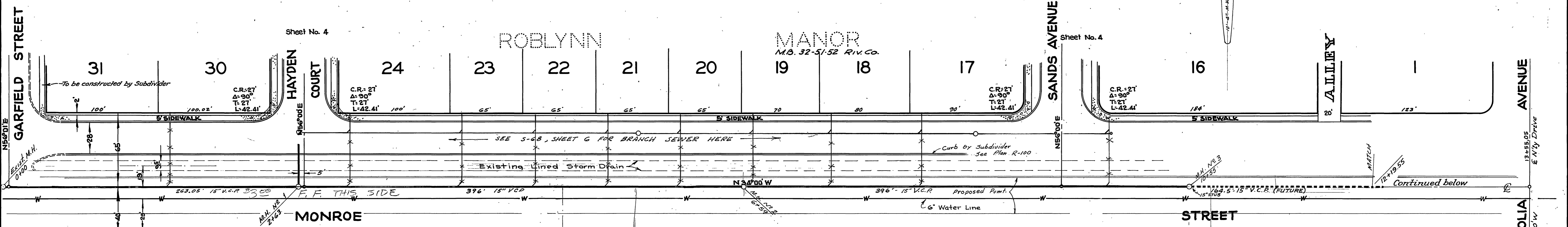
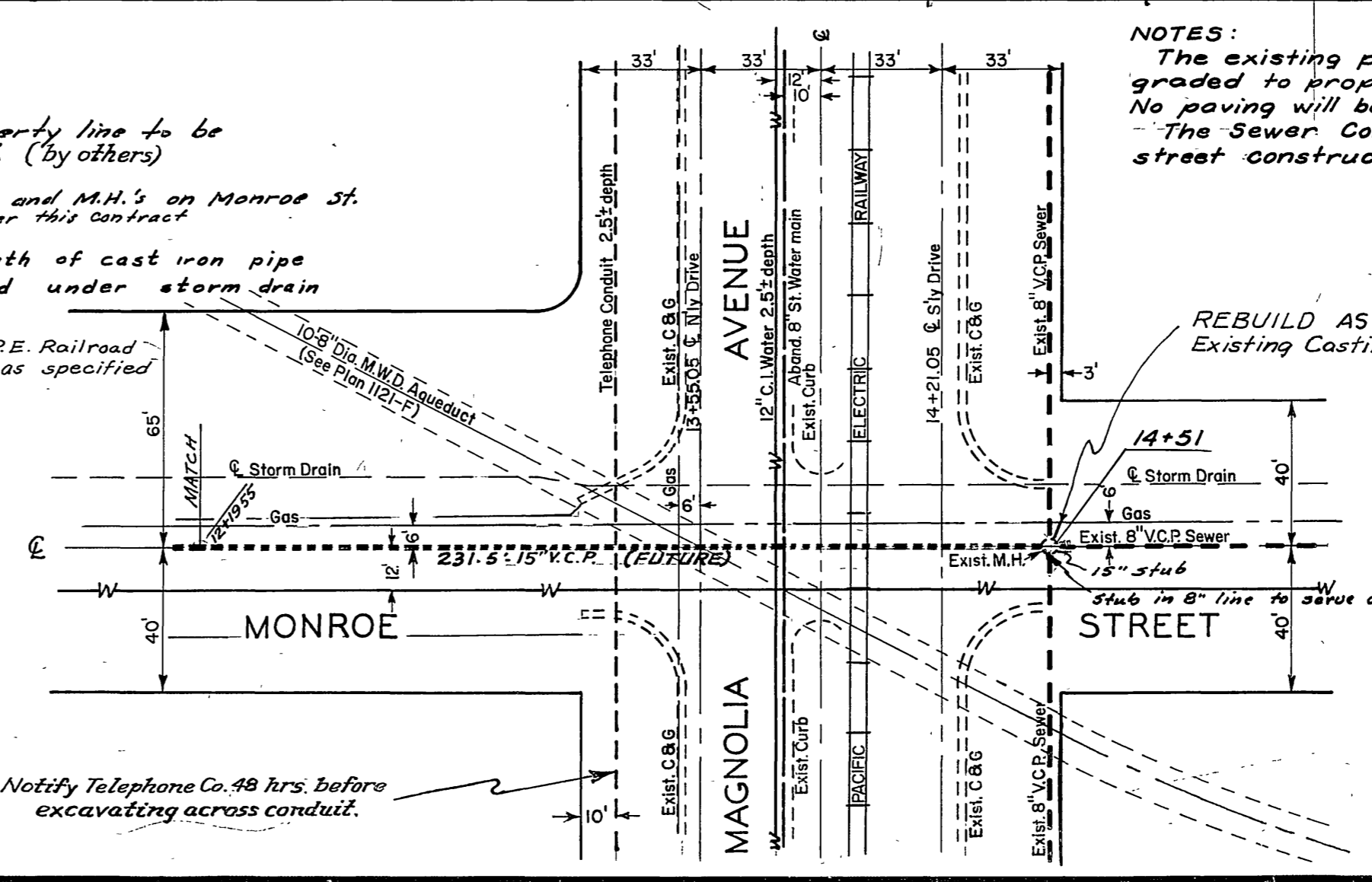

NOTES:  
 The existing pavement will be removed and the street rough graded to proposed grade at time of sewer installation.  
 No paving will be required except across Magnolia Avenue.  
 The Sewer Contractor will be required to co-ordinate his work with street construction being done by the Street Department.

REVISIONS	
MARK	DATE
1-4-57	Change elevation of M.H.D. Aqueduct & Sewer grade (to 1055 to 14+51)
4-17-57	Revise notes on Magnolia M.H.
10-28-58	AS BUILT M.H. 242

CITY OF RIVERSIDE CALIFORNIA  
 DEPARTMENT OF PUBLIC WORKS

**MONROE STREET  
 SANITARY TRUNK SEWER  
 BETWEEN GARFIELD ST.  
 AND MAGNOLIA AVE.**

DESIGNED BY: [Signature]  
 DRAWN BY: [Signature]  
 CHECKED BY: [Signature]  
 APPROVED BY: [Signature]  
 ASSISTANT CITY ENGINEER

DATE: April 10, 1957

INDEXED R.B.

S-74

SHEET 1 OF 1