

PLAN	SURVEYED	BY	DATE
	NOTE BOOK		
	ALIGNMENT CHECKED		
	RT. OF WAY CHECKED		
	NO.		

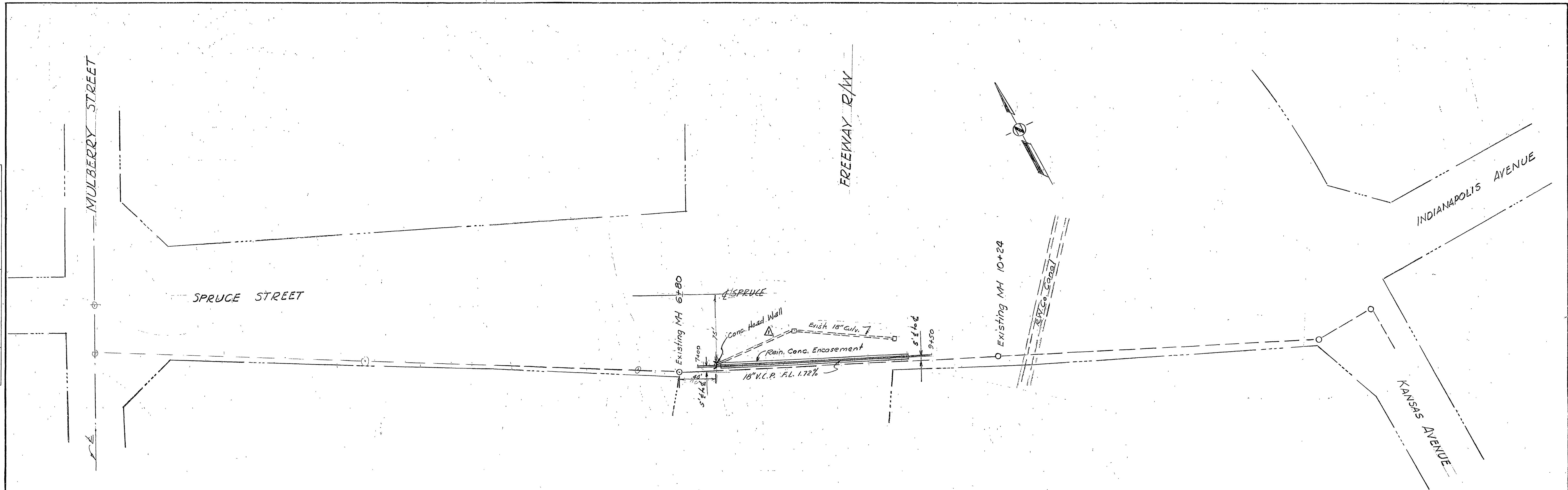

PROFILE	SURVEYED	BY	DATE
	NOTE BOOK		
	GRADES CHECKED		
	B. M. NOTED		
	STRUCTURE NOTATION CH'D		
	NO.		

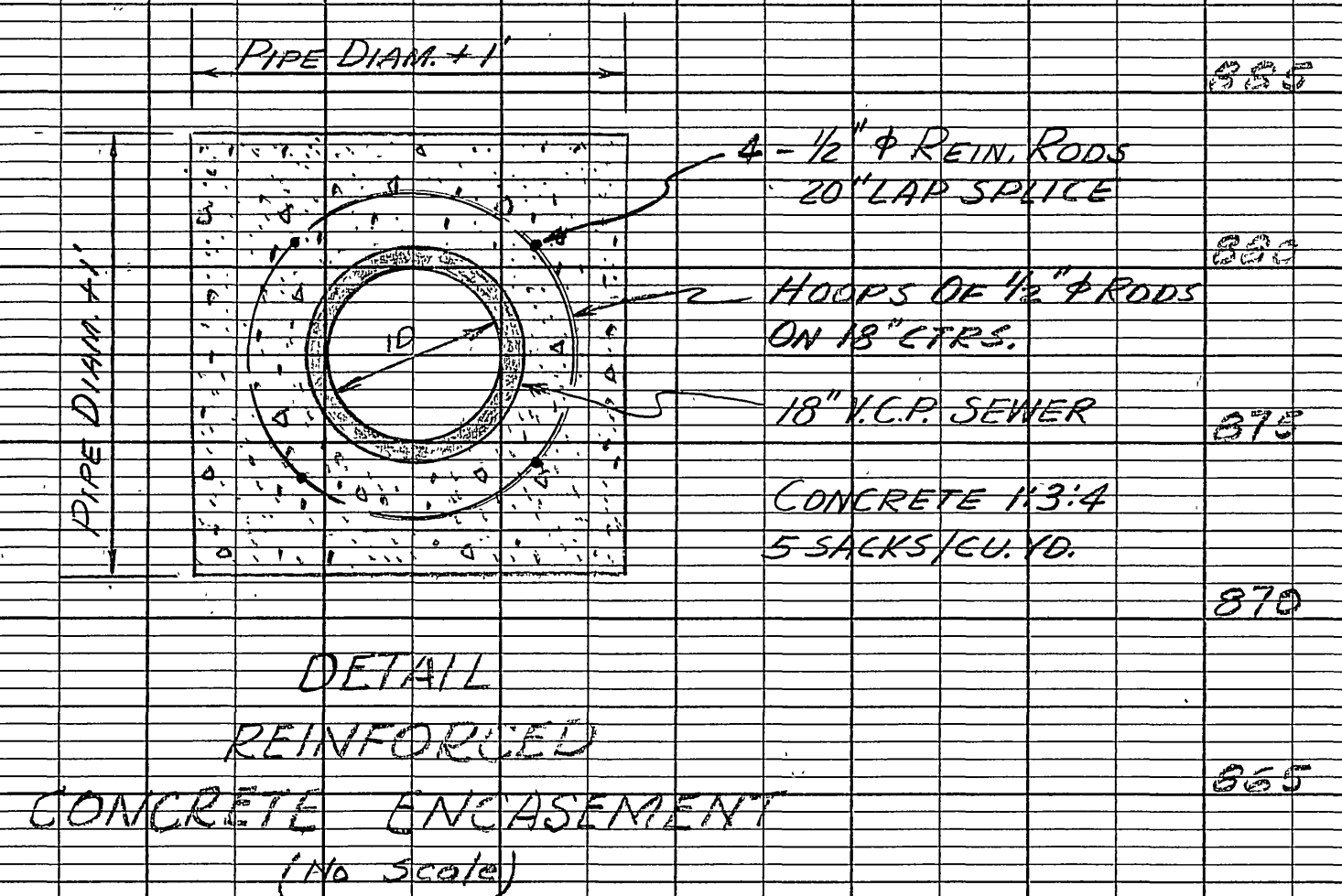
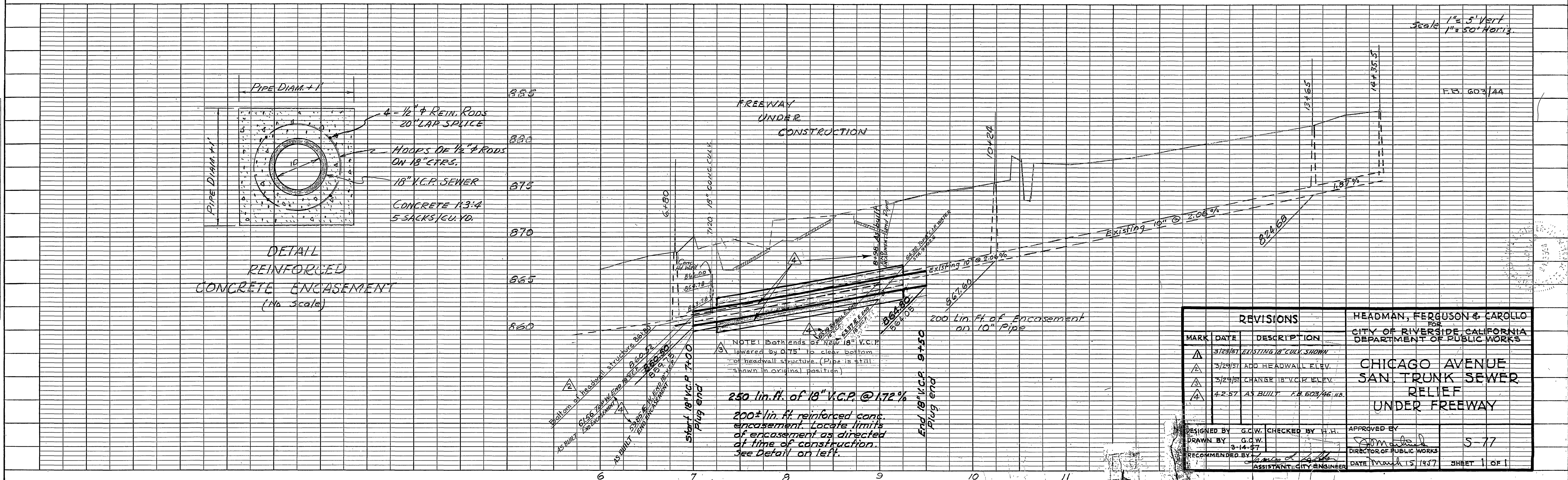

NOTE: Both ends of new 18" V.C.P. lowered by 0.75' to clear bottom of headwall structure. (Pipe is still shown in original position.)

250 lin. ft. of 18" V.C.P. @ 1.72%

200± lin. ft. reinforced conc. encasement. Locate limits of encasement as directed at time of construction. See Detail on left.

REVISIONS			HEADMAN, FERGUSON & CAROLLO FOR CITY OF RIVERSIDE CALIFORNIA DEPARTMENT OF PUBLIC WORKS	
MARK	DATE	DESCRIPTION	APPROVED BY	
△	3/23/51	EXISTING 18" CULV. SHOWN		
△	3/23/51	ADD HEADWALL ELEV.		
△	3/23/51	CHANGE 18" V.C.P. ELEV.		
△	4-2-57	AS BUILT F.R. 603/46/118		

DESIGNED BY	G.C.W.	CHECKED BY	W.H.	APPROVED BY	
DRAWN BY	G.C.W.	DATE	MARCH 15 1957	DIRECTOR OF PUBLIC WORKS	5-77
RECOMMENDED BY	<i>James J. Smith</i>	DATE	MARCH 15 1957	ASSISTANT CITY ENGINEER	SHEET 1 OF 1