

BENCH MARK F.B. 1020/22 c/o F.B. 050/44
 Elev. 993.76 PK NAIL IN N.E. CURB RETURN LINDEN & IOWA

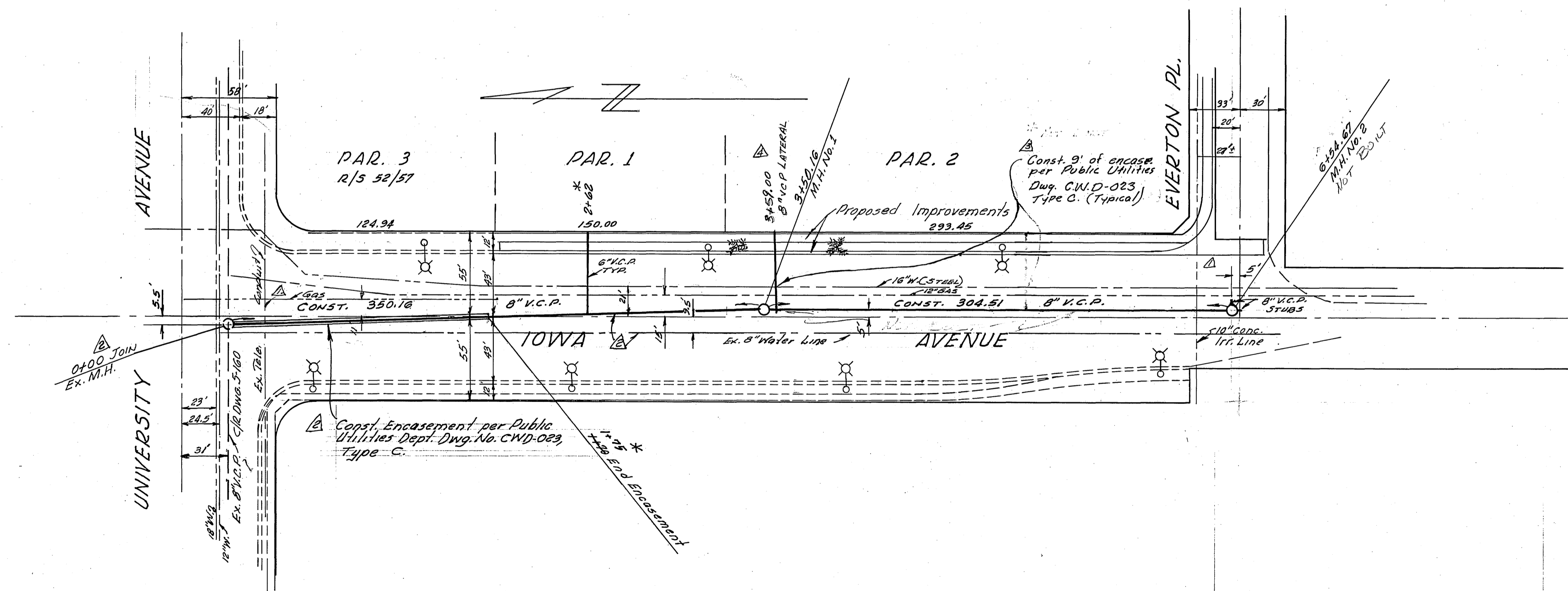

- GENERAL NOTES:
1. Construction shall be in accordance with *Standard Specifications for Public Works Construction, 1970 Edition and Standard Drawings.*
 2. It shall be the responsibility of the contractor to clear the right of way in accordance with the decisions of the law as it affects each utility including irrigation lines and other utilities and at the cost to the City.
 3. **SMALLS SHALL BE IN CONFORMANCE TO A.S.T.M. SPEC. C-492-64 TYPE B OR C. OR A.S.T.M. SPEC. C-594-62 T (GRAND SEAL) WITH CERTAIN EXCEPTIONS OR MODIFICATIONS ON WITH THE CITY ENGINEER.**
 4. Pipe shall be bedded per Case 1, Standard Drawing No. 410, unless otherwise specified on plan.
 5. Location of manholes and vaults to be determined in the field.
 6. All manholes and vaults to be constructed in accordance with Standard Drawing No. 502. Bricks shall be placed and capped.
 7. Manhole frames and covers to be cast in electric non-ferrous material.
 8. Manholes are to be 6" dia. unless otherwise specified on plan.
 9. Prior to manufacture of sewer, Contractor is to compare existing sewer and contact Engineer for verification of existing elevations.

ALBERT A. WEBB ASSOCIATES
 CIVIL ENGINEERS
 RIVERSIDE, CALIFORNIA
 APPROVED BY: *Ernest N. Will* DATE: 4/22/71
 R.E. No. 2876
 W.O. 71-32 FOR UNIVERSITY PLAZA F.B. 558

DESIGNED BY: <i>REC</i>	DRAWN BY: <i>REC</i>	CHECKED BY: <i>REC</i>
DATE: 4/22/71	DATE: 4/22/71	DATE: 4/22/71

Approved By: *Al J. Oregano* City Engineer
 Date: 12-14-71
 City of Riverside, California
 PUBLIC WORKS DEPARTMENT

* AS BUILT 1-26-72 EARL
 SEWER PLAN & PROFILE
 IOWA AVENUE
 UNIVERSITY AVE TO EVERTON PL.
 PARCEL MAP NO. 23
 SCALE: HORIZ. 1"=50' VERT. 1"=5'

ACCOUNT NO.
 DRAWING NUMBER
S-834
 SHEET 1 OF 1
 71-32B