

BENCH MARK
RIV. CO. B.M. NO. 601-28-68
Bronze disk in conc. post, 32.0'
NE of intersection of Magnolia Ave.
and La Sierra Ave.
Rese# 1971 Elev. 712.14

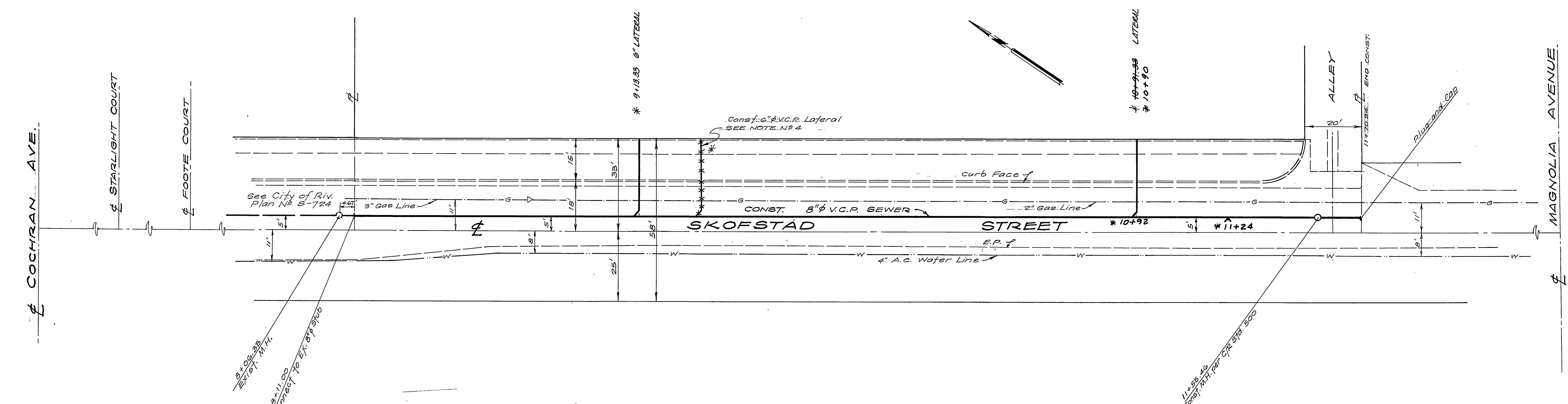

- GENERAL NOTES:
- Construction shall be in accordance with the Standard Specifications for Public Works Construction, 1970 Edition, and City of Riverside Std. Dwg.
 - It shall be the responsibility of the contractor to clear the right of way to boundaries and the conditions of the same as it affects such utilities including irrigation lines as shown hereon and as it may be to the City.
 - Pipe will be uncoated ductile iron, standard outside diameter as specified herein.
 - Location of manholes shall be as shown of direction of the owner.
 - All manholes shall be to standard size, Standard Detail No. 28. Manholes shall be ring.
 - Manhole frames and covers to be set to finished pavement grades.
 - Subcontractors shall be responsible for providing the necessary permits and fees for construction.
 - Work shall be completed within the specified time.

* As built 9.23.55 JL
* AS BUILT 6/19/68 KALP

ALBERT A. WEBB ASSOCIATES CIVIL ENGINEERS RIVERSIDE, CALIFORNIA APPROVED BY: <i>[Signature]</i> DATE: 9-22-71 R.E. No. 9876 W.O. 71-152 FOR: D.P. WINSLOW F.B. 1020	MARK REVISIONS APPR. DATE	CITY OF RIVERSIDE, CALIFORNIA PUBLIC WORKS DEPARTMENT		SEWER PLAN & PROFILE SKOFSTAD STREET	ACCOUNT No. 71-152 DRAWING NUMBER S-857
		APPROVED BY: <i>[Signature]</i> DATE: 4-7-28, 1971 CHIEF PUB. WKS. ENGR.	APPROVED BY: <i>[Signature]</i> DATE: 4-7-28, 1971 DIRECTOR OF PUBLIC WORKS	STA. 8+06.33 TO STA. 11+70.94 ZONING CASE R-75-701	SHEET 1 OF 1 71-152-B

SCALE: 1" = 20' HOR. 1" = 2' VERT.