

**GENERAL NOTES:**

- CONSTRUCTION SHALL BE IN ACCORDANCE WITH THE CITY OF RIVERSIDE, DEPARTMENT OF PUBLIC WORKS, STANDARD SPECIFICATIONS FOR PUBLIC WORKS CONSTRUCTION, 1970 ED., STD. DRAWINGS & CH. 15, CH. 20, RIVERSIDE MUNICIPAL CODE.
- IT SHALL BE THE RESPONSIBILITY OF THE CONTRACTOR TO CLEAR THE RIGHT OF WAY IN ACCORDANCE WITH THE PROVISIONS OF THE LAW AS IT AFFECTS EACH UTILITY INCLUDING IRRIGATION LINES AND APPURTENANCES AND AT NO COST TO THE CITY.
- JOINTS IN VITRIFIED CLAY PIPE SEWER SHALL CONFORM TO ASTM STANDARD C-485-60T, OR THE LATEST REVISION THEREOF.
- PIPE SHALL BE BEDDED PER CASE I, STANDARD DRAWING No. 452, UNLESS OTHERWISE SPECIFIED ON PLAN.
- LOCATION OF KYES AND LATERALS TO BE DETERMINED IN THE FIELD.
- MANHOLE FRAMES AND COVERS TO BE SET TO EXISTING PAVEMENT GRADES.

**NOTICE TO CONTRACTOR:**

THE EXISTENCE AND LOCATION OF ANY UNDERGROUND UTILITY PIPES OR STRUCTURES SHOWN ON THESE PLANS ARE OBTAINED BY A SEARCH OF THE AVAILABLE RECORDS. TO THE BEST OF OUR KNOWLEDGE, THERE ARE NO EXISTING UTILITIES EXCEPT AS SHOWN ON THE PLANS.

THE CONTRACTOR IS REQUIRED TO TAKE DUE PRECAUTIONARY MEASURES TO PROTECT THE UTILITY LINES SHOWN AND ANY OTHER LINES NOT OF RECORD OR NOT SHOWN ON THESE PLANS.

**NOTE:**

No trenching shall be allowed within 5' of existing street trees.

BENCH MARK: F&B-A  
 15" BRASS DISC STAMPED  
 (FIG-A) CAPPED & INT. OF  
 VICTORIA AVE. & WASHINGTON  
 STREET FEB. 1963  
 ELEV. 927.999

HAWKINS, ROBERTSON & ASSOC.  
 ENGINEERS & SURVEYORS  
 RIVERSIDE, CALIFORNIA  
 Dale S. Headley 2/17/73  
 R.C.E. NO. 1765 DATE

FOR: WILLIAM SHAMBLIN

\* 1/2" BUILT 10/10/74

CITY OF RIVERSIDE, CALIFORNIA  
 DEPARTMENT OF PUBLIC WORKS

APPROVED BY: [Signature]  
 OFFICE ENGINEER  
 PARK DEPARTMENT  
 TRAFFIC DIVISION  
 ASSISTANT CITY ENG.  
 DATE: 7/10/73

SEWER PLAN  
 TRACT 4859-1  
**VICTORIA STREET**  
 FROM INT. OF WASHINGTON ST. & VICTORIA ST. TO  
 630.13' N'LY ALONG VICTORIA ST.

PROJECT NO.

**S-925**

SHEET 1 OF 2

HORIZ. SCALE: 1" = 40' VERT. SCALE: 1" = 4'

FILE NO. 72-225A



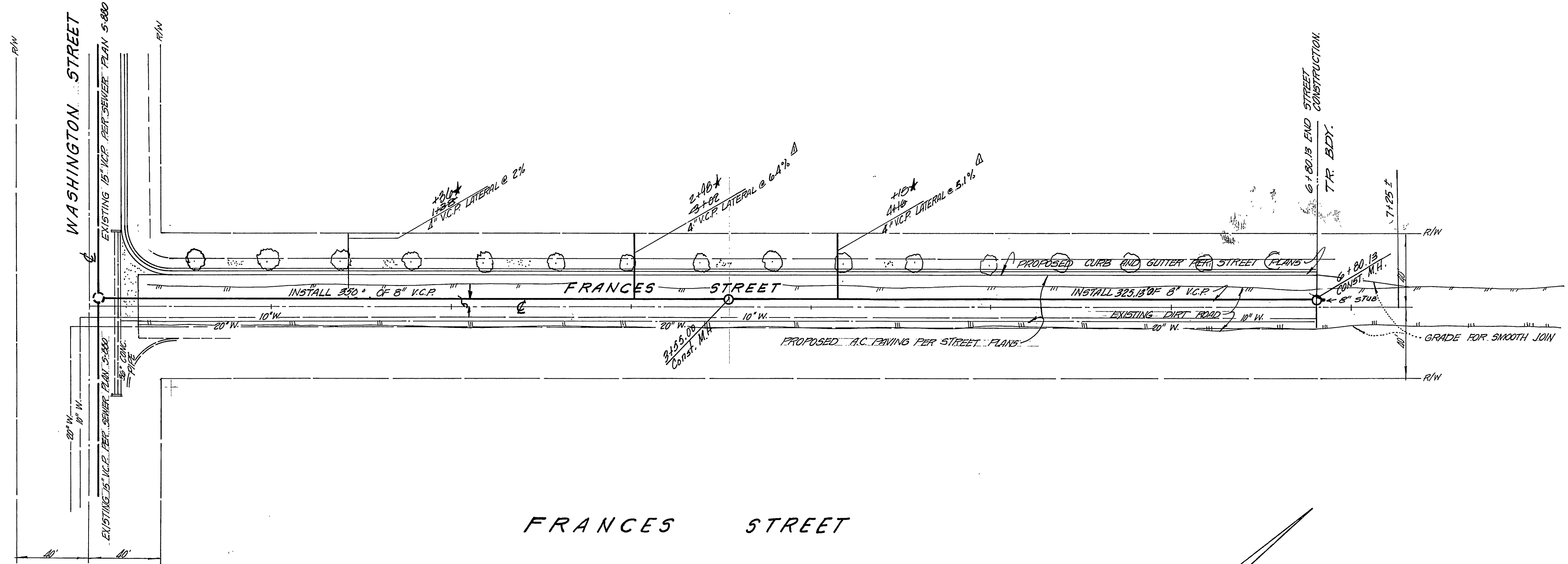
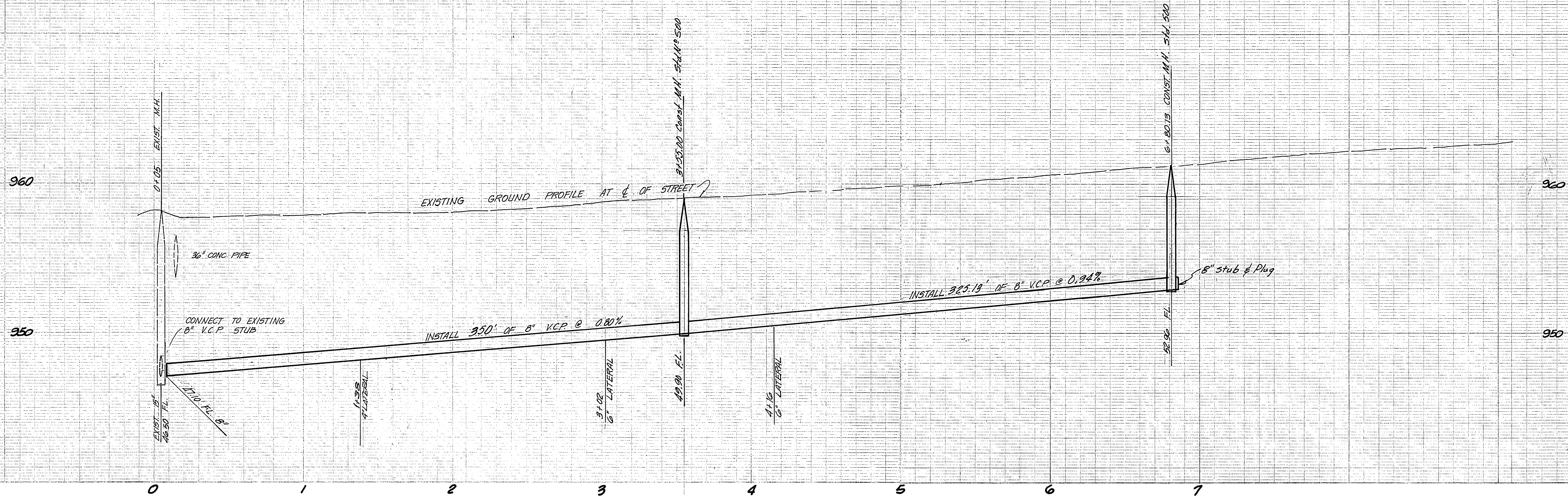

FRANCES STREET

\* 1/2" CURB @ 216 10.14

<b>BENCH MARK:</b> F6-A 1/2" BRASS DISC, STAMPED (F6-A) CAPPED @ INT. OF VICTORIA AVE. & WASHINGTON STREET. FB 735/13 ELEV. 927.999	<b>HAWKINS, ROBERTSON &amp; ASSOC.</b> ENGINEERS & SURVEYORS RIVERSIDE, CALIFORNIA  Dale D. Dredling 2/17/73 R.C.E. NO. 17059 DATE	DESIGNED BY DG DRAWN BY CC CHECKED BY CER	CITY OF RIVERSIDE, CALIFORNIA DEPARTMENT OF PUBLIC WORKS		<b>SEWER PLAN</b> TRACT 1859 <b>FRANCES STREET</b> FROM INT. OF WASHINGTON ST. & FRANCES TO 680.19' NLY ALONG FRANCES ST.	PROJECT NO.
			APPROVED BY OFFICE ENGINEER PARK DEPARTMENT TRAFFIC DIVISION ASSISTANT CITY ENG.	BY DATE WILLIAM D. HANSEN 7/10/73		APPROVED BY DIRECTOR OF PUBLIC WORKS WILLIAM D. HANSEN

HORIZ. SCALE: 1" = 40' VERT. SCALE: 1" = 4'