

CURVE DATA  
 B = 400'  
 Δ = 12° 24' 58"  
 L = 201.08'  
 T = 43.51'

**CONSTRUCTION NOTES**

- CONSTRUCTION SHALL BE IN ACCORDANCE WITH STANDARD SPECIFICATIONS FOR PUBLIC WORKS CONSTRUCTION, 1973 EDITION.
- THE FOLLOWING STANDARD DRAWINGS APPLY:  
 NO. 452 FOR BEDDING OF PIPE  
 NO. 453 FOR RESURFACING AND BACKFILL  
 NO. 500 FOR MANHOLES  
 NO. 500 FOR MANHOLE DISTINGS  
 NO. 502 FOR INSTALLING "T" OR "V" FOR SEWER LATERALS
- BY  INDICATES THAT PROPERTY OWNER HAS REQUESTED LOCATION OF LATERAL AT LOCATION SHOWN. LETTER IS IN FILE.
- CONSTRUCT "T", OR AT OPTION OF CONTRACTOR, A "V" LOCATION SHOWN THIS:

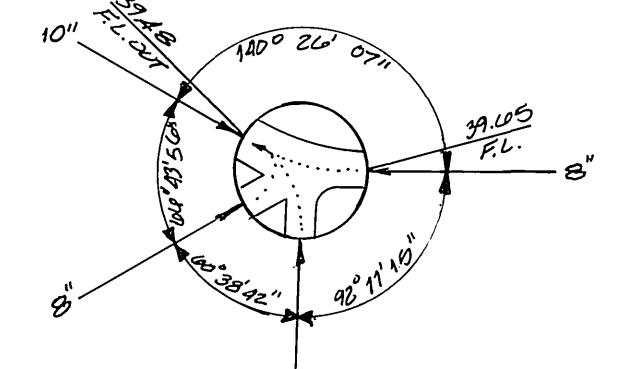

STUB LOCATIONS  
 M.H. #1  
 U.T.S.

APPROVED BY:  
 [Signature]  
 public utilities department - water  
 6-26-74  
 date

DESIGNED BY	DRAWN BY	CHECKED BY
REVISIONS	APPR. DATE	

CITY OF RIVERSIDE, CALIFORNIA  
 PUBLIC WORKS DEPARTMENT  
 APPROVED BY: [Signature]  
 PARK DEPARTMENT  
 TRAFFIC DIVISION  
 CHIEF PUB. WKS. ENGR.  
 DATE: 7-10-74

NELLIE STREET  
 ASSESSMENT DISTRICT #2  
 (SEWER)  
 FROM DUNCAN AVENUE TO 0+00'S & V  
 SCALE: HORIZ: 1"=40' VERT: 1"=4'

ACCOUNT No. 84-451-643  
 DRAWING NUMBER  
 S-973  
 SHEET 1 OF 1

