

NOTE:
Standard Driveways to be located
in the Field A=10' B=17' PER STA
DWG 302

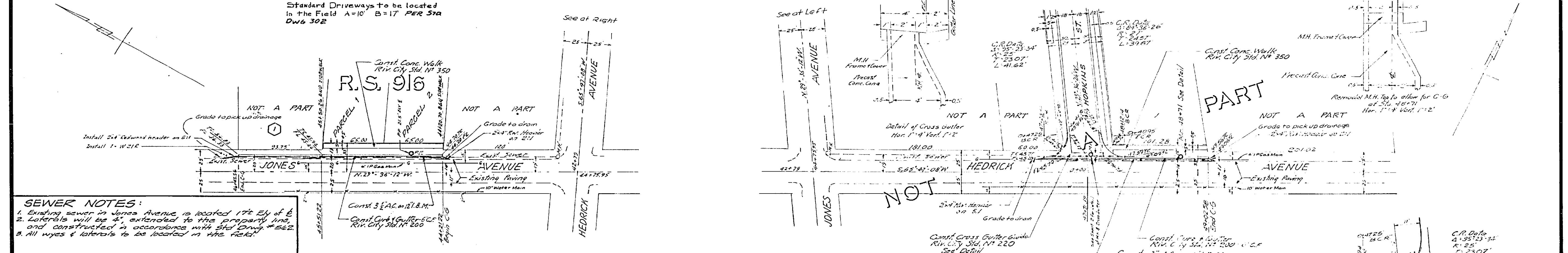

- SEWER NOTES:**
- Existing sewer in Jones Avenue is located 17" Ely of E
 - Laterals will be 4" extended to the property line and constructed in accordance with Std. Drawg # 562
 - All wyes & laterals to be located in the field
- GENERAL NOTES:**
- It shall be the responsibility of the Contractor to clear the right of way in accordance with the provisions of law as it affects such utility, including irrigation lines and appurtenances and at no cost to the City.
 - Construction shall be in accordance with the City of Riverside Department of Public Works Specifications No. 484 and Standard Drawings
 - Prime coat, seal coat and paint binder are required.
 - Grading will require a permit under Ordinance 3093 for a cut or fill exceeding 100 cubic yards or a fill over 1 foot in depth.
 - A soil test has been taken by the Developer.
 - Trim edge of existing pavement where new paving joins existing pavement to a clean straight line. Construct match-up paving as shown, and overlay paving as directed in the field to produce a smooth crown section.

B.M. RR. Spike in R.P. #662732 E. of S.E. Cor. Hedrick & Jones Avenues
Elev. = 744.65

| | | | | |
|--|---|---|--|---|
| J. F. DAVIDSON ASSOCIATES CIVIL ENGINEERS - SURVEYORS - PLANNERS RIVERSIDE, CALIFORNIA APPROVED BY: <i>[Signature]</i> DATE: 12-2-64 R.E. No. 26311 W.C. 527 FOR Edgar E. Moore P. 894-2 | Change from that shown to R.S. 916 [Stamp] | CITY OF RIVERSIDE, CALIFORNIA DEPARTMENT OF PUBLIC WORKS APPROVED BY: <i>[Signature]</i> DATE: 6-10-65 OFFICE ENGINEER TRAFFIC DIVISION ASSISTANT CITY ENGINEER | STREET PLAN and PROFILE JONES AVENUE R.S. 916 HORIZ. SCALE: 1" = 50' VERT. SCALE: 1" = 5' | PROJECT NO. R-1009 SHEET 1 OF 1 FILE NO. 3302 |
| | DESIGNED BY: <i>[Signature]</i> DRAWN BY: <i>[Signature]</i> CHECKED BY: <i>[Signature]</i> | | | |

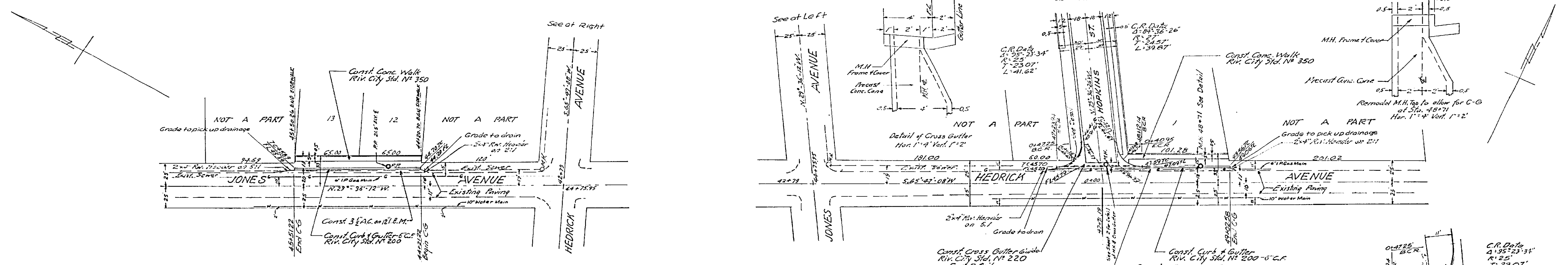
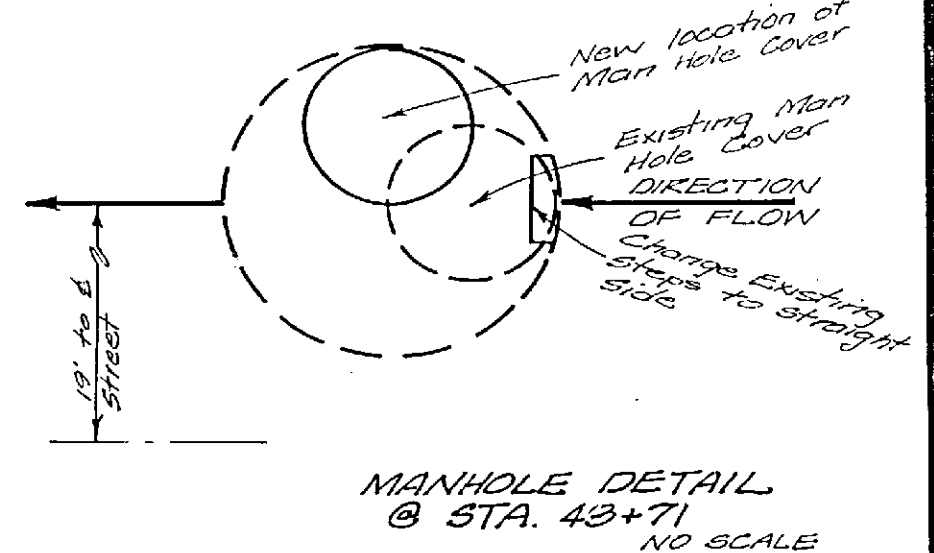
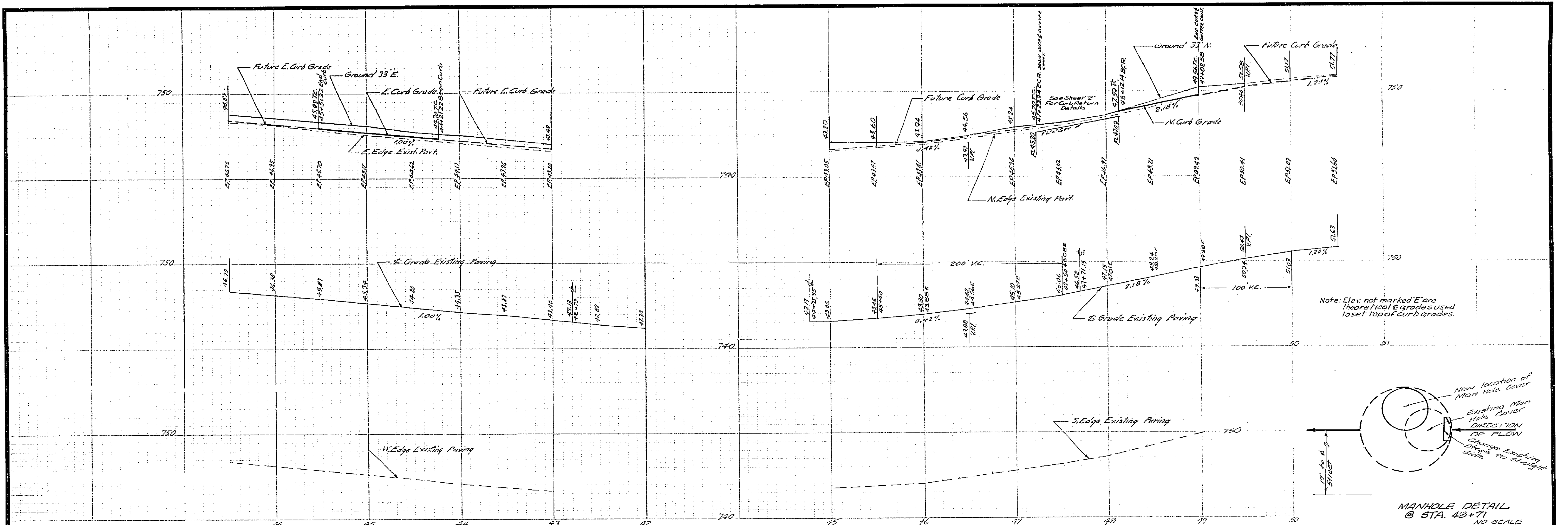

- GENERAL NOTES:**
- It shall be the responsibility of the Contractor to clear the right of way in accordance with the provisions of law as it affects each utility including irrigation lines and appurtenances and at no cost to the City.
 - Construction shall be in accordance with the City of Riverside Department of Public Works Specifications No. 181 and Standard Drawings.
 - Prime coat, seal coat and paint binder are required.
 - Grading will require a permit under Ordinance 3093 for a cut or fill exceeding 100 cubic yards or a fill over 1 foot in depth.
 - A soil test has been taken by the Developer.
 - Trim edge of existing pavement where new paving joins existing pavement, to a clean straight line. Construct match-up paving as shown, and overlay paving as directed in the field to produce a smooth crown section.

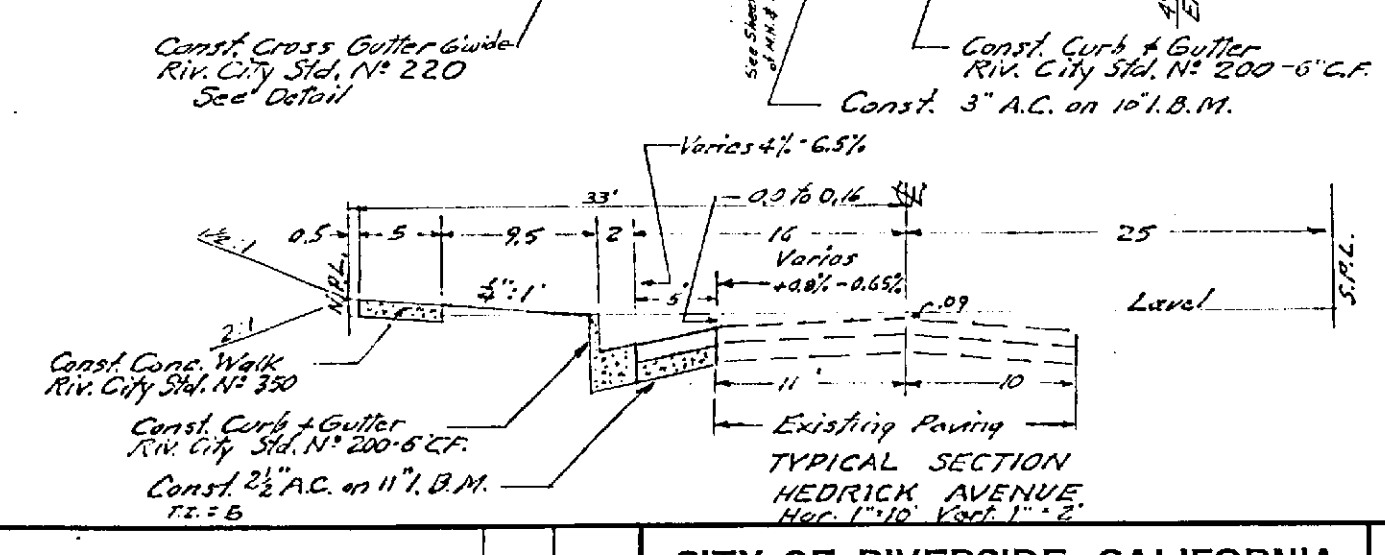
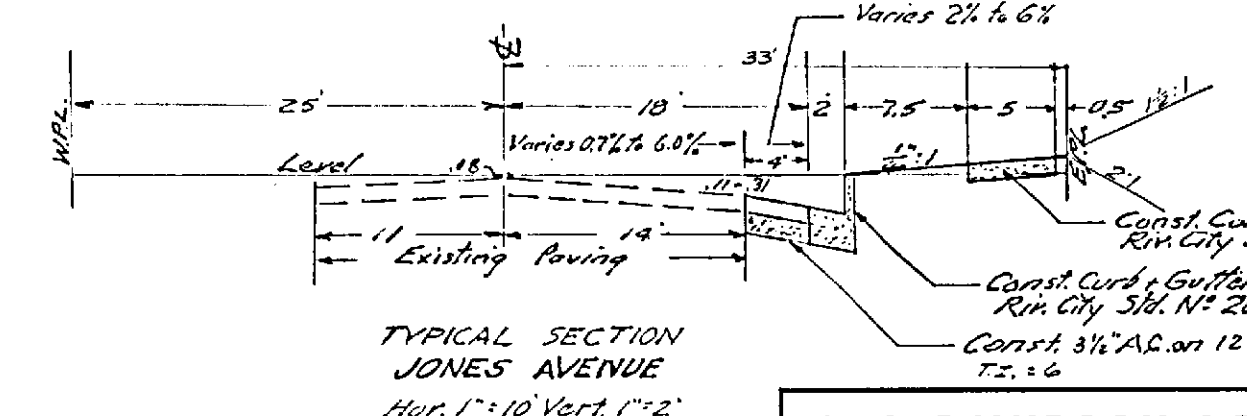

DETAIL OF CURB RET. AT STA. 41+23.31
1" = 20'
Void Not for Construction

| | | | | | |
|---|--|--|--|--|--|
| J. F. DAVIDSON ASSOCIATES CIVIL ENGINEERS - SURVEYORS - PLANNERS RIVERSIDE, CALIFORNIA APPROVED BY: <i>Robert S. Johnson</i> DATE 12-2-64 R.E. No. 26611 W.O. 12-400 FOR: Edgar E. Moore P.B. 894-9 | | CITY OF RIVERSIDE, CALIFORNIA DEPARTMENT OF PUBLIC WORKS APPROVED BY: <i>[Signature]</i> DATE 6-10-65 OFFICE ENGINEER TRAFFIC DIVISION ASSISTANT CITY ENGINEER | | STREET PLAN and PROFILE HEDRICK AVENUE JONES AVENUE TRACT 3082 HORIZ. SCALE: 1" = 50' VERT. SCALE: 1" = 5' PROJECT NO. 1 R-1009 SHEET 1 OF 2 FILE NO. 2775 | |
|---|--|--|--|--|--|

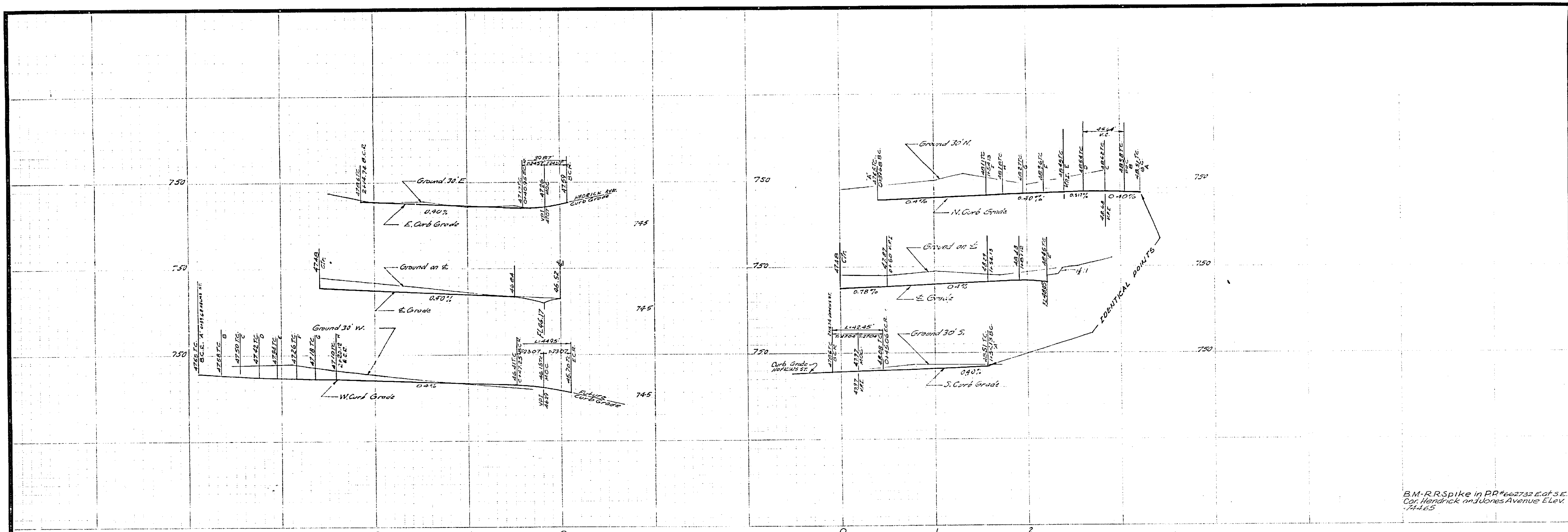

B.M.-RR Spike in PP#662732 E of S.E. Cor. Hendrick and Jones Avenue Elev. 744.85

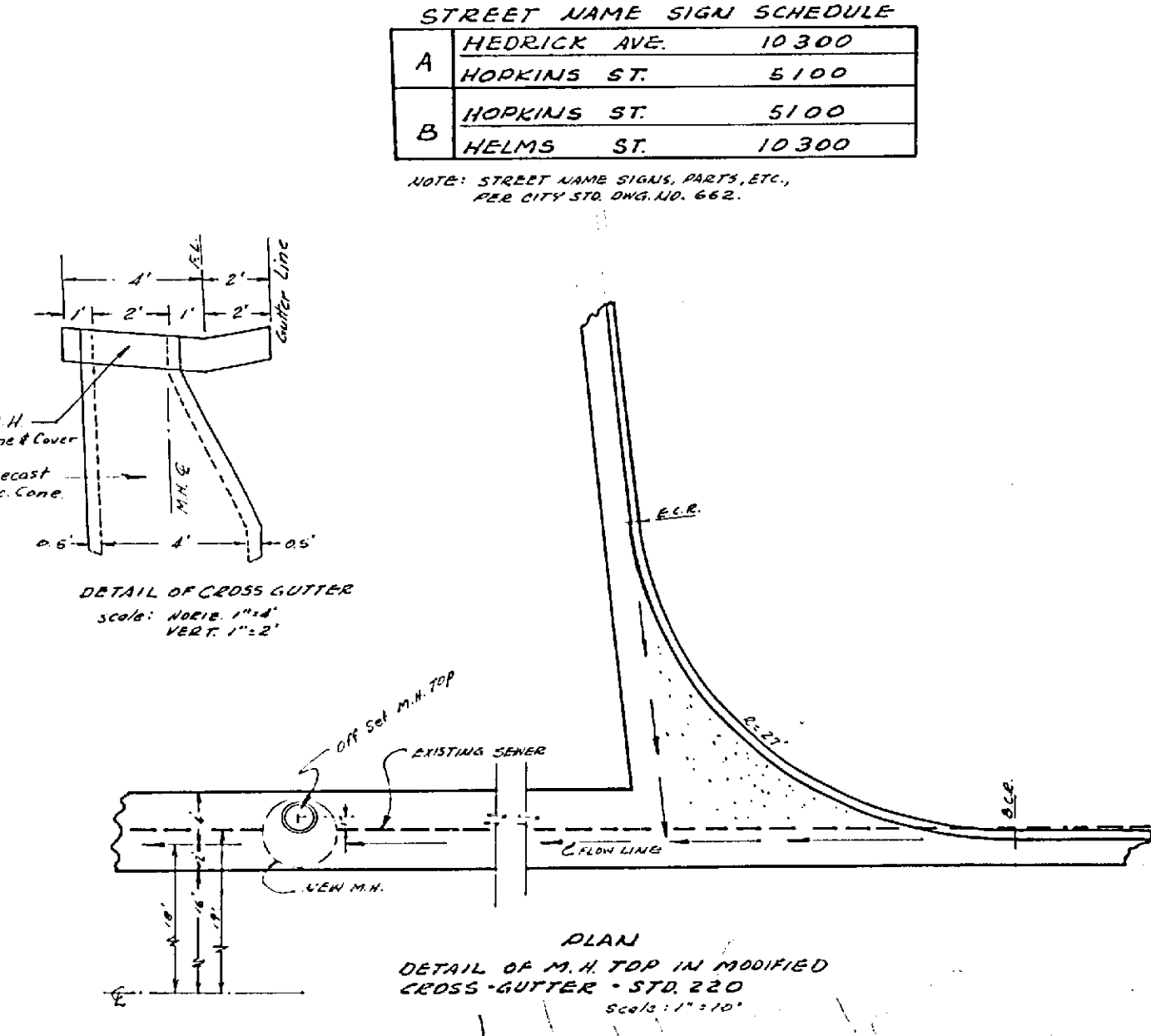
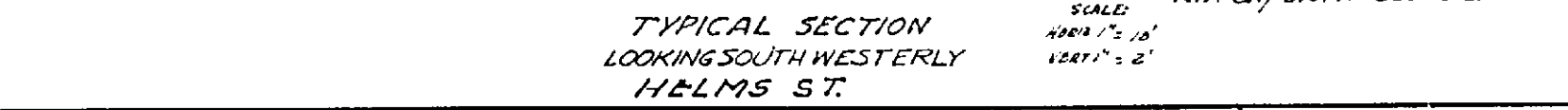
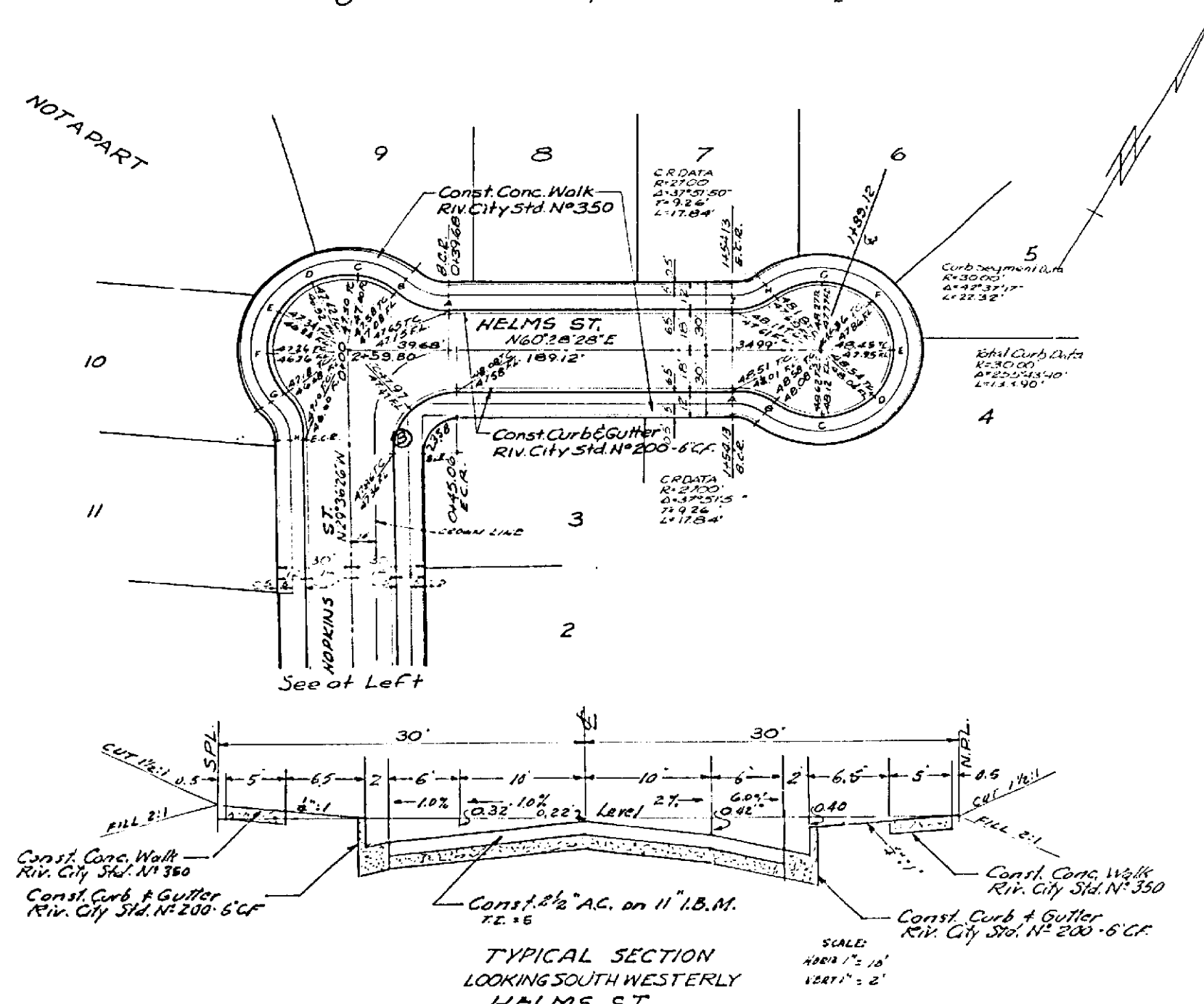
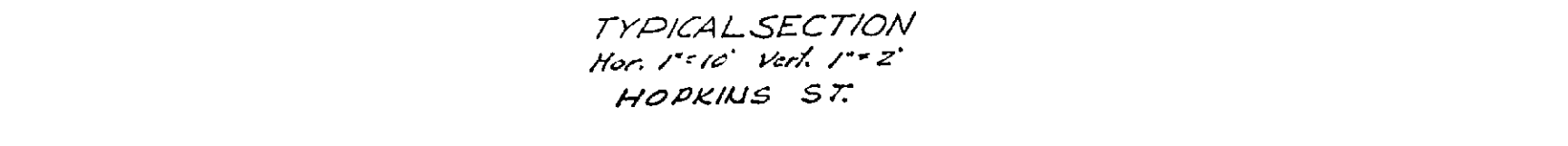
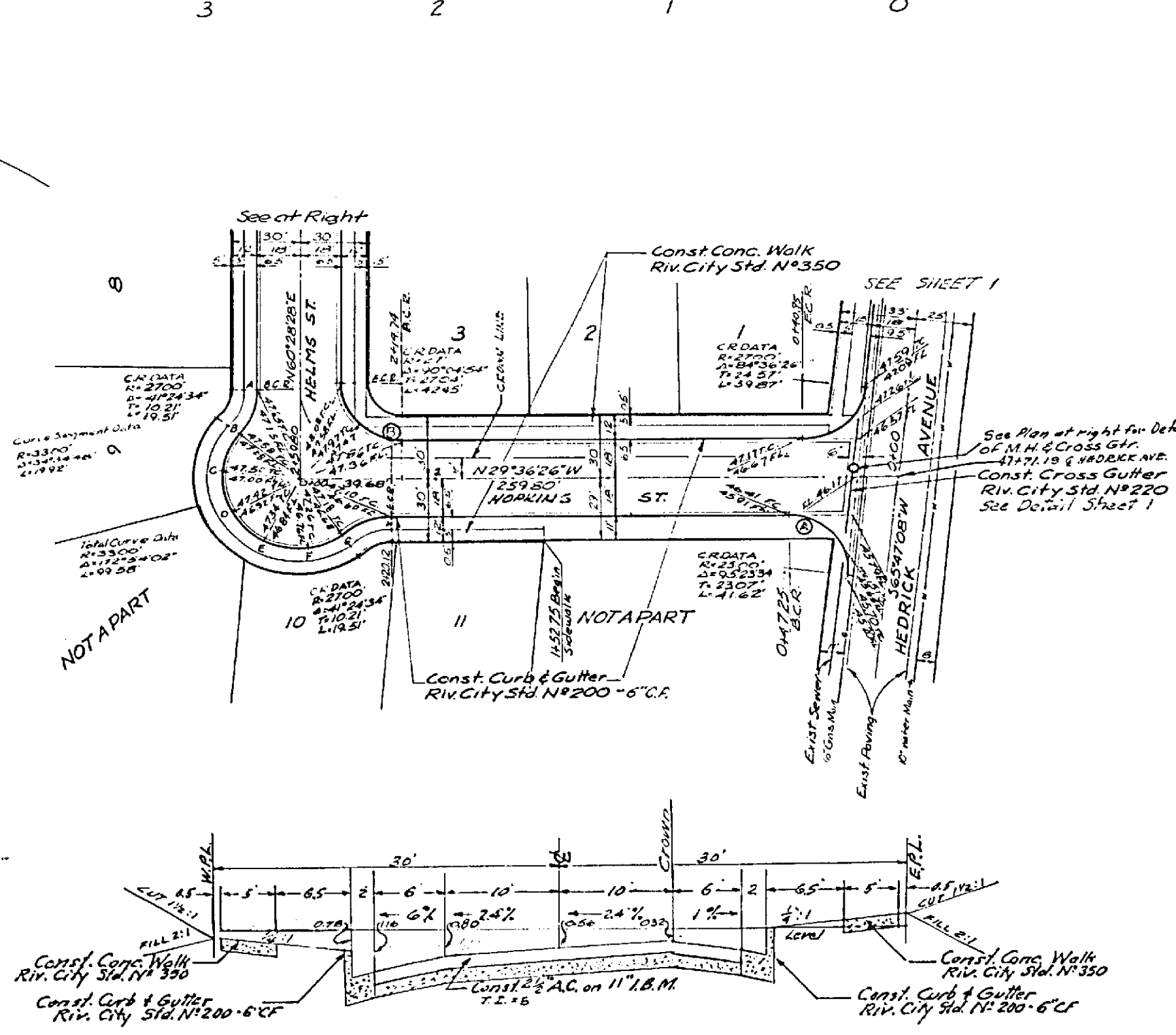
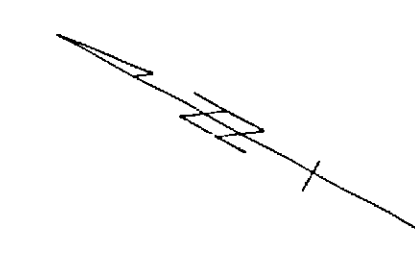

STREET NAME SIGN SCHEDULE

| | | |
|---|--------------|--------|
| A | HEDRICK AVE. | 10 300 |
| | HOPKINS ST. | 5 100 |
| B | HOPKINS ST. | 5 100 |
| | HELMS ST. | 10 300 |

NOTE: STREET NAME SIGNS, PARTS, ETC., PER CITY STD. DIV. NO. 662.

| | | | | |
|---|---|---|--|---|
| J. F. DAVIDSON ASSOCIATES CIVIL ENGINEERS - SURVEYORS - PLANNERS RIVERSIDE, CALIFORNIA APPROVED BY: <i>[Signature]</i> DATE: 12-9-66 R.E. No. 15664 W.G. 12400 FOR: <i>[Signature]</i> F.B. 692-8 | REVISIONS APPR. DATE DESIGNED BY: E.A.K. DRAWN BY: CHECKED BY: B.G.J. | CITY OF RIVERSIDE, CALIFORNIA DEPARTMENT OF PUBLIC WORKS APPROVED BY: <i>[Signature]</i> DATE: 6-10-66 OFFICE ENGINEER PARK DEPARTMENT TRAFFIC DIVISION ASSISTANT CITY ENGINEER | STREET PLAN & PROFILE HOPKINS STREET HELMS STREET TRACT-3082 HORIZ. SCALE: 1" = 50' VERT. SCALE: 1" = 5' | PROJECT NO. R-1009 SHEET 2 OF 2 FILE NO. 2775 |
| | | DATE: 6-10-66 | FILE NO. 2775 | |