

PROFILE
HORIZ SCALE 1" = 20'
VERT. SCALE 1" = 3'

PLAN
SCALE 1" = 20'

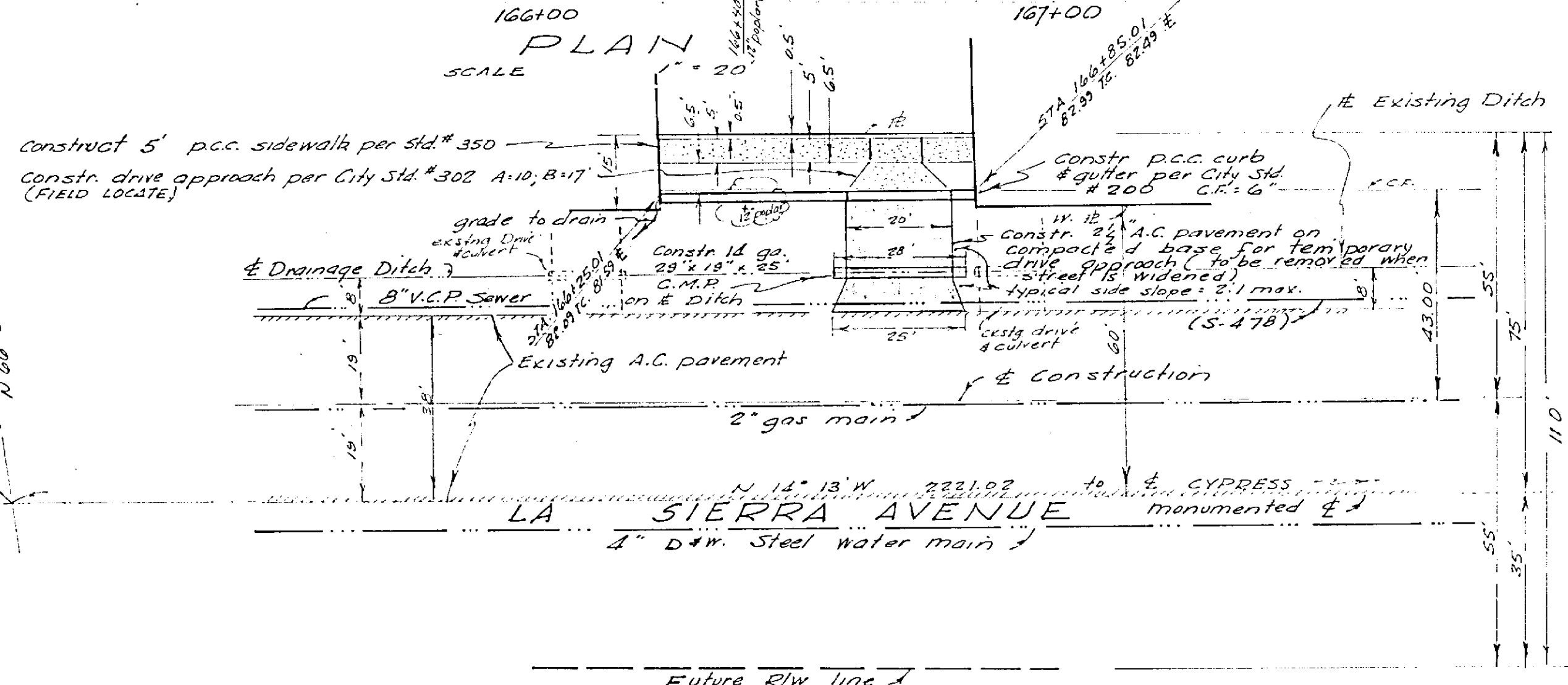

GENERAL NOTES

- All construction shall be in accordance with standards and specifications No. 161 of the City of Riverside, Dept. of Public Works.
- Trim edge of existing pavement to clean straight line. Construct match-up paving and overlay existing pavement as directed in the field to produce smooth crown section.
- It shall be the responsibility of the contractor to clear the right of way in accordance with the provisions of law as it affects each utility, including irrigation lines and appurtenances, and at no cost to the City.
- Prime Coat, paint binder and seal coat are required.
- Grading will require a permit under Ordinance 3093 for a cut or fill exceeding 100 cubic yards or a fill over one foot in depth.
- The developer shall arrange for a test of the subgrade level by a soils engineer. Depth and type of cover shall be determined by the soils engineer and submitted to the City of Riverside for approval.
- The finish subgrade shall have a compaction of not less than 90% for a depth of 6" as determined by test no. California 216 immediately prior to placement of cover.
- BENCH MARK: R.R. spike in P.P. 154386, S.E. Corner Cypress Ave. and La Sierra Avenue, City of Riverside B.M. Elev. 750.123
- Refer to E.A.S. Project Dwg. S-701(1) in County Surveyors Office for existing construction.

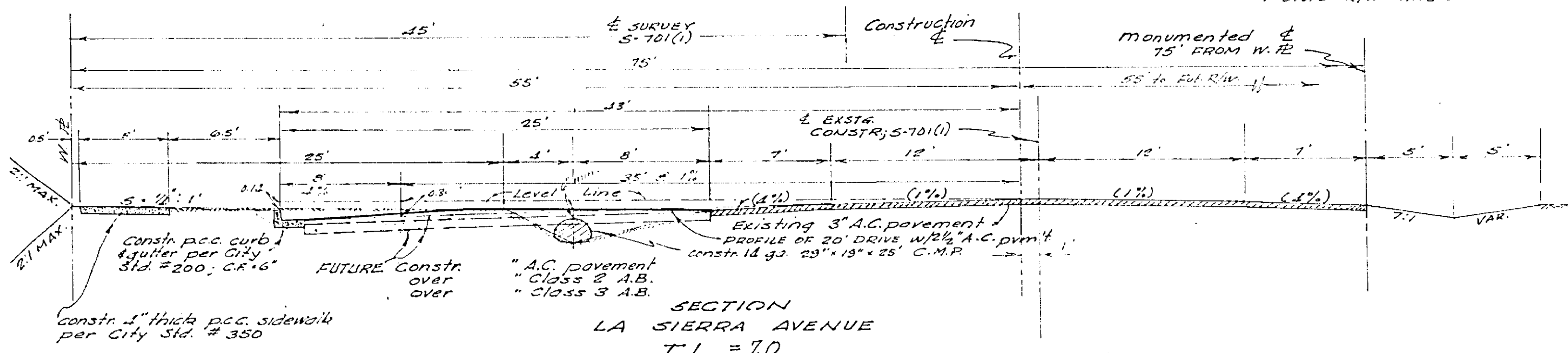

SECTION
LA SIERRA AVENUE
T.I. = 7.0
NO SCALE

NOTE!! - Section is as shown on S-701(1) County Road Department.

PARK & RECREATION DEPT.
BY: *Rennie Davenport* 7-1-65
DATE

ROBERT L. TAYLOR
CIVIL ENGINEER
APPROVED BY: *Robert L. Taylor*
RCE # 10470

CITY OF RIVERSIDE, CALIFORNIA DEPARTMENT OF PUBLIC WORKS	
APPROVED BY	DATE
OFFICE ENGINEER	7-1-65
PARK DEPARTMENT	
TRAFFIC DIVISION	
APPROVED BY	DATE
DIRECTOR OF PUBLIC WORKS	7-8-65
DESIGNED BY	DRAWN BY
CHECKED BY	102

STREET PLAN & PROFILE WESTERLY CURB LA SIERRA AVENUE WEST SIDE, 1700' N/W OF CAMPBELL AVE	
PROJECT NO. 55 238	R-1012
SHEET . . . OF . . .	FILE NO.
HORIZ. SCALE: 1" = 20' VERT. SCALE: 1" = 3'	