

Scale 1" = 100'

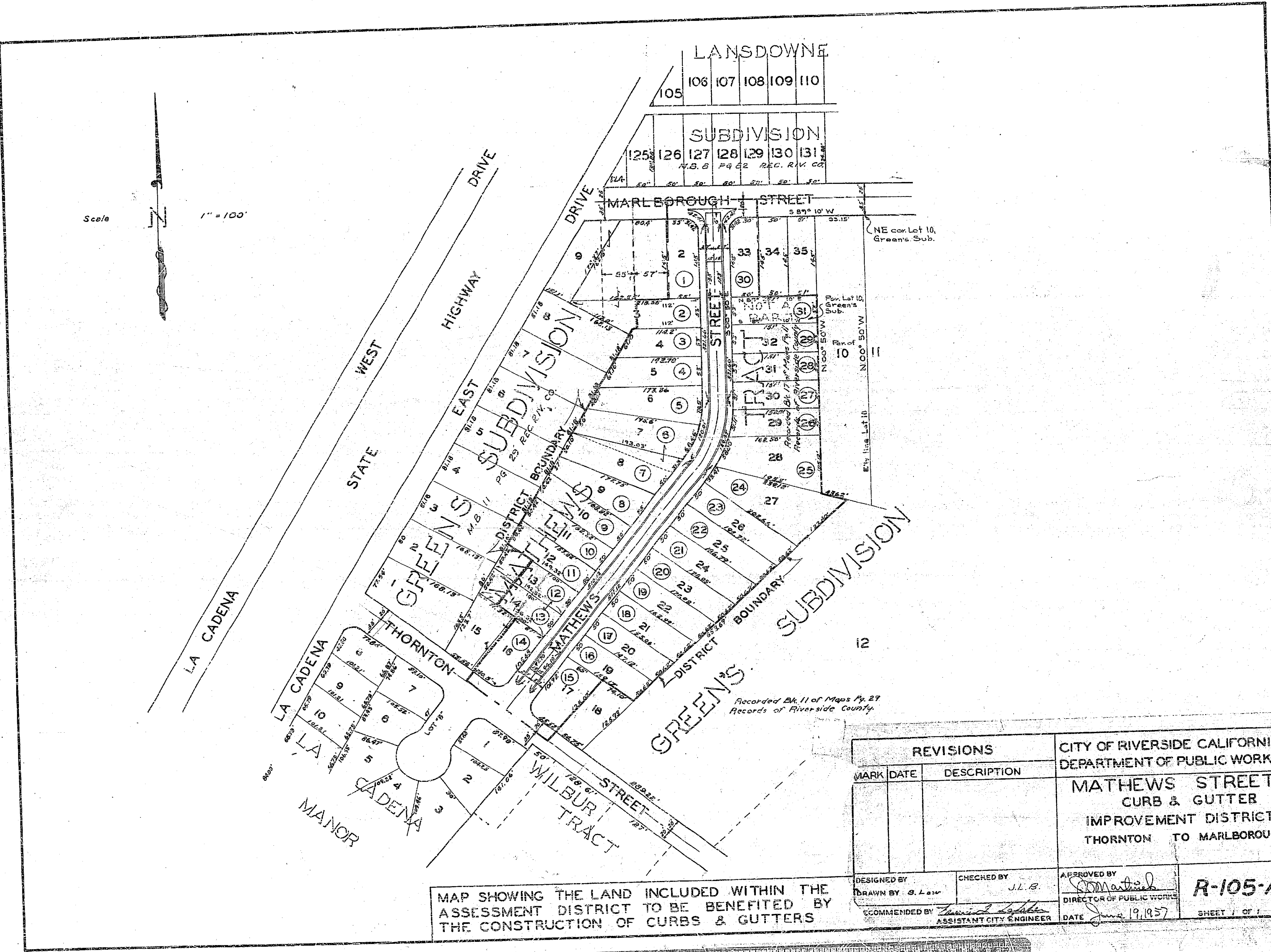
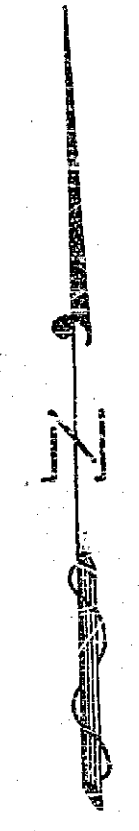

Recorded Bl. 11 of Maps P. 29
Records of Riverside County.

MAP SHOWING THE LAND INCLUDED WITHIN THE ASSESSMENT DISTRICT TO BE BENEFITED BY THE CONSTRUCTION OF CURBS & GUTTERS

REVISIONS		CITY OF RIVERSIDE CALIFORNIA DEPARTMENT OF PUBLIC WORKS	
MARK	DATE	DESCRIPTION	
		MATHEWS STREET CURB & GUTTER IMPROVEMENT DISTRICT THORNTON TO MARLBOROUGH	
DESIGNED BY	CHECKED BY	APPROVED BY	R-105-A SHEET 1 OF 1
DRAWN BY <i>G. Law</i>	<i>J.L.B.</i>	<i>[Signature]</i>	
RECOMMENDED BY	ASSISTANT CITY ENGINEER	DATE	
<i>[Signature]</i>		<i>June 19, 1957</i>	

ASSESSMENT NO. 442
DIAGRAM

EXHIBITING MATHEWS STREET IMPROVEMENT DISTRICT

IN THE CITY OF RIVERSIDE ON WHICH WORK HAS BEEN DONE UNDER THE OFFICIAL CONTRACT OF THE SUPERINTENDENT OF STREETS OF SAID CITY WITH CARL J. FREJD DATED OCTOBER 11, 1957 FOR THE CONSTRUCTION OF CONC. CURB & GUTTER, CONC. APRONS, & CONC. CROSS GUTTER ON MATHEWS ST BETWEEN THORNTON ST. & MARLBOROUGH ST. AS IS MORE PARTICULARLY DESCRIBED IN SAID CONTRACT TO WHICH REFERENCE IS HEREBY MADE FOR FURTHER PARTICULARS; SAID DIAGRAM ALSO SHOWS THE RELATIVE LOCATION OF EACH LOT PORTION OF LOT, PIECE OR PARCEL OF LAND ASSESSED FOR THE WORK DONE NUMBERED IN CIRCLES TO CORRESPOND TO THE RED INK NUMBERS IN THE ASSESSMENT. HEREIN FIGURES NEXT TO PROPERTY LINES SHOW LENGTH OF SAID LINES IN FEET. THE MARK (') MEANS FEET. PROPERTY LINES THAT DIFFER FROM THE RECORDED SUBDIVISIONS ARE SHOWN BY BROKEN LINES. THE DISTRICT BENEFITED IS BOUNDED BY A HEAVY DASHED LINE. PROPERTY COVERED BY THIS ASSESSMENT IS SHOWN ON THE FOLLOWING RECORDED MAPS:

MATHEWS TRACT M.B. 17/11 REC. RIV. CO.

HEREIN THE LEGEND OF THE DIFFERENT KINDS OF WORK PERFORMED IS SHOWN AS FOLLOWS:

CONC. CURB & GUTTER —————
CONC. APRONS & CROSS GUTTER ————



CITY ENGINEER OF THE CITY OF RIVERSIDE
THE FOLLOWING IS A STATEMENT OF AMOUNTS OF DIFFERENT KINDS OF WORK DONE BY CARL J. FREJD UNDER CONTRACT DATED OCTOBER 11, 1957 PURSUANT TO RESOLUTION OF INTENTION NO. 7311 ADOPTED BY THE CITY COUNCIL OF THE CITY OF RIVERSIDE ON THE 9TH DAY OF JULY 1957

2,008.86 LIN. FT. CONC. CURB & GUTTER STD. 108 6" C.F.
360.93 SQ. " " APRONS
136.00 " " " CROSS GUTTER

AT SAID CITY OF RIVERSIDE THIS 21 DAY OF Nov

Orval Callington
STREET SUPERINTENDENT
OF THE CITY OF RIVERSIDE

I HEREBY CERTIFY THAT THE ABOVE WORK WAS DONE IN ACCORDANCE WITH LINES AND GRADES FURNISHED BY ME AND THAT THE DIAGRAM OF THE ASSESSMENT DISTRICT FOR THE SAME IS CORRECT.

Carl J. Frejd
CITY ENGINEER
OF THE CITY OF RIVERSIDE

RECORDED AT 8:40 O'CLOCK P.M.
THIS 8 DAY OF Jan 1957

Orval Callington
SUPERINTENDENT OF STREETS
OF THE CITY OF RIVERSIDE

E-1259
1101