

PROFILE
 horiz. scale 1" = 40'
 vert. scale 1" = 4'

PLAN
 scale 1" = 40'

GENERAL NOTES

- All construction shall be in accordance with Standards and Specifications No. 261 of the City of Riverside, Department of Public Works.
- Trim edge of existing pavement to clean straight line. Construct match up paving and overlay existing paving as directed to produce smooth crown section.
- It shall be the responsibility of the contractor to clear the right of way in accordance with the provisions of law as it affects each utility, including irrigation lines and appurtenances and at no cost to the City.
- Prime Coat, Peint binder and seal Coat are required.
- Grading will require a permit under Ordinance 3093 for a cut or fill exceeding 100 cubic yards or a fill over one foot in depth.
- The developer shall arrange for a test of the subgrade level by a soils engineer. Depth and type of cover shall be determined by the soils engineer and submitted to the City of Riverside for approval.
- The finish subgrade shall have a compaction of not less than 90% for a depth of 0.5 feet as determined by Test No. California 616 immediately prior to placement of cover.
- Benchmark: Pk. nail one foot east of B.C.R. curb return @ S.E. corner of Mountain View Avenue and Vanessa Street. (STA. 13+1760 ± 31. Curb Mtn. Ven) U.S.G.S. EL. = 789.66

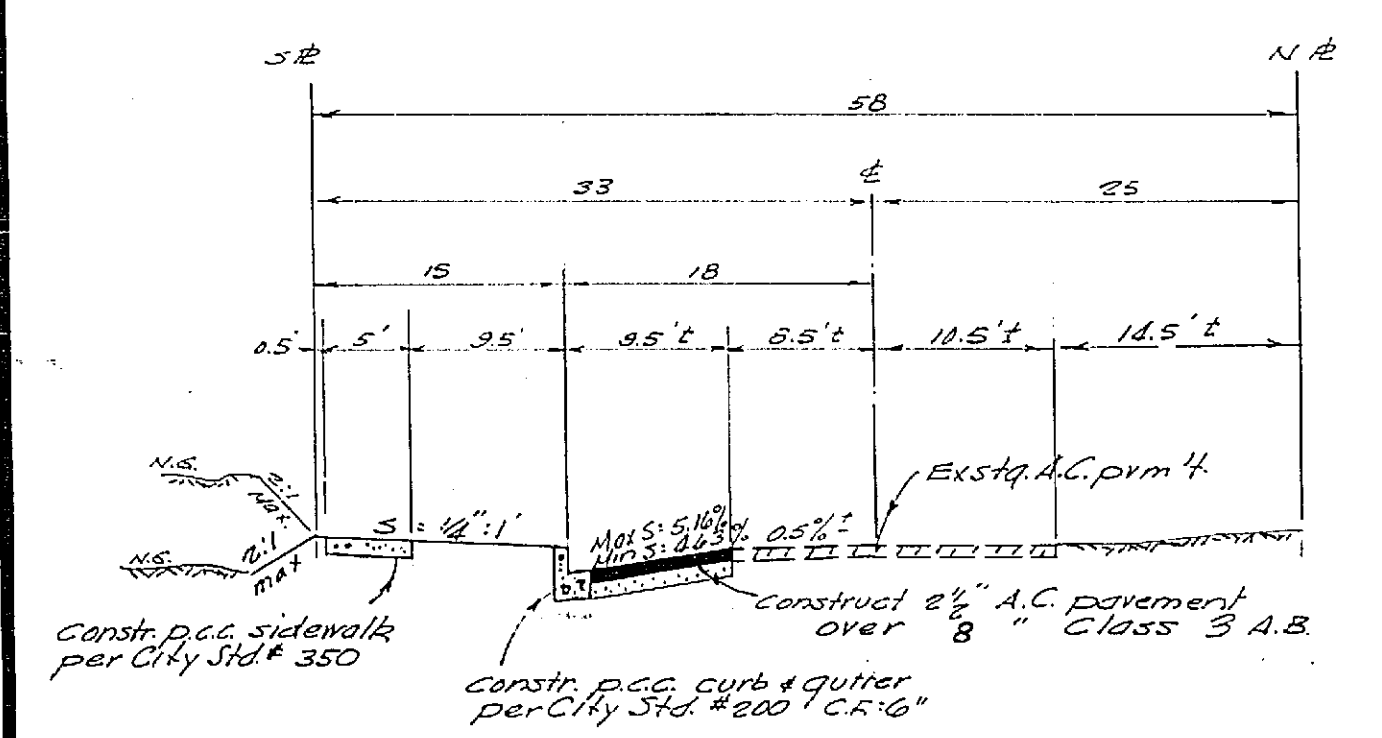

TYPICAL SECTION
 MOUNTAIN VIEW AVENUE
 no scale
 T.I. = 5.0

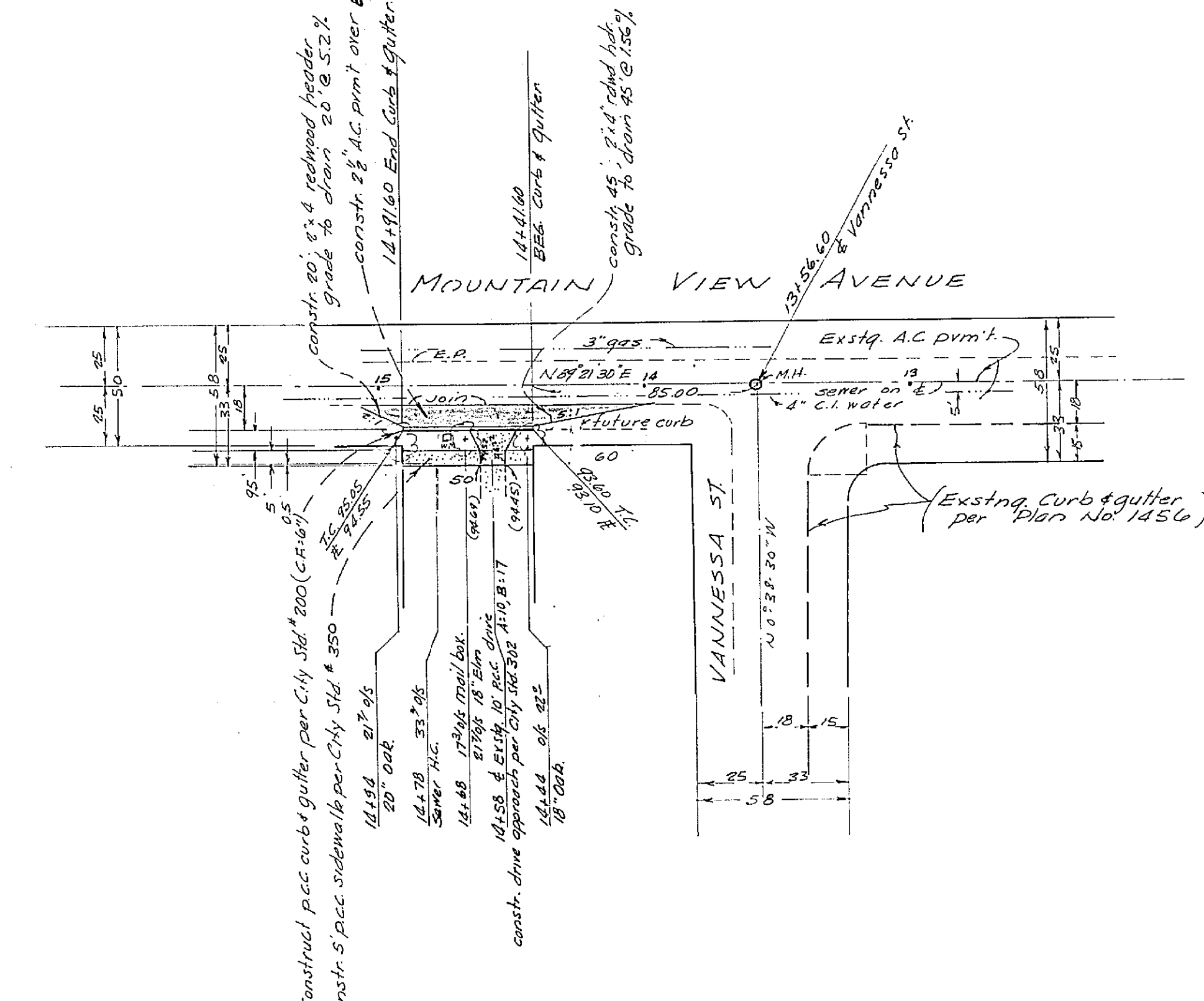

ROBERT J. TAYLOR
 CIVIL ENGINEER

APPROVED BY:
Robert J. Taylor
 RCE 10470

CITY OF RIVERSIDE, CALIFORNIA DEPARTMENT OF PUBLIC WORKS		STREET PLAN & PROFILE MOUNTAIN VIEW AVE. (100' width of Vanessa) STA. 12+21.60 to 12+91.60		PROJECT NO. R-1063
APPROVED BY OFFICE ENGINEER PARK DEPARTMENT TRAFFIC DIVISION ASSISTANT CITY ENG.	BY 7-27-65	DATE 7-26-65	DATE 7-27-65	SHEET 1 OF 1
DESIGNED BY	DRAWN BY	CHECKED BY	HORIZ. SCALE: 1" = 40'	VERT. SCALE: 1" = 4'