

Profile View Data:

Stationing	Elevation
245+15	12.37
245+25	12.34
245+35	12.31
245+45	12.28
246+85	12.16
246+95	12.13
247+05	12.10
247+15	12.07
247+25	12.04

Profile View Data (Continued):

249+00	12.30
249+10	12.28
249+20	12.26
249+30	12.24
249+40	12.22
249+50	12.20
249+60	12.18
249+70	12.16
249+80	12.14
249+90	12.12
250+00	12.10
250+10	12.08
250+20	12.06
250+30	12.04
250+40	12.02
250+50	12.00
250+60	11.98
250+70	11.96
250+80	11.94
250+90	11.92
251+00	11.90
251+10	11.88
251+20	11.86
251+30	11.84
251+40	11.82
251+50	11.80
251+60	11.78
251+70	11.76
251+80	11.74
251+90	11.72
252+00	11.70
252+10	11.68
252+20	11.66
252+30	11.64
252+40	11.62
252+50	11.60
252+60	11.58
252+70	11.56
252+80	11.54
252+90	11.52
253+00	11.50

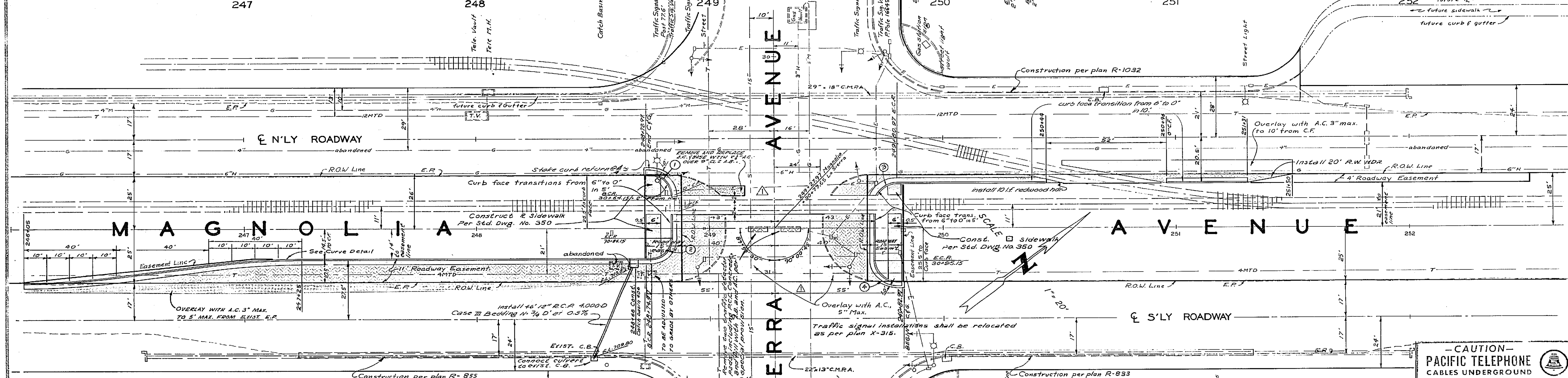

**CURB CURVE DETAIL**  
246+05 to 247+25

NO.	R	Δ	T	L
1	10'	90°00'30"	10.00'	15.71'
2	10'	89°29'30"	10.00'	15.71'
3	10'	90°00'30"	10.00'	15.71'
4	10'	90°00'30"	10.00'	15.71'

REFERENCE: FB. 701/62/69 FB. 723/71-75

**CAUTION - PACIFIC TELEPHONE CABLES UNDERGROUND BEFORE EXCAVATING CALL COLLECT**

CITY OF RIVERSIDE, CALIFORNIA  
DEPARTMENT OF PUBLIC WORKS

**LA SIERRA AND MAGNOLIA INTERSECTION**

**R-1072**

R.R. CROSSING NUMBER 6W - 8.25

APPROVED BY: [Signature]  
DIRECTOR OF PUBLIC WORKS

DATE: 6-24-68

HORIZ. SCALE: 1" = 20' VERT. SCALE: 1" = 2'

CONTRACT 75-1-1