

H.M. 1954

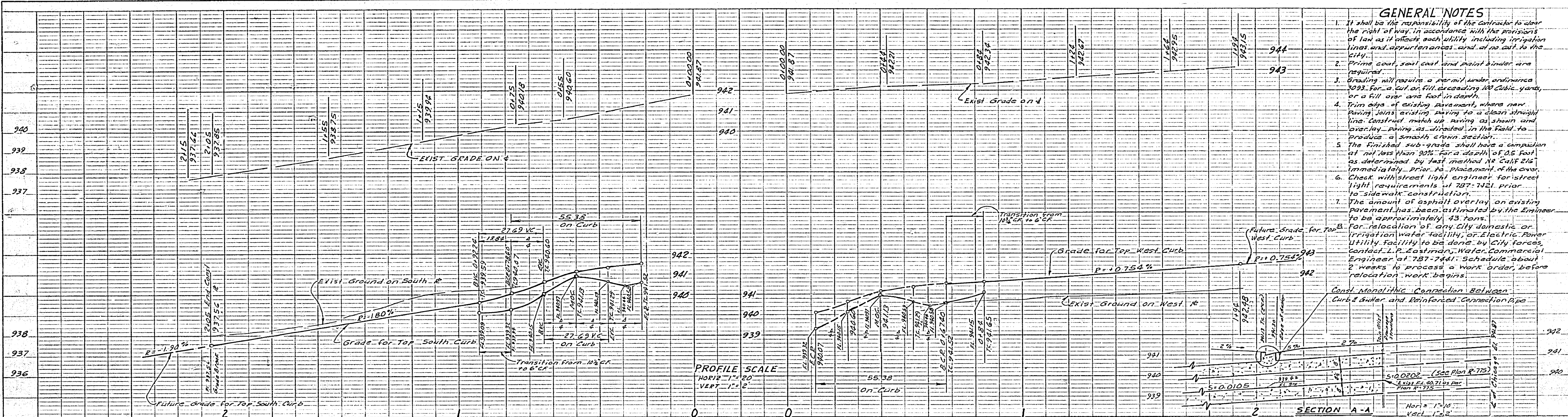

GENERAL NOTES

- It shall be the responsibility of the contractor to clear the right of way in accordance with the provisions of law as it affects each utility including irrigation lines and appurtenances and of no cost to the city.
- Prime coat, seal coat and joint binder are required.
- Grading will require a permit under ordinance 3093 for a cut or fill exceeding 100 cubic yards, or a fill over one foot in depth.
- Trim edge of existing pavement where new paving joints existing paving to a clean straight line. Construct match up paving as shown and overlay paving as directed in the field to produce a smooth crown section.
- The finished sub-grade shall have a compaction of not less than 90% for a depth of 15 feet as determined by test method No. 2031-216 immediately prior to placement of the curb.
- Check with street light engineer for street light requirements at 787-1421 prior to sidewalk construction.
- The amount of asphalt overlay on existing pavement has been estimated by the Engineer to be approximately 43 tons.
- For relocation of any City domestic or irrigation water facility, or Electric Power Utility facility to be done by City forces, contact L.P. Eastman, Water Commercial Engineer at 787-7441. Schedule about 2 weeks to process a work order, before relocation work begins.

PROFILE SCALE
 HORIZ 1" = 20'
 VERT 1" = 2'

CONSTRUCTION NOTES

- Const. Curb & Gutter as per std. dwg. #200 G.C.F.
- Const. Commercial Driveway as per std. dwg. #302, #125, #139
- Const. 12' Parkway Conc. Sidewalk as per std. dwg. #325
- Const. S.A.C. & Seal Coat over S.C.L.A.B. (per State Specs)
- Depress Paving to form Flow Lines.
- Pour sidewalk & drainage structure together. Steel reinforcing & drainage structure per std. #410.
- Const. Drainage Structure per std. Plan on Lot.
- Const. Std. Frame & Cover per std. #450.

STREET LIGHT NOTES

- All street light standards and pullboxes to be located in the field.
- All street light standards shall be checked for clearance of driveways and placed 1' from end of curb returns.
- See City of Riverside Div. No. 11-15011 for light standard details and Draw. #11-15003 & 604. for pullbox details.
- All cables to be AWG No. 8 Copper.
- This is a 2 wire 240 volt multiple system.
- All construction to comply with City of Riverside Street Light Specifications.
- Dimensions to be called for as outlined in specifications.
- Final Point (S) to be confirmed at time of construction.
- \$75.00 Compensation Fee paid - 7-30-65.
- The City of Riverside Traffic Engineering Division will pay \$180.00 toward the cost of this project to the Developer upon completion of the work and receipt of a statement from the Developer.

STREET LIGHT LEGEND

- Indicates City of Riverside masthead light standard No. 6830 with 20,000-400W. Type 21 "Living Metal" mercury vapor luminaire Cal. # L.M. 53A2 or approved equal.
- Indicates No. 3 1/2 pullbox "Brooks Products Inc." or approved equal.
- Indicates No. 5 pullbox "Brooks Products Inc." or approved equal.
- Indicates 1" rigid galv. steel conduit, except as noted.
- Indicates seal point.

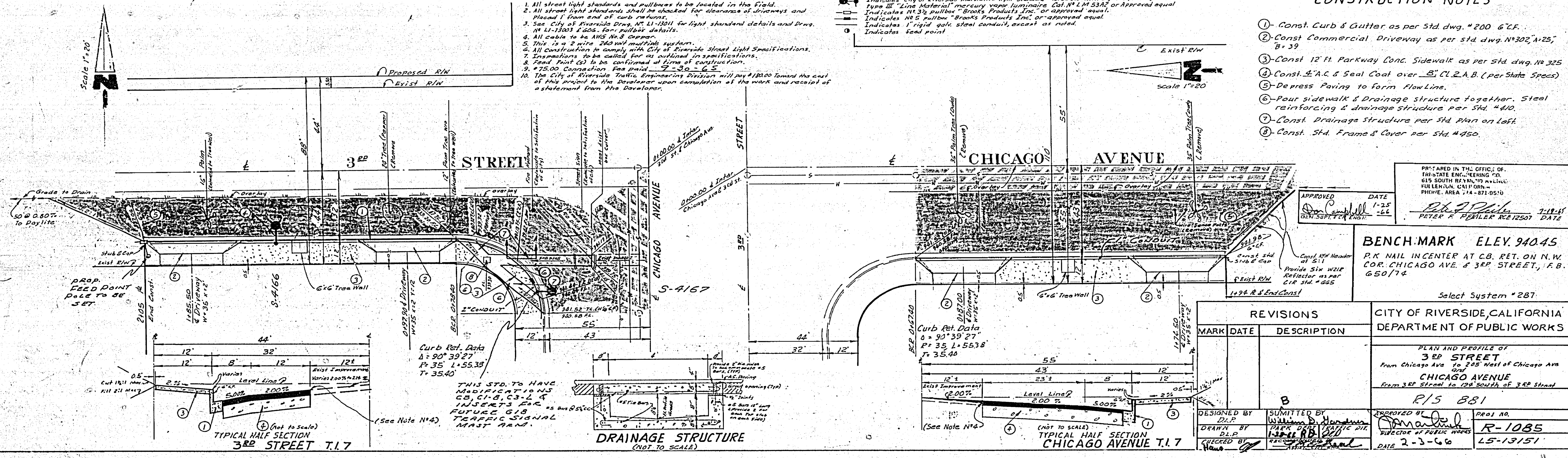

PREPARED IN THE OFFICE OF THE
 TRISTATE ENGINEERING CO.
 815 SOUTH BAYVIEW AVENUE
 FULLERTON, CALIFORNIA
 PHONE AREA 714-871-9510

APPROVED DATE 1-25-66
 PETER K. REILER REGISTERED ENGINEER

BENCH-MARK ELEV. 940.45
 P.K. NAIL IN CENTER AT C.B. RET. ON N.W. COR. CHICAGO AVE. & 3RD STREET, F.B. 650/74

| REVISIONS | |
|-----------|------|
| MARK | DATE |
| | |
| | |
| | |

| | |
|--|------------------------------------|
| CITY OF RIVERSIDE, CALIFORNIA DEPARTMENT OF PUBLIC WORKS | |
| PLAN AND PROFILE OF 3RD STREET From Chicago Ave. to 245' West of Chicago Ave. CHICAGO AVENUE From 3RD Street to 126' South of 3RD Street | |
| R/15 881 | |
| DESIGNED BY D.P. | SUBMITTED BY William D. Handman |
| DRAWN BY D.P. | CHECKED BY D.P. |
| APPROVED BY [Signature] | PROJECT NO. R-1035 |
| DATE 2-3-66 | DATE 4-13-51 |

PLAN
 CHICAGO AVENUE
 FROM CHICAGO AVE. TO 245' WEST OF CHICAGO AVE.
 FROM 3RD STREET TO 126' SOUTH OF 3RD STREET