

BENCH MARK
 12.5' x 12.5' x 12.5' GL. chisel on North
 end of NW corner Ransom & Shaker.

- (6) The finished sub grade shall have a compaction of not less than 95% for depths of 0.5' and as determined by test method No. "CAL. 216" immediately prior to placement of the cover.
- (7) Construction to control City, Gas, P. Shaker, Drive in not constructed to 250, 280 & 300 at time of the construction.
- (8) Check with Street Lighting Engineer for street light requirements, Phase 787-7421, 24 hours prior to sidewalk construction.
- (9) Check with Park & Recreation Dept. Street Tree Division for tree well requirements, phone 787-7300.

QUANTITY ESTIMATE	
Curb/Gutter Standard No. 200 (6" C.F.)	899 LF
2 1/2" A.C. and 100' coat	600 LF
Curb Type 5 Sidewalk Standard No. 325	40,014 SF
Imported Base Material	2,328 SF
Cross Gutter Standard No. 220	332 SF
2 1/4" Redwood Header	1,581 LF
Manhole Standard No. 180	1 EA
Outlet Structure Standard No. 410	2 EA
2" A.C. Paving, Erosion Protection	1,320 SF

CAUTION
 30" H.P. Gas Line, Contact So. Counties Gas Co. 24 Hrs. Prior to any excavation at 845 2617.

ALBERT A. WEBB ASSOCIATES
 CIVIL ENGINEERS
 RIVERSIDE, CALIFORNIA
 APPROVED BY: *E. D. N. W. O. R. DATE 1/15/66*
 R.E. No. 20222

NO.	DESCRIPTION	DATE
1	BASE COURSE ADDED TO 410	9-23-67
2	REVISIONS	

CITY OF RIVERSIDE, CALIFORNIA
 DEPARTMENT OF PUBLIC WORKS
 APPROVED BY: *[Signature]*
 DIRECTOR OF PUBLIC WORKS
 DATE 4-5-66

STREET PLAN AND PROFILE
 WEST SIDE
 SHAKER DRIVE
 From 72nd Street to Century Avenue
 CIR-R/S No. 932
 PROJECT NO. R-1096
 SHEET 1 OF 3
 FILE NO. C-4-425-A

DESIGNED BY: *[Signature]* DRAWN BY: *[Signature]* CHECKED BY: *[Signature]*

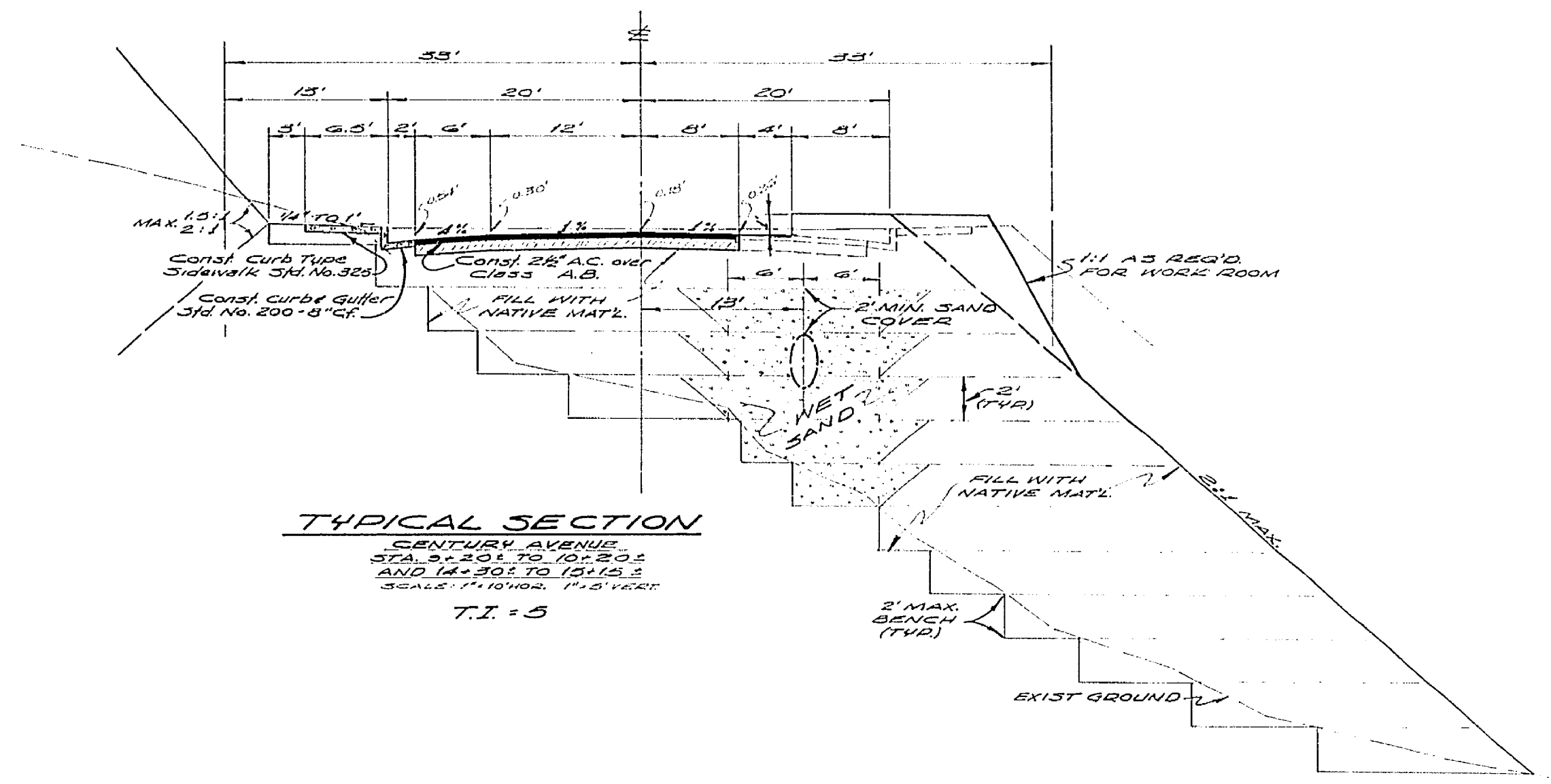
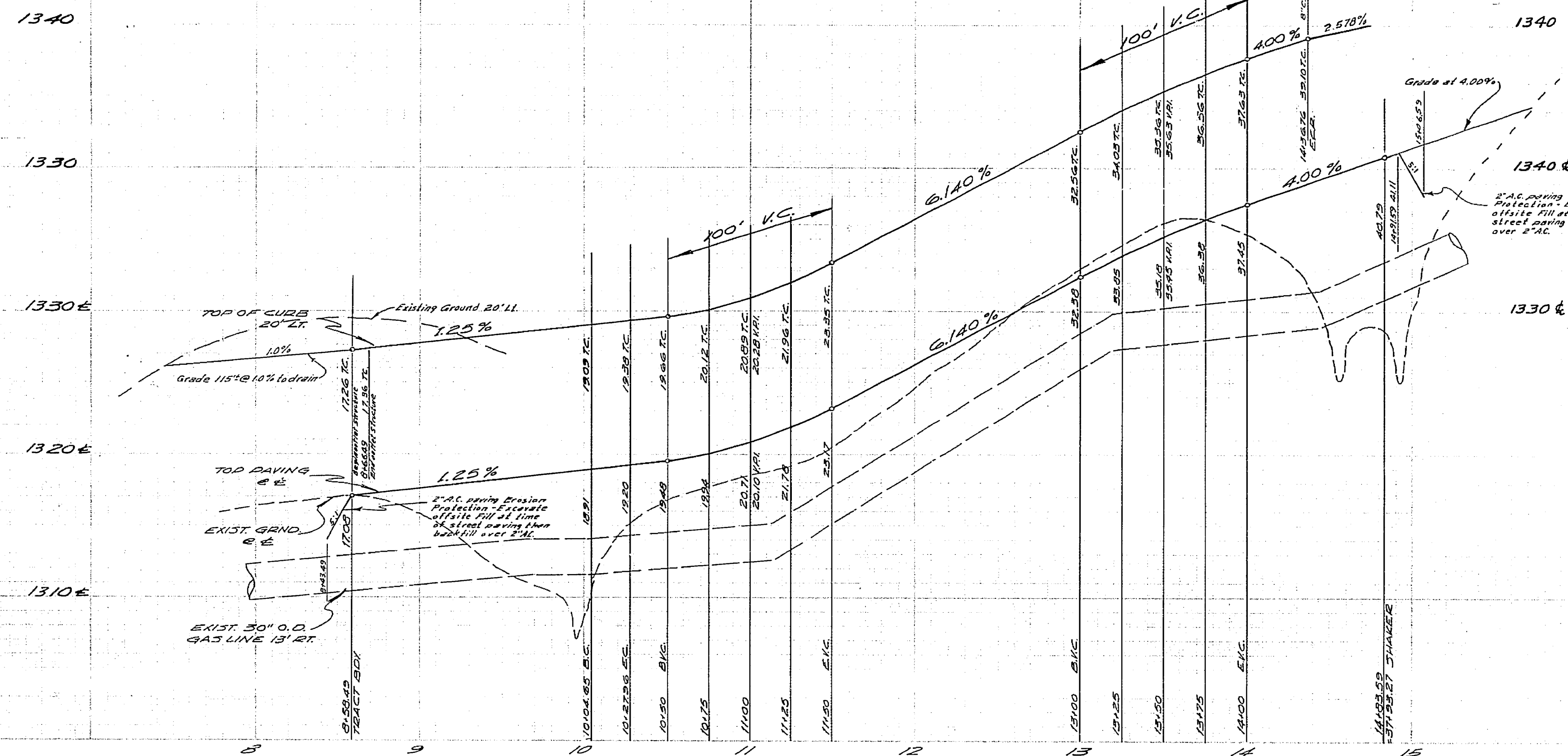

BENCH MARK:
 CB 543/14, Elev 1236.61, chisel on North
 end of NW corner Risom & Sherer.

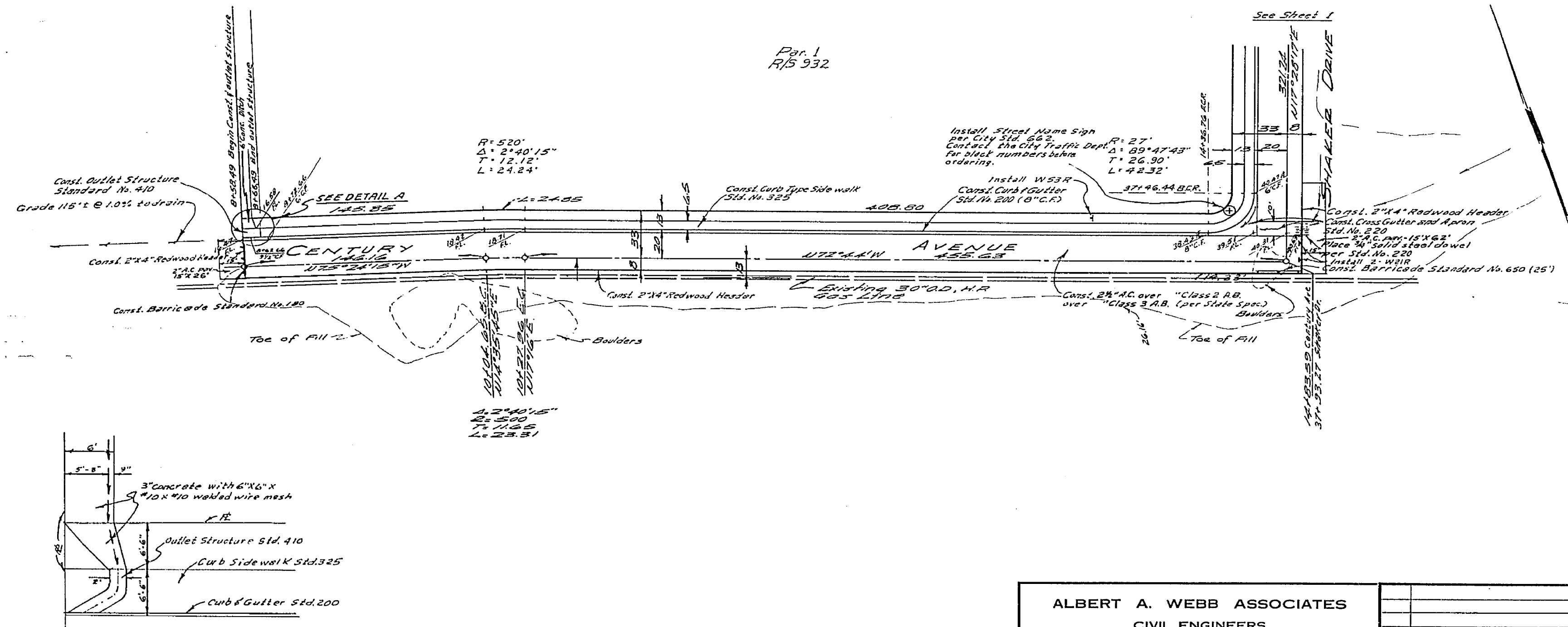

NOTE:
 Call Office C. Baird at So. Counties Gas Co.,
 645 S. 28th, 24 hours prior to working near
 30" Gas lines.

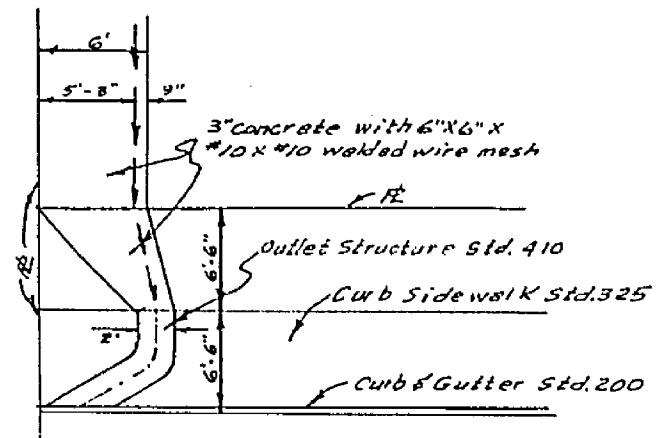
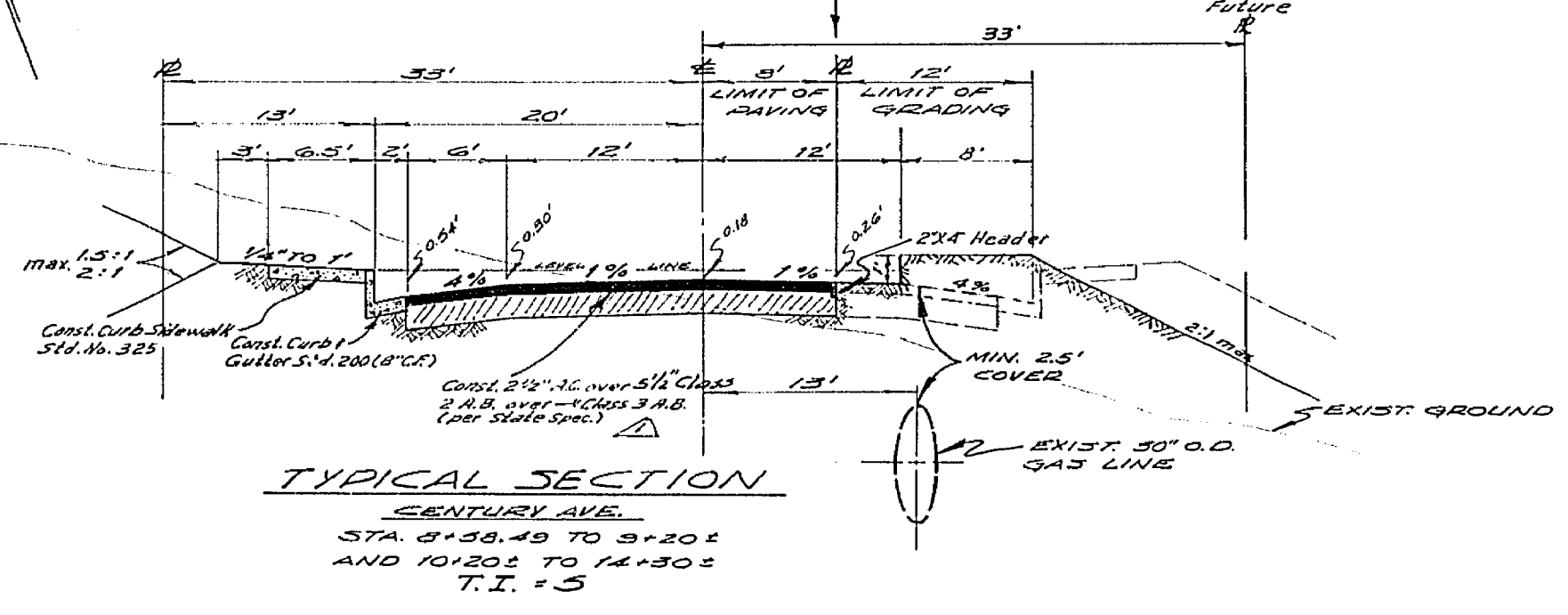

ALBERT A. WEBB ASSOCIATES CIVIL ENGINEERS RIVERSIDE, CALIFORNIA APPROVED BY: <i>[Signature]</i> DATE: 8/3/65 R.E. No. 3076 W.O. 44-473 FOR: RIVERSIDE CITY SCHOOLS P.D.	DESIGNED BY: <i>[Signature]</i> DRAWN BY: <i>[Signature]</i> CHECKED BY: <i>[Signature]</i>	CITY OF RIVERSIDE, CALIFORNIA DEPARTMENT OF PUBLIC WORKS APPROVED BY: <i>[Signature]</i> DATE: 8-5-66 OFFICE ENGINEER PARK DEPARTMENT TRAFFIC DIVISION ASSISTANT CITY ENG.	STREET PLAN AND PROFILE North Side CENTURY AVENUE Sherer Drive to 780' Waverly CIR-RIS No. 932	PROJECT NO. R-1096 SHEET 2 OF 2 FILE NO. 64-473-A
		DATE: 4-5-66	HORIZ. SCALE: 1" = 50' VERT. SCALE: 1" = 5'	