

- ### STREET LIGHT LEGEND and NOTES
- INDICATES CITY OF RIVERSIDE MARBLEITE LIGHT STANDARD NO 450A WITH 1000L FROM THE 11" LINE MATERIAL MERCURY VAPOR LUMINAIRE, CABLE LUMINAIRE OR IMPROVED EQUAL.
  - INDICATES 1" RIGID GALVANIZED STEEL CONDUIT, EXCEPT AS NOTED.
  - 1. ALL STREET LIGHT STANDARDS AND PULL BOXES TO BE LOCATED IN THE FIELD.
  - 2. ALL STREET LIGHT STANDARDS SHALL BE CHECKED FOR CLEARANCE OF DRIVEWAYS AND ADJACENT PROPERTY BEFORE INSTALLATION.
  - 3. SEE CITY OF RIVERSIDE DRAWING NO LI-13008 FOR LIGHT STANDARD DETAILS.
  - 4. ALL CABLE TO BE AWG 128 COPPER.
  - 5. THIS IS A 2 WIRE 240 VOLT MULTIPLE SYSTEM.
  - 6. ALL CONSTRUCTION TO COMPLY WITH CITY OF RIVERSIDE STREET LIGHT SPECIFICATIONS.
  - 7. INSPECTIONS TO BE CALLED FOR AS OUTLINED IN SPECIFICATIONS.
  - 8. FEED POINT TO BE CONFIRMED AT TIME OF CONSTRUCTION.

B.M. CITY OF RIVERSIDE DATUM  
S. & L. IN S.W. CORN. RETURN,  
SEQUOIA & CALIFORNIA  
F.B. 550/53 ELEV. 757.85

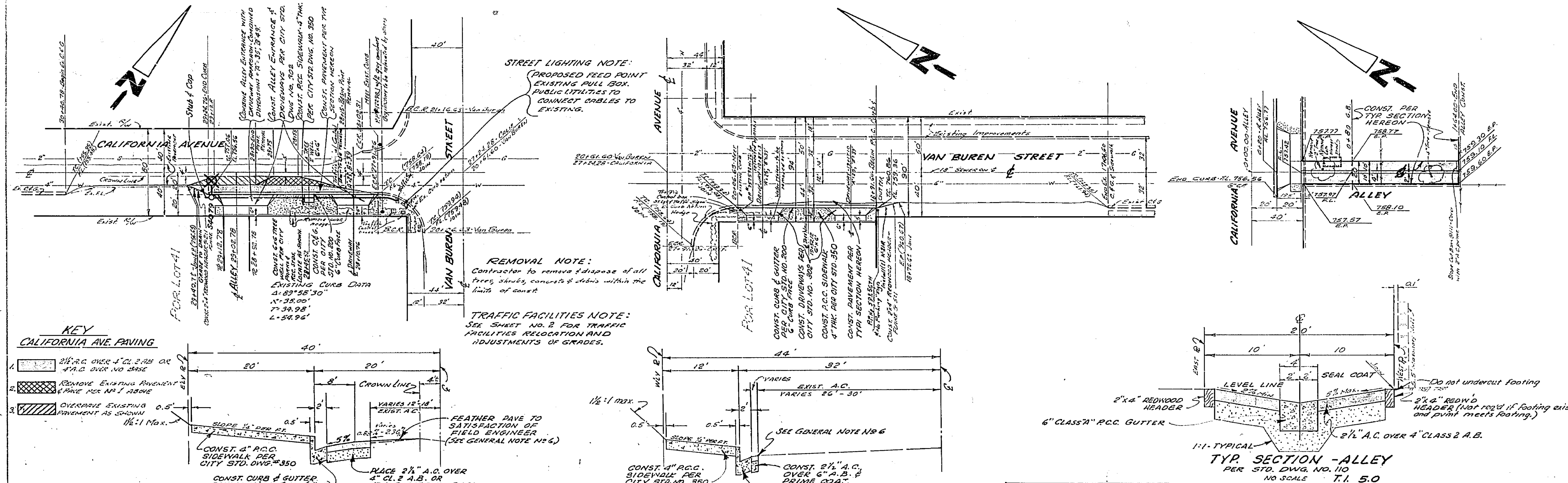

- ### GENERAL NOTES
1. IT SHALL BE THE RESPONSIBILITY OF THE CONTRACTOR TO CLEAR THE RIGHT OF WAY IN ACCORDANCE WITH THE PROVISIONS OF LAW AS IT AFFECTS EACH UTILITY INCLUDING IRIGATION LINE AND APPURTENANCES AND AT NO COST TO THE CITY.
  2. CONSTRUCTION SHALL BE IN ACCORDANCE WITH THE CITY OF RIVERSIDE DEPARTMENT OF PUBLIC WORKS SPECIFICATIONS NO. 461 AND STANDARD DRAWINGS.
  3. PRIME COAT, SEAL COAT, AND PAINT BINDER ARE REQUIRED.
  4. GRADING WILL REQUIRE A PERMIT UNDER ORDINANCE 3093 FOR A CUT OR FILL EXCEEDING 100 CUBIC YARDS, OR A FILL OVER ONE FOOT IN DEPTH.
  5. CONTACT PARK & RECREATION DEPARTMENT AT 797-7301 AND PUBLIC UTILITIES ENGINEERING AT 797-7621, TO ADJUST MATCH-UP PAVING AS SHOWN AND OVERLAY PAVING AS DIRECTED IN THE FIELD TO PRODUCE A SMOOTH CROWN SECTION.
  6. TRIM EDGE OF EXISTING PAVEMENT, WHERE NEW PAVING JOINS EXISTING PAVEMENT TO A CLEAN, STRAIGHT LINE. CONSTRUCT MATCH-UP PAVING AS SHOWN AND OVERLAY PAVING AS DIRECTED IN THE FIELD TO PRODUCE A SMOOTH CROWN SECTION.
  7. THE AMOUNT OF ASPHALT OVERLAY ON EXISTING PAVEMENT HAS BEEN ESTIMATED BY THE ENGINEER TO BE APPROXIMATELY 64 TONS.
  8. THE FINISHED SUBGRADE SHALL HAVE A RELATIVE COMPACTION OF NOT LESS THAN 90% FOR A DEPTH OF 0.5 FEET AS DETERMINED BY TEST METHOD NO. CALIF. SIG-6 (CODE DIV. OF HIGHWAYS, PROCEEDURES MANUAL VOL. 1) IMMEDIATELY PRIOR TO PLACEMENT OF COVER.
  9. FOR RELOCATION OF ANY CITY DOMESTIC OR IRRIGATION WATER FACILITY OR ELECTRIC POWER UTILITY FACILITY TO BE DONE BY CITY PRINCE, CONTACT L. P. EASTMAN, WATER COMMERCIAL ENGINEER, AT 794-787-7441. SCHEDULE ABOUT 2 WEEKS TO PROCESS A WORK ORDER, BEFORE RELOCATION WORK BEGINS.

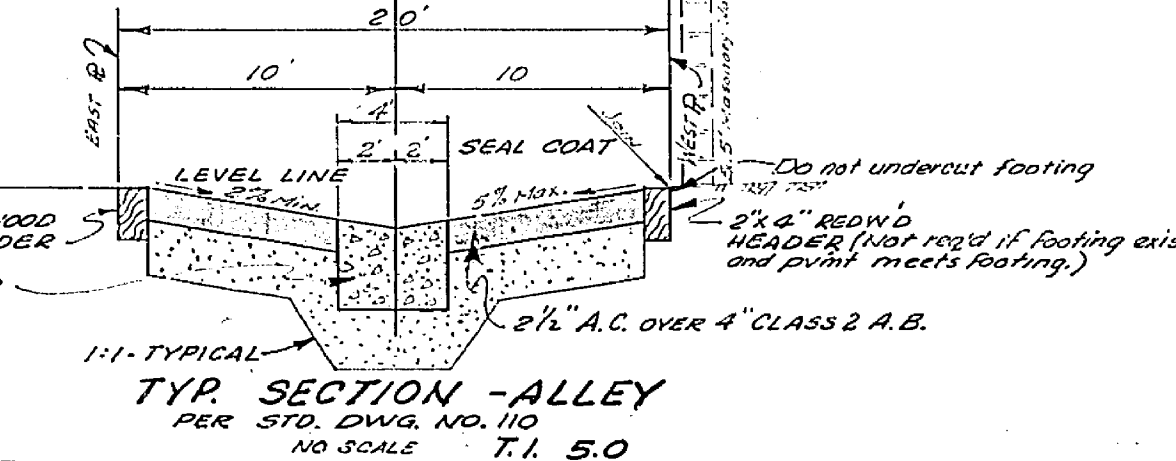
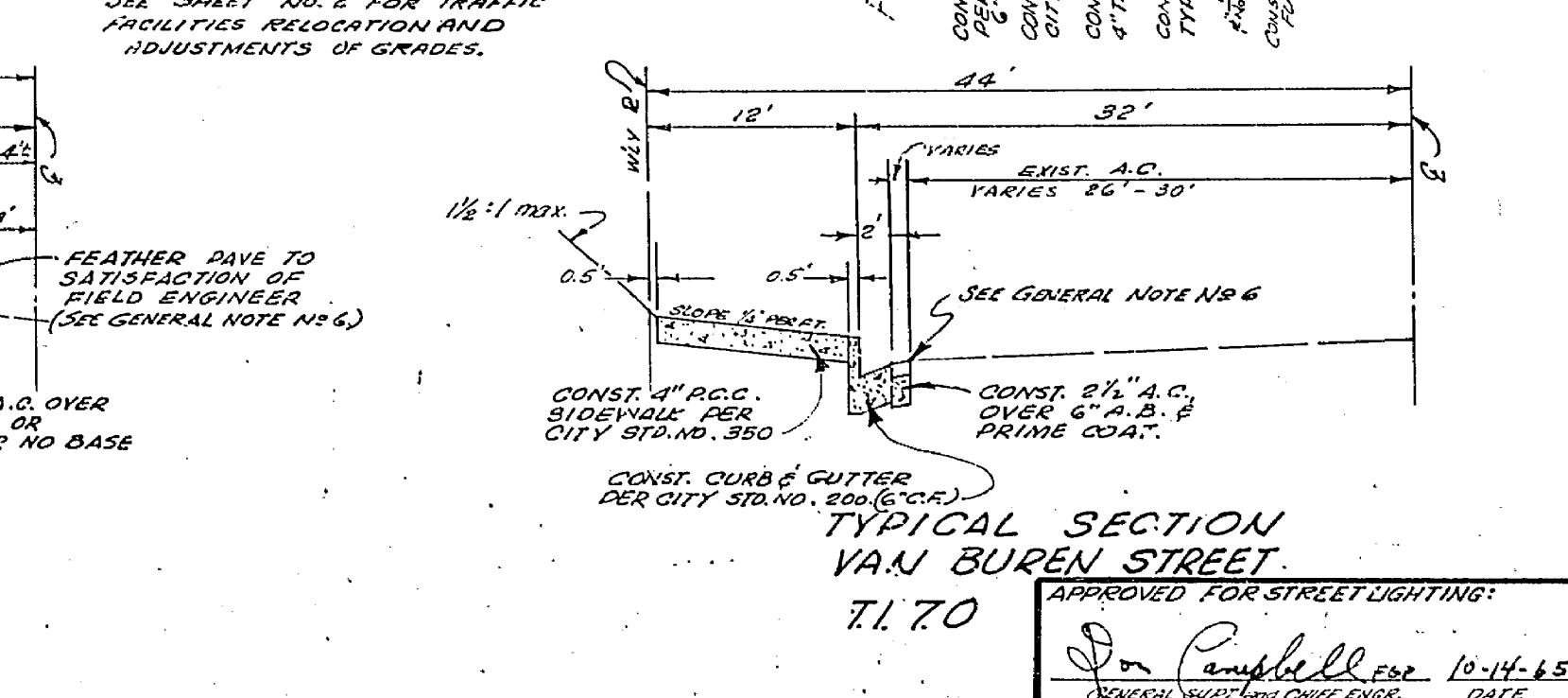
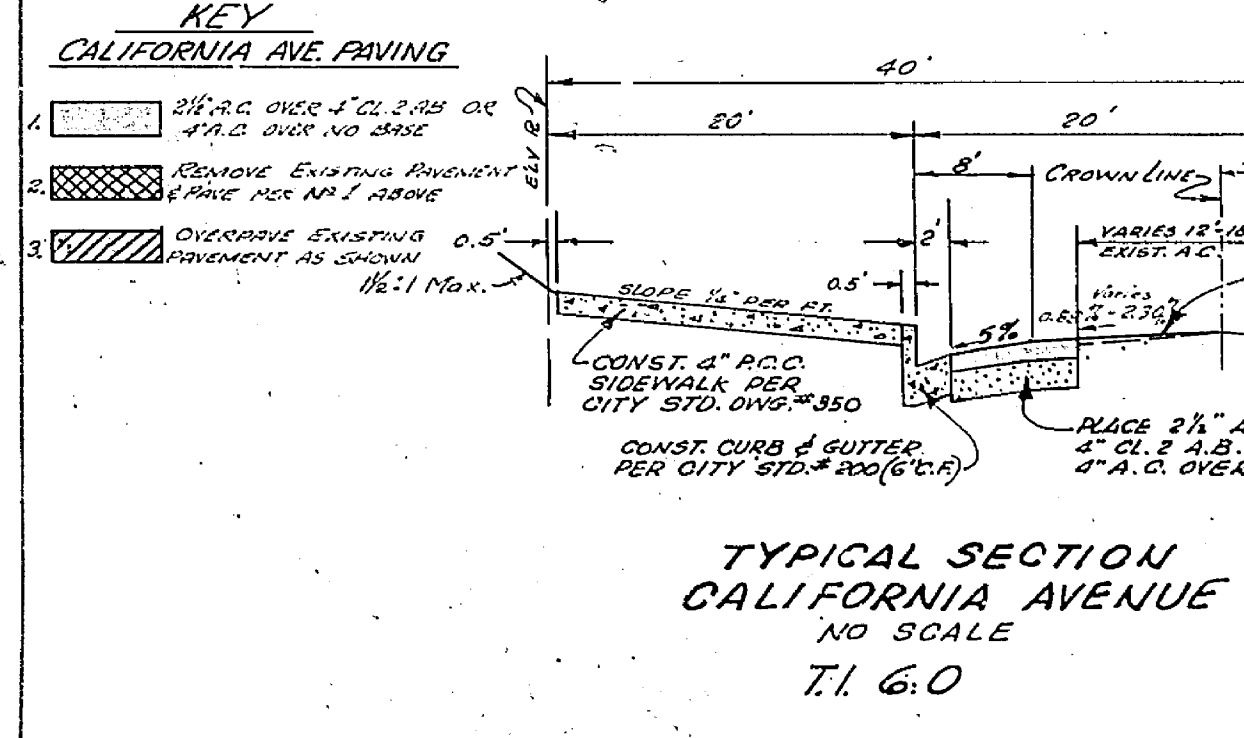

APPROVED FOR STREET LIGHTING:  PETER F. PFEILER - R.C.E. 12507		UNDER THE SUPERVISION OF:  PETER F. PFEILER - R.C.E. 12507		CITY OF RIVERSIDE, CALIFORNIA DEPARTMENT OF PUBLIC WORKS		STREET IMPROVEMENTS AT SOUTHWEST CORNER OF CALIFORNIA AVENUE AND VAN BUREN STREET and ALLEY R/119-645 173 FT TO 193 FT WLY OF VAN BUREN ST.		PROJECT NO. L5-1317 SHEET 1 OF 2 R-1099	
DESIGNED BY: CHS DRAWN BY: CHS CHECKED BY:	REVISIONS NO. DATE	APPROVED BY:  CITY ENGINEER	DATE: 10-21-65	APPROVED BY:  DIRECTOR OF PUBLIC WORKS	DATE: 10-21-65	HORIZ. SCALE: 1"=30' VERT. SCALE: 1"=5'	FILE NO.	0100690 C.H.S.-Jr.	

SCALE 1" = 20'

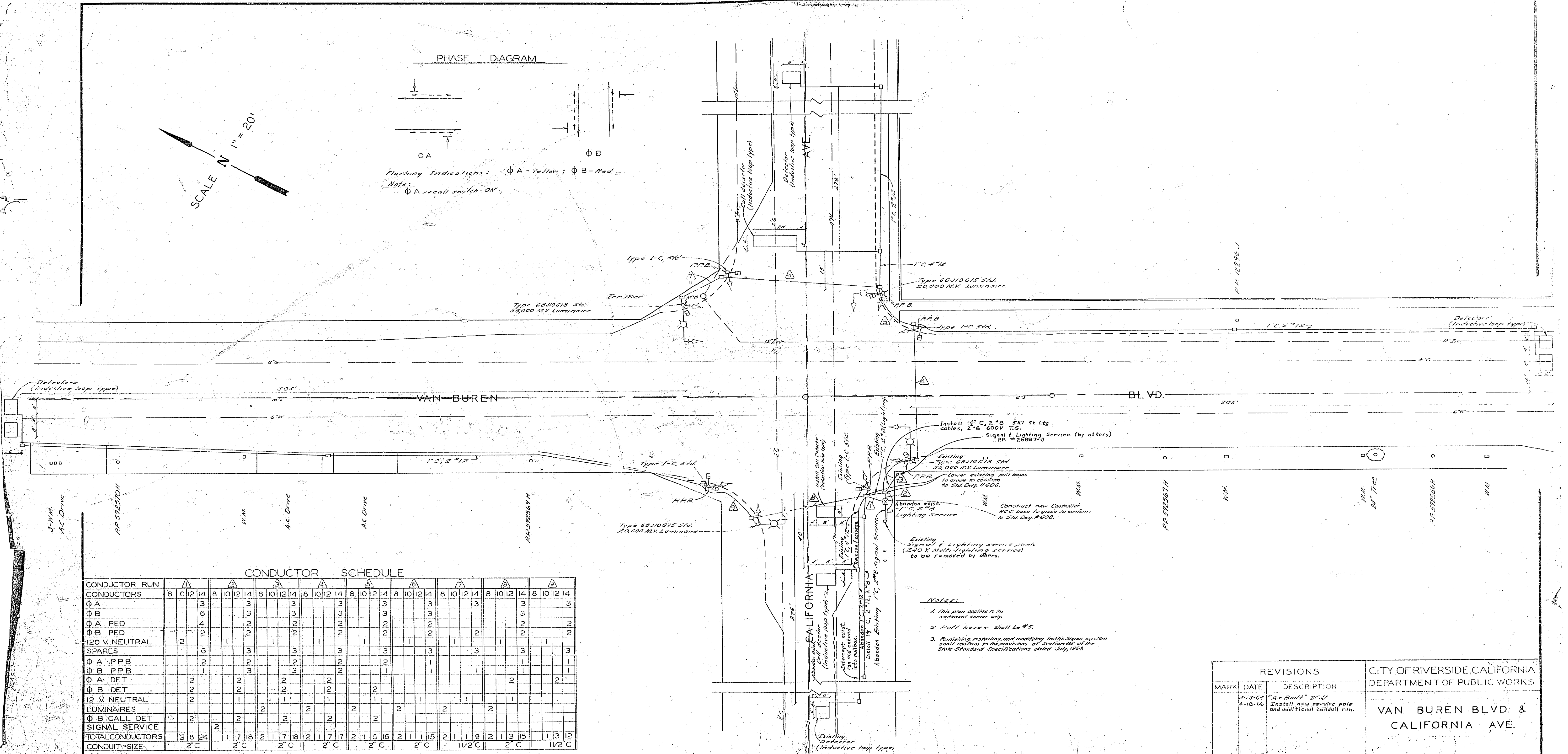
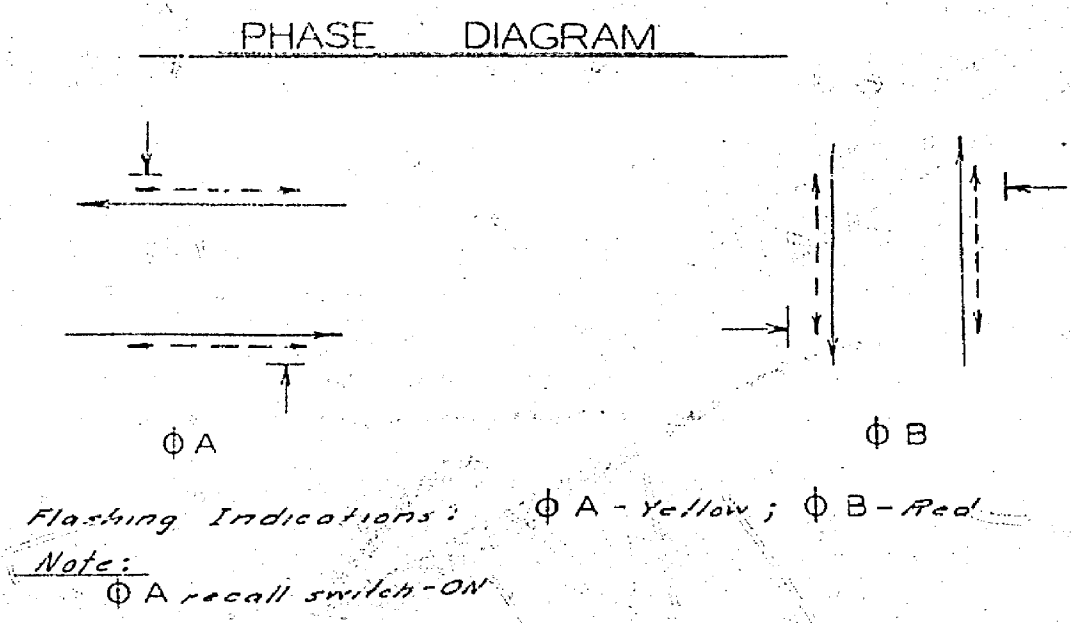

CONDUCTOR SCHEDULE

CONDUCTOR RUN	A		B		C		D		E		F		G		H		I				
CONDUCTORS	8	10	12	14	8	10	12	14	8	10	12	14	8	10	12	14	8	10	12	14	
$\Phi$ A			3				3				3				3				3		
$\Phi$ B			6				6				6				6				6		
$\Phi$ A PED			4				2				2				2				2		
$\Phi$ B PED			2				2				2				2				2		
120 V. NEUTRAL	2				1				1				1				1				
SPARES			6				3				3				3				3		
$\Phi$ A - PPB			2				2				2				2				2		
$\Phi$ B - PPB			1				3				2				1				2		
$\Phi$ A DET	2				2				2				2				2				
$\Phi$ B DET	2				2				2				2				2				
12 V. NEUTRAL	2				1				1				1				1				
LUMINAIRES			2		2		2		2		2		2		2		2		2		
$\Phi$ B CALL DET	2				2				2				2				2				
SIGNAL SERVICE			2				2				2				2				2		
TOTAL CONDUCTORS	2	8	24		1	7	18		2	1	7	17		2	1	5	16	2	1	1	15
CONDUIT SIZE	2" C		2" C		2" C		2" C		2" C		2" C		1 1/2" C		2" C		1 1/2" C				

- Notes:
1. This plan applies to the southwest corner only.
  2. Pull boxes shall be #5.
  3. Remaking, installing, and modifying Traffic Signal system shall conform to the provisions of Section 06 of the State Standard Specifications dated July, 1964.

REVISIONS			CITY OF RIVERSIDE, CALIFORNIA DEPARTMENT OF PUBLIC WORKS	
MARK	DATE	DESCRIPTION		
3-3-64		"As Built" 5/11	VAN BUREN BLVD. & CALIFORNIA AVE.	
4-10-66		Install new service pole and additional conduit run.		
DESIGNED BY			SUBMITTED BY	APPROVED BY
DRAWN BY JKH			PARK DEPT. [Signature]	[Signature]
CHECKED BY [Signature]			DATE 10-20-65	PROJECT NO. R-1099