

SCALE: 1" = 20'
 NORTH SIDE

SCALE: 1" = 20'
 SOUTH SIDE

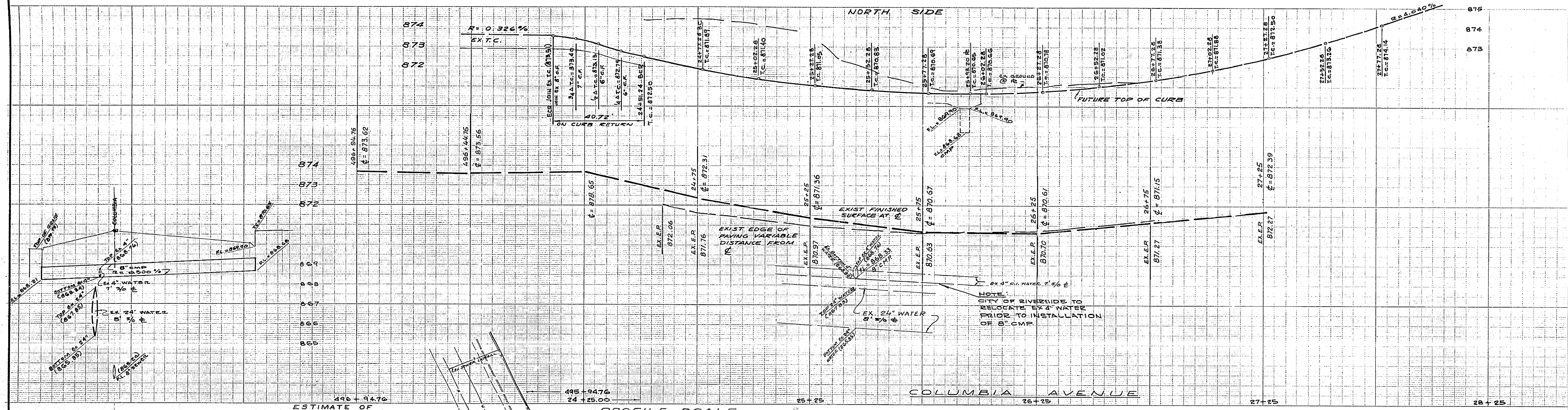

CONSTRUCTION NOTES & ESTIMATE OF QUANTITY

- 1 CONST. CONC. CURB & GUTTER PER STD. DWG. NO. 200 6" C.F. 190. L.F.
- 2 CONST. STD. 4" R.C.C. SIDEWALK PER STD. DWG NO. 32.5 1075. S.F.
- 3 CONST. STD. R.C.C. COM. DRIVE A=25 B=39 PER STD. DWG. NO. 302 1986. S.F.
- 4 CONST. 4" A.C. OVER 10" CLASS B.A.B. W/PRIME CONT. & SEAL COAT OR 2 1/2" A.C. OVER 4" CLASS 2 A.B. OVER 14" CLASS 3. 2852. S.F.
- 5 CONST. STANDARD 6' X 6' TREE WELL PER DEPT. PARKS RECREATION SPECIFICATIONS 2
- 6 INSTALL 8" CMP 16 GA. 95 L.F. ± ASPHALT COATED & INVERT PAVED 95 L.F.
- 7 CONST. STD. CATCH BASIN W=4' V=1.97 FT. NO. 405 1

GENERAL NOTES

1. ALL CONSTRUCTION SHALL BE IN ACCORDANCE W/ STANDARDS AND SPECIFICATIONS NO. 461 OF THE CITY OF RIVERSIDE, DEPARTMENT OF PUBLIC WORKS.
2. THE EXISTENCE AND LOCATION OF ANY UNDERGROUND UTILITY PIPES AND STRUCTURES SHOWN ARE OBTAINED FROM AVAILABLE RECORDS. THE CONTRACTOR IS REQUIRED TO TAKE DUE PRECAUTIONARY MEASURES TO PROTECT THE UTILITY LINES SHOWN AND ANY OTHER UTILITY LINES NOT SHOWN ON THIS PLAN.
3. CHECK WITH STREET LIGHTING ENGINEER FOR STREET LIGHT REQUIREMENTS, PHONE 787-7421, PRIOR TO SIDEWALK CONST.
4. CHECK WITH PARK & RECREATION DEPARTMENT, STREET TREE DIVISION FOR TREE WELL REQUIREMENTS, PHONE 787-7501 PRIOR TO SIDEWALK CONST.
5. IT SHALL BE THE RESPONSIBILITY OF THE CONTRACTOR TO CLEAR THE RIGHT OF WAY IN ACCORDANCE WITH THE PROVISIONS OF LAW AS IT AFFECTS EACH UTILITY INCLUDING IRRIGATION LINES AND APERTANCES AND AT NO COST TO THE CITY.
6. PRIME COAT, SEAL COAT, AND PAINT BINDER ARE REQUIRED.
7. GRADING WILL REQUIRE A PERMIT UNDER ORDINANCE 3093 FOR A CUT OR FILL EXCEEDING 100 CUBIC YARDS, OR A FILL OVER ONE FOOT IN DEPTH.
8. TRIM EDGE OF EXISTING PAVEMENT, WHERE NEW PAVING JOINS EXISTING PAVEMENT TO A CLEAN STRAIGHT LINE. CONSTRUCT MATCH UP PAVING AS SHOWN AND OVERLAY PAVING AS DIRECTED IN THE FIELD TO PRODUCE A SMOOTH CROWN SECTION. ENGINEER ESTIMATES OVERLAY TO BE 0.91 TONS.
9. FOR RELOCATION OF ANY CITY DOMESTIC OR IRRIGATION WATER FACILITY, OR ELECTRIC POWER UTILITY FACILITY TO BE DONE BY CITY FORCE, CONTACT L.P. EASTMAN, WATER COMMERCIAL ENGINEER 787-7441. SCHEDULE ABOUT 2 WEEKS TO PROCESS A WORK ORDER, BEFORE RELOCATION WORK BEGINS.

NOTICE
 CONTACT STATE INSPECTOR AT 869-8511 2 DAYS PRIOR TO CONST. IN STATE B. 25F.
 ENC. PERMIT NO. 866 E 760969 WHICH EXPIRES JUNE 15, 1960

PROFILE SCALE
 HORIZ: 1" = 20' VERT: 1" = 2'

CURB RETURN DATA

Δ = 66° 39' 25"
R = 35.00'
L = 40.72'
T = 23.02'

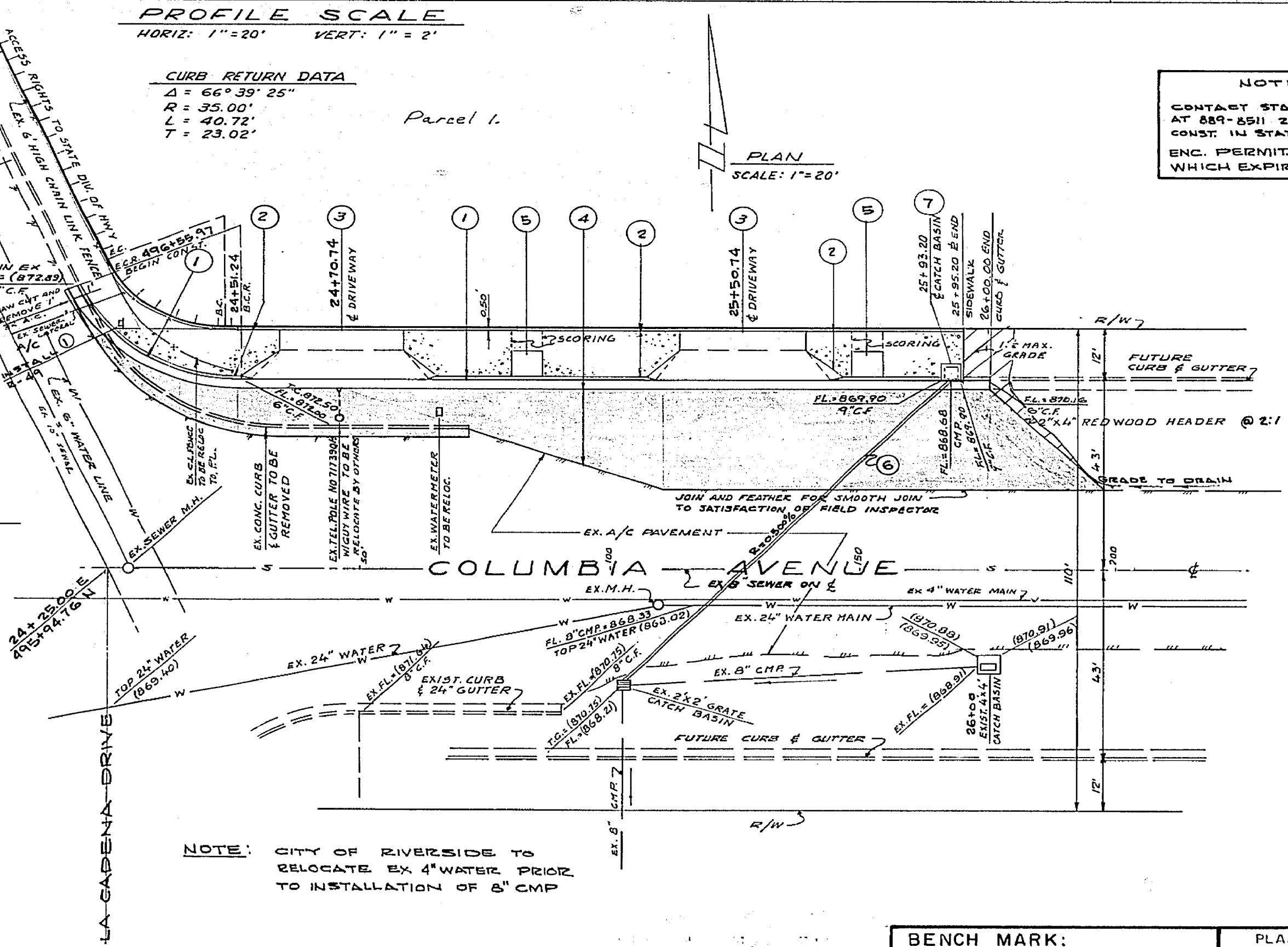
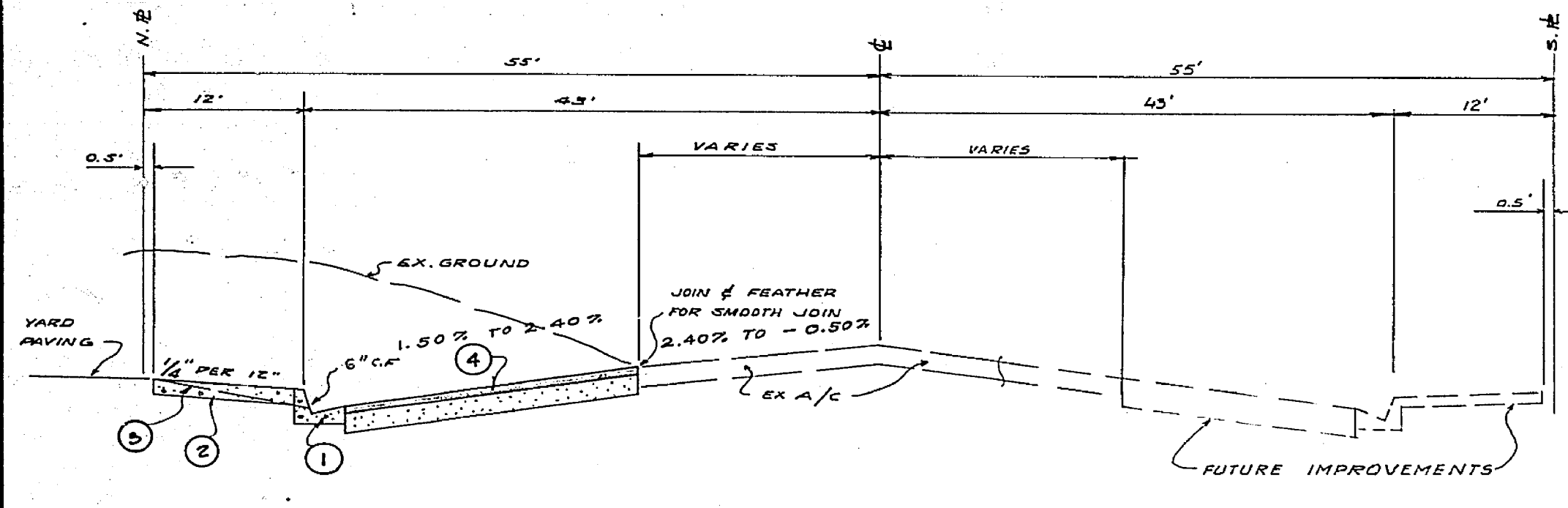

NOTE: CITY OF RIVERSIDE TO RELOCATE EX. 4" WATER PRIOR TO INSTALLATION OF 8" CMP

BENCH MARK:
 S&L 2' W OF S.W. CURB RETURN ON COLUMBIA & MULBERRY
 F.B. 659/17
 ELEV. = 872.426

PLANS PREPARED IN THE OFFICE OF
L.D. LEEPER & ASSOC.
 DESIGNED BY: J.A.K.
 DRAWN BY: J.A.K./N.A.U.
 CHECKED BY: J.B. H. 11/14/59
 SUBMITTED BY: J.A.K.
 PARK DEPT. TRAFFIC DIV.
 RECOMMENDED BY: J.A.K.
 ASSISTANT CITY ENGINEER
 APPROVED BY: J.A.K.
 DIRECTOR OF PUBLIC WORKS
 DATE: 4-8-66
 PROJ. NO. 53300
 R-1122
 SHEET 1 OF 1