

**PROFILE**  
 MADISON STREET  
 SCALE: HORIZ. 1"=30'  
 VERT. 1"=10'

Note: This plan approved for temporary alignment only of Madison Street between Sta. 6+24.37 and Sta. 19+15.36. Alignment subject to ultimate design of Hazardous Blvd., Troutwein Rd., Madison St. and Wood Terrace Way.  
 Date 2-10-54  
 [Signature]  
 Director of Public Works

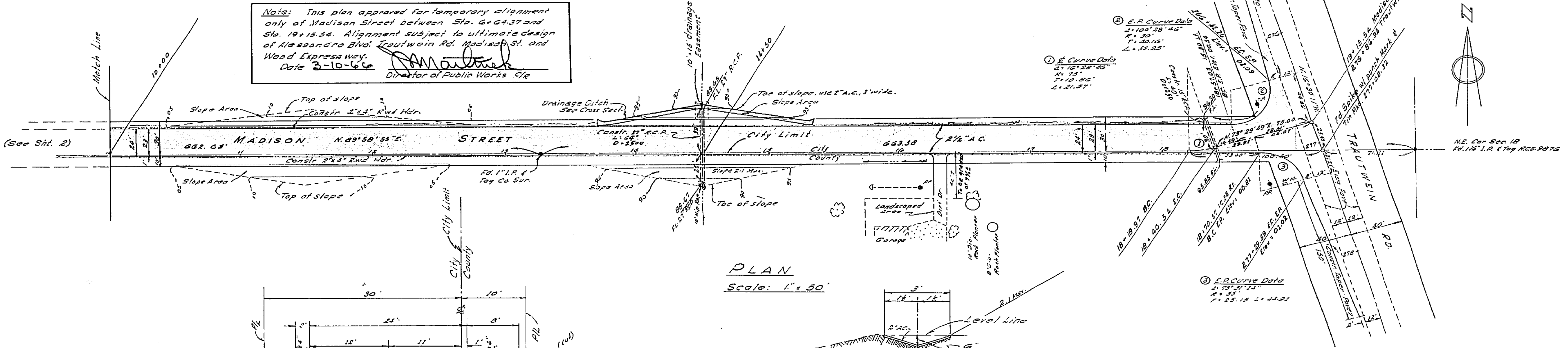

**PLAN**  
 Scale: 1"=50'

- GENERAL NOTES**
- It shall be the responsibility of the contractor to clear the right of way in accordance with the provisions of law as it affects each utility including irrigation lines and appurtenance and no cost to the City.
  - Construction shall be in accordance with the City of Riverside, Department of Public Works, specifications No. 361, and standard Drawings.
  - Prime Coat, Seal Coat, & Patch Binder are required.
  - Grading will require a permit under Ordinance 3033 for a cut or fill exceeding 100 cu. yds. or a fill over one foot in depth.
  - The Developer shall arrange for a test of the soil at the sub-grade level by a soil engineer. Thickness of pavement and thickness and type of aggregate base shall be determined by the soil engineer, and submitted to the City of Riverside for approval.
  - Developer shall furnish and install street name signs and post as per Std. Div. #62, contact Traffic Division for Block Numbers before ordering signs.
  - The finished sub-grade shall have a composition of not less than 90% for a depth of 2.5 feet as determined by test method No. 2017, 216 F immediately prior to placement of the cover.

**QUANTITIES ESTIMATE**  
 Paving: 61,748 sq. ft.  
 Swale: 2,800 sq. ft.  
 2"x4" Rwd. Hdr. 3,131 ft.  
 2 Barricades City Sid. 630 with w.w.e.  
 1 Barricade County Sid. 27  
 Type 2" curb & gutter ca. 570' to 537 ft.  
 1 27" reinforced Concrete Pipe 66 ft.  
 1 30" Reinforced Concrete Pipe 30 ft.  
 1 15" Reinforced Concrete Pipe 40 ft.  
 Base Material 61,748 sq. ft.

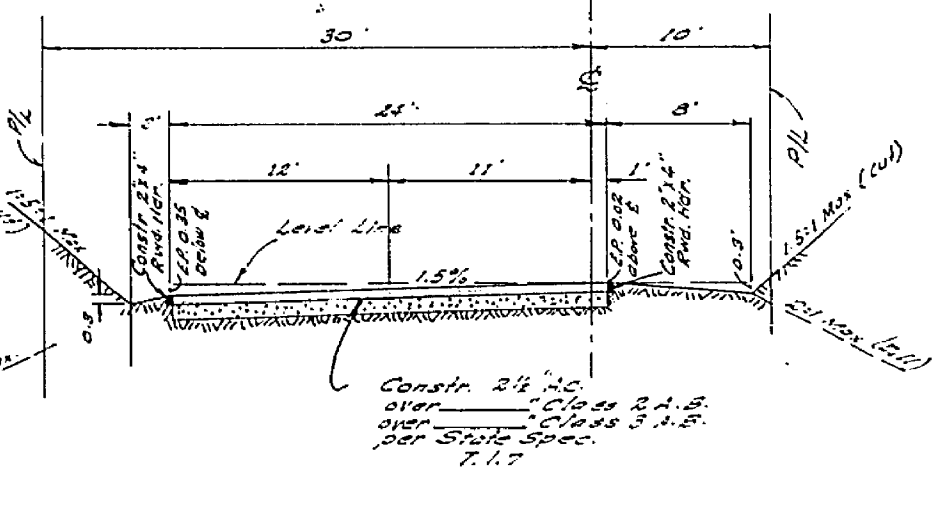

**TYPICAL SECTION**  
 MADISON ST.  
 Sta. 6+24.37 to Sta. 19+15.36  
 Scale: Horiz. 1"=10'  
 Vert. 1"=5'  
 T. J. 7

**TYPICAL SECTION DRAINAGE DITCH**  
 Scale: 1"=5'

Beach Mark  
 Conc. Nail in Rock Outcrop  
 105.2 ft. of Sta. 253+05 of  
 Troutwein Rd. Sta. 1055+41

HUGH M. GALLAHER  
 CIVIL ENGINEER  
 RIVERSIDE, CALIFORNIA  
 Approved by [Signature] Date \_\_\_\_\_  
 R.C.E. No. 7304  
 W.O. E-987 F.B. G-24/54

MARK	REVISIONS	APPR. DATE

CITY OF RIVERSIDE, CALIFORNIA  
 DEPARTMENT OF PUBLIC WORKS  
 APPROVED BY [Signature] DATE 11/10/54  
 OFFICE ENGINEER  
 PARK DEPARTMENT  
 TRAFFIC DIVISION  
 ASSISTANT CITY ENG. [Signature]

**STREET PLAN & PROFILE**  
 MADISON STREET  
 Troutwein to 1,915'± W'ly  
 HORIZ. SCALE: 1"=50' VERT. SCALE 1"=10'

PROJECT NO.  
**R-1127**  
 SHEET 1 OF 2

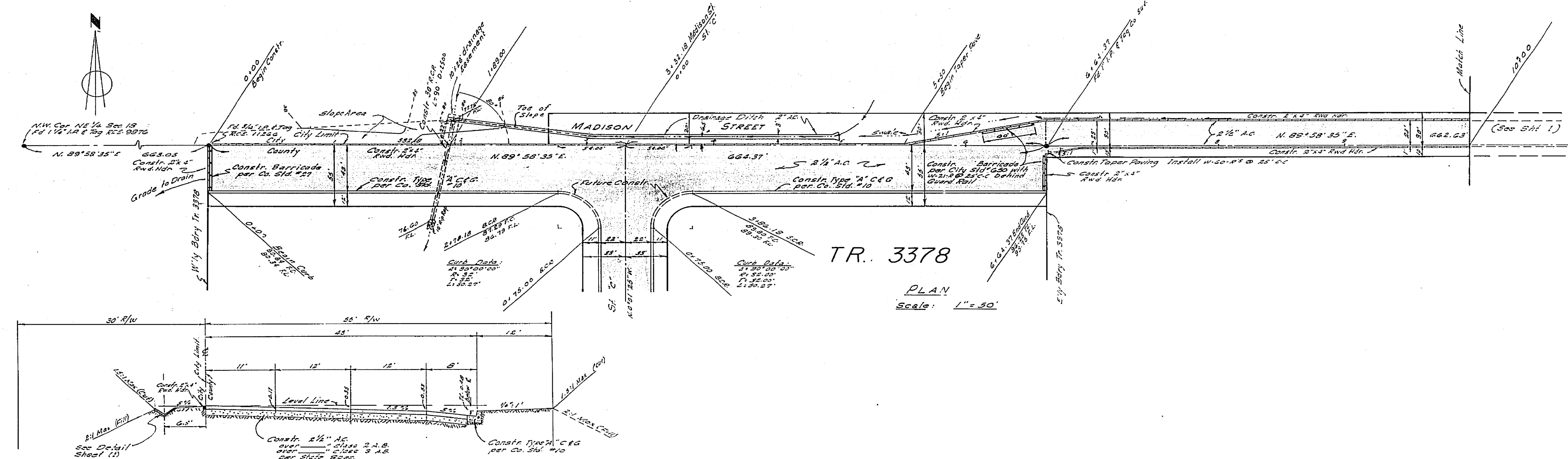
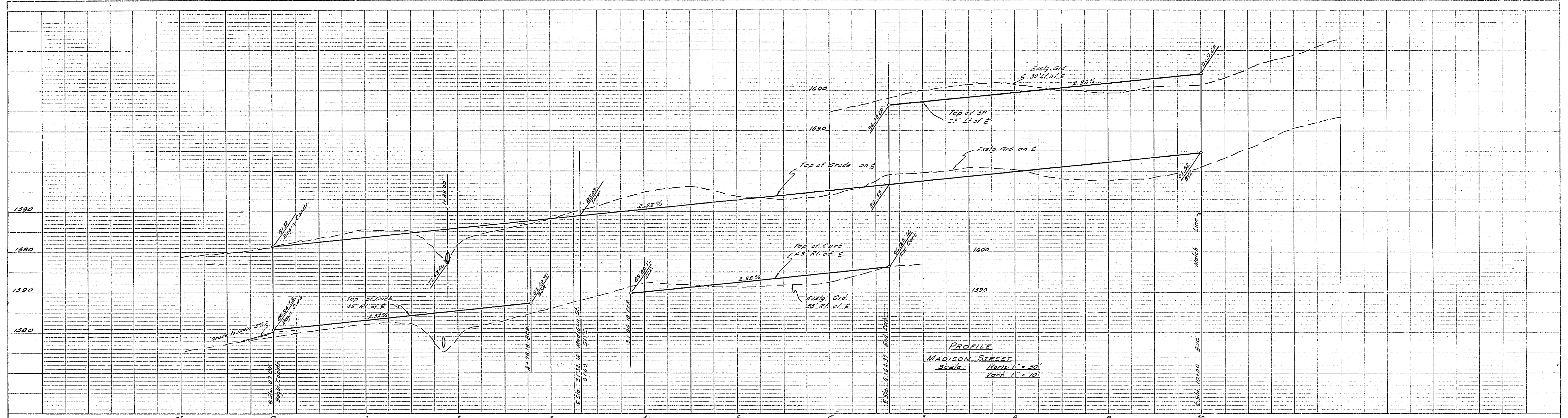

**TYPICAL HALF SECTION  
 MADISON ST.  
 Sta. 0+00 to Sta. 6+64.37  
 Scale: Horiz. 1" = 10' Vert. 1" = 5'  
 T.I. = 7**

**Bench Mark:** Conc. Nail in Rock Outcrop  
 155' ± E.I. of Sta. 263+86 of  
 Troutwein Rd. Elev. 1633.47

<b>HUGH M. GALLAHER</b> CIVIL ENGINEER RIVERSIDE, CALIFORNIA Approved by <i>[Signature]</i> Date _____ R.C.E. No. 7304 W.O. E-987	CITY OF RIVERSIDE, CALIFORNIA DEPARTMENT OF PUBLIC WORKS APPROVED BY _____ BY: _____ DATE: 3-10-66 OFFICE ENGINEER PARK DEPARTMENT TRAFFIC DIVISION ASSISTANT CITY ENGINEER DATE 3-10-66	<b>STREET PLAN &amp; PROFILE                  MADISON STREET                  Troutwein to 1,915' ± W'y</b> APPROVED BY <i>[Signature]</i> DATE: 3-10-66 DIRECTOR OF PUBLIC WORKS	PROJECT NO. <b>R-1127</b>
			SHEET <b>2</b> OF <b>2</b> HORIZ. SCALE: 1" = 50' VERT. SCALE 1" = 10'