

- GENERAL NOTES**
1. It shall be the responsibility of the contractor to clear the right-of-way in accordance with the provisions of law as it affects each utility, including irrigation lines and appurtenances, and also east to the City.
  2. Construction shall be in accordance with the City of Riverside, Dept. of Public Works, Specifications No. 401 and Standard Drawings.
  3. Prime Coat, Seal Coat, and Bitum Binder are required.
  4. Grading will require a permit under Ordinance 3093 for a cut exceeding 100 cubic yards, or a fill over one foot in depth.
  5. The amount of asphalt overlay on existing pavement has been asphaltered by the Engineer to be approximately 2.0 feet.
  6. Trim edge of existing pavement, where new paving joins existing pavement, to a clean, straight line. Construct match-up paving as shown and overlay paving as directed in the field to produce a smooth crown section.
  7. Driveways to be located in the field and constructed per Riv. City Std. 302.
  8. Curb and Gutter to be "Blus Topped" every ten feet.
  9. **BENCH MARKS** - AK nail in lead on top of Ely end of culvert wing wall on Sly side of Dufferin St. at Grace St. Elev. 985.04.
  10. For relocation of any City domestic or irrigation water facility, or electric power utility facility to be done by City forces, contact L.R. Eastman, Water Commercial Engineer at 787-7441. Schedule about two weeks to process a work order, before relocation work begins.

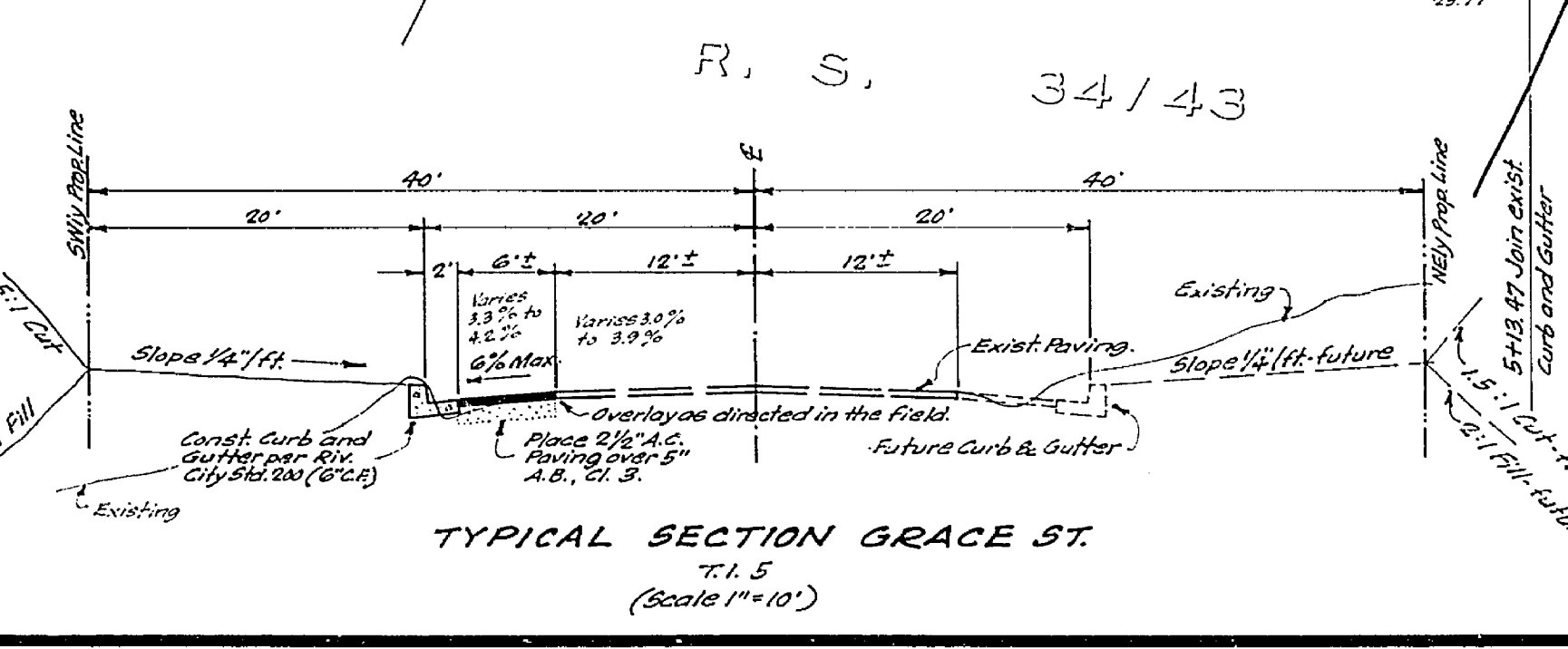
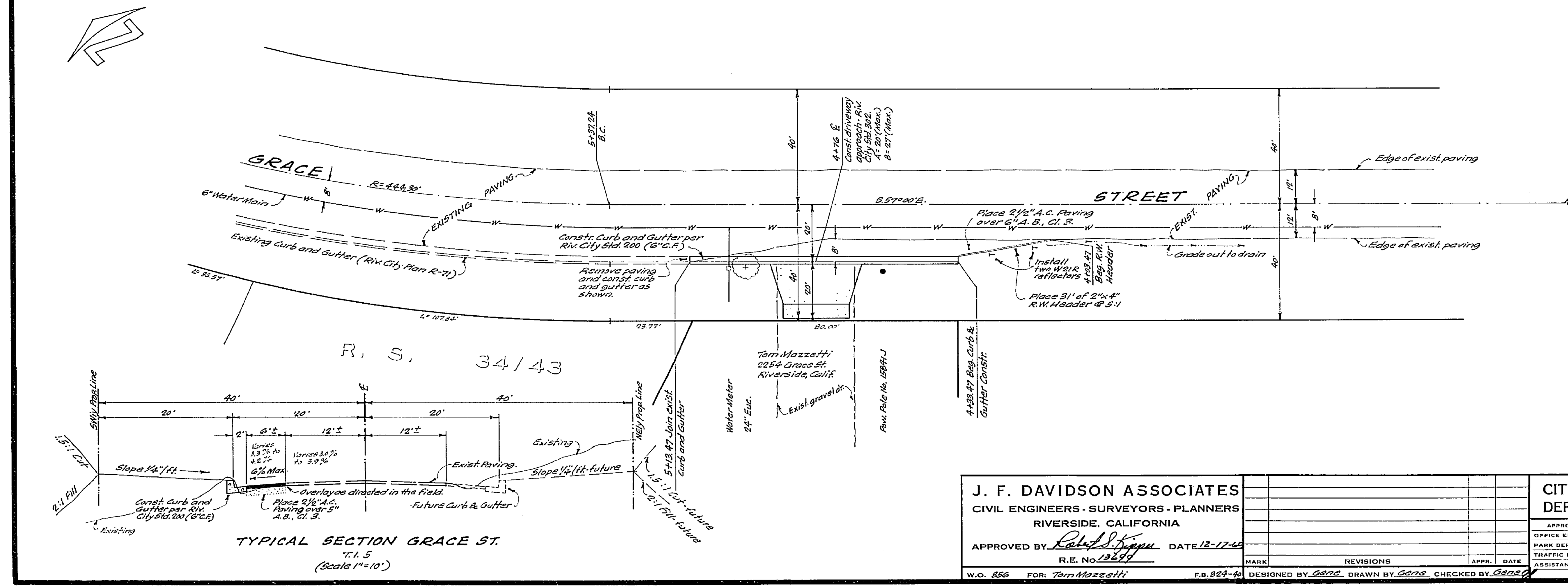

**J. F. DAVIDSON ASSOCIATES**  
 CIVIL ENGINEERS - SURVEYORS - PLANNERS  
 RIVERSIDE, CALIFORNIA  
 APPROVED BY: *Tom Mazzetti* DATE: 12-17-66  
 R.E. No. 12257

**CITY OF RIVERSIDE, CALIFORNIA**  
 DEPARTMENT OF PUBLIC WORKS  
 APPROVED BY: *Tom Mazzetti* DATE: 2-17-66  
 ASSISTANT CITY ENGINEER

**STREET PLAN AND PROFILE**  
**GRACE STREET**  
 Southwesterly side 450' ± Northwesterly of Dufferin Street.  
**Building Permit 2254 Grace St.**  
 HORIZ. SCALE: 1" = 20' VERT. SCALE: 1" = 5'

PROJECT NO. **R-1134**  
 SHEET **1** OF **1**  
 FILE NO. **3323**

W.D. 856 FOR: Tom Mazzetti F.B. 824-40 DESIGNED BY: GENE DRAWN BY: GENE CHECKED BY: GENE