

CITY B.M.
ON N.W. CORNER BETWEEN STOVES
& BELLAVILLE AVENUE ELY 802.66
F.B. 704.137

GENERAL NOTES

- IT SHALL BE THE RESPONSIBILITY OF THE CONTRACTOR TO CLEAR THE RIGHT OF WAY IN ACCORDANCE WITH THE PROVISIONS OF LAW 45 IT AFFECTS EACH UTILITY INCLUDING RELOCATION LINES AND SUPPORTS AT HIS COST TO THE CITY.
- CONSTRUCTION SHALL BE IN ACCORDANCE WITH THE CITY OF RIVERSIDE DEPARTMENT OF PUBLIC WORKS, SPECIFICATIONS NO. 461 AND STANDARD DRAWINGS.
- PRIME COAT, SEAL COAT, AND PAINT BINDER ARE REQUIRED.
- GRADING WILL REQUIRE A PERMIT UNDER ORDINANCE 3093 FOR A CUT OR FILL EXCEEDING 100 CUBIC YARDS, OR A FILL OVER ONE FOOT IN DEPTH.
- TRIM EDGE OF EXISTING PAVEMENT WHERE NEW PAVING JOINS EXISTING PAVEMENT, TO A SMOOTH TRIM LINE, CONSTRUCT INTERMEDIATE FINISH AS SHOWN AND OVERLAY PAVING AS DESIRED IN THE FIELD TO PRODUCE A SMOOTH GRADUAL SECTION. THE AMOUNT OF ASPHALT OVERLAY ON EXISTING PAVEMENT HAS BEEN ESTIMATED BY THE ENGINEER TO BE APPROXIMATELY 2.0 INCHES.
- RELOCATION OF ANY CITY DEPARTMENT'S UTILIZATION WATER FACILITY, OR ELECTRIC POWER UTILITY FACILITY TO BE DONE BY CITY FORCE, CONTACT L. R. EASTMAN, WATER/COMMERCIAL ENGINEER AT 787-1441.
- CONTACT STREET LIGHT ENGINEER AT 787-7488 FOR STREET LIGHT REQUIREMENTS AND PARALLEL CURB LIGHT AT 787-7801 FOR STREET TREE REQUIREMENTS PRIOR TO SIDEWALK CONSTRUCTION.

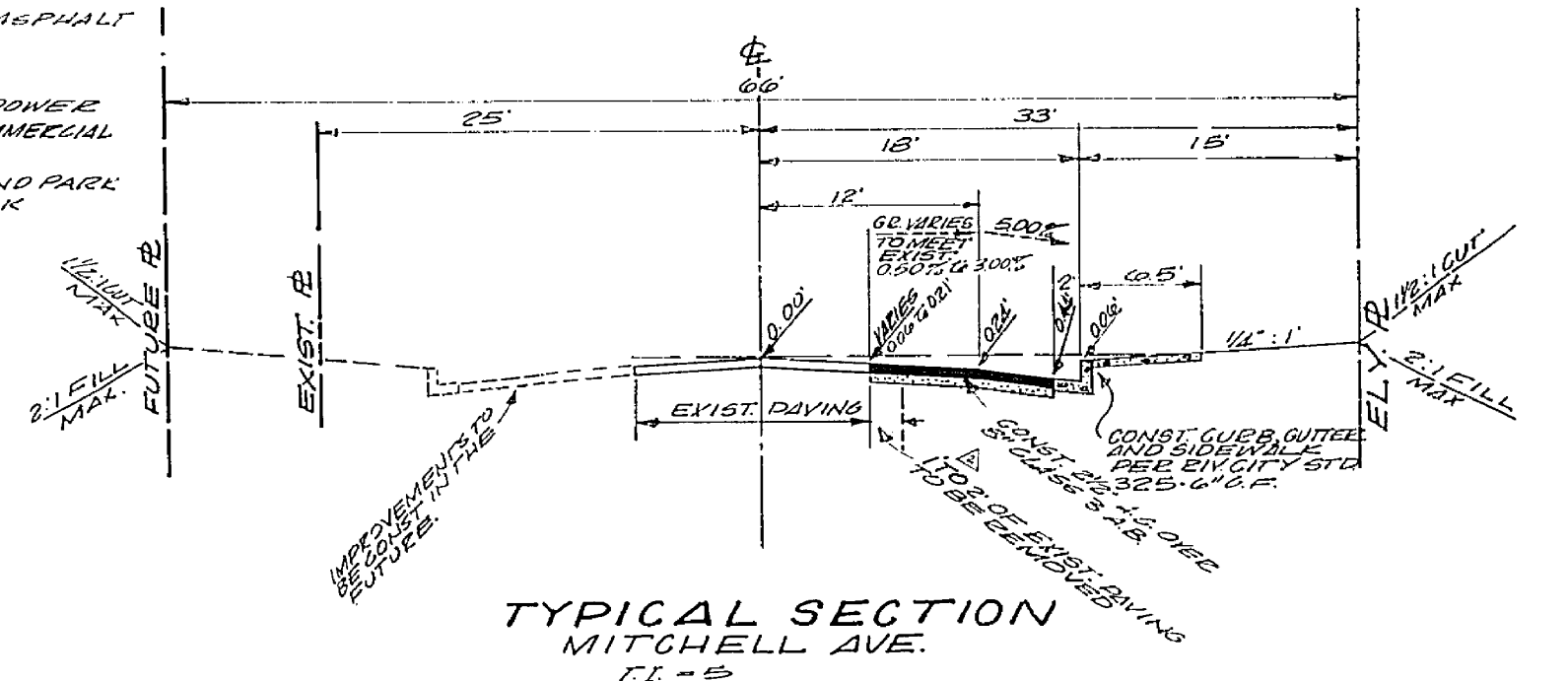
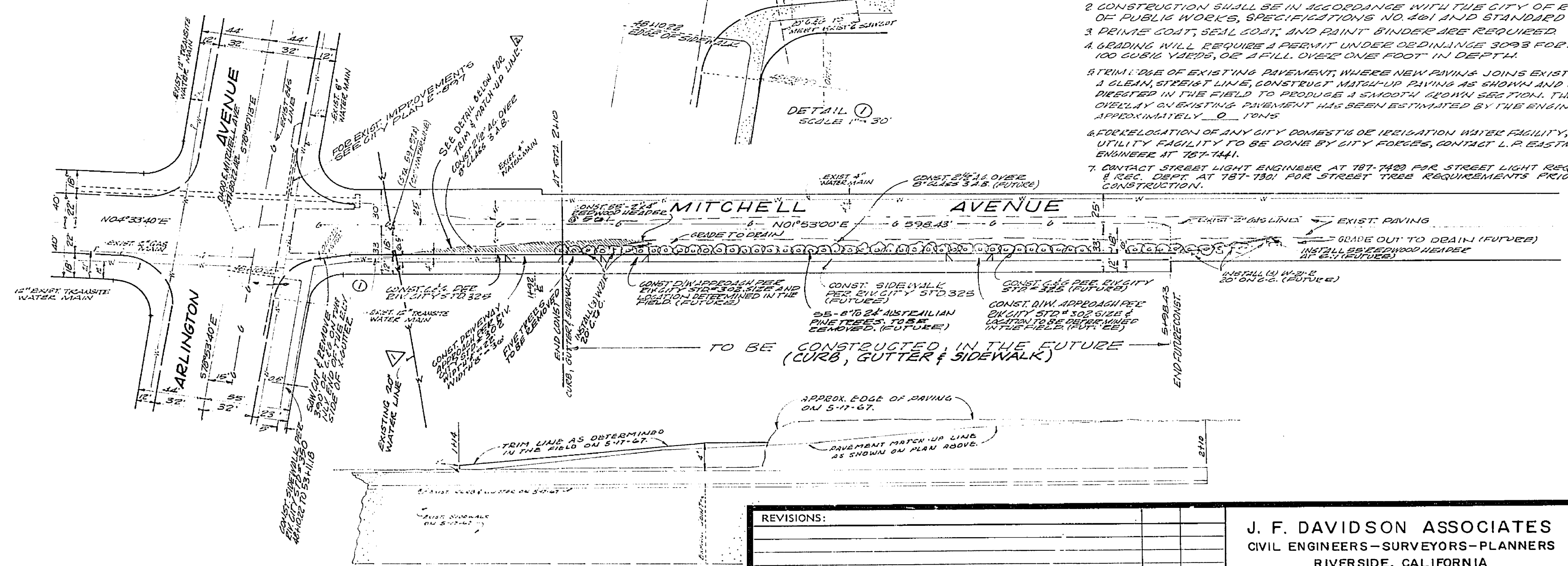

REVISIONS:	
1	INDICATE PAVEMENT TRIM LINE ON 5-11-67
2	ADDED WATER LINE PER DIV. 117-325

J. F. DAVIDSON ASSOCIATES
CIVIL ENGINEERS-SURVEYORS-PLANNERS
RIVERSIDE, CALIFORNIA

APPROVED BY: *Robert L. Davidson* DATE: 4-15-66
R.E. NO. 1153

CITY OF RIVERSIDE, CALIFORNIA
DEPARTMENT OF PUBLIC WORKS

APPROVED BY: *W. J. ...* DATE: 6-21-66
DIRECTOR OF PUBLIC WORKS

STREET PLAN & PROFILE
MITCHELL AVENUE
N.W. OF ARLINGTON AVE

C-27-650

PROJECT NO. **R-1153**

SHEET **1** OF **2**

FILE NO. **3320**

DETAIL - Δ
Showing paving removal & replacement with trim line as determined in the field. See plan.

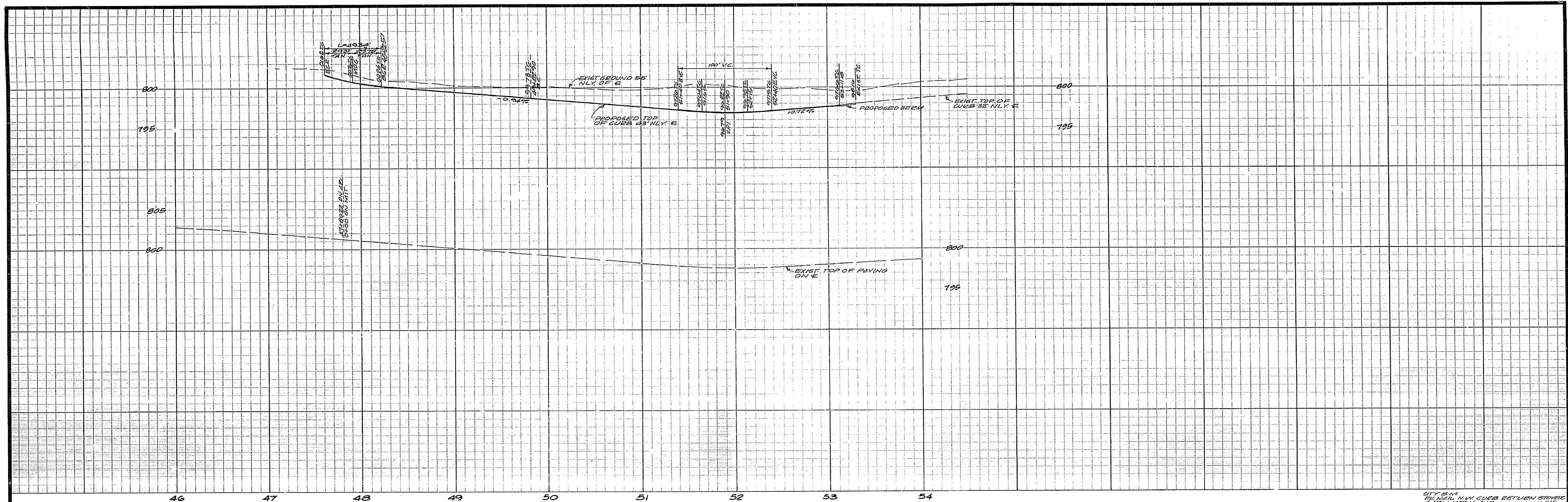

CITY PLAN N.W. CURB BETWEEN STREETS
 8. ARLINGTON AVE. ELEV. 800.916
 R.S. 10437

GENERAL NOTES

1. IT SHALL BE THE RESPONSIBILITY OF THE CONTRACTOR TO CLEAR THE RIGHT OF WAY IN ACCORDANCE WITH THE PROVISIONS OF LAW AS IT AFFECTS EACH UTILITY INCLUDING IRRIGATION LINES AND APPURTENANCES AT NO COST TO THE CITY.
 2. CONSTRUCTION SHALL BE IN ACCORDANCE WITH THE CITY OF RIVERSIDE, DEPARTMENT OF PUBLIC WORKS, SPECIFICATIONS NO. 461 AND STANDARD DRAWINGS.
 3. PRIME COAT, SEAL COAT, AND PAINT BINDER ARE REQUIRED.
 4. GRADING WILL REQUIRE A PERMIT UNDER ORDINANCE 3093 FOR A CUT OR FILL EXCEEDING 100 CUBIC YARDS, OR A FILL OVER ONE FOOT IN DEPTH.
5. STEEP EDGE OF EXISTING PAVEMENT, WHERE NEW PAVING JOINS EXISTING DRIVEWAYS, TO ADEQUATE STRAIGHT LINE, CONSTRUCT MATCH-UP PAVING AS SHOWN AND OVERLAY PAVING AS DIRECTED IN THE FIELD TO PRODUCE A SMOOTH CROWN SECTION.

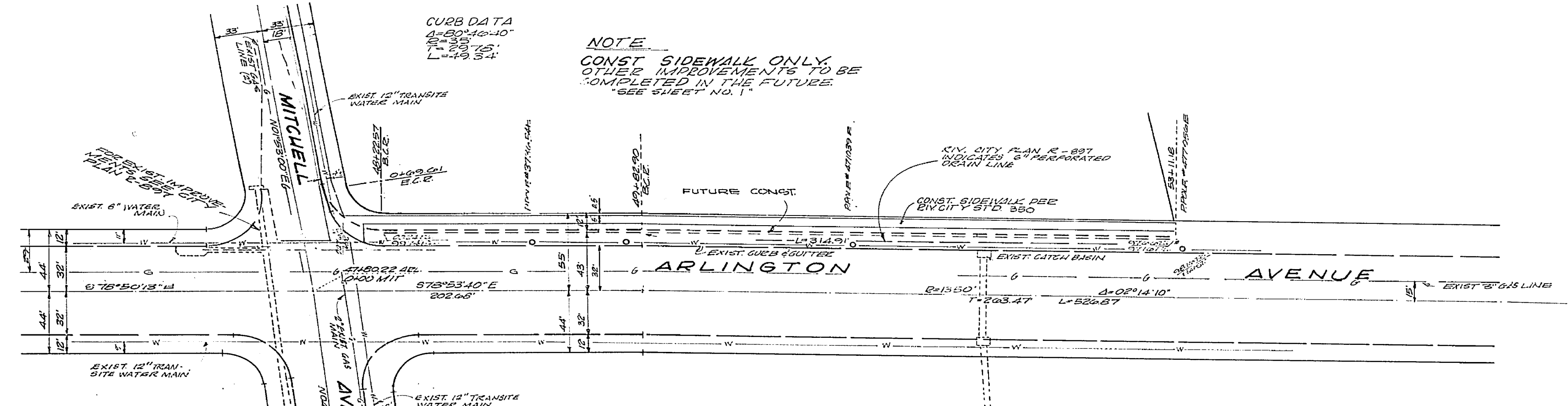
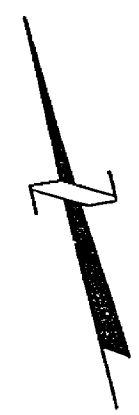

CURB DATA
 4'-00" x 10'-00"
 1" x 20" x 15"
 L=49.5'-4"

NOTE
 CONST. SIDEWALK ONLY,
 OTHER IMPROVEMENTS TO BE
 COMPLETED IN THE FUTURE.
 SEE SHEET NO. 1

**TYPICAL SECTION
 ARLINGTON AVE.**
 SCALE: 1" = 10'-0"

NO.	DESCRIPTION	DATE

J. F. DAVIDSON ASSOCIATES
 CIVIL ENGINEERS - SURVEYORS - PLANNERS
 RIVERSIDE, CALIFORNIA

APPROVED BY: *Robert J. Kyger* DATE: 5-22-66
 R.E. NO. 13246

CITY OF RIVERSIDE, CALIFORNIA
 DEPARTMENT OF PUBLIC WORKS

APPROVED BY: *[Signature]* DATE: 6-21-66
 DIRECTOR OF PUBLIC WORKS

**STREET PLAN & PROFILE
 ARLINGTON AVENUE**

C-27-656
 W.O. 575 FOR: ALVORD SCH. DIST. F.B. 867

PROJECT NO.
R-1153

SHEET **2** OF **2**

FILE NO. **3320**