

PROFILE "T" ALLEY
SCALE: 1/4" = 20' VERT.

PROFILE ALLEY
SCALE: 1/4" = 20' VERT.

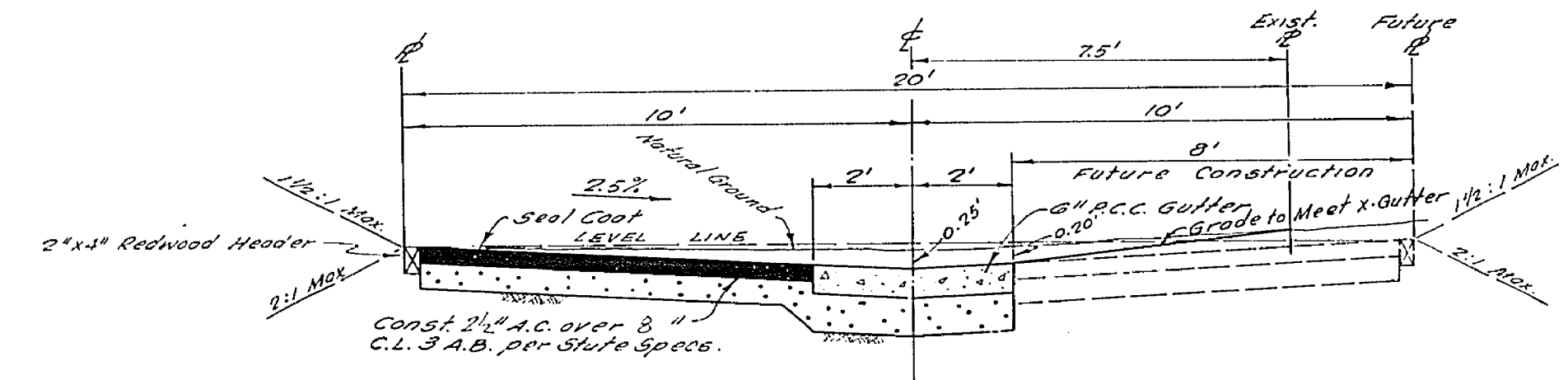
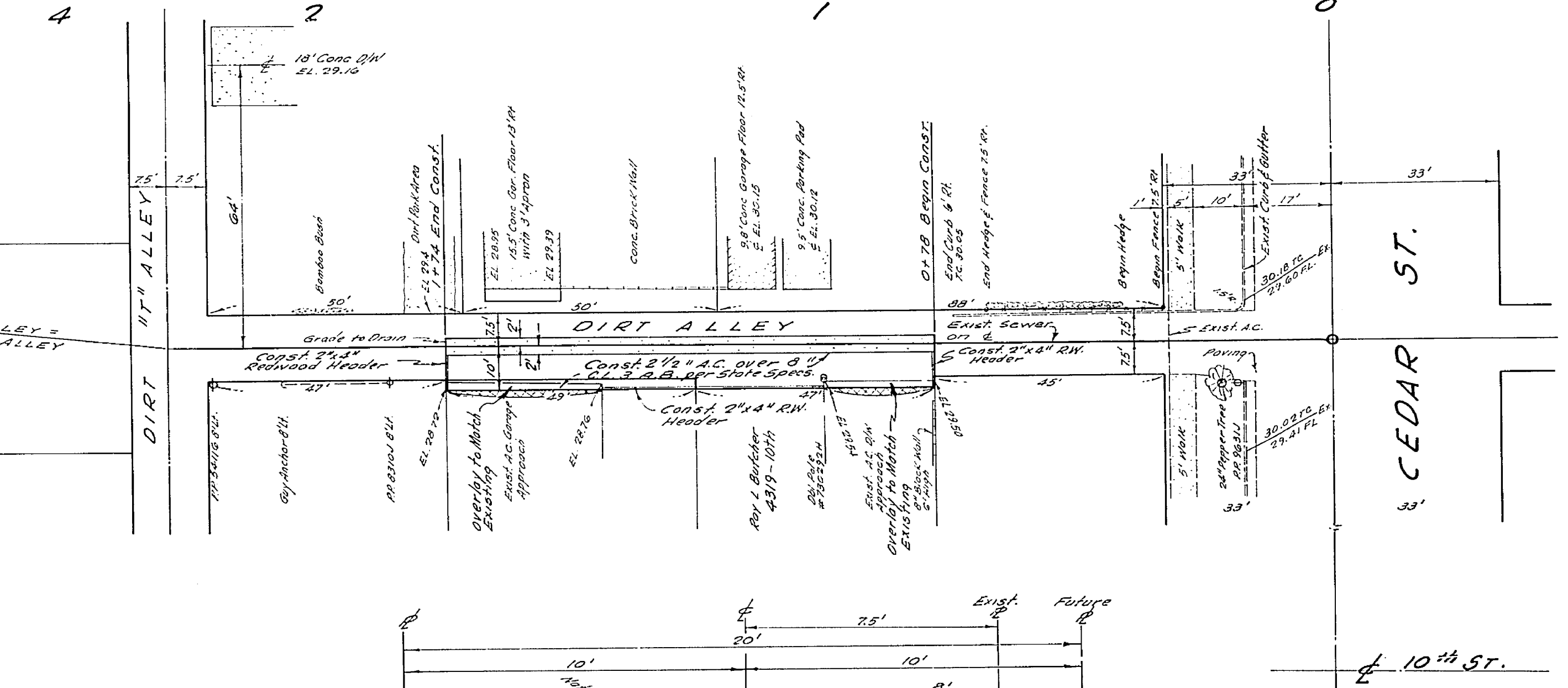
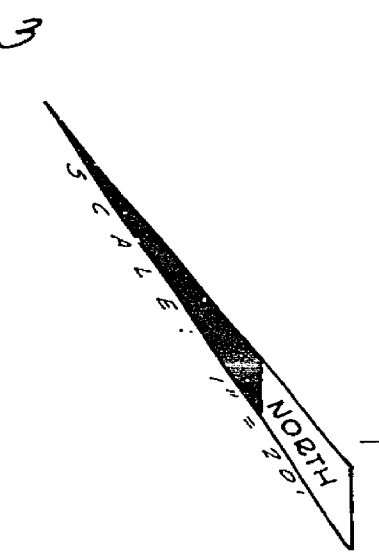

TYPICAL SECTION (SEE STD. No. 110)
STA. 0+78 TO STA. 1+74
- NOT TO SCALE -

GENERAL NOTES

1. It shall be the responsibility of the contractor to clear the right of way in accordance with the provisions of law as it affects each utility including irrigation lines and appurtenances and at no cost to the city.
2. Construction shall be in accordance with the city of Riverside, Department of Public Works, Specifications No. 461 and Std. Draw'g's.
3. Prime coat, seal coat and paint binder are required.
4. Grading will require a permit under Ordinance 3093 for a cut or a fill exceeding 100 cubic yards or a fill over one foot in depth.
5. Trim edge of existing pavement, where new paving joins existing pavement, to a clean straight line. Construct match-up paving as shown and overlay as directed in the field to produce a smooth crown section.
6. The finished subgrade shall have a compaction of not less than 90% for a depth of 0.5' foot as determined by test method No. California 216 immediately prior to placement of the cover.

BENCH MARK: 5 ft. in N. Corn 7th St.
5' W. of N. line of Cedar Street, E. 18997

CRAWLEY, HAWKINS & HIEBER ENGINEERS & SURVEYORS RIVERSIDE, CALIFORNIA Approved: <i>George A. Hieber</i> Date: 3/16/66 R.S. 14407 J.O. 506 Field No. 78/72	REVISIONS DESIGNED BY: _____ DRAWN BY: _____ CHECKED BY: _____ APPR. DATE: _____	CITY OF RIVERSIDE, CALIFORNIA DEPARTMENT OF PUBLIC WORKS APPROVED BY: _____ OFFICE ENGINEER PARK DEPARTMENT TRAFFIC DIVISION ASSISTANT CITY ENG.	ALLEY PLAN & PROFILE BETWEEN 9th and 10th STREETS 4319-10th ST., WESTERLY OF CEDAR STREET BUILDING PERMIT DATE: 6-1-66 HORIZ. SCALE: 1" = 20' VERT. SCALE: 1" = 4'	PROJECT NO. R-1154 SHEET 1 OF 1 FILE NO. 4097
		APPROVED BY: _____ DIRECTOR OF PUBLIC WORKS DATE: 6-1-66	HORIZ. SCALE: 1" = 20' VERT. SCALE: 1" = 4'	FILE NO. 4097