

- STREET LIGHT NOTES**
- All street light standards and pullboxes to be located in the field.
 - All street light standards shall be checked for clearance of driveways and placed 10' from end of curb returns.
 - See City of Riverside Drawing No. L1-13008, and L1-13011 for light standard details and Drawing No. L1-13003 for pullbox details.
 - All cable to be AWG No. 8 copper.
 - This is a two wire 240 volt multiple system.
 - All construction to comply with City of Riverside Street Light Specifications.
 - Inspection to be called for as outlined in specifications.
 - Feed point to be confirmed at time of construction.
 - Person connection fee to be paid. (date paid)
 - Person inspection fee to be paid. (date paid)
 - The City of Riverside Traffic Engineering Division will pay \$25.00 toward the cost of this project to the Developer upon completion of the work and receipt of a statement from the Developer.
 - Excavation for street light standard bases, pullboxes and conduits must be done after installation of curbs and gutters, but before installation of sidewalks.
 - Back fill to be of type and compacted as specified by City of Riverside Public Works Department.
 - Contractor to obtain a street opening permit from City of Riverside Public Works Department before doing any excavation in proposed or dedicated street right of way.

- LEGEND**
- Indicates City of Riverside marbleite light standard No. 4504 with 7000 L, 175 W, Type II, except as noted "Line Material" mercury vapor luminaire with color corrected lamp. Cat. No. LM 44A1 or approved equal.
 - Indicates City of Riverside marbleite light standard No. 68J10 with 20000 L, 200 W, Type III "Line Material" mercury vapor luminaire. Cat. No. LM 53A2 or approved equal.
 - Indicates No. 3 1/2 pullbox "Brooks Products Inc." or approved equal.
 - Indicates 1" rigid galv. steel conduit, except as noted.
 - Indicates feed point.

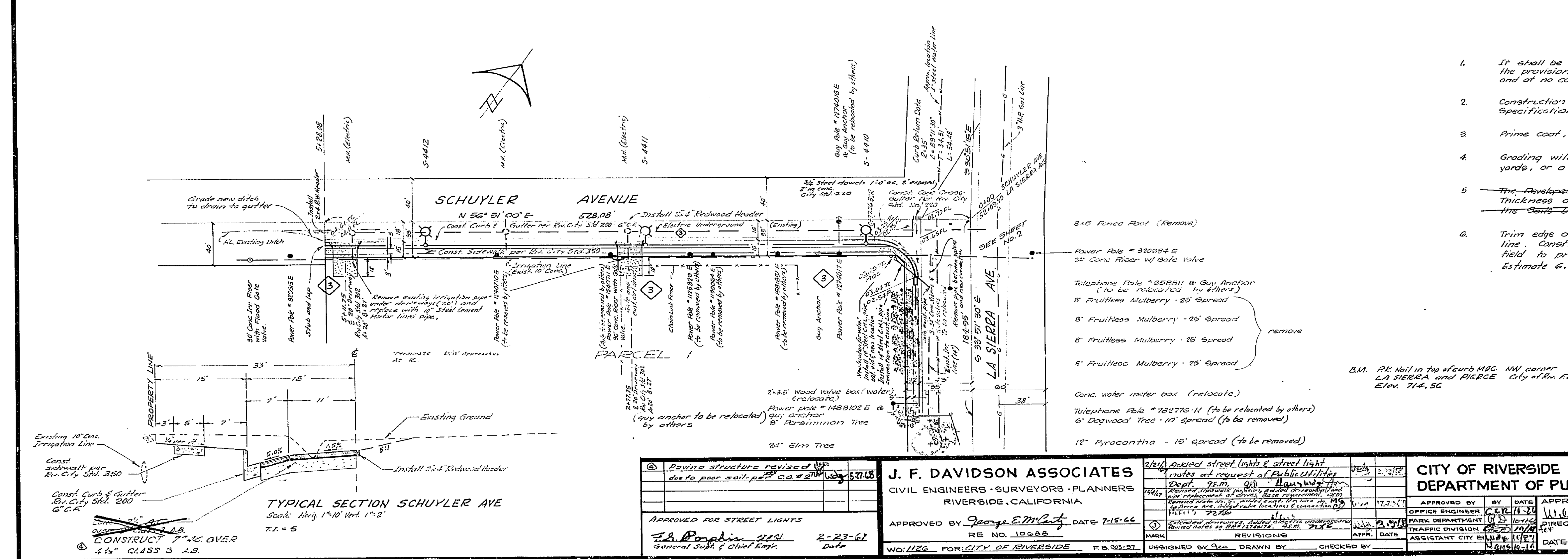

- GENERAL NOTES**
- It shall be the responsibility of the contractor to clear the right of way in accordance with the provisions of law as it affects each utility including irrigation lines and appurtenances and at no cost to the City.
 - Construction shall be in accordance with the City of Riverside Department of Public Works, Specifications No. 441 and Standard Drawings.
 - Prime coat, seal coat, and paint binder are required.
 - Grading will require a permit under Ordinance 9093 for a cut or fill exceeding 100 cu. yards, or a fill over one foot in depth.
 - The Developer shall arrange for a test of the soil of the subgrade level by a geotechnical engineer. Thickness of pavement and thickness and type of aggregate base shall be determined by the geotechnical engineer and submitted to the City of Riverside for approval prior to construction.
 - Trim edge of existing pavement, where new paving joins existing pavement, to a clean, straight line. Construct match-up paving as shown and overlay paving as directed in the field to produce a smooth crown section. Estimate 6.8 tons AC overlay on La Sierra Ave.

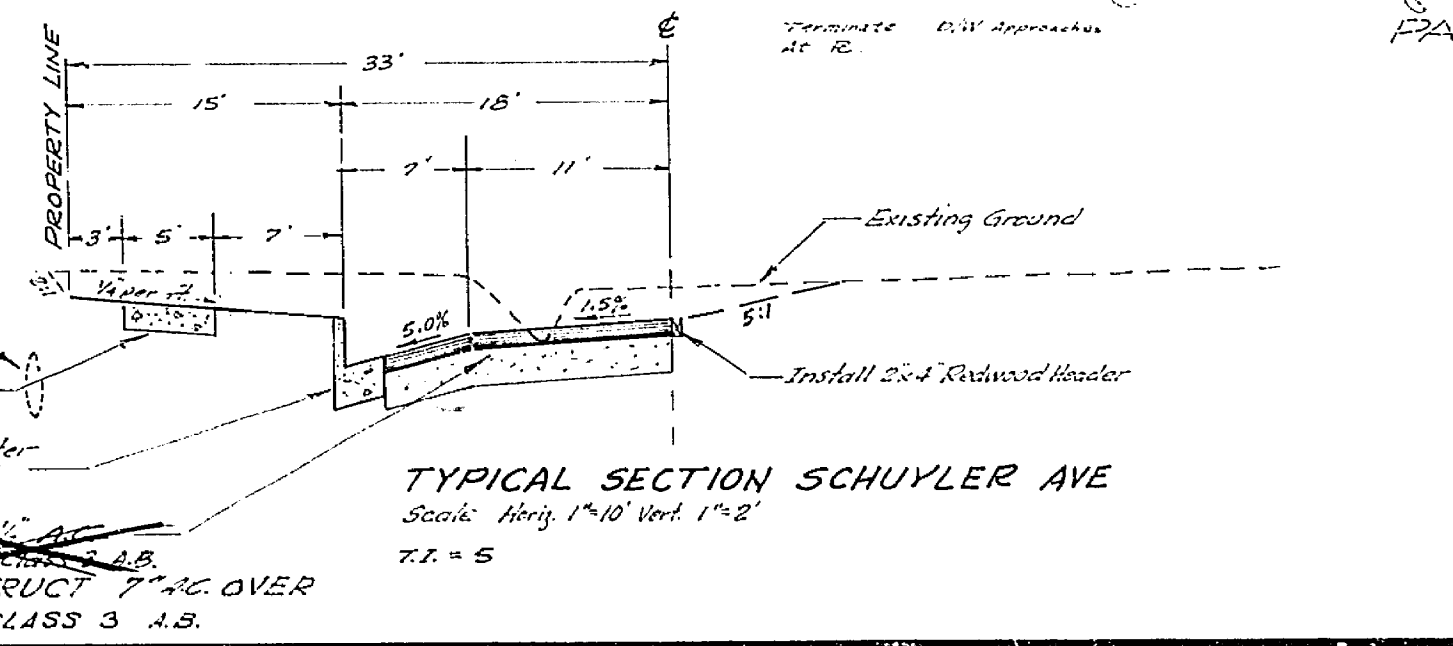

<p>J. F. DAVIDSON ASSOCIATES CIVIL ENGINEERS · SURVEYORS · PLANNERS RIVERSIDE, CALIFORNIA</p> <p>APPROVED FOR STREET LIGHTS <i>E. B. Douglas</i> 11/21/66 General Sub. & Chief Engr. Date</p>		<p>APPROVED BY <i>George E. McCarty</i> DATE 7-15-66 RE NO. 10068</p>		<p>DESIGNED BY <i>Geo.</i> DRAWN BY <i>Geo.</i> CHECKED BY <i>Geo.</i></p>		<p>CITY OF RIVERSIDE CALIFORNIA DEPARTMENT OF PUBLIC WORKS</p> <p>APPROVED BY <i>William S. Davidson</i> DATE 10/27/66 OFFICE ENGINEER PARK DEPARTMENT TRAFFIC DIVISION ASSISTANT CITY ENGINEER</p>		<p>STREET PLAN & PROFILE R.S. NO. 967 SCHUYLER AVENUE (LA SIERRA AVE. TO 528' SWLY OF LA SIERRA AVE.)</p>		<p>PROJECT NO. 55-341 LS-13235 R-1190</p>	
<p>APPROVED FOR STREET LIGHTS <i>E. B. Douglas</i> 11/21/66 General Sub. & Chief Engr. Date</p>						<p>REVISIONS</p>		<p>DATE 10/27/66</p>		<p>SHEET 1 OF 2 FILE NO. 3334</p>	

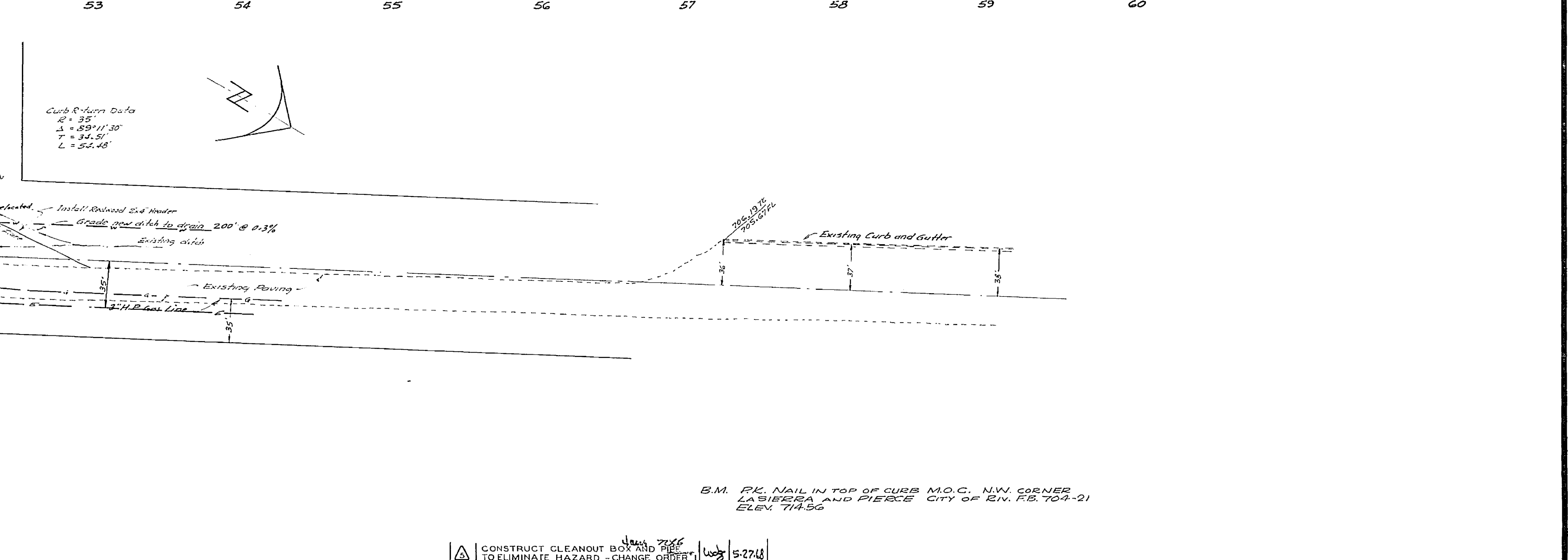
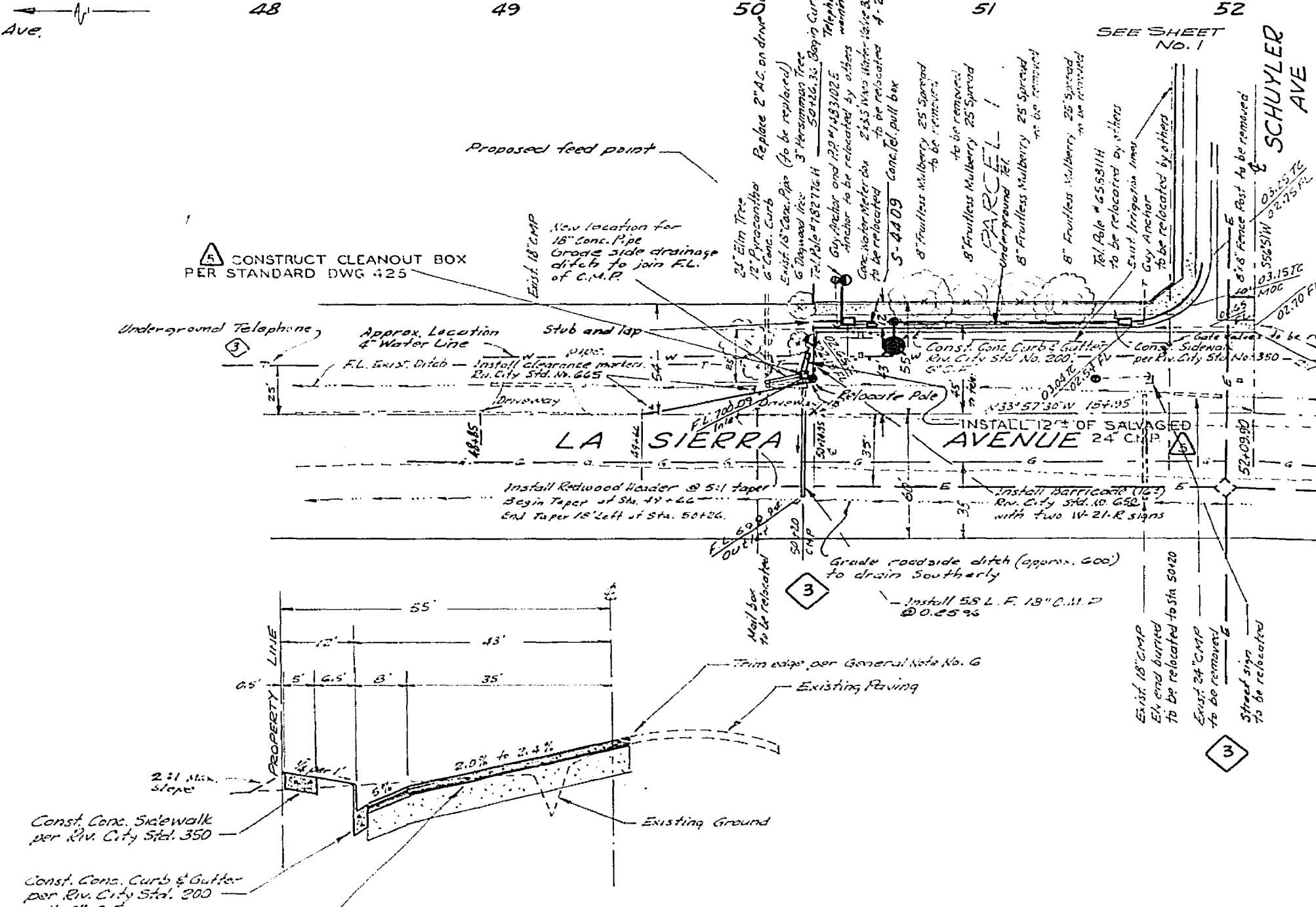
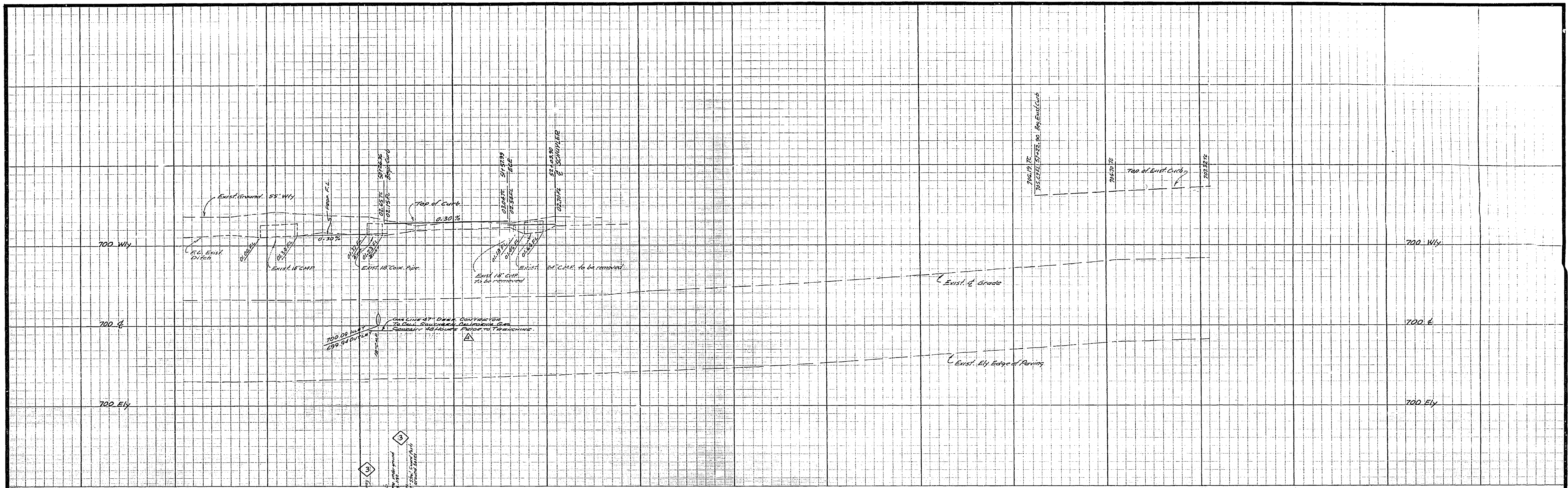

Const. Conc. Sidewalk per City Spec. 350 with 6" C.P.

Const. Conc. Curb & Gutter per City Spec. 200 with 6" C.P.

Const. 18" A.S. or 24" A.S. with 1" Class 2 A.S. over 7/8" class 3 Const. 6" I.C. OVER 10" CLASS 3 A.S.

TYPICAL SECTION LA SIERRA AVE.
Scale: Horiz. 1" = 20' Vert. 1" = 2'
T.I. = 7

REVISIONS

1	Pavement structure changed due to Dept. specifications order 2	5/27/66
---	--	---------

APPROVED FOR STREET LIGHTS
J.F. Davidson
 General Supt. & Chief Eng.
 2-23-67
 DATE

J. F. DAVIDSON ASSOCIATES
 CIVIL ENGINEERS - SURVEYORS - PLANNERS
 RIVERSIDE, CALIFORNIA

APPROVED BY *George E. McCarty* DATE 7-15-66
 R.E. No. 10688

W.O. 1126 FOR CITY OF RIVERSIDE F.B. 903-57

1	CONSTRUCT CLEANOUT BOX AND PIPES TO ELIMINATE HAZARD - CHANGE ORDER	5-27-66
2	Added Note to Request for Proposal	5-27-66
3	Added street lights and street light notes at request of Public Utilities Dept.	5-27-66
4	Added Note to Request for Proposal	5-27-66
5	Added Note to Request for Proposal	5-27-66

CITY OF RIVERSIDE, CALIFORNIA
 DEPARTMENT OF PUBLIC WORKS

APPROVED BY *William E. Davidson*
 DIRECTOR OF PUBLIC WORKS

DATE 10/27/66

STREET PLAN & PROFILE
 R.S. NO. 967
LA SIERRA AVENUE
 (SCHUYLER AVE TO 18TH SELBY OF SCHUYLER AVE.)

PROJECT NO. 55-341
 15-13235
R-1190
 SHEET 2 OF 2
 FILE NO. 3334

HORIZ. SCALE: 1" = 50'
 VERT. SCALE: 1" = 5'